

---

# INSTALLATION INSTRUCTIONS

---

## BRACKET

### SSC-1, SSC-2, SSC-3

The SSC bracket is designed for adding additional security to installations. By installing the SSC, a locking device can be placed to obscure access to fastening hardware.

Unpack and check contents (see Figure 1):

(Qty. 3) Bracket SSC-1 [up to 10-24 (M5)], SSC-2 [up to 1/4" (M7)], or SSC-3 [from M7 to 5/16"(M8)]

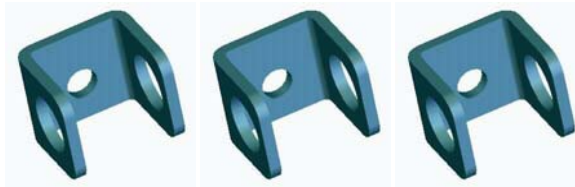

**Figure 1.**

1. Remove screw to be secured.
2. If screw to be secured is not a cap screw, replace existing screw with a cap screw.
3. Install bracket and secure using cap screw (see Figure 2).



**Figure 2.**

4. Install locking device in bracket, making sure locking device is large enough to cover access to cap screw (see Figure 3).

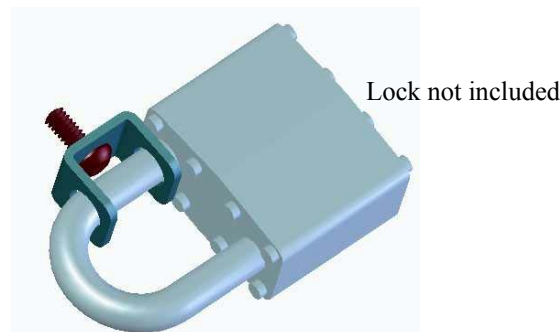

**Figure 3.**



**CHIEF MANUFACTURING INC.**  
1-800-582-6480 952-894-6280 FAX 952-894-6918  
12800 HIGHWAY 13 SOUTH, SUITE 500  
SAVAGE, MINNESOTA 55378 USA

8802-000124  
2003 Chief Manufacturing  
[www.chiefmfg.com](http://www.chiefmfg.com)  
01/04