

## No Mount

Code: N

### Description:

Use N for monitor arms that do not require a mount

## Two-Piece Clamp Mount with Base

Code: D

### Description:

The Two-Piece Clamp Mount is a two-piece surface clamp that supports the monitor arm post on horizontal surfaces.

### Application:

The Two-Piece Clamp Mount is designed to accommodate standard monitors, weighing a combined 30 pounds or less.

### Guidelines:

- The Two-Piece Clamp Mount accommodates horizontal surfaces ranging from 0.63" to 2.82" in thickness.
- The Heavy Duty Clamp Mount can be installed on a work surface with a minimum 0.5" clearance between the back of the work surface and a wall or panel. This is accomplished by separating the two clamp pieces, sliding the rear of the top portion between the surface and panel, and connecting the bottom portion from the underside of the surface.

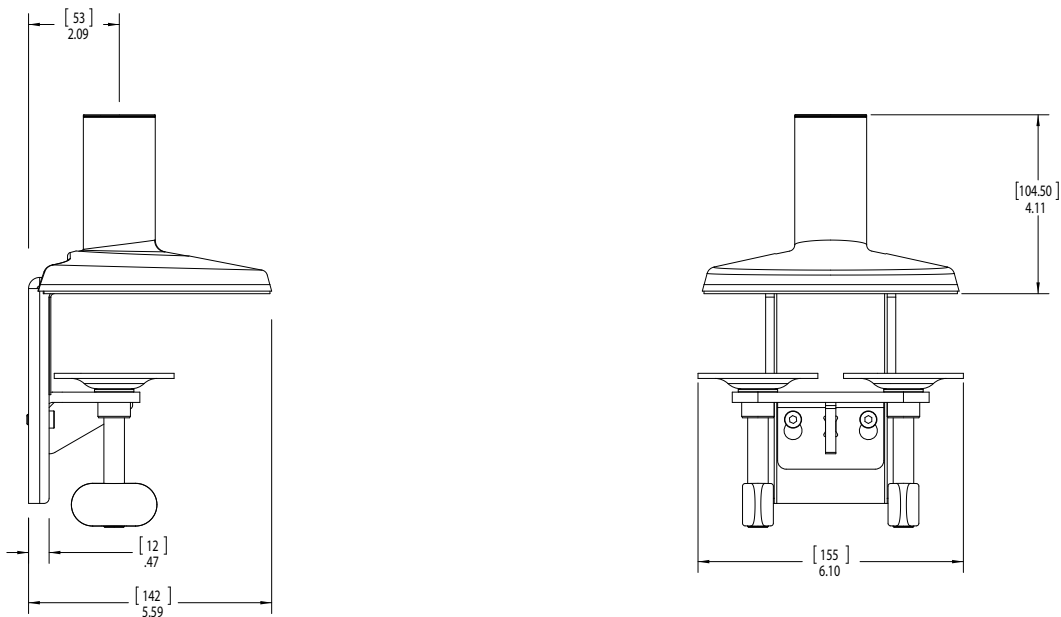

## TECHNICAL SPECIFICATIONS - MOUNTS

### Bolt-Through Mount with Base

Code: B

**Description:**

The Bolt-Through Mount uses an undersurface plate and heavy-duty bolt to support the monitor arm post on a horizontal surface.

**Application:**

The Bolt-Through Mount is the best option for heavy monitors or multiple monitor environments because it offers the most stability.

**Guidelines:**

- A 75mm Screw is mounted in conjunction with a 7mm thick plate to the bottom of the mounting surface.
- When mounting, leave at least 2 inches from the edge of the mounting surface for no overhang.

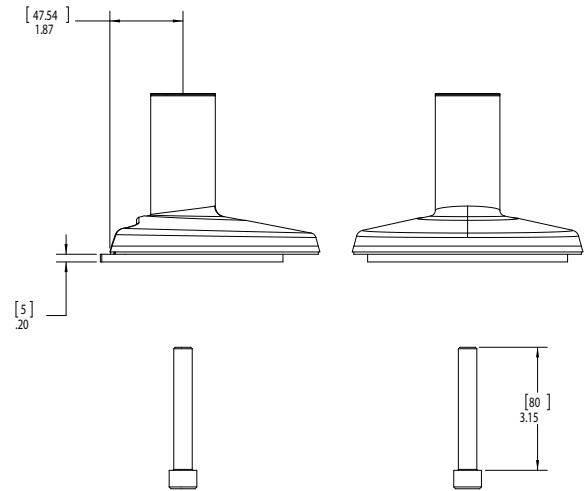

### Universal Slatwall Mount

Code: S

**Description:**

Universal Slatwall Mounts mount to many different slatwall systems and support up to two monitors depending on arm style.

**Application:**

Universal Slatwall Mounts are designed for interchangeability with a number of slatwall systems.

**Guidelines:**

- Not all slatwall is designed to support the weight of a monitor arm. Be sure to confirm the slatwall's weight load with its manufacturer. Humanscale does not warrant that slatwall will support the weight of a monitor arm, regardless of the monitor arm's availability for that system.
- Standard Slatwall Mounts support up to two monitors per mount.
- The distance from the center of the Slatwall Mount to the surface must be at least half the actual monitor height for the monitor to fit in the space provided.

