

Workrite
ergonomics®



SOLACE SIT-TO-STAND

SIT-TO-STAND

SOLACE

For more than 25 years, [Workrite Ergonomics](#) has been helping organizations create happier, healthier and more productive workplaces. We take issues like neck and back pain, blurred vision, and headaches caused by extended computer use seriously, and are committed to helping organizations fight these increasingly common problems.

Workrite's Solace provides a quick and efficient way to transform any ordinary desk into a more ergonomic sit/stand Workstation. Solace provides up to 22" of smooth vertical adjustability and can be easily mounted to the back of the worksurface using the built in C-clamp or grommet mount. It also features a reversible base that enables it to be used with virtually any size desk.

Solace was designed to promote comfortable healthy posture and is available with Workrite's Standard or Revo adjustable keyboard platforms. Our optional dual monitor adaptor kit enables you to reconfigure quickly and seamlessly from one monitor to two. Solace is simple to install, features a wide adjustment range and can be easily adapted to provide a uniquely personalized workspace for any user.

Solace — For the Way You Work



SOLACE — FOR THE WAY YOU WORK



Solace Standard



Solace Premium with Dual Monitor Adaptor option

Solace Sit-to-Stand

Standard

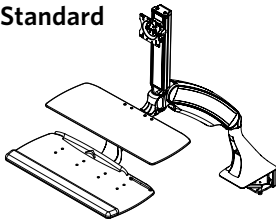

UB-182-25 Keyboard Platform

Arm Features:

- 25 lb. capacity
- 22" lift range
- 360° rotation at base
- Reversible base for compatibility with 24"-32" deep worksurfaces
- Monitor tower and keyboard platform rotate independently
- Available in Silver

Monitor Mount Features:

- Supports one 5- 17 lb. monitor
- 9.5" independent monitor height adjustment

Standard Keyboard Platform Features:

- Features our Standard UB-182-25 Keyboard Platform
- In-Line mousing for right and left handed users
- 3" independent keyboard platform adjustment

Model #	Weight	List
SOL-ST-CCG-S	53	\$999

Premium

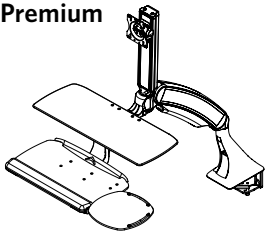

UB-2100FT-25 Keyboard Platform

All the same Arm and Monitor Mount features as the Standard, plus:

Premium Keyboard Platform Features:

- Features our Revo UB-2100FT-25 Keyboard Platform
- Mouse platform tilts independently from keyboard platform
- Mouse platform can be positioned in-line, mouse-forward and mouse-over in both right handed or left handed position
- 3" independent keyboard platform adjustment

SOL-PR-CCG-S	54	\$1,099
--------------	----	---------

Accessories

Dual Monitor Adaptor

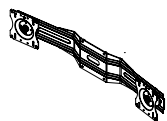

- Converts from single monitor to dual monitor use
- Supports two monitors 5-7 lb. each, up to 24" actual width
 - Reduces maximum weight capacity of arm by 3 lb.
- Includes additional Quick Release Adaptor

SOL-ADPT-TWIN-S	6	\$99
-----------------	---	------

Replacement Parts

C-Clamp & Grommet Mount Hardware Kit	SOL-HDWR-CCG-B	6	\$149
Replacement Secondary Surface	SOL-WS-1024-B	5	\$75
Replacement Standard Platform	SOL-AKP-ST-B	6	\$183
Replacement Premium Platform	SOL-AKP-REVO-B	6	\$227

SUPERIOR RANGE ENSURES ERGONOMIC COMFORT

Solace promotes health and wellness by providing the core ergonomic benefits associated with height adjustable desks, monitor arms, and keyboard platforms. The all-in-one ergonomic workstation offers a quick & economical method to enhance user comfort as well as overall productivity. With its proficient ranges of lift, rotation and tilt, Solace has the flexibility to accommodate a wide variety of users and applications.

Arm:

Solaces' pneumatic strut allows the arm to effortlessly lift the keyboard and monitor(s) between the seated and standing positions. The industry leading keyboard platform height range makes Solace an ideal solution for multi-user environments.

- Designed to meet ANSI/BIFMA & HFES standards, supporting 5th percentile seated women to 95th percentile standing man
- Keyboard Platform, Secondary Surface & Monitor Mount travel in unison allowing transition between seated and standing height in seconds
- Stows down to just 14" to quickly and easily access desktop workspace



Standing position



Seated position



Stowed position

Dimensions

Forward base reach & range

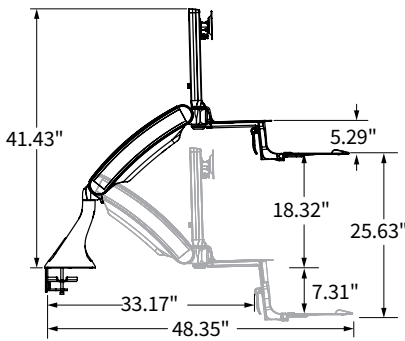

Reverse base reach & range

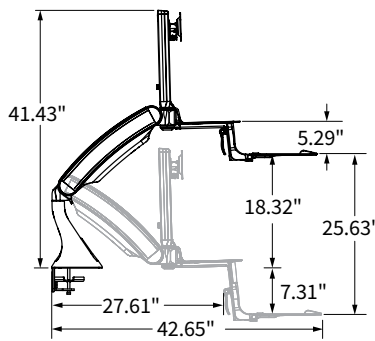

Pivot

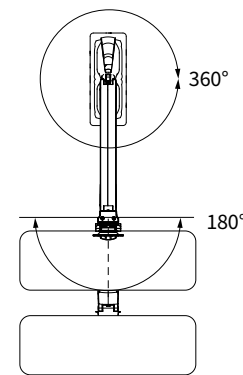

Stowed Depth

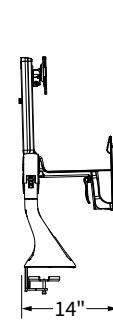

Arm Rotation

Base:

- C-Clamp and Grommet Mount provide installation flexibility
- Reversible base allows keyboard platform to drop below static worksurface up to 32" deep

Mounting clearance

C-Clamp

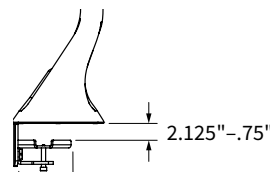

Grommet

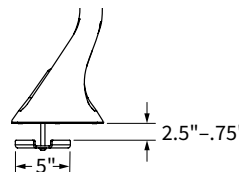

Reversible base ensures Solace is compatible with 30" and 24" worksurfaces.

INDEPENDENT ADJUSTMENT FOR A FINE-TUNED FIT

To create a uniquely personalized configuration, Solace incorporates the ability to make fine-tune independent adjustments to both Monitor and Keyboard Platform positioning.



Monitor Mount:

The counter balance technology creates a simple to use, knob free experience so the user can adjust monitor height with minimal effort.

- Supports one 5–17 lb. monitor
- 9.5" of independent height adjustment
- Standard VESA (75 mm & 100 mm)
- Quick Release Adaptor Included for streamlined monitor installation



Dual Monitor Adaptor increases productivity.

Optional Dual Monitor Adaptor:

- Supports two monitors 5–7 lb. ea and up to 24" wide

Dimensions

Monitor Mount tilt, rotate & swivel

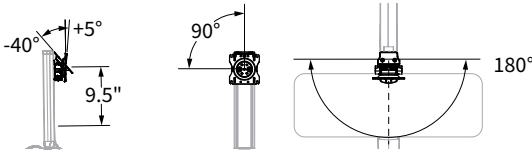

Dual Monitor Adaptor option

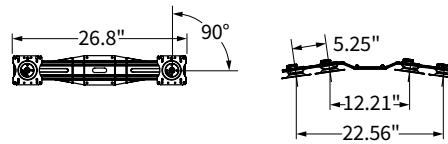

Keyboard Platform:

By unlatching the cam lever behind the keyboard platform, the user has ability to raise or lower the keyboard platform to ideal height.

- Standard features UB182-25 Platform
- Premium features Revo UB2100FT25 Platform
- Over 3" of independent adjustment
- Folds up 90° for optimal storage



Easy keyboard platform adjustment with the cam lever.



The Standard Keyboard option offers in-line mousing for left or right handed users.



The Premium Keyboard option includes an independent mouse surface for in-line, mouse-forward and mouse-over positions.

Dimensions

Keyboard platform tilt & range

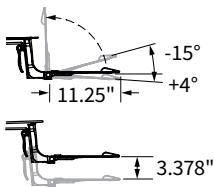

Standard Keyboard option

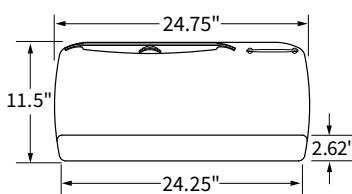

Premium Keyboard option

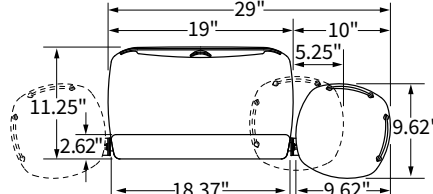

Secondary Surface

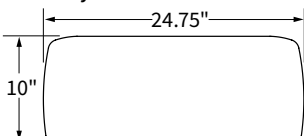

Secondary Surface:

- Convenient worksurface for placing items when in standing position

SIMPLE & QUICK INSTALLATION

When compared to installing a height adjustable workcenter, a monitor arm and a keyboard platform, the Solace sit-to-Stand is far less complex and time consuming. Benefits of installing Solace Sit-to-Stand include:

- Installing complete ergonomic solution with one connection point
- Allen wrenches provided for arm assembly and tension adjustments
- Included Tool Caddy attaches to Solace keeping tools at hand
- Base ships with upper clamp bracket pre-attached
- Keyboard Platform & Secondary Surface attach with just four screws each
- Quick Release Adaptor included for easy monitor attachment



C-clamp or grommet mounting allows quick and easy installation.

AVERAGE INSTALLATION TIME

Height Adjustable Workcenter:	40 minutes	Solace:	25 minutes
Monitor Arm:	20 minutes		
Adjustable Keyboard Platform:	15 Minutes		
1 hour 15 minute job		25 minute job	

ENVIRONMENTAL CONSIDERATIONS

Solace design was centered around green business practices with special focus on environmental sustainability. By incorporating recycled material in the manufacturing process, Solace contributes toward LEED credit ratings.

LEED RECYCLABILITY CALCULATIONS

	Weight in lb.	Recycled Content %
Total Weight	36 lb.	-
Post Industrial Content	11.5 lb.	16% (½ of 32% total*)
Post Consumer Content	8 lb.	22%
LEED Recycled %*	19.5 lb.	38%

*LEED % recycled content: Total post-consumer recycled %, plus ½ pre-consumer/post industrial recycled %.

LEED CREDIT RATING

PRODUCT

LEED CREDIT RATING	PRODUCT
Manufacturing & Resources	
MR Credit 4.1 Required Recycled Content, 10%	Solace Sit-To-Stand
MR Credit 4.2 Required Recycled Content, 20%	Solace Sit-To-Stand
Innovation & Design Process	
Credit 1.1 – 1.4 Innovation in Design Ergonomic product could be credited as part of an implemented Ergonomic Strategy	Solace Sit-To-Stand