

ERGOTRON®

Zido® Pole Cart



Part Number	ZD2166CG4
Product Includes	60" (152.4 cm) high, 2.5" (6.35 cm) diameter column with holes in 1" (2.54 cm) increments for accessory installation, heavy metal base, and 4 casters (4" [10.16 cm] size, 2 locking)
Materials and Finishes	Steel column and cast metal base receive a baked-on powder coated finish that's durable and easy to clean
Product Dims	
Weight Capacity	150 lbs. (68.04 kg) overall. When calculating the load being applied to the cart, also factor in weight of any accessories that you add on
Mobility	Easy to move with 4" (10.16 cm) twin-wheel rubber casters (two locking). Heavy cast metal base provides stability
Product Weight	35 lbs. (15.9 kg)
Shipping	Shipping Weight: 45 lbs. (20 kg); ships in 2 boxes
Warranty	Limited lifetime against manufacturing defects on materials and workmanship



Shown with optional accessories (sold separately)

Zido Pole Cart provides a strong, tall, single column to support all the accessories you need.

At 66" (167.64 cm) tall, Zido Pole Cart is drilled at 1" (2.54 cm) increments on the column for easy accessory installation. Heavy metal cast base provides needed support in a small footprint. Overall weight capacity is 150 lbs. (68.04 kg). Large 4" (10.16 cm) casters (2 locking) take your cart and equipment where you need it.

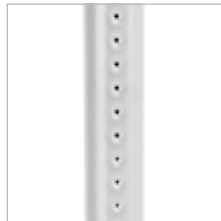

The column has holes in 1" (2.54 cm) increments to install accessories at the right height



Heavy cast metal base provides a stable foundation in a compact footprint



Add a handle (sold separately. PN: ZHHCG) to easily steer your Zido Pole Cart where you need it



A Single Monitor Mount (sold separately. PN: ZOMSCG) will support any monitor up to 40 lbs. (18.14 kg)



The 30-year legacy of Anthro Corporation lives on in its world-class factory, flexible award-winning designs, and market-leading personal customer service. When you see Anthro-DNA, it signifies quality manufacturing and technology leadership.

See Zido accessories on the next page >

Zido Pole Cart Accessories

Cable Bin

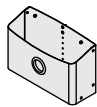

- Attaches to the back of the column with 3 fasteners.
- Comes with 2 grommets pass-throughs (2.25" [5.72 cm] diameter), 1 on the front and 1 on the bottom. Comes with four 8" (20.32 cm) long cable ties. Install the Surge Protector (sold separately. PN:520BK) for added convenience.

Product	Width	Depth	Height	Weight	Part #
Cable Bin	14.5" (36.83 cm)	5.25" (13.34 cm)	9.5" (24.13 cm)	9 lbs. (4.08 kg)	ZCBCG

Hooks



- Manage cords and cables with this pair of strong plastic hooks.
- Install at any height along the back of the column.

Product	Weight	Part #
Hooks (set of 2)	1 lb. (0.45 kg)	ZHKCG

Drawer Solutions

Drawers

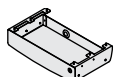

Shallow

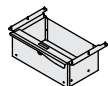

Deep

- Add secure storage to your Zido Pole Cart with these locking drawers. They attach under a cap shelf or an additional shelf with 6 screws. Choose from Shallow (4.5" [11.43 cm] high) or Deep (6.5" [16.51 cm] high).
- The Shallow Drawer's interior measurements are 19" w x 10" d x 3" h (48.26 x 25.4 x 7.62 cm). The back features a grommets cord pass-through for power and network cables.
- The Deep Drawer's interior measurements are 14.75" w x 8.75" d x 5.75" h (37.47 x 22.23 x 14.61 cm).

Product	Weight Capacity	Locking	Width	Depth	Height	Weight	Part #
Shallow	15 lbs. (6.8 kg)	Yes	20.5" (52.07 cm)	11.25" (28.58 cm)	4.5" (11.43 cm)	13 lbs. (5.9 kg)	ZDRCG
Deep	15 lbs. (6.8 kg)	Yes	16" (40.64 cm)	10" (25.4 cm)	6.5" (16.51 cm)	16 lbs. (7.26 kg)	ZDCCG

 Only works with Additional Shelf (sold separately. PN:ZADLCG/CG).

2-Drawer Enclosure

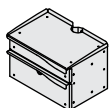

- This enclosure's locking drawers store equipment, supplies, and documents safely and securely.
- Attaches to the front of the column with two large wraparound brackets.
- The 2-drawer Enclosure features a small upper drawer (interior measurements 14.75" w x 8.75" d x 2.75" h [37.47 x 22.23 x 6.99 cm]) and large lower drawer (interior measurements 14.75" w x 8.75" d x 5.75" h [37.47 x 22.23 x 14.61 cm]). The top surface measures 16.5" w x 11.25" d (41.91 x 28.58 cm).
- The unit holds up to 50 lbs. (22.68 kg) overall: 10 lbs. (4.54 kg) in the small drawer, 15 lbs. (6.8 kg) in the large drawer and 25 lbs. (11.34 kg) on the top.

Product	Width	Depth	Height	Weight	Part #
2-drawer Enclosure	16.5" (41.91 cm)	11.25" (28.58 cm)	11" (27.94 cm)	35 lbs. (15.88 kg)	ZDE02CG/CG

Single Monitor Mount



- Install on column in 1" (2.54 cm) increments, putting your monitor at the desired viewing height.
- Comes with 25 degree pan and +10 to -3 degrees tilt.
- Monitor Mounting Standards: VESA MIS-D, 75/100 (hole pattern = 100 x 100 mm & 75 x 75 mm), MIS-E (hole pattern = 200 x 100 mm), MIS-F (hole pattern = 200 x 200 mm ONLY)
- Supports 40 lbs. (18.14 kg)

Product	Weight	Part #
Single Monitor Mount	3 lbs. (1.36 kg)	ZOMSCG

Glove Box Holder

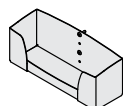

- Attaches to the back of the column at any height using 2 screws.

Product	Width	Depth	Height	Weight	Part #
Glove Box Holder	11.5" (29.21 cm)	3.5" (8.89 cm)	4.5" (11.43 cm)	3 lbs. (1.36 kg)	ZGBCG

Handle

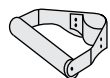

- Strong metal handles help you easily steer your Zido right where it's needed!
- 8" (20.32 cm) wide.
- Attaches to the back of the column with a 2-piece bracket.

Product	Weight	Part #
For Pole Cart or Monitor Tube	4 lbs. (1.81 kg)	ZHHC

[More accessories on the next page >](#)

Keyboard Caddy

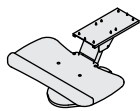

- Caddy moves in and out, up and down, tilts 10° positive and 20° negative, and swivels 360°. Movement ranges from even with your work surface to 6" (15.24 cm) below.
- Swing-out mouse surface pivots out when it's needed and hides away when it's not.
- Made of steel and phenolic with an integrated foam wrist rest.
- Surfaces are neutral granite color.
- Attaches with 10 screws and requires 11" (27.94 cm) mounting depth. When retracted the caddy will extend 4" (10.16 cm) from the front of the shelf. Drill required for installation.

Product	Width	Weight	Part #
Keyboard Caddy	19.5" (49.53 cm)	11 lbs. (4.99 kg)	169BK

 Only works with Additional Shelf (sold separately. PN:ZADLCG/CG).

Probe Holders

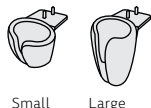

- Cups come in grey with light green accent. Brackets are Cool Grey to match Zido Pole Cart.
- Brackets measure 1.5" (3.81 cm) wide x 2.5" (6.35 cm) deep and attach to the bottom of any wood surface with 2 screws. Cushioned cups snap into place. Drill required for installation.

Product	Width	Depth	Height	Weight	Part #
Probe Holder, Small	2.5" (6.35 cm)	3.5" (8.89 cm)	2.5" (6.35 cm)	1 lb. (0.45 kg)	ZGCSCG
Probe Holder, Large	2.5" (6.35 cm)	3.5" (8.89 cm)	4.5" (11.43 cm)	1 lb. (0.45 kg)	ZGCLCG

 Only works with Additional Shelf (sold separately. PN:ZADLCG/CG).

Shelves

Additional Shelf

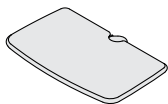

- Wood shelf attaches to the column with 3 screws.
- Holds 50 lbs. (22.68 kg).

Product	Width	Depth	Weight	Part #
Additional Shelf	25" (63.5 cm)	16.5" (41.91 cm)	13 lbs. (5.9 kg)	ZADLCG/CG

Base Storage Shelf

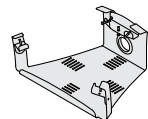

- Clamps onto the base of the Zido Pole Cart.
- Comes with a Strap & Buckle Kit, and has a weight capacity of 50 lbs. (22.68 kg).

Product	Width	Depth	Height	Weight	Part #
Base Storage Shelf - Cool Grey	9.5" (24.13 cm)	12.5" (31.75 cm)	4.5" (11.43 cm)	14 lbs. (6.35 kg)	ZBCG

Equipment Shelf

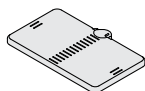

- Attaches to the column tube with 3 screws.
- Comes with a Strap & Buckle Kit, and has a weight capacity of 50 lbs. (22.68 kg).

Product	Width	Depth	Weight	Part #
Medium Equipment Shelf	19" (48.26 cm)	11" (27.94 cm)	9 lbs. (4.08 kg)	ZESMCG/CG
Large Equipment Shelf	22" (55.88 cm)	13" (33.02 cm)	14 lbs. (6.35 kg)	ZESLCG/CG

Surge Protector

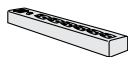

- This UL-listed surge suppressor is 12" (30.48 cm) long, has 6 outlets and is rated at 15 amps, 120 Volts. Comes with on/off switch, on/off indicator light, 15-ft (457.2 cm) power cord and circuit breaker reset button.
- Comes in Black and mounts to the column, to a cable bin (sold separately. PN:ZCBCG), or underneath a shelf with integrated mounting hardware. Drill required if attaching underneath a shelf.

Product	Cord Length	Depth	Weight	Part #
Surge Protector	15' (457.2 cm)	2.5" (6.4 cm)	2 lbs. (1 kg)	520BK