

## Tablet Management Cart / Module

Sync Cable Kit  
for iPad®

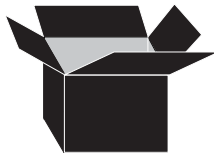

16x



Length  
0.5 m (19.7")

### Compatibility:

Made for  
iPad Air 2  
iPad Air  
iPad (4th generation)  
iPad mini 3  
iPad mini with Retina Display  
iPad mini

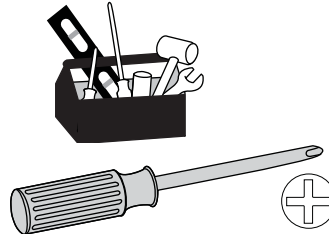

[www.ergotron.com](http://www.ergotron.com)  
USA 1-800-888-8458  
Europe +31 (0)33-45 45 600  
China 86-769-86018920

- 1 Make sure the Module power cord is disconnected from wall power supply before proceeding.

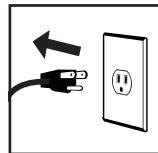

Unlock the module and open the doors.



NOTE: the Module power cord acts as the connect/disconnect device switching power off and on.

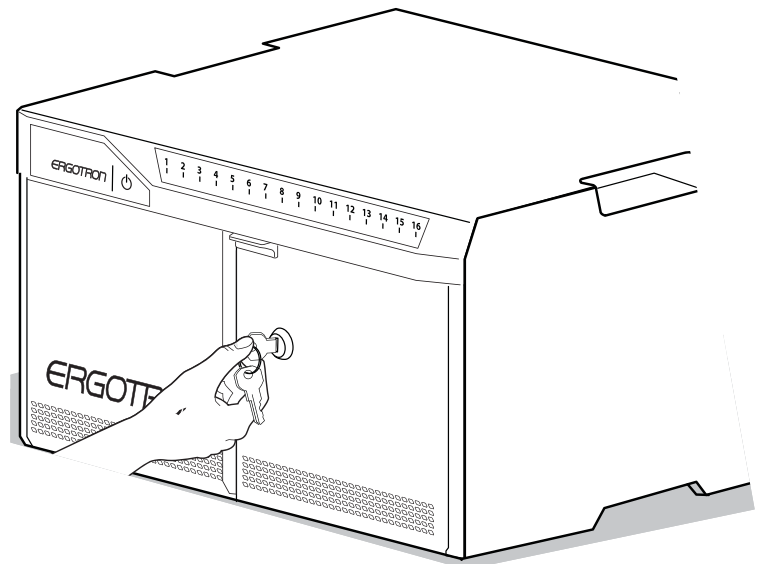

- 2 Use a Phillips screwdriver to remove the two screws located on the interior sides of the module; save screws to reinsert later.

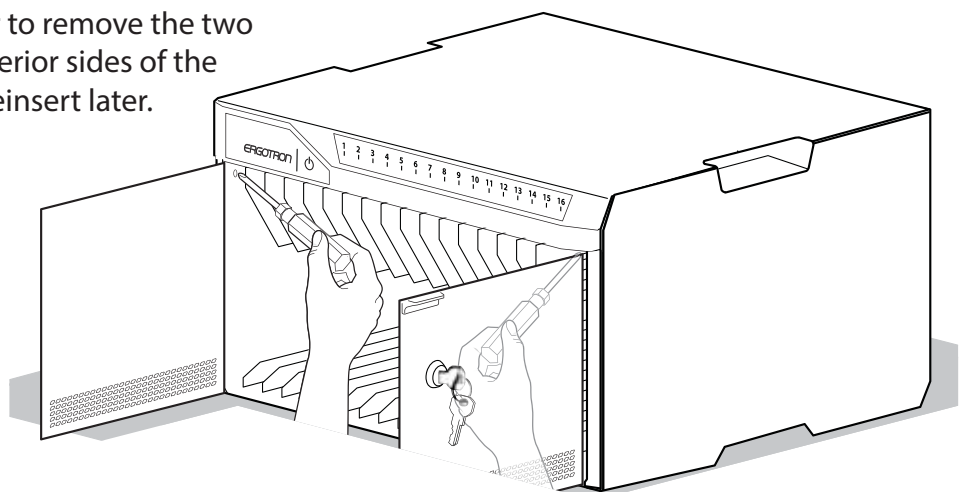

Apple, iPad, iPad Air, iPad mini, Retina and Macintosh are trademarks of Apple Inc., registered in the U.S. and other countries.

"Made for iPad," means that an electronic accessory has been designed to connect specifically to iPad, and has been certified by the developer to meet Apple performance standards. Apple is not responsible for the operation of this device or its compliance with safety and regulatory standards. Please note that the use of this accessory with iPad may affect wireless.

**3** Partially slide out the module drawer. You'll need to unplug two cables before sliding the drawer completely out. Open the strap to access the two cables.

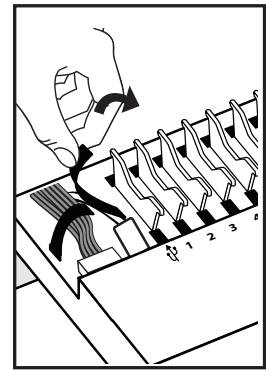
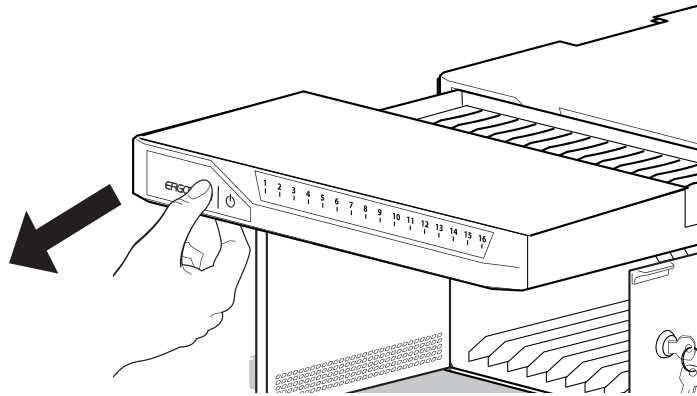

**4** Unplug the USB and DC power cables (push up on the lever under the DC connector to release). The drawer can now be removed.

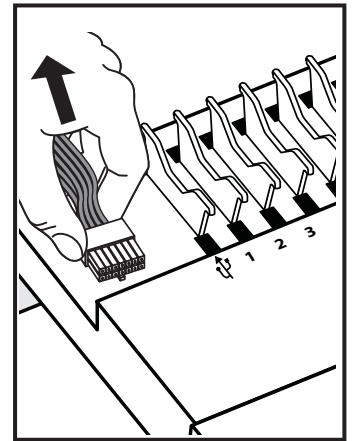
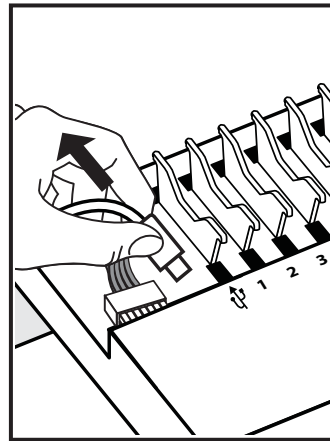

**5** Unwind and remove the existing USB cables from drawer.

NOTE: Please recycle or dispose the removed cables in a responsible manner.

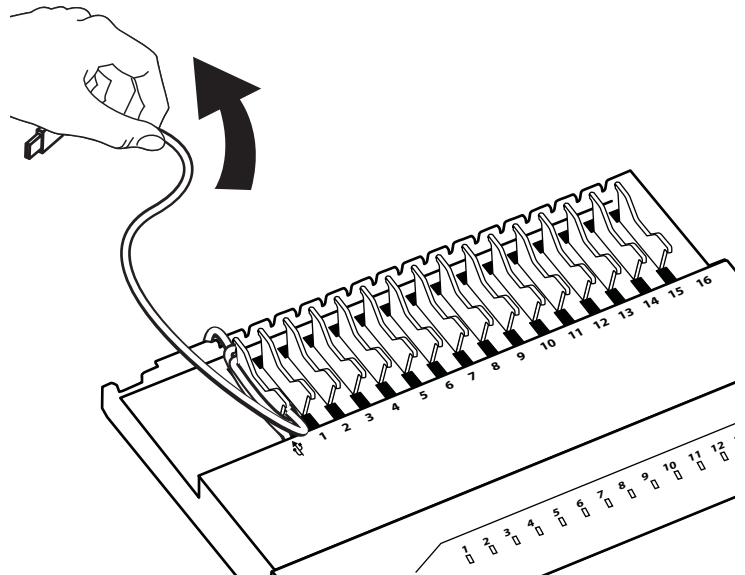

---

**6**

Connect the USB cable to the USB port.

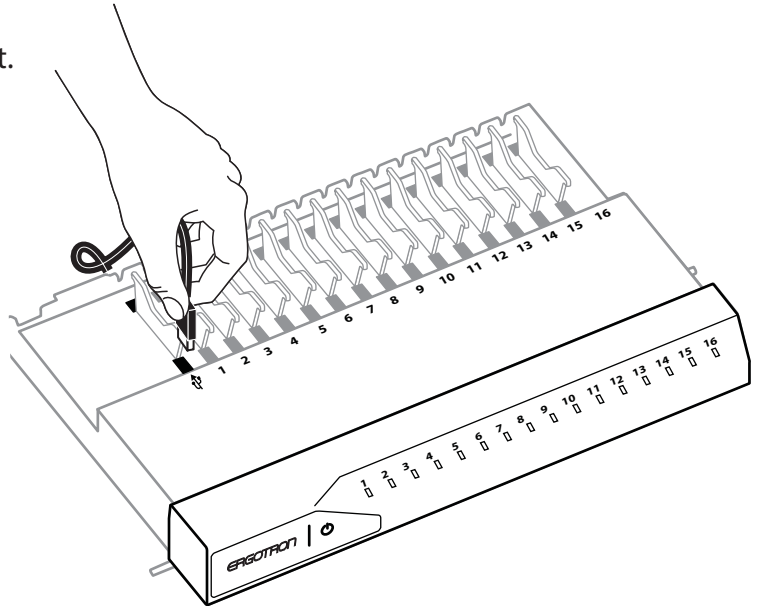

---

**7**

Place the drawer upside down on the cart top and route the USB cable through the slot on the back of the drawer and under the hooks toward the front. Make sure there is no slack in the cable. All excess cable should hang from the hooks.

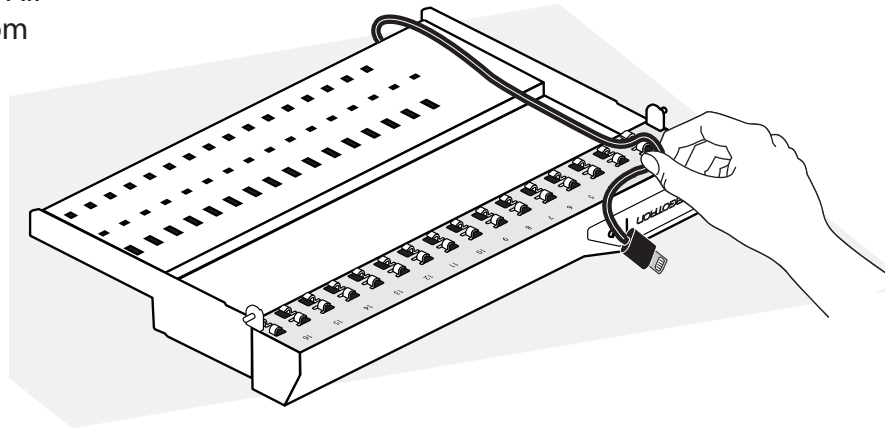

---

**8**

Repeat USB cabling steps 6 through 8 for the rest of the iPad devices going into this module.

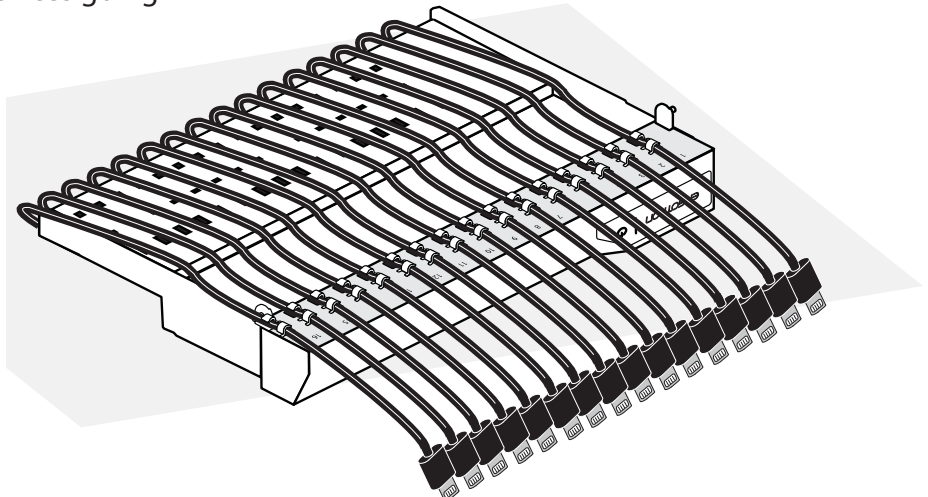

- 9** Slide the drawer partially into the module. Reconnect the USB and DC cables and wrap the straps around the cables.

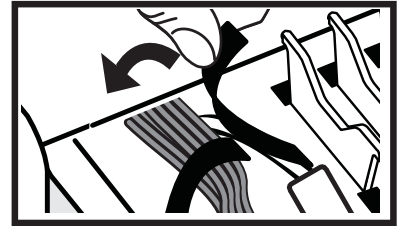
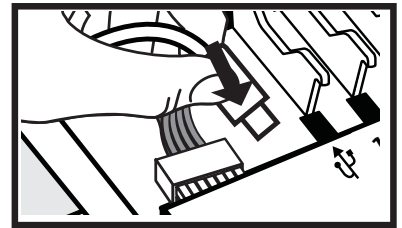
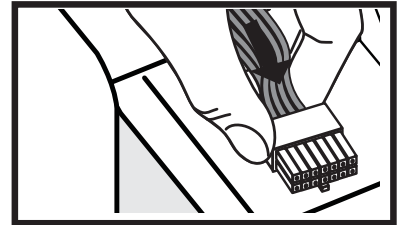
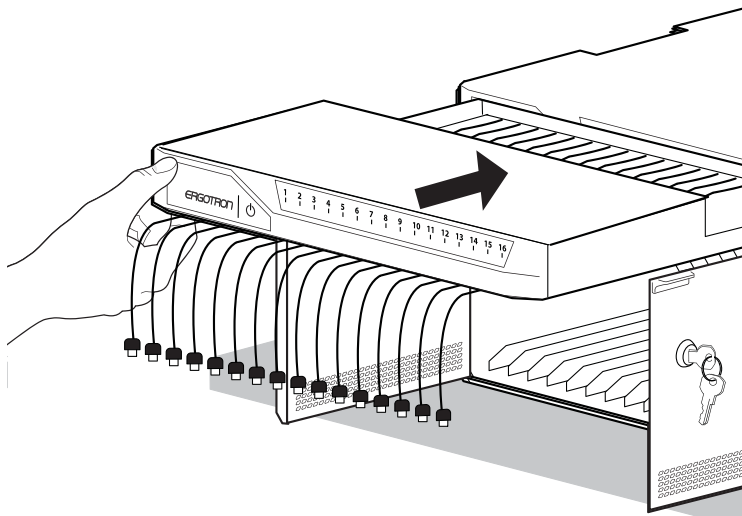

- 10** Slide the drawer completely into the module. Insert the screws removed in step 2 and tighten.

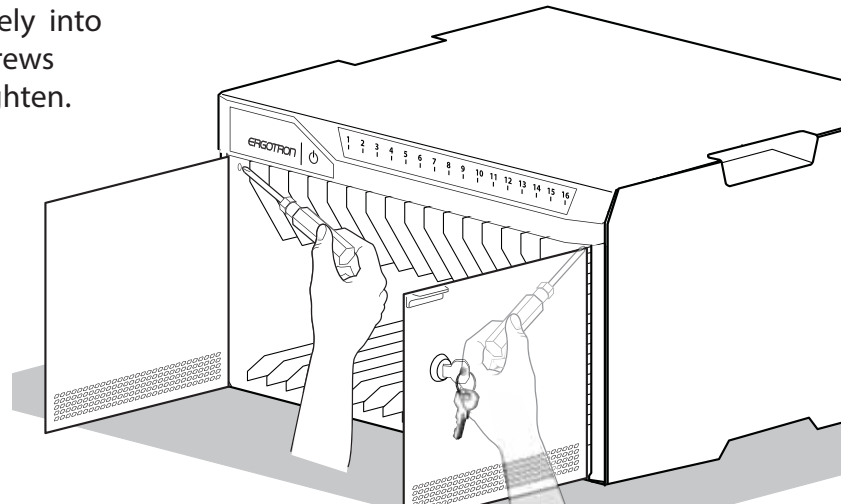

- 11** Insert iPad devices into module. Connect the tablet USB charging cables to the iPad devices.

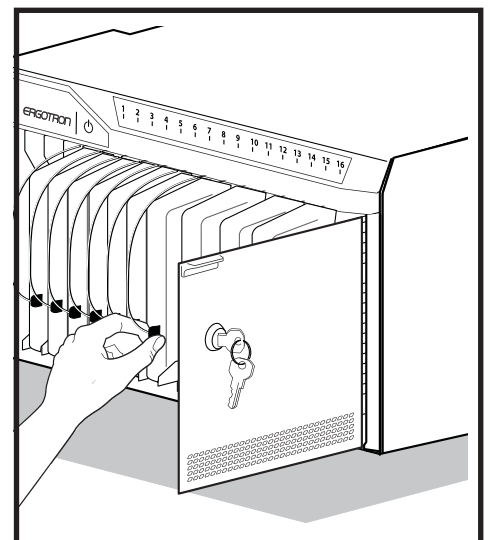
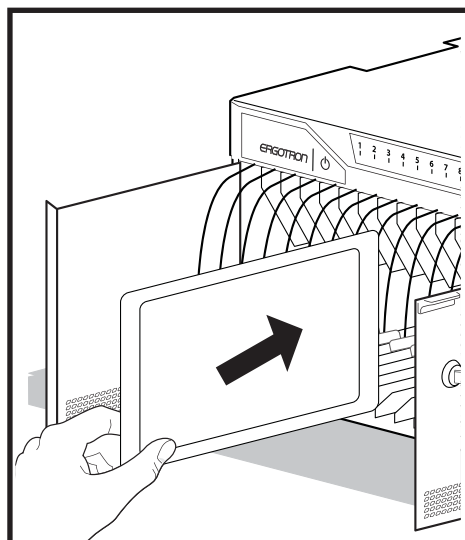

# 12 Tablet Charging

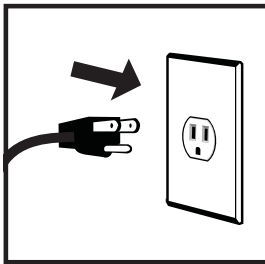

To begin charging the tablets, plug in the Module power cord.

The power cord is used to turn the Module power on and off. Charging occurs whenever the cart power cord is connected UNLESS a Macintosh® or PC notebook USB cable is connected to the cart for syncing.



**NOTE:** the Module power cord acts as the connect/disconnect device switching power off and on.



© 2014 Ergotron, Inc.  
All rights reserved.

While Ergotron, Inc. makes every effort to provide accurate and complete information on the installation and use of its products, it will not be held liable for any editorial errors or omissions (including those made in the process of translation from English to another language), or for incidental, special or consequential damages of any nature resulting from furnishing this instruction and performance of equipment in connection with this instruction. Ergotron, Inc. reserves the right to make changes in the product design and/or product documentation without notification to its users. For the most current product information, or to know if this document is available in languages other than those herein, please contact Ergotron. No part of this publication may be reproduced, stored in a retrieval system, or transmitted in any form or by any means, electronic, mechanical, photocopying, recording or otherwise without the prior written consent of Ergotron, Inc., 1181 Trapp Road, Eagan, Minnesota, 55121, USA. Patents Pending and Patented U.S. & Foreign. Ergotron is a registered trademark of Ergotron, Inc.

#### Americas Sales and Corporate Headquarters

St. Paul, MN USA  
(800) 888-8458  
+1-651-681-7600  
www.ergotron.com  
sales@ergotron.com

#### EMEA Sales

Amersfoort, The Netherlands  
+31 33 45 45 600  
www.ergotron.com  
info.eu@ergotron.com

#### APAC Sales

Tokyo, Japan  
www.ergotron.com  
apaccustomerservice@ergotron.com

#### Worldwide OEM Sales

www.ergotron.com  
info.oem@ergotron.com