

Gemini™ Arm

Adjustable Keyboards - Arms

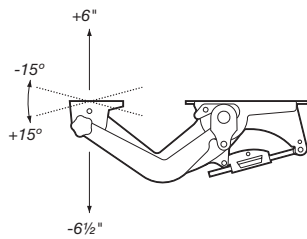

Dual adjustable arms lift larger keyboard surfaces with outstanding strength and stability.



Model 2420

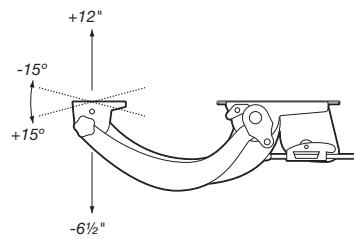

Model 2440

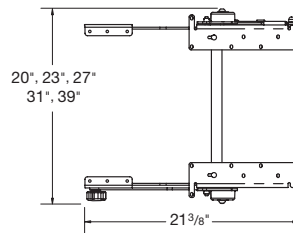

Model 2420

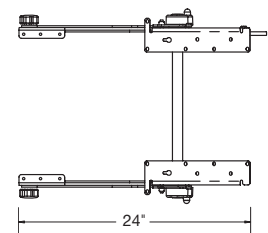

Model 2440

Features

- Dual adjustable arms lift separate worksurface or platform with outstanding strength and stability
- 30° tilt range (-15° to + 15°) is adjusted using easy to reach knob
- Positive rod locking brake
- Easily adjustable springs allow counterbalance to be adjusted
- Easy T-pull height adjustment
- 150 lb load rating exceeds ANSI/BIFMA standards
- Available in various widths from 20" - 39"
- Adaptors for WorkRite platforms available (see below)
- Two models available for different height range requirements
 - #2420 provides 12½" height range (+6" to -6½")
 - #2440 provides 18½" height range (+12½" to -6")

Height Range	Width	Model #	Weight
12½"	20"	2420-20	16
	23"	2420-23	17
	27"	2420-27	18
	31"	2420-31	20
	39"	2420-39	21
18½"	20"	2440-20	17
	23"	2440-23	18
	27"	2440-27	19
	31"	2440-31	21
	39"	2440-39	22

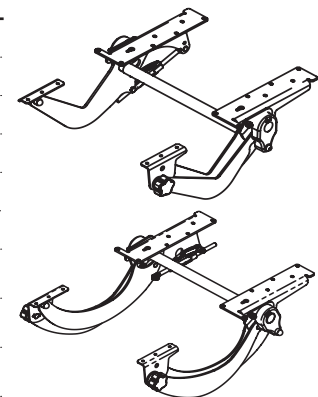

At WorkRite we believe that every body has a right to work comfortably and safely for maximum productivity. You can trust WorkRite - as 75% of Fortune 100 companies have - to create innovative solutions that flex to the diverse range of user needs, preferences and settings at work today.