

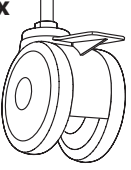

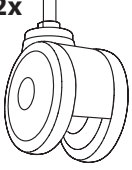

Attaching the StyleView Specialty Casters involves unloading mounted equipment, laying the cart down on its back, removing the old casters from the base and installing the specialty casters. Ergotron recommends this operation be carried out by two people to minimize the possibility of damage to the cart and/or personal injury.

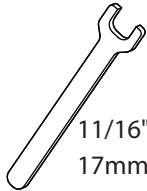

USA 1-800-888-8458
Europe +31 (0)33-45 45 600

| | A | B | C | D | E |
|---|--|--|--|---|---|
| 1 | 2x  | 2x  |  Loctite | 1x  10mm | 1x  11/16" 17mm |

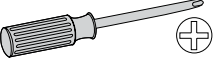
1 Prepare Cart.

- a** Unlock riser cap.
- b** Remove riser cap.

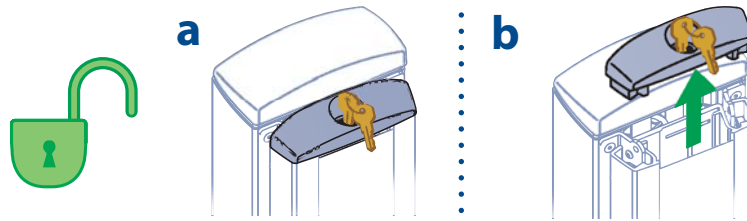

2 Anchor riser to tower.

- a** If riser and tower are not on the same level, move riser down to lowest position.
- b** Insert two #10-24 x 3/8" screws to anchor riser to tower, as shown below. *NOTE: Some Carts came with 1/8" hex head anchor screws and a hex wrench rather than phillips head screws.

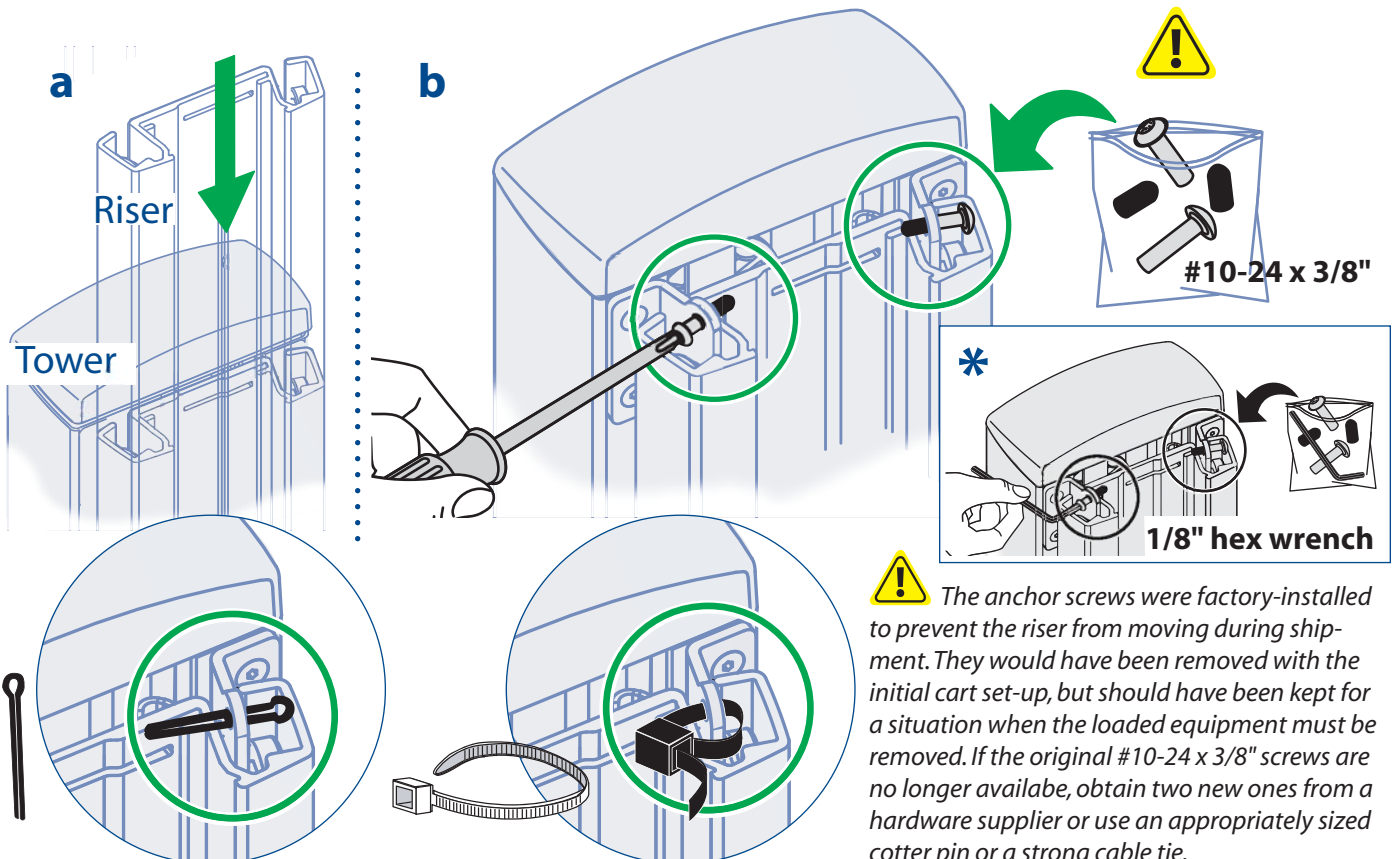

Assembly Instructions

3 Prepare Cart (continued)

a Lock casters.

b Turn off all mounted equipment.

c If cart has a power system, turn off by holding down the standby button  on the RUI for 1 - 3 seconds. The Power light will shut off.

d Disconnect from power source, if applicable. Disconnect any cables.

e Remove mounted equipment and any other components that could be damaged when the cart is tipped over to access the casters where they are attached to the base.

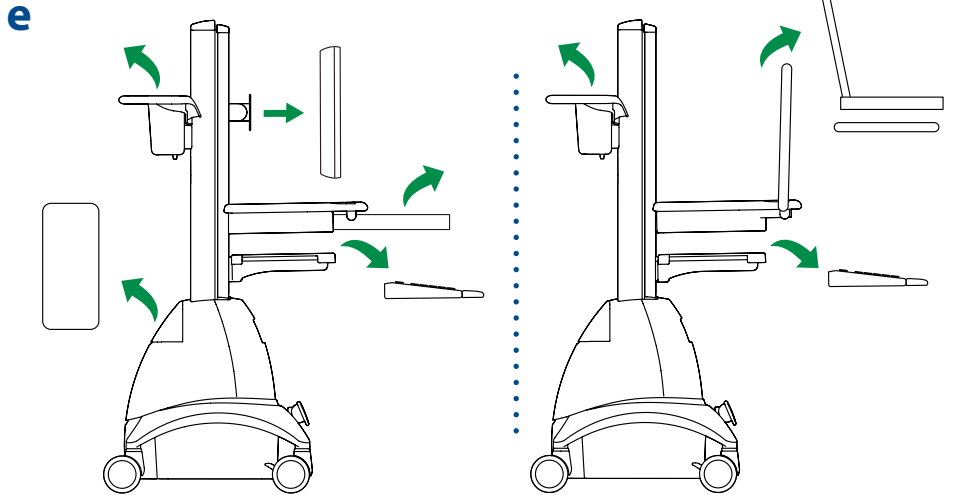
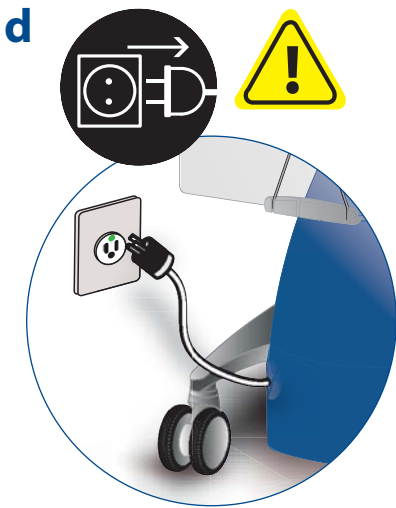
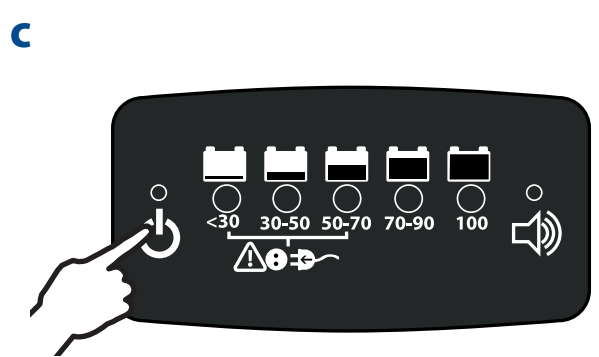
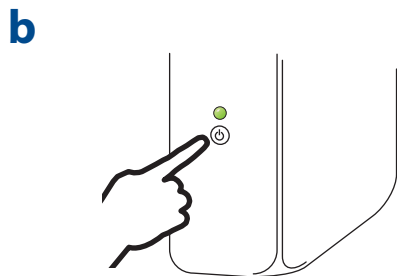

4 Working with two people, position the cart on a flat, clean surface so that the casters are accessible where they meet the base.

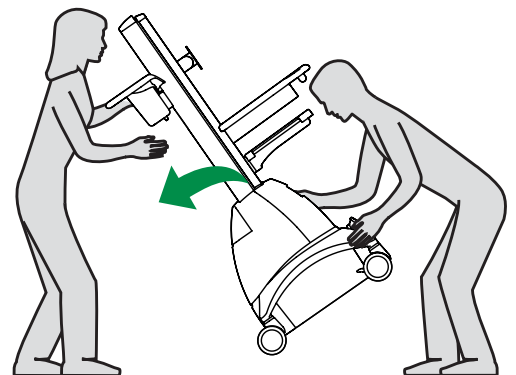
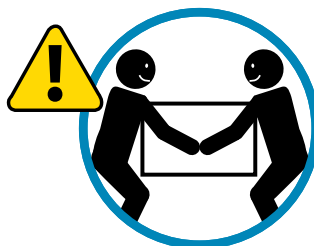

Assembly Instructions

5 Loosen nut at base of casters with wrench.

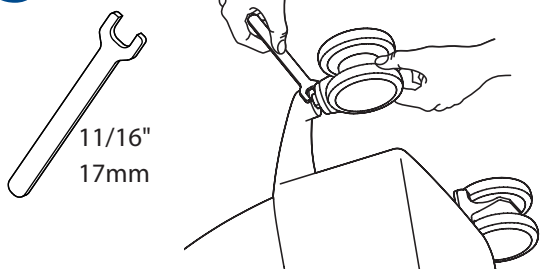

6 Twist the old casters off the base.

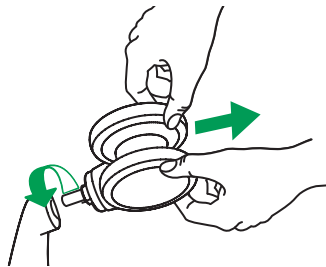

7 Attach the new casters to the base.*

a Apply a line of Loctite to stem of each new caster.

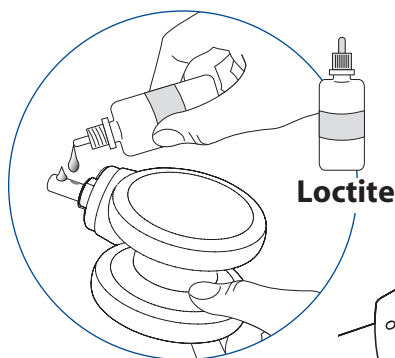

b

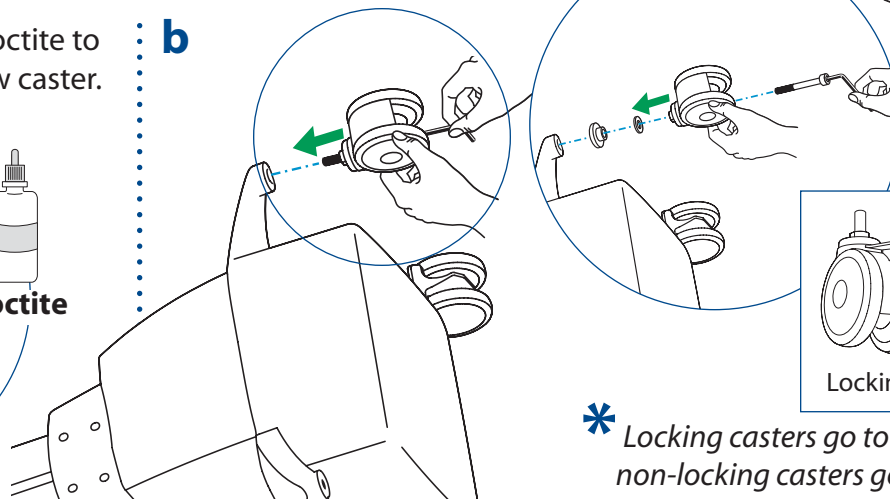

* Locking casters go to front of cart and non-locking casters go to back of cart.

8 Lift cart to upright position.

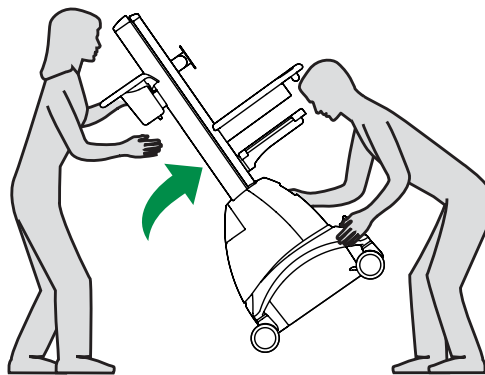
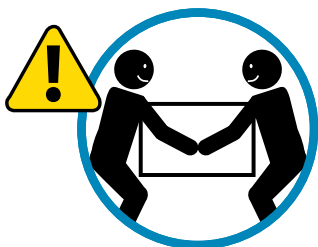

9 Mount equipment back on cart.

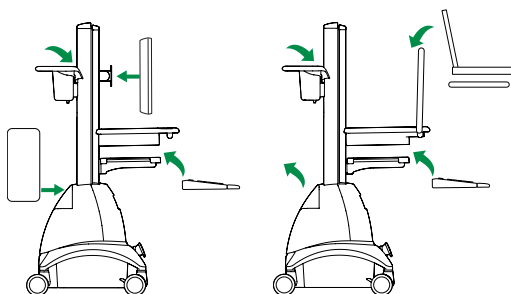

10 Remove temporary riser/tower anchors.

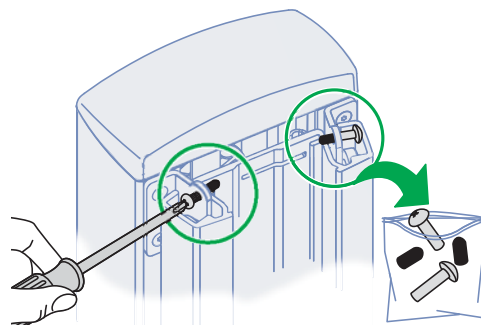

© 2006 Ergotron, Inc.
All rights reserved.

While Ergotron, Inc. makes every effort to provide accurate and complete information on the installation and use of its products, it will not be held liable for any editorial errors or omissions (including those made in the process of translation from English to another language), or for incidental, special or consequential damages of any nature resulting from furnishing this instruction and performance of equipment in connection with this instruction. Ergotron, Inc. reserves the right to make changes in the product design and/or product documentation without notification to its users. For the most current product information, or to know if this document is available in languages other than those herein, please contact Ergotron Customer Care at: 800-888-8458 or consult the Ergotron, Inc. website at: www.ergotron.com. No part of this publication may be reproduced, stored in a retrieval system, or transmitted in any form or by any means, electronic, mechanical, photocopying, recording or otherwise without the prior written consent of Ergotron, Inc., 1181 Trapp Road, Eagan, Minnesota, 55121, USA Patents Pending and Patented U.S. & Foreign. Ergotron is a registered trademark of Ergotron, Inc.