

SmartMount® Articulating Wall Arm

For 32" to 52" Flat Panel Screens



FLAT PANEL MOUNTS

1. Arm extends up to 27.43" (697 mm) from wall (including thickness of screen adapter)
2. Integrated Cable Management provides ample area to run cables to complete a professional and discrete installation
3. One-touch tilt allows adjustment of +15°/-5° without the use of tools
4. ±5° roll aid in screen leveling
5. Screen can be rotated from portrait to landscape without removing the screen
6. ±0.5" vertical adjustment for fine tuning screen position

Universal Models

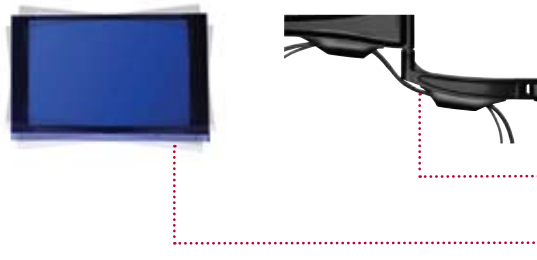
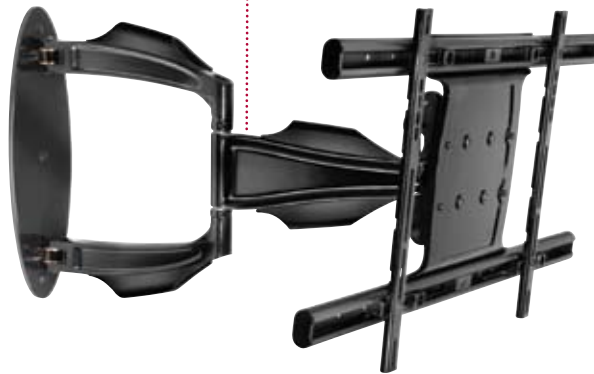

For expanded product information and technical data visit www.peerlessmounts.com

TECHNICAL DRAWINGS

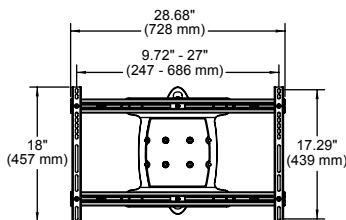

FRONT VIEW

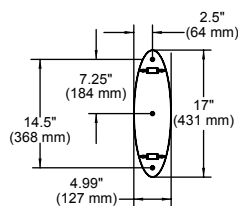

WALL PLATE DETAIL

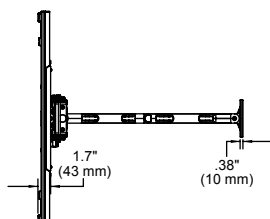

TOP VIEW

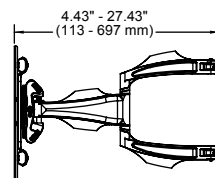

SIDE VIEW

MODELS

Universal Models:

Includes standard hardware (hex or Phillips) for attaching screen to mount

SA752PU High gloss black
SA752PU-S High gloss silver

Dedicated Models:

Includes standard hardware (hex or Phillips) for attaching screen to mount. Requires Screen Adapter to be Purchased Separately*

SA752P High gloss black

* Dedicated adapter plates come in flat black and include security fasteners

SCREEN ADAPTER



Mounting pattern

Universal Models: 27" W x 17.29" H
(686 x 439 mm)



VESA® pattern

Universal Models: up to 600 x 400 mm

Dedicated Models: Requires screen-specific PLP or LC adapter to be purchased separately

SPECIFICATIONS



Distance from wall

Universal Models: 4.43"-27.43" (113-697 mm)
Dedicated Models: 2.73"-25.73" (69-654 mm)



Tilt | Swivel | Roll

+15/-5° | ±90° | ±5°



Max load

90 lb (41 kg)

Product Dimensions (W x H x D)

Universal Models: 28.68" x 18" x 4.43"-27.43"
(728 x 457 x 113-697 mm)

Dedicated Models: 15.2" x 17" x 2.73"-25.73"
(386 x 431 x 69-654 mm)

Mounting Surfaces

Wood stud, concrete, cinder block and metal stud
(Metal stud accessory required)

Ship Weight

Universal Models: 90 lb (41 kg)

Dedicated Models: 85 lb (38 kg)

CERTIFICATIONS



RoHS

MADE IN USA

ACCESSORIES



ACC925:

Security Fasteners pg# 132



ACC415:

Metal Stud Accessory pg# 130

WSP752/753:

Metal Stud Wall Plates

Call Customer Care for more information

To verify mount compatibility with any LCD, plasma or projector model use MountFinder™ at www.peerlessmounts.com

CLICK: www.peerlessmounts.com

CALL: 800.865.2112

FAX: 708.865.2941