

Model **CMR415, CMR419** Suspended Ceiling Camera Mount is designed to support a small camera. This unit mounts easily on any exposed suspended ceiling grid.

Features:

- | Heavy gauge cold rolled steel construction.
- | Scratch resistant white fused epoxy finish.
- | 80° adjustable camera tilt.
- | 360° swivel action.

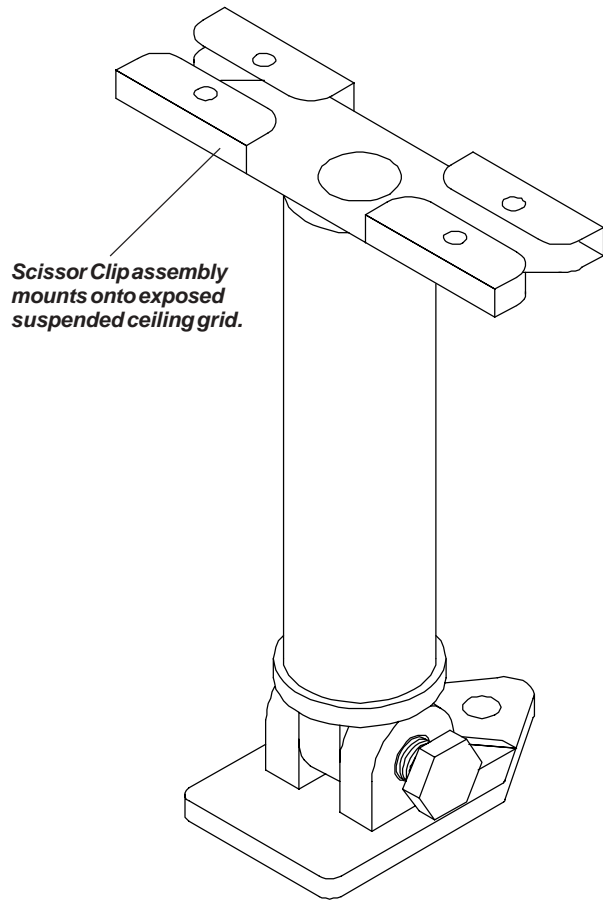

CMR415 - 5" (127)
CMR419 - 9" (229)

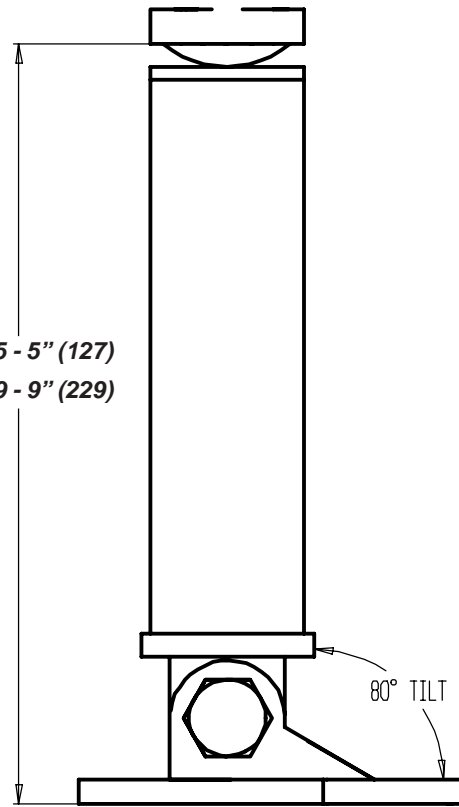

Side View

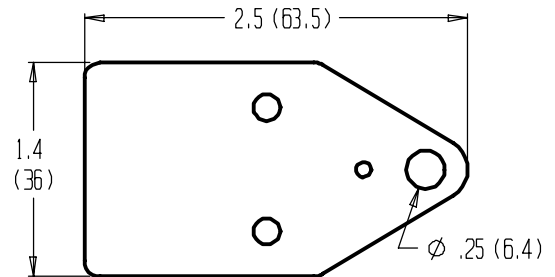

Bottom View

Maximum Weight Capacity: 10 lb (4.5 kg)		
Weight	*Shipping Weight	All dimensions - inch (mm) unless specified otherwise.
.5 lb (.23 kg)	1 lb (.5 kg)	

*Shipping weight based on single unit shipment.
 Per unit shipping weight may be less for bulk orders.

ARCHITECTS SPECIFICATIONS

The suspended ceiling camera mount shall be a Peerless model **CMR415, CMR419** mount and shall be mounted where indicated on the plans. The mount shall support a small camera, swivel 360° and provide 80° of adjustable tilt. It shall be constructed of heavy gauge cold rolled steel and Lexan plastic. The finish shall be scratch resistant white fused epoxy. Assembly and installation shall be done according to instructions provided by the manufacturer.



Peerless Industries, Inc. 3215 W. North Ave. Melrose Park, IL 60160
 708-865-8870 800-865-2112 Fax 708-865-2941 www.peerlessindustries.com

TECHNICAL DATA SHEET

Suspended Ceiling Camera Mount

Issued: 06-22-99 Sheet No. 124-9504-1 9-11-03 page 1 of 1