

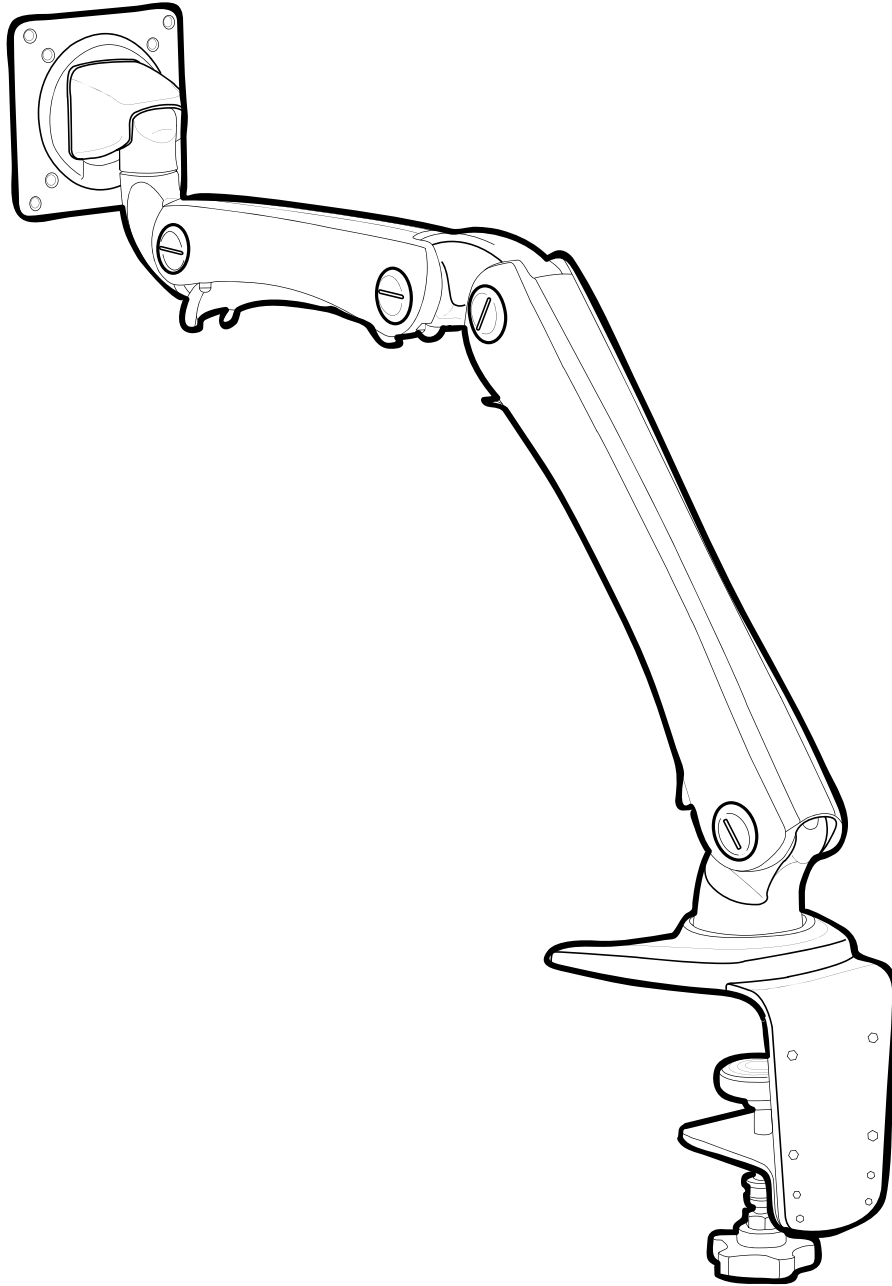

## **Installation and Assembly: Desktop Two-Link Arm for 15" to 24" LCD monitors**

---

**Models: LCT-A1B1C, LCT-A1B1H**



**Max Load Capacity: 17.6 lb (8 kg)**

**NOTE:** Read entire instruction sheet before you start installation and assembly.

## **⚠ WARNING**

- Do not begin to install your Peerless product until you have read and understood the instructions and warnings contained in this Installation Sheet. If you have any questions regarding any of the instructions or warnings, please call Peerless customer care at 1-800-865-2112.
- This product should only be installed by someone of good mechanical aptitude, has experience with basic building construction, and fully understands these instructions.
- Make sure that the supporting surface will safely support the combined load of the equipment and all attached hardware and components.
- Never exceed the Maximum Load Capacity. See page one.
- Always use an assistant or mechanical lifting equipment to safely lift and position equipment.
- Tighten screws firmly, but do not overtighten. Overtightening can damage the items, greatly reducing their holding power.
- Be sure to use designated fasteners and tools to assemble product. If correct fasteners and tools are not used, product may fail.
- When using clamp mounted product do not install arm until clamp is securely attached to mounting surface.
- When a monitor is not attached to arm assembly, arm may swing upward and cause harm to you or damage to product.

## **Table of Contents**

Parts List.....	3
Installation to Mounting Surface .....	4
Installation to Screen .....	5
Control Bolt Tension Adjustment.....	6
Cable Management .....	6

*For customer care call (800) 865-2112 or (708) 865-8870.*

Before you begin, make sure all parts shown are included with your product.

## Parts List

Description	LCT-A1B1C	LCT-A1B1H
	Qty	Qty
<b>A</b> arm assembly	1	1
<b>B</b> small screen screw	4	4
<b>C</b> large screen screw	4	4
<b>D</b> 4 mm wrench	1	1
<b>E</b> bolt	-	1
<b>F</b> spring washer	-	1
<b>G</b> flat washer	-	1
<b>H</b> bottom washer	-	1
<b>I</b> 8 mm wrench	-	1

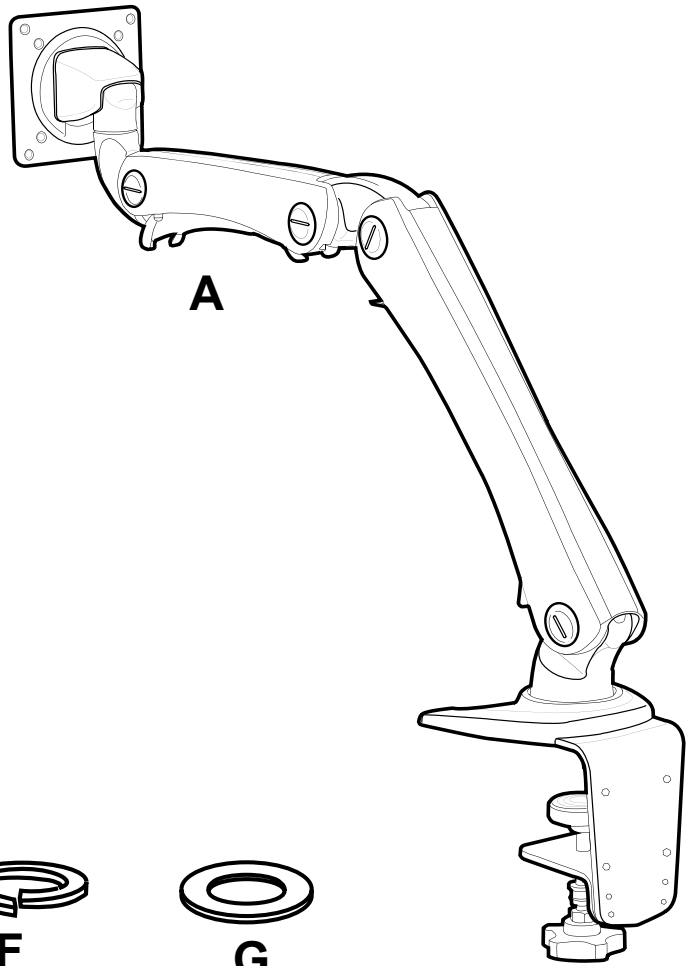

Parts may appear slightly different than illustrated.

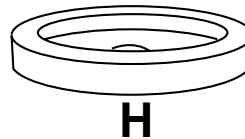
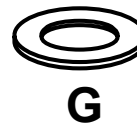
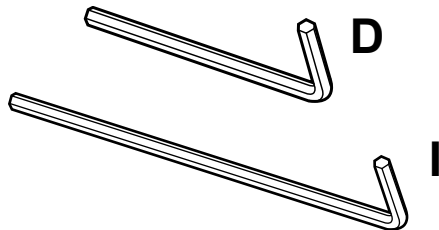
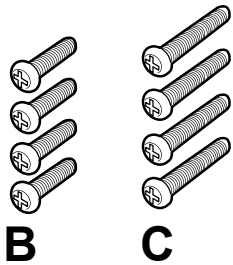

## Clamp Installation Method

- 1** **NOTE:** Do not remove safety band until installation is complete.  
Arm assembly (A) can be mounted to mounting surface with a thickness of 1/3" - 3.5" (10 - 89 mm). Insert the clamp onto mounting surface as shown below.

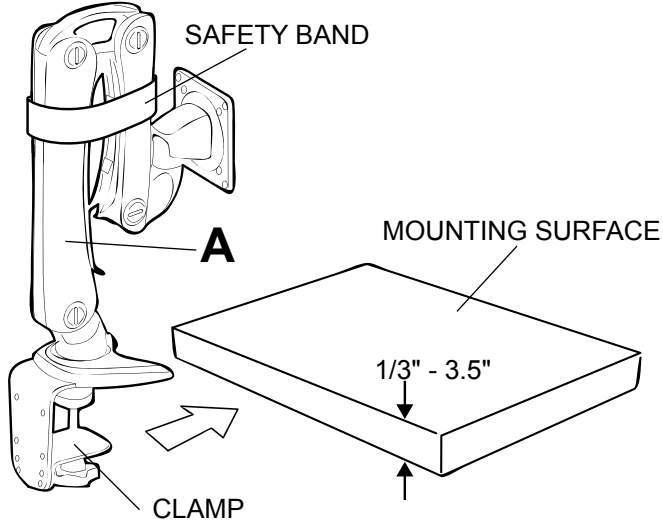

- 1-1** Turn handle to tighten arm assembly (A) to mounting surface until firmly attached.

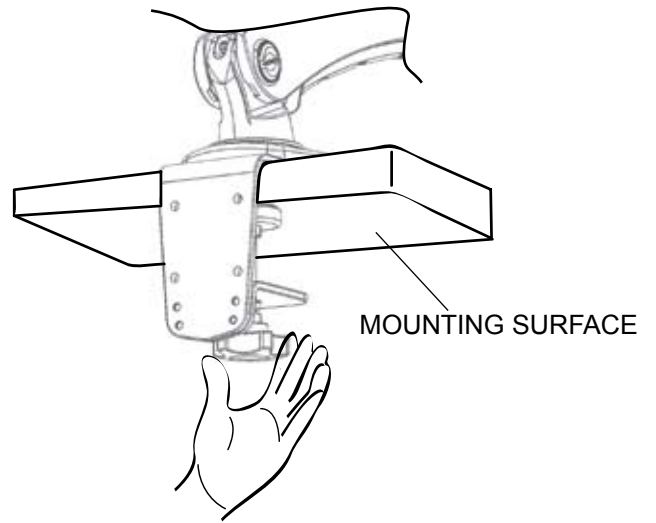

## Hole Installation Method

- 2** Drill .5" (13 mm) hole into mounting surface. Place pipe assembly (A) onto mounting surface and secure using one bolt (E), one spring washer (F), one flat washer (G), and one bottom washer (H) as shown in figure 1.1. Tighten bolt (E) using 8 mm wrench (I) as shown in figure 1.2.

**NOTE:** Be sure fasteners and washers are assembled in correct order as shown in detail 1.

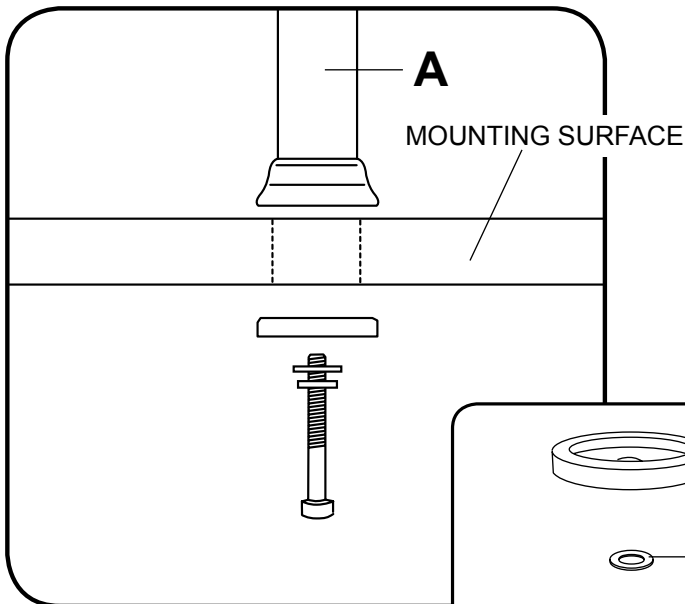
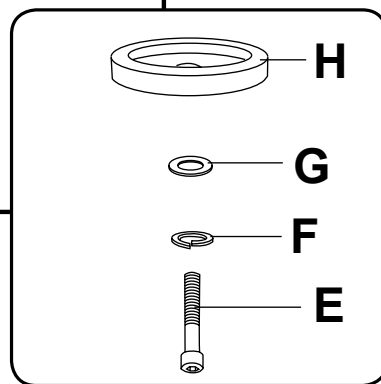

fig. 1.1



DETAIL 1

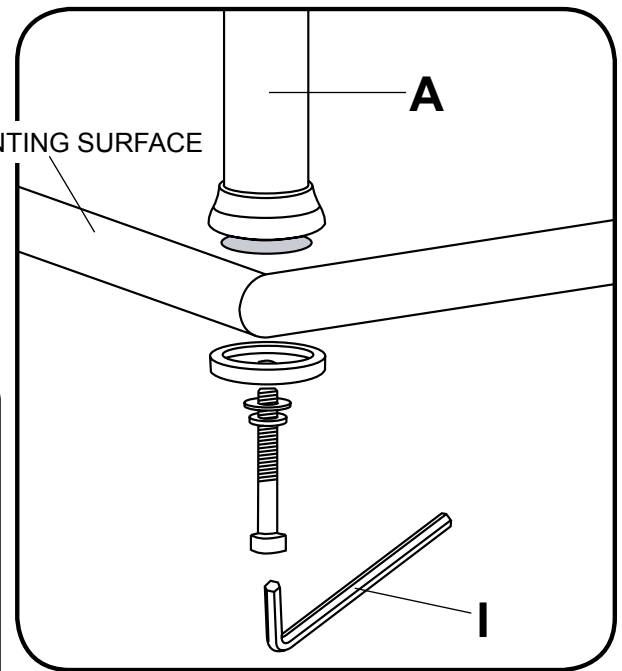
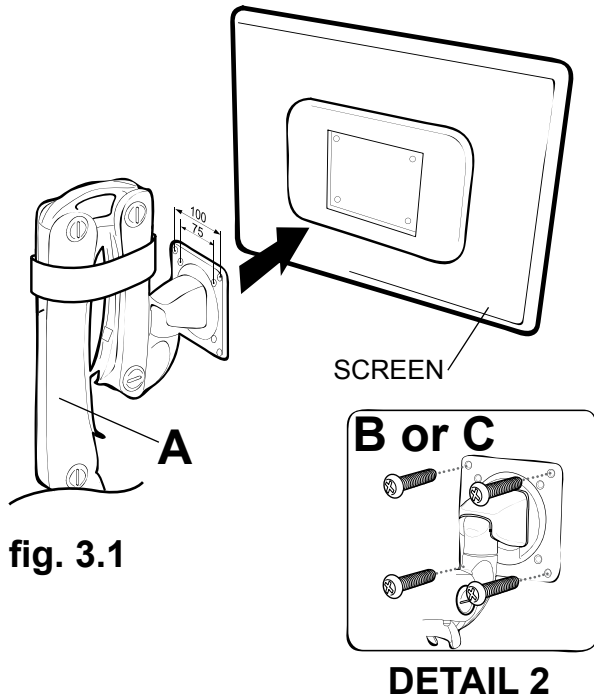

fig. 1.2

## Installation to Screen

- 3** Attach front of arm assembly (**A**) to back of screen with four screws (**B or C**) as shown in detail 2 using VESA 75 or VESA 100 mounting pattern as shown in figure 3.1.



- 3-1** When screws (**B or C**) are securely fastened to arm assembly (**A**), remove safety band.

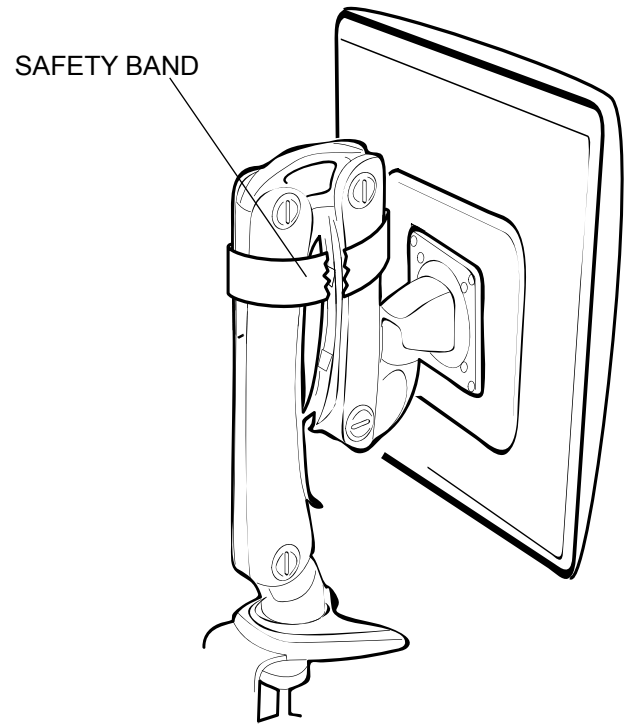

## Control Bolt Tension Adjustment

**4** **NOTE:** This product is factory set for a 19" (483 mm) monitor. When changing the size of the monitor, adjust the control bolt with M4 wrench as shown in figure 4.1.

Adjust control bolt at top of arm assembly (**A**) with M4 wrench (**D**) as shown in figure 4.2.

Bend upper arm to access control bolt cover. Remove control bolt cover and adjust control bolt with M4 wrench (**D**) as shown in figure 4.3.

Bend lower arm to access control bolt. Adjust control bolt with M4 wrench (**D**) as shown in figure 4.4.

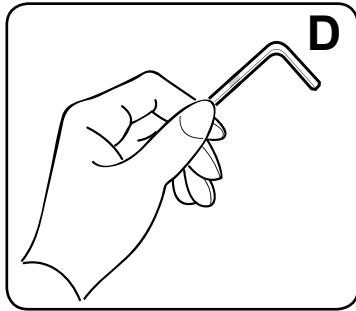

fig. 4.1

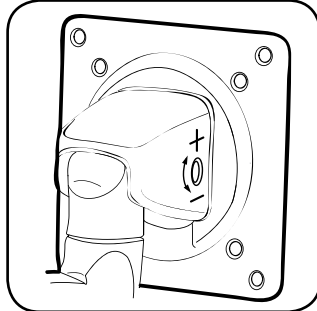

fig. 4.2

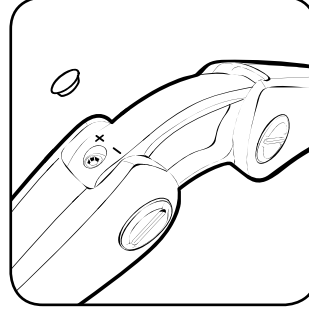

fig. 4.3

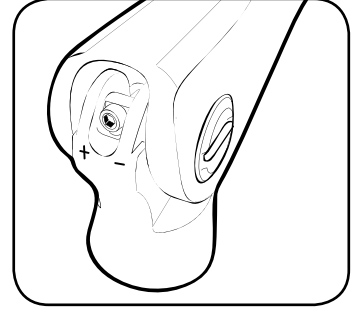
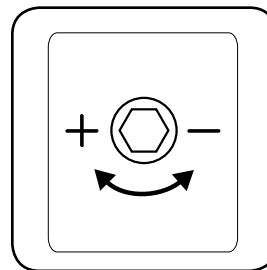

fig. 4.4

### CAUTION

- Be careful not to pinch fingers when adjusting arms of arm assembly (**A**).



#### NOTES:

- Turn control bolt clockwise (+) to adjust for weight greater than 8.8 lbs (4 kg).
- Turn control bolt counter-clockwise (-) to adjust for weight less than 8.8 lbs (4 kg).

## Cable Management

**5** Insert cable into cable guide of arm assembly (**A**).  
Open gap to press fit cable as shown in detail 3.

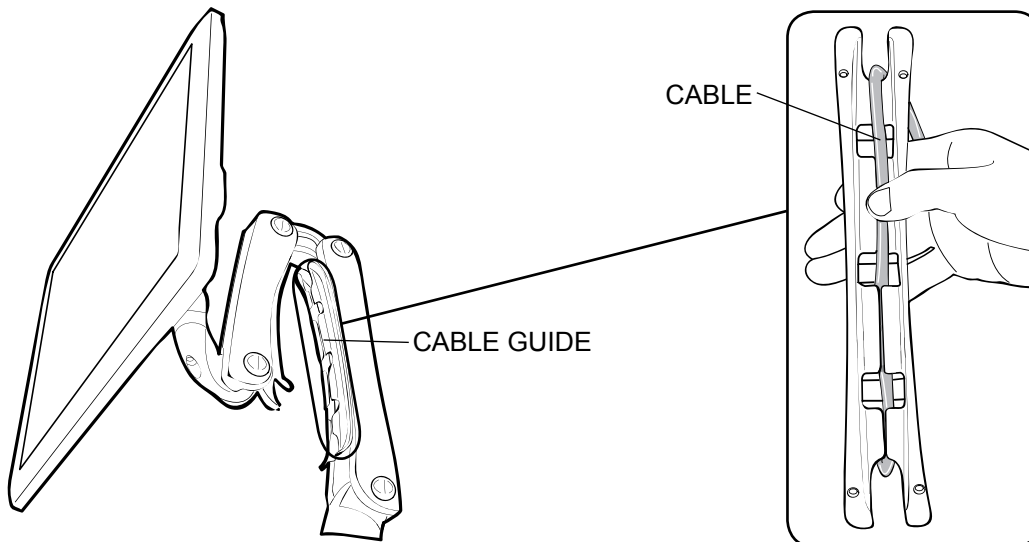

DETAIL 3