

Components at a Glance



Front of Cabinet (closed)

1. Locking front door to User area.
2. Locking door latch w/padlock bracket.
3. Feet (for countertop installation)



Front of Cabinet (open)

4. Lock mechanism
5. Bay dividers with Cable Channels
6. Laptop cubby for host computer

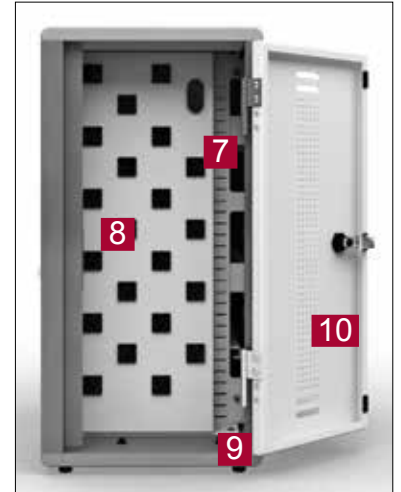

Side of Cabinet (open)

7. Cord pass-through from front of cabinet
8. Center divider with power outlets
9. Power cord access
10. Locking side door to IT area

This Cabinet is designed to automatically charge and store tablet, smart phone, and hand-held devices safely and efficiently. This cabinet supports 1-20 devices. Please review this manual before installing your equipment to learn how to use the cabinet safely.

The cabinet is listed to UL Information Technology Equipment 60950-1 safety standard.

AC input: 120VAC 60 Hz. Max amps: 12A.

Table of Contents

Getting Started	2
Safety Notices	2
Installing the Cabinet	3
Loading Devices	6
Troubleshooting Guide ..	7
Warranty	8

 www.ergotron.com

 **USA 1-800-325-3841**

For the latest User Installation Guide please visit: www.ergotron.com

Getting Started

Important Safeguards - We want you to be safe!

These cabinets are electrical devices. Use care with them and follow these important safeguards:

- Electrical devices are not toys. Children are often unaware of the hazards associated with electrical devices, so this unit must always be used by adults or with adult supervision.
- Do not use this unit outdoors.
- Liquids should not be stored in, set on or placed inside this unit.
- Never unplug this product from the outlet when your hands are wet.
- Set the power switch to the down OFF position before you unplug the unit from the wall, plug the unit into the wall, or plug in devices.
- Be careful with the power cord. Do not jam the power cord against sharp edges. Do not use the unit if the cord appears to be damaged or if the ground prong is missing. When the unit is not plugged in, wrap the power cord and store in the IT area.
- Do not use an extension cord with this unit.
- Inadequate repair can create significant hazards to users and is not covered by the warranty. Repairs should always be performed by a qualified electrician.

Electrical Testing

- Before using your new charging cabinet, have a qualified electrician verify the current draw does not exceed the rating of the unit when all the devices are installed.
- Test the contact integrity of the wall outlet using a receptacle tension tester such as a Woodhead 1760 or a Safeplug 1700.
- Test the branch circuit for ground integrity and branch circuit protection.
- Do not plug in the unit if the switch, receptacles, or power cord have been damaged or if the ground prong is missing from the plug. If repairs are ever needed, they should be performed by a qualified electrician.

Doors and Locks

The front doors on each cabinet feature a two-point keyed locking system to protect your devices. To open a door, lift the bottom of the handle and rotate it to the inside of the unit. Your unit shipped with 2 keys. Contact Customer Care for replacements.

For added security, each front door features a padlock bracket to hold your own padlock. When installed, your padlock restricts access to the handle so the unit can't be opened.



Installing the Cabinet

STEP 1

Select the Mounting Location and Method

- When choosing the right place to install your cabinet, be sure to check the location of your power source. The power cord that comes with your cabinet is 10 ft long.
- Your cabinet can be wall-mounted to wood wall studs or drywall, or bolt it to a countertop. If you're installing to wood wall studs, go to Step 2. If you're installing into drywall, go to Step 3. If you're bolting to a countertop, go to Step 4. The cabinet also comes with cushioned feet; use them if you're placing your cabinet on a flat surface. See Step 5 for installation instructions.
- *NOTE: Your Yes Cabinet for Tablets can be mounted to other surfaces (like concrete or brick), and this work should be done by a qualified contractor.*

STEP 2

Wall-mount to Wood Wall Studs

This is a two-person step.

- Determine the installation point for your cabinet. Using a stud finder, locate the studs. While one person holds the cabinet frame up to the wall at the desired height, the other marks the height of the top of the cabinet. Measure down 1-1/2" along the studs to determine the position of the screws and mark where the screws will go. Use a level to make sure the marks are level.
- Using a 1/8" drill bit, drill one hole in a stud about 1-1/2" deep. How do you make sure that hole is 1-1/2" deep? Measure that length on your drill bit and mark it with a piece of masking tape. Stop drilling when you reach the masking tape. Repeat for the second screw.
- Using a Phillips driver (or a power driver with a Phillips bit), attach the first 1-5/8" long screw at that mounting point, but don't tighten all the way to the wall. Stop tightening when the screw head is about 1/4" away from wall.
- Lift the cabinet onto the wall. Mark the screw position of the lower screws. Remove the cabinet, drill the lower holes, and install the lower screws. Lift the cabinet into place and tighten all four screws.

-  1-5/8" Screw
325-5086-00

Wall Stud Profile

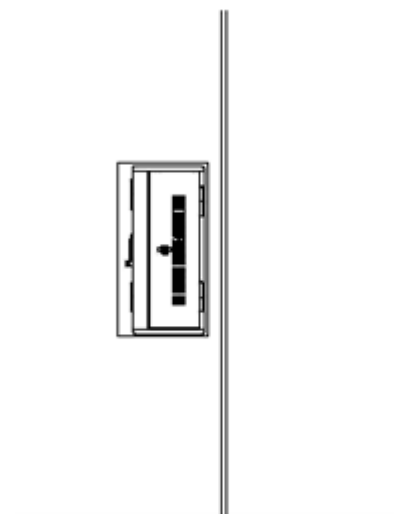
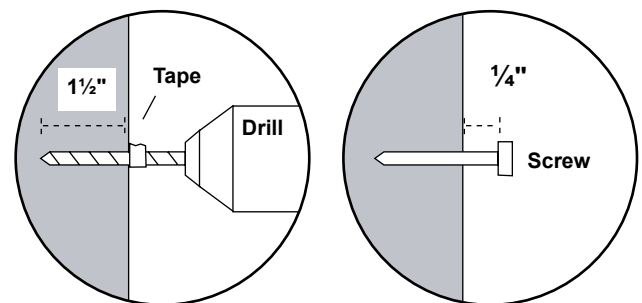

Go to Step 6.

STEP 3

Wall-mount to Drywall

- Determine the installation point for your cabinet. While one person holds the cabinet frame up to the wall at the desired height, the other marks the height of the top of the cabinet. Measure down 1-1/2" to determine the position of the screws and mark where the screws will go. Use a level to make sure the marks are level.
- Drill 1/2" diameter hole at the mounting point.
- Insert a TOGGLER into one hole, metal end first.
- Pull the plastic ring end so the metal channel rests flush behind the wall. With your other hand, slide the plastic cap along the straps until the flange of the cap is flush with the wall.
- Place your thumb between the plastic straps. Push side to side, snapping off the straps at the wall.
- Insert a 1-5/8" long screw into the TOGGLER, but don't tighten all the way. Leave the bolt head about 1/4" from the plastic cap.
- Repeat for the second TOGGLER.
- Lift the cabinet onto the wall. Mark the screw position of the lower screws. Remove the cabinet and install the lower TOGGLERS. Lift the cabinet into place and tighten all four screws.

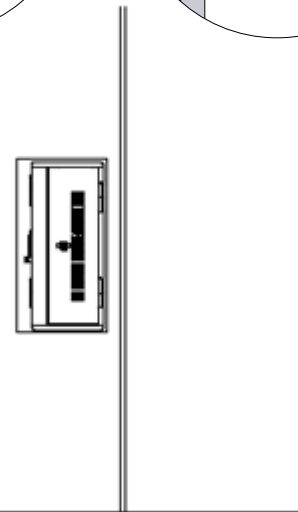
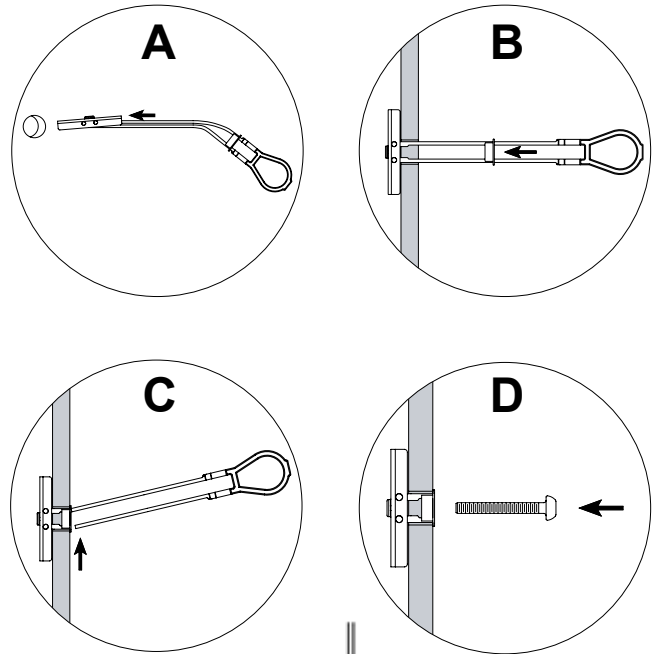

Go to Step 6.

STEP 4

Bolt-through Installation to Countertop

- Pre-drill a 1/4" dia hole in your countertop or shelf.
- Using a box knife, slice through the membrane covering the pre-drilled holes on the bottom of the cabinet.
- Slide the 3.5" bolt through the washer, through the bottom of the cabinet, through the countertop, and capture with the 325-5259-00 nut.

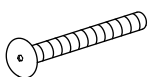

3.5" Bolt
325-5657-00



5/8" Washer
325-5379-00



1/4-20 Nylock Nuts
325-5259-00

Go to Step 6.

STEP 5

Install Feet

- Stick a 3/4" wood screw through each rubber bumper (581-5063-00).
- Locate the four pre-drilled holes on the bottom of the cabinet, one in each corner. Using the Anthro driver, attach each foot to the cabinet.

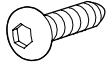

3/4" Button Hd PB Screw
325-5575-00

STEP 6

Install the Bay Labels and Route Cables

- Your cabinet comes with labels for numbering the bays in your cabinet. Line up each label with the front face of the bay shelf, peel of the backer, and affix the label.
- Starting at the far left-hand side of each shelf, route one cord through the channel at the top of the divider. The right-hand divider on each shelf will not have a cord. Make sure the cord end that goes into the device is at the front of the cart and the power end goes through the back panel and into the IT area. Leave enough slack in front so users have enough cord to easily plug into the device without straining the cord. To quickly measure an adequate length, use the height of the divider as a measuring stick.
- The open area at the bottom of the cabinet is designed to hold a teacher laptop. Use the small cable clips provided to route its cord to the back of the cabinet and into the side IT area.
- In the IT area, plug in each power adapter, then connect each cord to an adapter. Use the cable ties to organize cables.
- Turn the power to the OFF position before plugging the cabinet into the wall.

Loading Devices, Cable Management

In the front User area of the cabinet

- Check that the vertical spacing of the shelves fits your devices. To adjust shelf height, the Anthro driver to loosen (not remove) the 2 screws that attach the left side of the shelf. Lift the left side off the screws and pull the shelf to the left to free the tabs on the right. Set aside the shelf. Remove and reinstall the screws and shelf at the desired height. [Image A]
- Check the position of the Cable Comb located at the back of the shelf. Is it at the right height? If not, reposition it! Remove the two fasteners on the left side using the Anthro driver and set them aside. Lift the left side of the comb and pull the piece to the left to free the tabs on the right. Reinstall the screws at the desired height, then reinstall the comb.
- Check that the horizontal spacing of the bay dividers fits your devices and cases. To move the dividers and adjust the bay width, press back on the divider tab under the shelf that connects the divider to the shelf until the divider pops free. If your fingers don't fit, try a flat-head screwdriver. To install the divider, angle the divider into a slot at the back of the shelf, then tilt the divider into place at the front of the shelf. [Image B] Number each bay with the provided labels.



- To route the cords, route one charging cord along the top of each divider. Make sure that the cord end that goes into the device is at the front of the bay and the power end goes through the center panel and into the IT area.
- Leave enough slack in front (approximately 4.5"; use the height of the divider as a measuring stick) so users can plug in the device without straining the cord. [Image C]
- Weave the cord around the short hook at the front of the divider, then back and forth through the three long channels along the top of the divider, including the center channel that's lower than the others, and finally through the short hook at the back of the divider. [Image D and E]



In the side IT area of the cabinet

- Plug in each power adapter, then use Cable Ties provided to organize excess cord length. [Image F]
- A great technique for coiling cables is to wind them around two fingers before securing them in the cable ties. Be sure to leave enough slack in your cord so it can plug into the adapter.
- Turn the power switch to the OFF position before plugging the cabinet into the wall. [Image G]
- Route the power cable through the mouse hole on the inside edge of the cabinet to feed the cord down to a power outlet below the cabinet or inside the wall. [Image H]

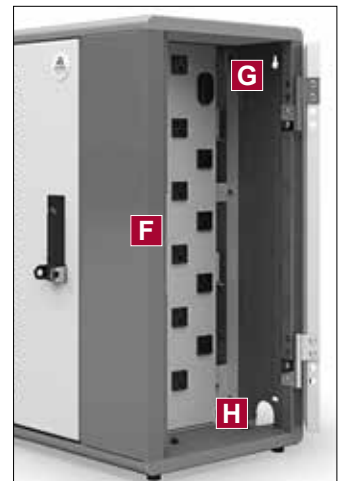

CONGRATULATIONS! YOUR CABINET ASSEMBLY IS COMPLETE!

Troubleshooting Guide

How do I know if my devices will draw more than the allowed current?

Have a qualified electrician verify the unit's current draw. Perform this test with devices installed and batteries discharged.

The devices are all plugged in, but they won't charge. What do I do?

First, check the cabinet: With the switch in the down OFF position, inspect the main power cord and plug to make sure that they're undamaged. Plug the cord into a working power outlet. Next, check the devices: Verify that each device is connected to its power adapter and that each brick is plugged into the power column. Move the switch to the up ON position to direct power to the devices. Still need some help? Contact Customer Care for assistance.

Someone tried to break into the unit and damaged a door. Can it be replaced?

Yes, you can order a replacement. Contact Customer Care. We'll ask you for the model number of your unit and whether it's for the front or side of the unit.

My power cord/plug is damaged. Is it covered under warranty?

For warranty information visit: www.ergotron.com/warranty

When I plug in the unit it trips the circuit breaker. What is wrong?

The cabinets are designed to run on a 15 amp circuit. If you have other equipment or appliances plugged into the same circuit you may be overloading it. Have a qualified electrician check that adequate power is available in the circuit.

My unit was damaged during shipment. What should I do?

Please contact Customer Care and we'll work with you.

How do I find the unit's serial number?

The serial number label is located inside the IT area near the base.

Can I remove a bay divider?

Yes! Locate the tab at the base of the front of the divider. Place a piece of masking tape on the shelf in front of the tab to protect the shelf's finish, then carefully and gently pry up the tab using a narrow flat-head screwdriver.



For Warranty visit: www.ergotron.com/warranty

For Service visit: www.ergotron.com

For local customer care phone numbers visit: <http://contact.ergotron.com>

Americas Sales and Corporate Headquarters

1181 Trapp Rd.
St. Paul, MN USA
1-800-325-3841
www.ergotron.com
sales@ergotron.com

ERGOTRON[®]



While Ergotron, Inc. makes every effort to provide accurate and complete information on the installation and use of its products, it will not be held liable for any editorial errors or omissions (including those made in the process of translation from English to another language), or for incidental, special or consequential damages of any nature resulting from furnishing this instruction and performance of equipment in connection with this instruction. Ergotron, Inc. reserves the right to make changes in the product design and/or product documentation without notification to its users. For the most current product information, or to know if this document is available in languages other than those herein, please contact Ergotron. No part of this publication may be reproduced, stored in a retrieval system, or transmitted in any form or by any means, electronic, mechanical, photocopying, recording or otherwise without the prior written consent of Ergotron, Inc., 1181 Trapp Road, Eagan, Minnesota, 55121, USA. Patents Pending and Patented U.S. & Foreign. Ergotron is a registered trademark of Ergotron, Inc.

© 2016 Ergotron, Inc. All rights reserved.

All trademarks are the property of their respective companies. Anthro is a registered trademark and brand of Ergotron Inc. Anthro-DNA is a trademark of Ergotron Inc.