

130-D16-B01 DESK STAND
130-C16-B01 CLAMP MOUNT

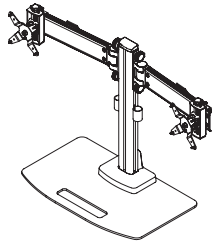

130-D16-B02 DESK STAND
130-C16-B02 CLAMP MOUNT

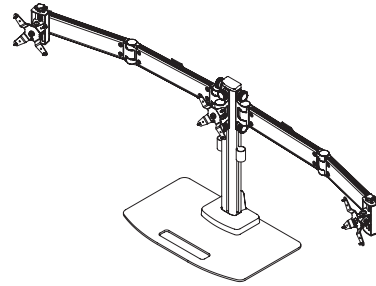

130-D16-B03-TW DESK STAND
130-C16-B03-TW CLAMP MOUNT

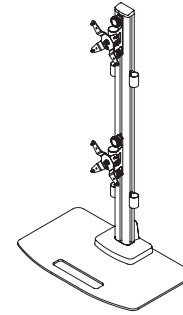

130-D28-B11 DESK STAND
130-C28-B11 CLAMP MOUNT

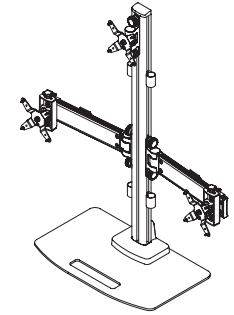

130-D28-B12 DESK STAND
130-C28-B12 CLAMP MOUNT

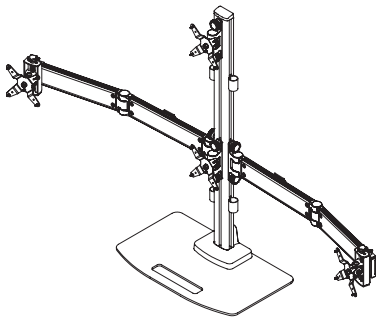

130-D28-B13 DESK STAND
130-C28-B13 CLAMP MOUNT

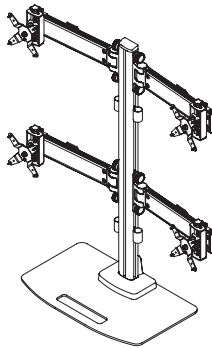

130-D28-B22 DESK STAND
130-C28-B22 CLAMP MOUNT

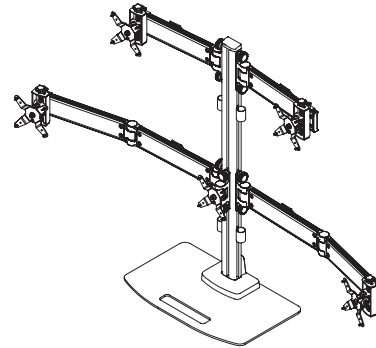

130-D28-B23 DESK STAND
130-C28-B23 CLAMP MOUNT

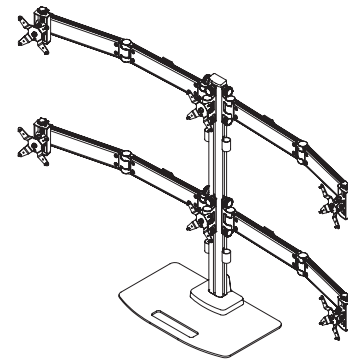

130-D28-B33 DESK STAND
130-C28-B33 CLAMP MOUNT

130 SERIES™

Parts List

130-D16-B01 / 130-C16-B01

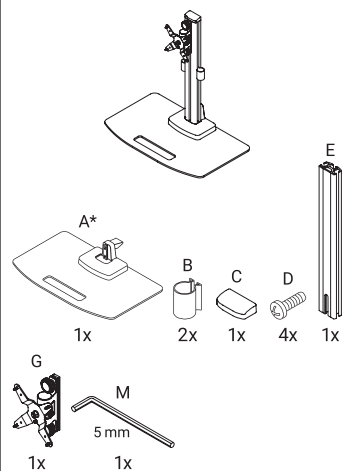

130-D16-B02 / 130-C16-B02

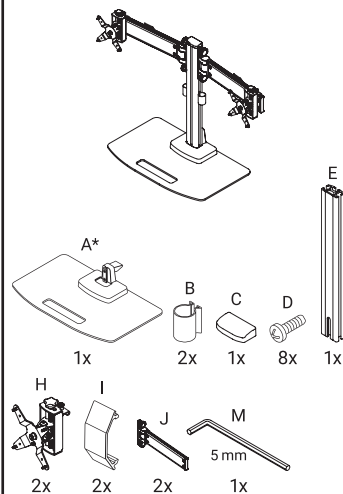

130-D16-B03-TW / 130-C16-B03-TW

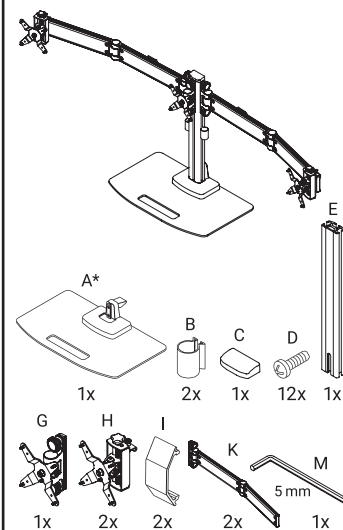

130-D28-B11 / 130-C28-B11

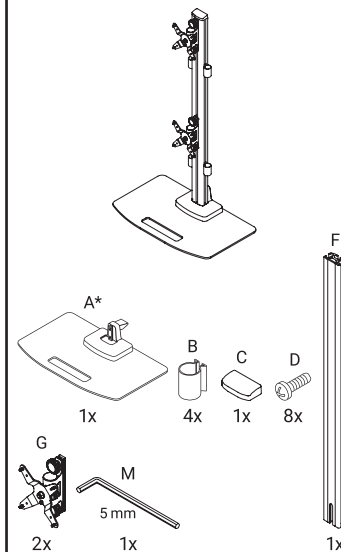

130-D28-B12 / 130-C28-B12

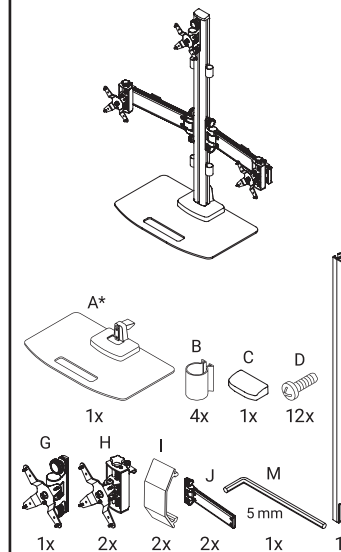

130-D28-B13 / 130-C28-B13

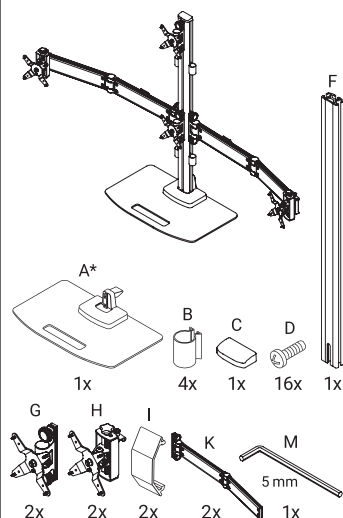

130-D28-B22 / 130-C28-B22

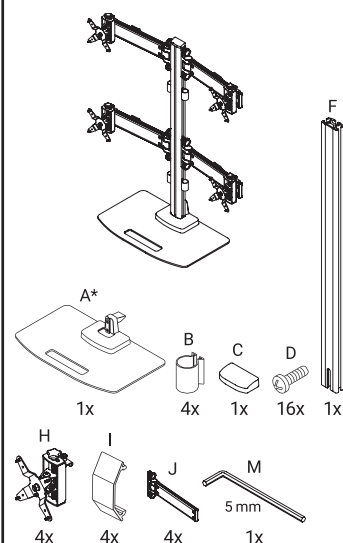

130-D28-B23 / 130-C28-B23

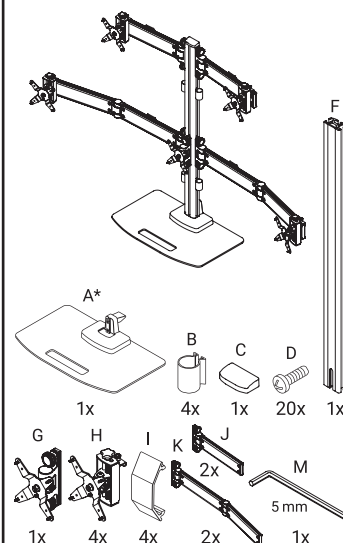

130-D28-B33 / 130-C28-B23

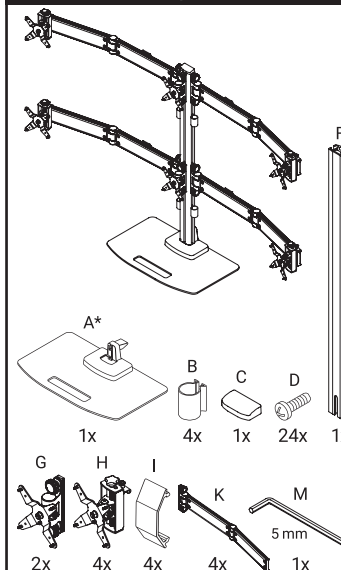

* CLAMP MOUNT
MODELS INCLUDE PART L
AND NOT PART A:

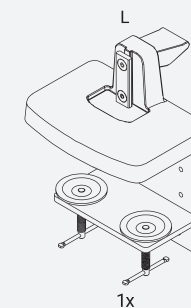

1a | ATTACH COLUMN TO DESK STAND

A

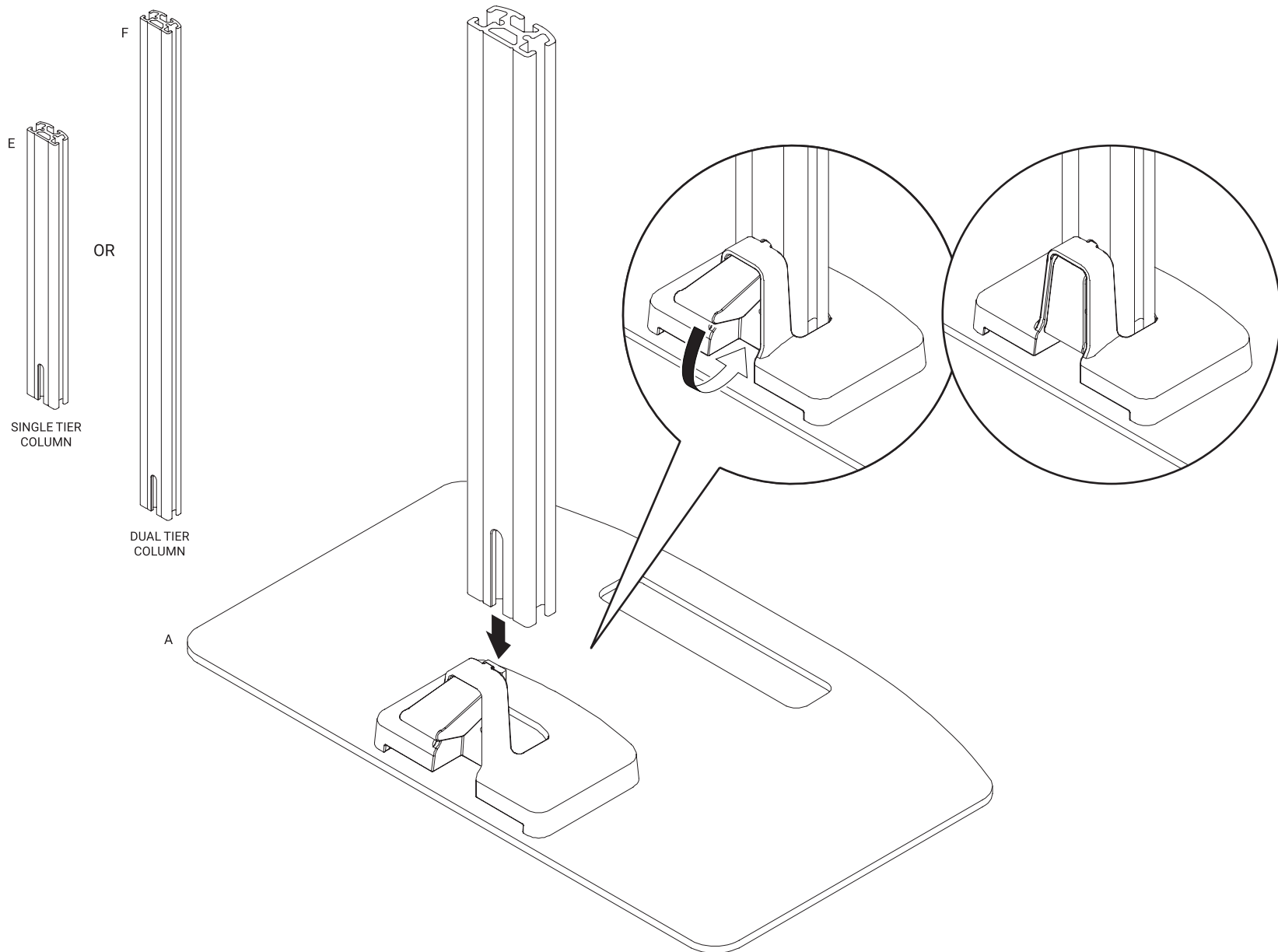

1b | ATTACH COLUMN TO CLAMP MOUNT

A

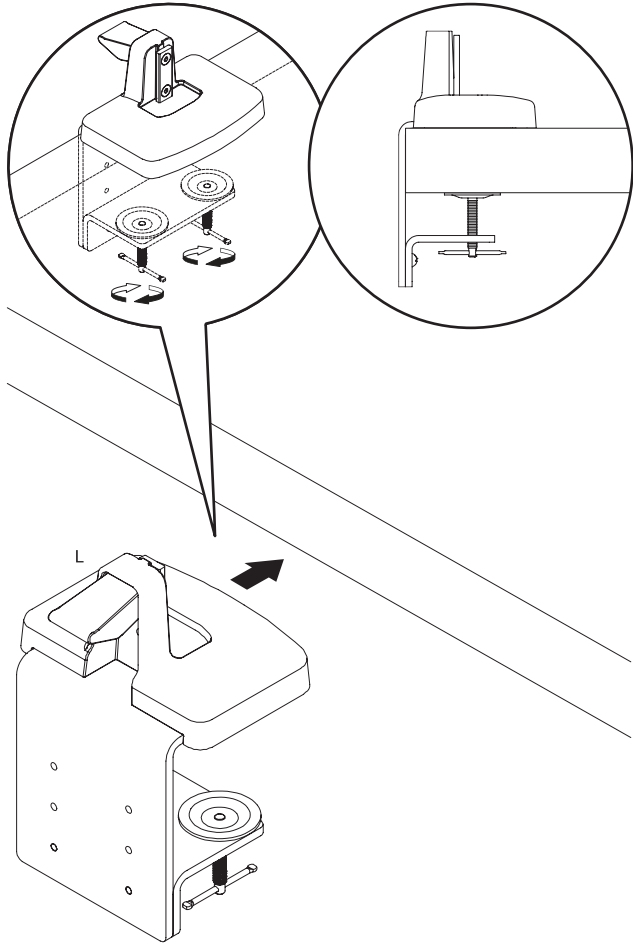

The clamp mount can be reconfigured to three different settings to accommodate a variety of desk thicknesses.

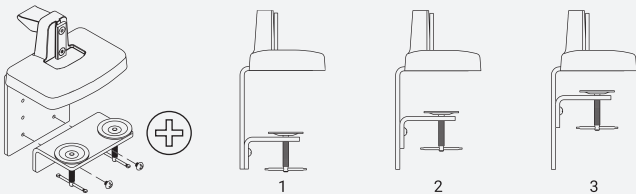

B

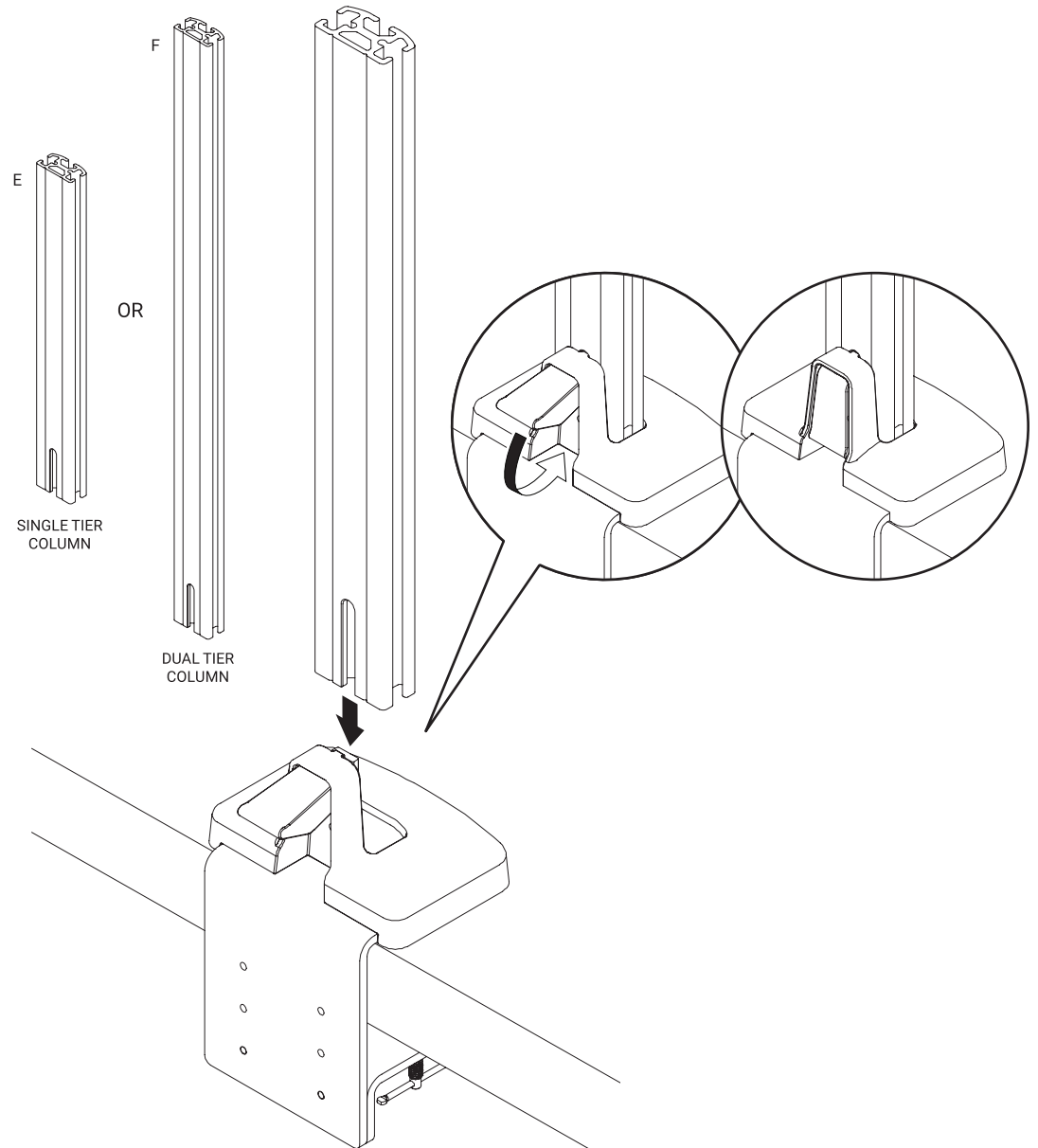

2 | ATTACH PIVOT TO COLUMN

A

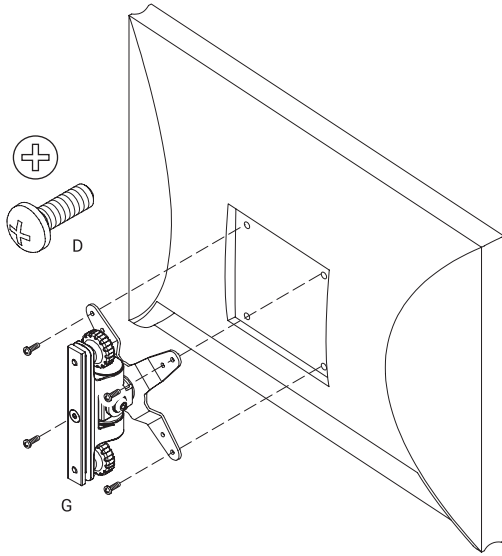

B

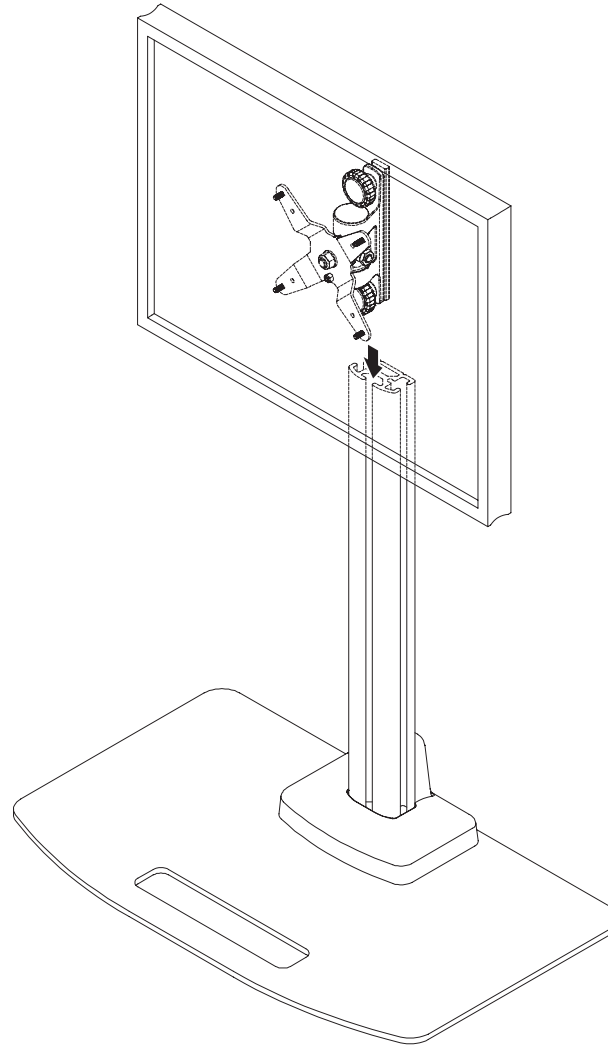

C

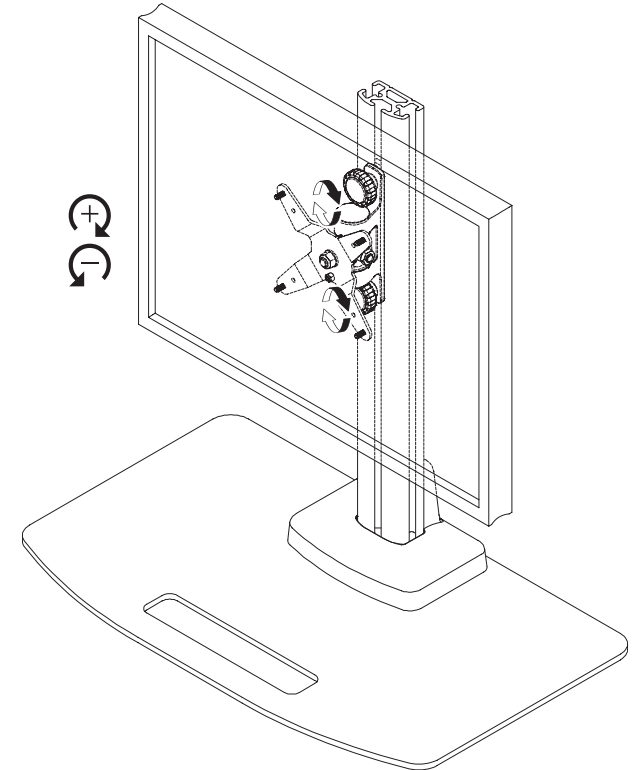

3 | ATTACH WINGS

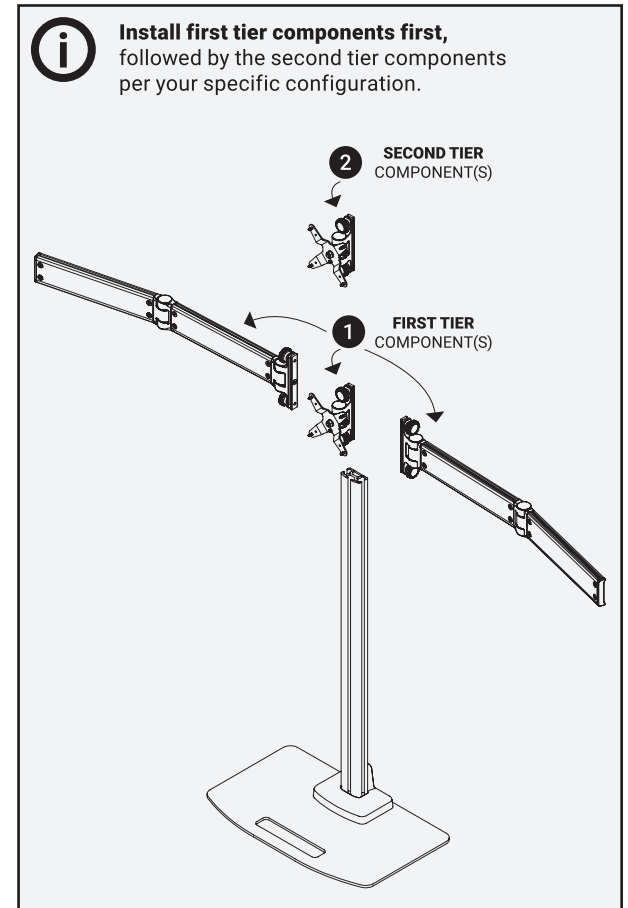
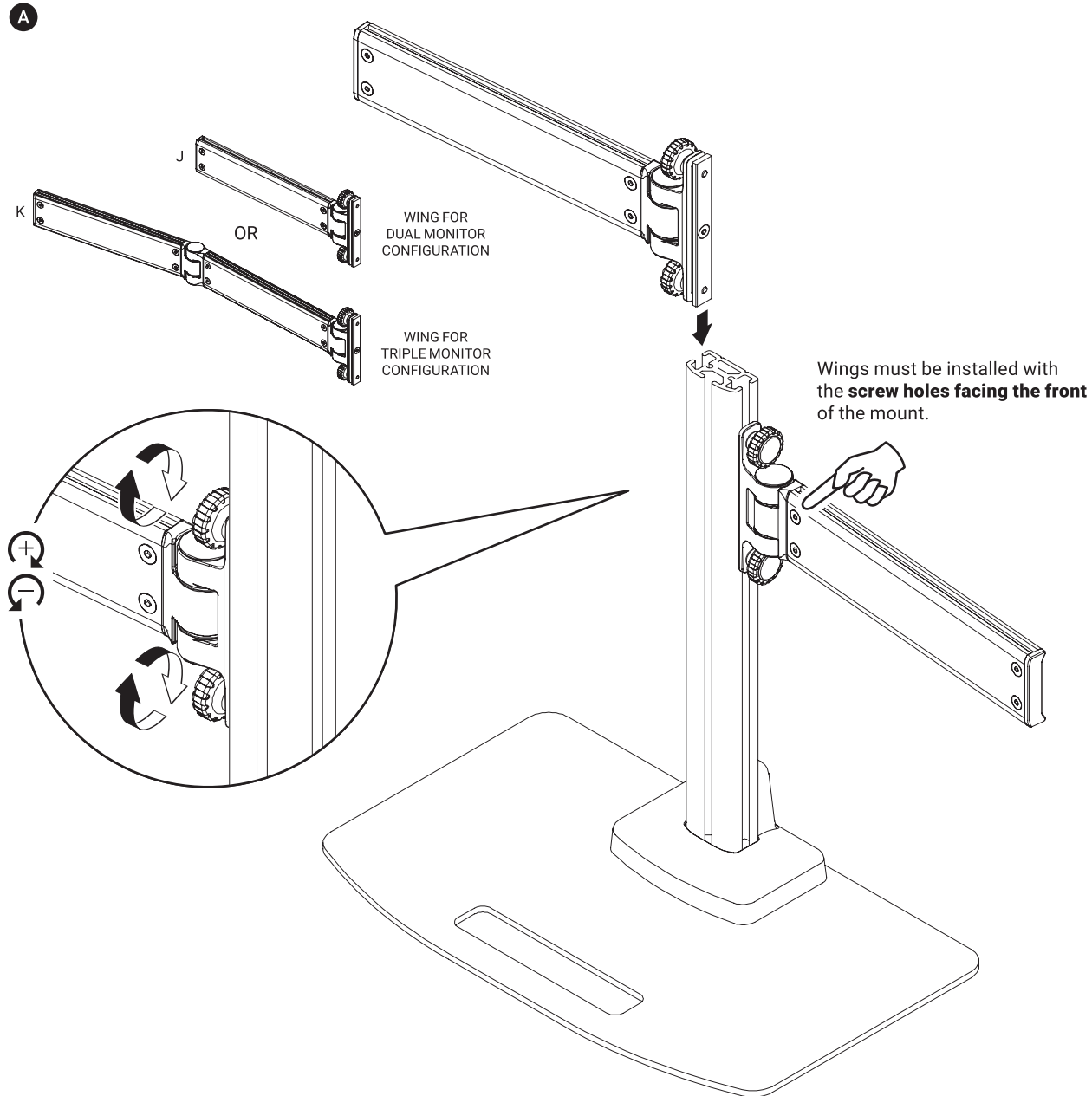

4 | ATTACH PIVOT TO WING

A

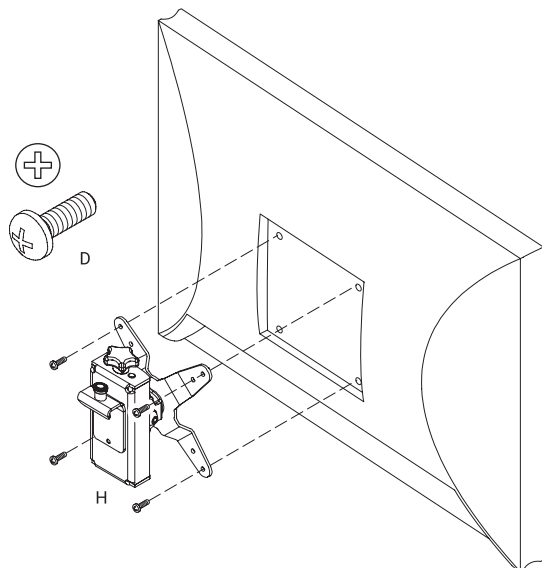

B

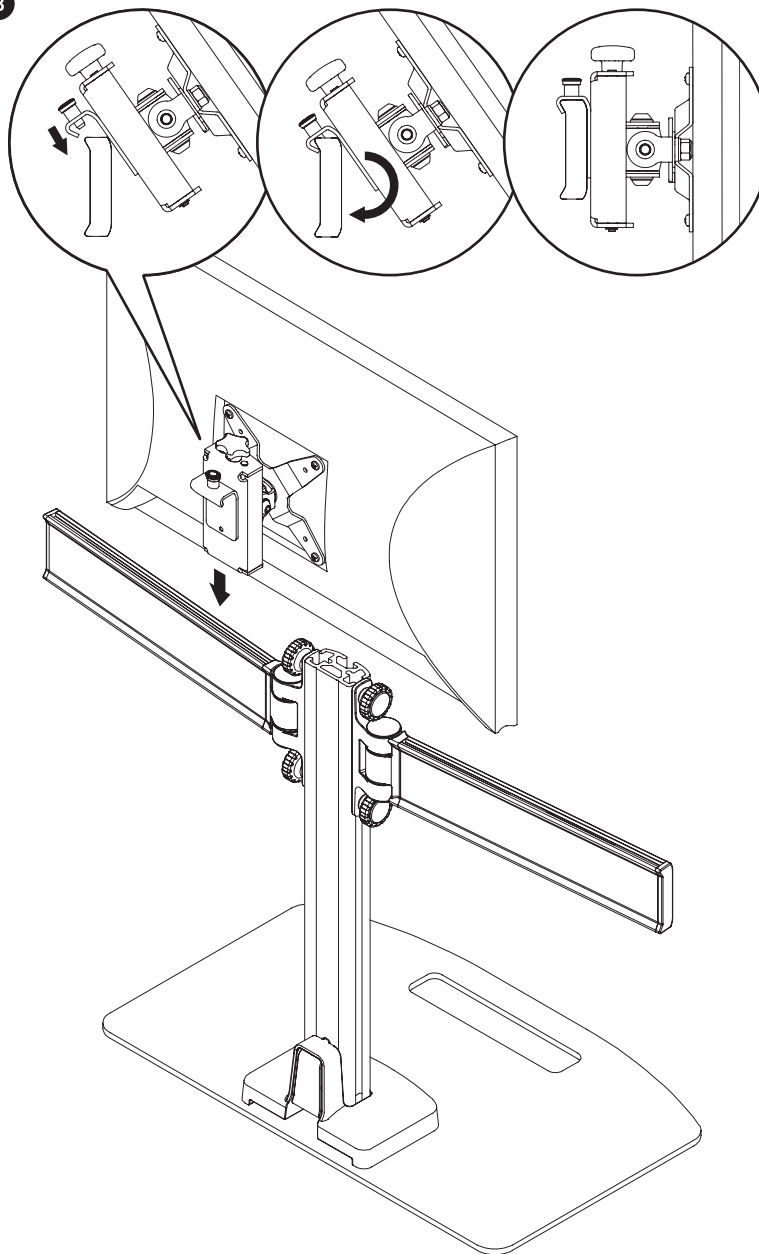

Optional Pivot Adjustments

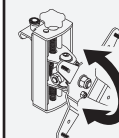

Tilt Adjustment

Tilt friction can be loosened or tightened by adjusting the 5mm hex key on the side of the pivot. Secure the nut (13mm), located on the opposite side of the pivot, while adjusting hex screw.

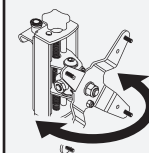
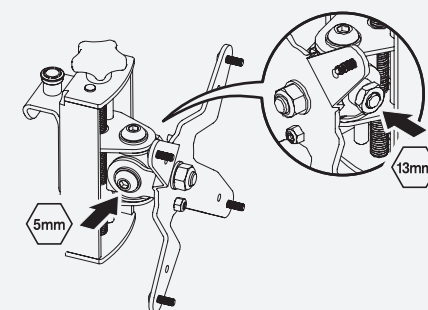

Rotation Adjustment

Rotation friction can be loosened or tightened by adjusting the hex screws at the top and bottom of the pivot with a 5mm hex key.

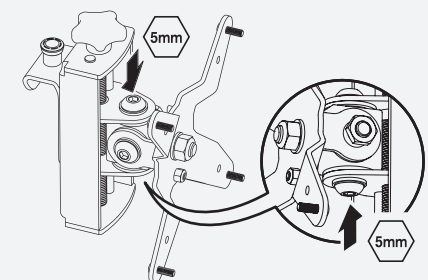

4 | ATTACH PIVOT TO WING

C

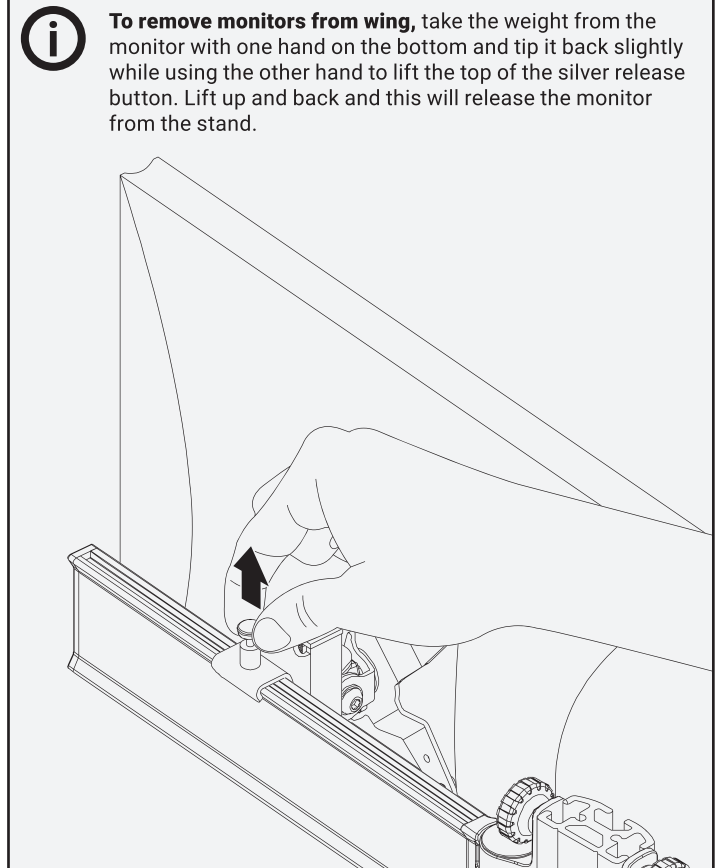
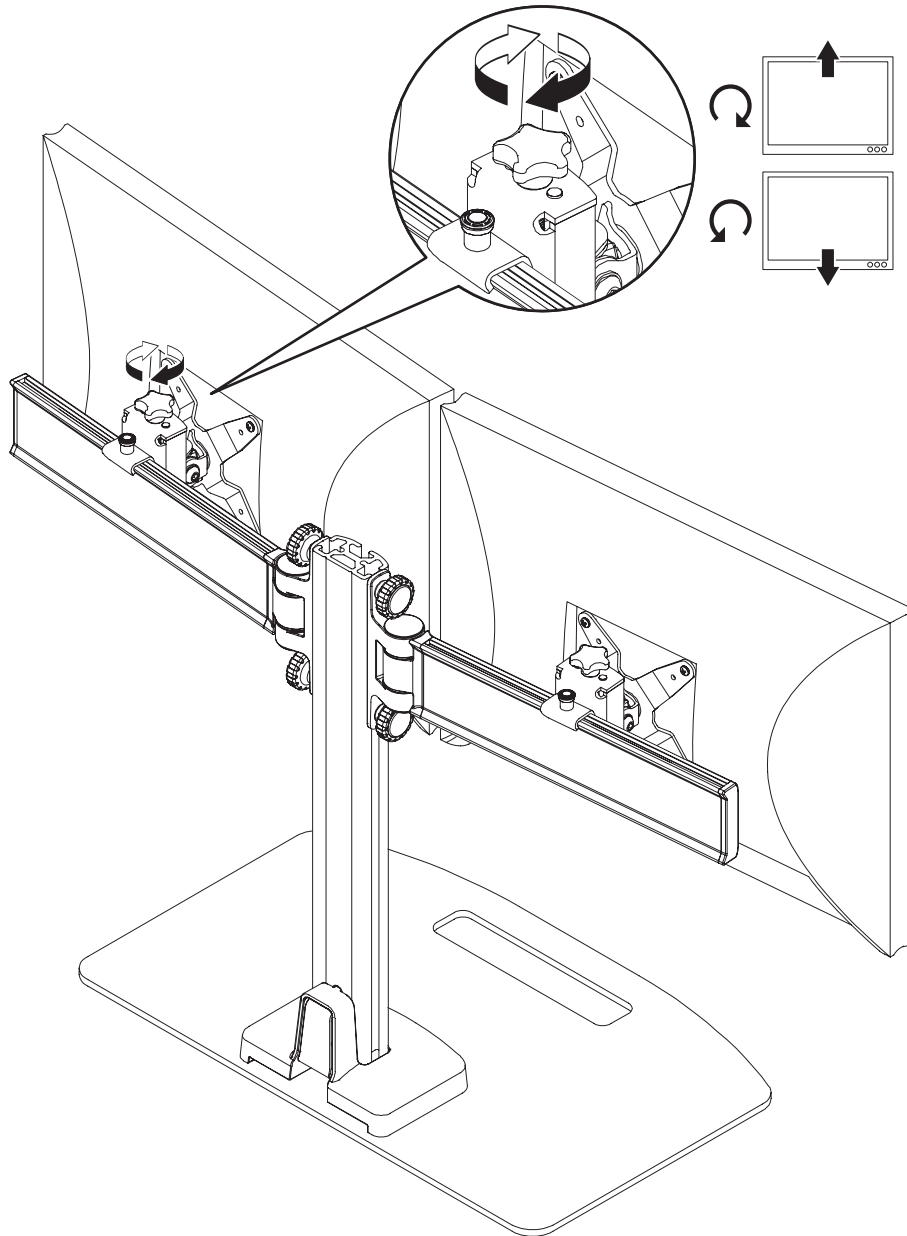

5 | CABLE MANAGEMENT

A

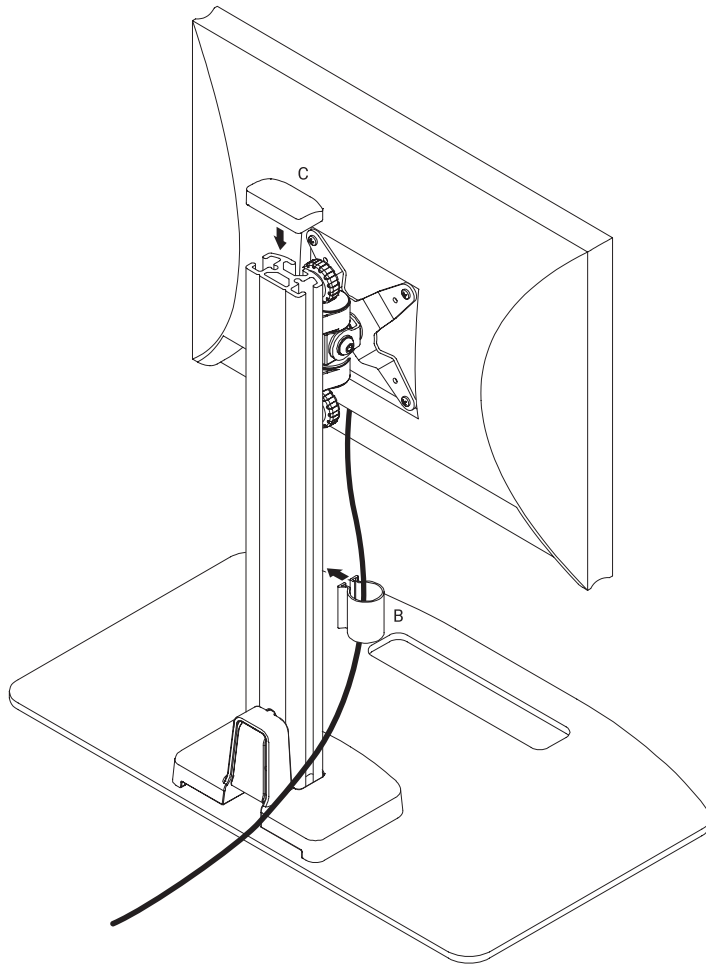

OR

