

Assembly & Installation Instructions: Magnetic Cable Chain ACC-WM-MCC-X

Workrite
ergonomics®

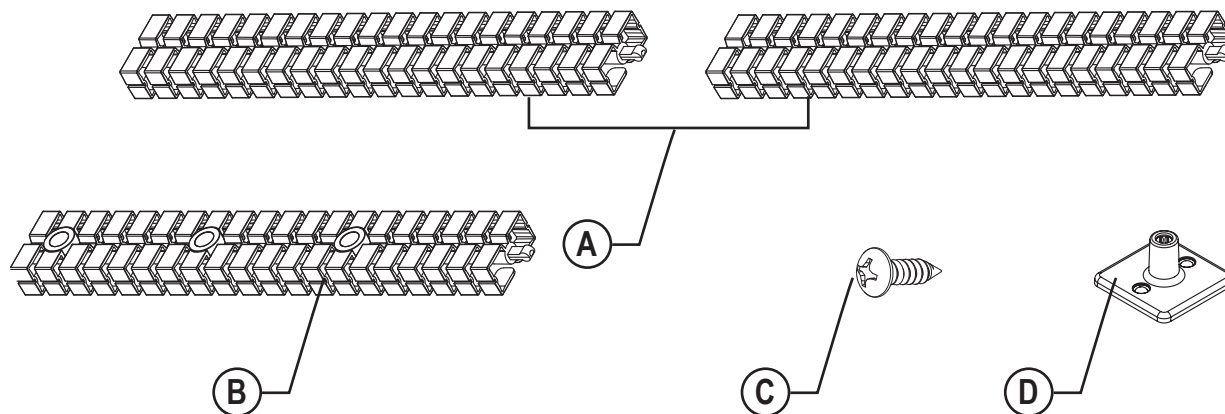

ID	Part Name	Qty
A	Magnetic Cable Chain—Middle/Upper Segment	2
B	Magnetic Cable Chain—Bottom Segment	1
C	#6 × 7/16" Phillips Pan Head Screws	2
D	Mounting Socket	1

Tools Required:



Cordless Drill



1/8" Drill Bit

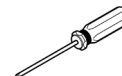

#2 Phillips Bit
Screwdriver or
Driver/Drill

1 Assemble the three segments (A & B) together

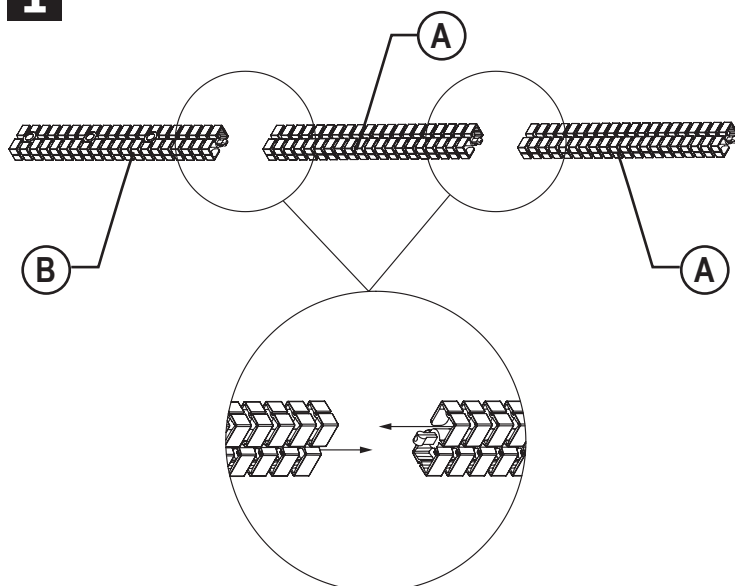

The segment containing magnets should be positioned at the end of the series, magnet should conclude the chain as shown

- Segments snap together by inserting the plastic standoff of one segment into the pocket of an alternative segment.
- A click will indicate the chain has been securely attached

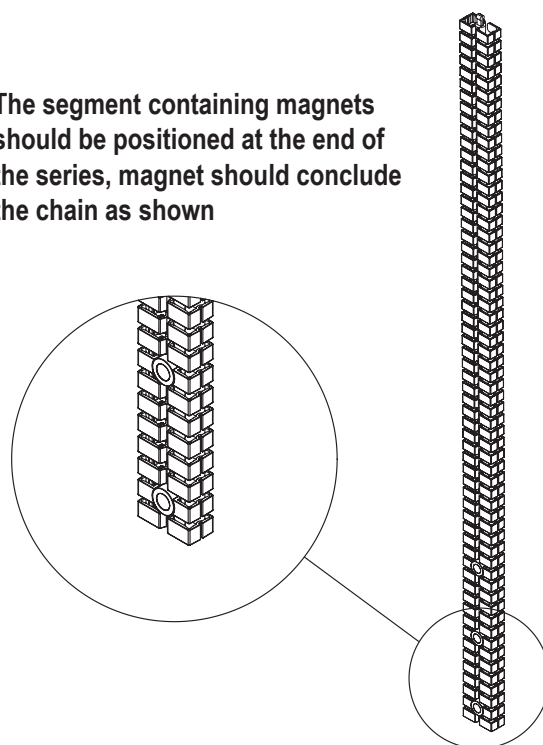

2a

Attach mounting socket (D)
to worksurface.

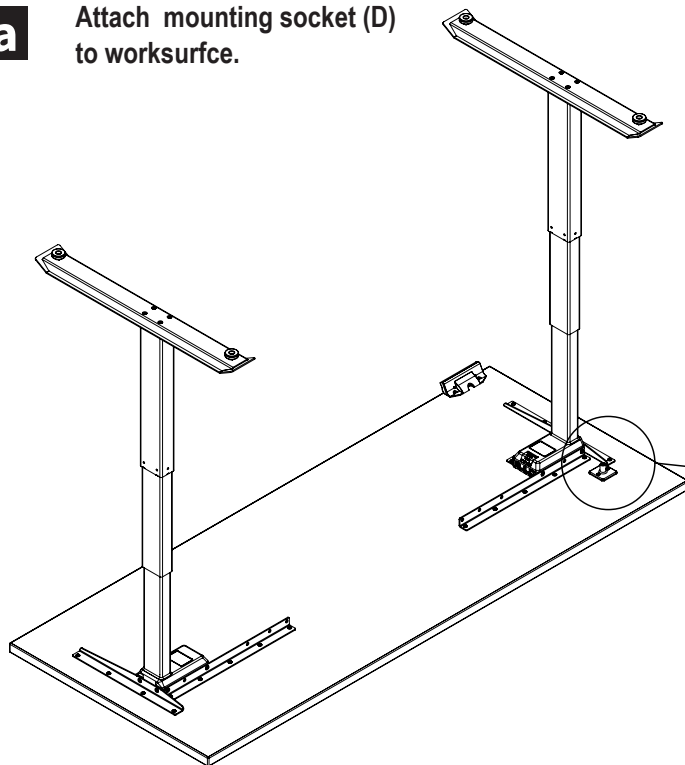

Position Mounting Socket (D) 2.5 inch
behind the rear motor bracket aligned
with the center of the leg column

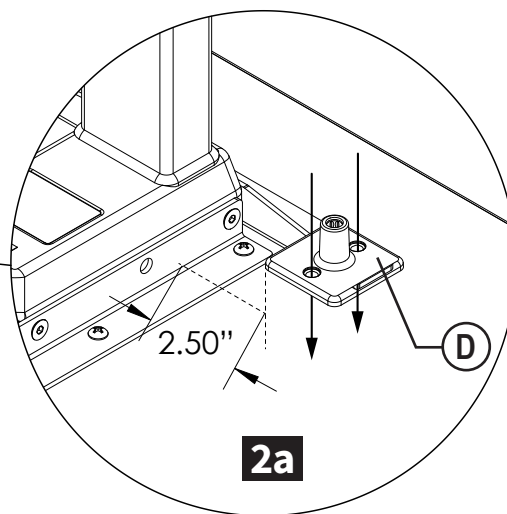
**2b**

Pre-drill two pilot holes using $\frac{1}{8}$ Drill bit

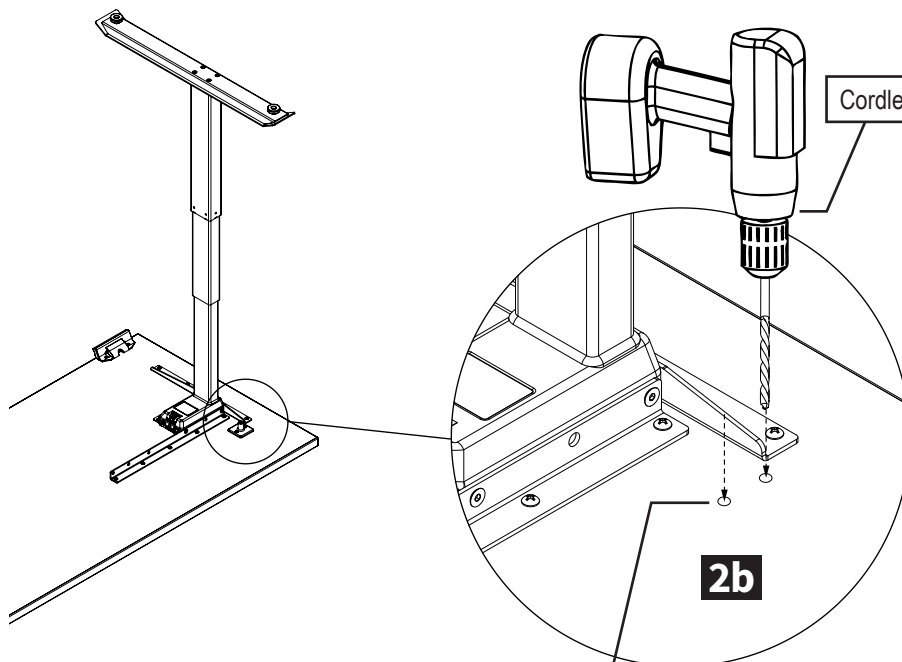
**2c**

Use screw driver to mount socket to bottom
side of the worksurface with
two #6 $\frac{7}{16}$ " Phillips Pan Head Screws (C)

Cordless Drill with $\frac{1}{8}$ Drill bit

#2 Phillips Screwdriver

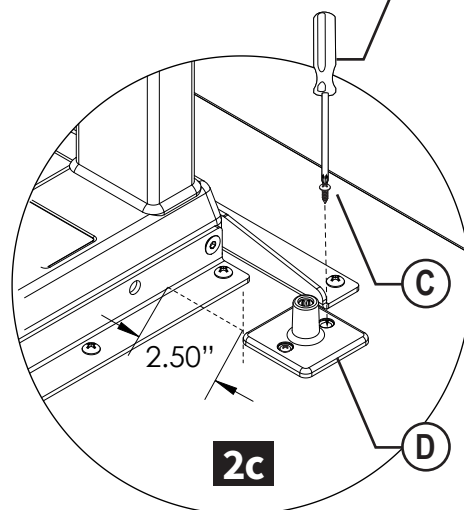

Drill Two Pilot Holes from
Underside of Worksurface
DO NOT DRILL DEEPER THAN $\frac{1}{2}$ "

3a

Attaching Magnetic Cable Chain

- Insert the plastic standoff on the top of the Cable Chain (A) into Mounting Socket (D).
- A click will indicate the chain has been securely attached

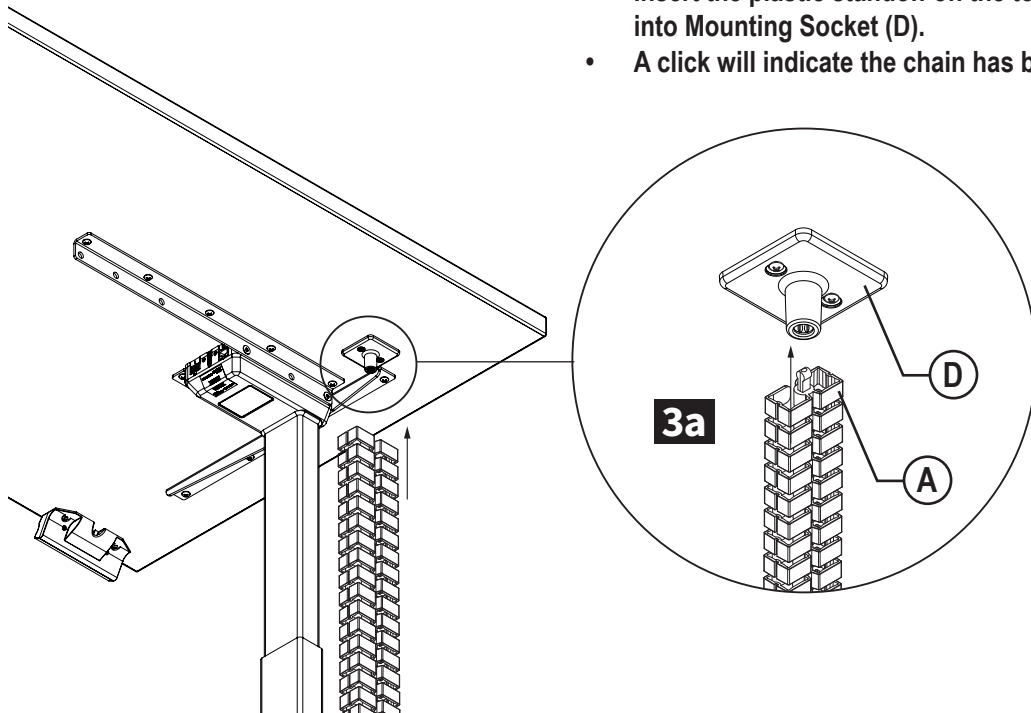
**3b**

Attach the three magnetic links (B) to the bottom of the leg column.

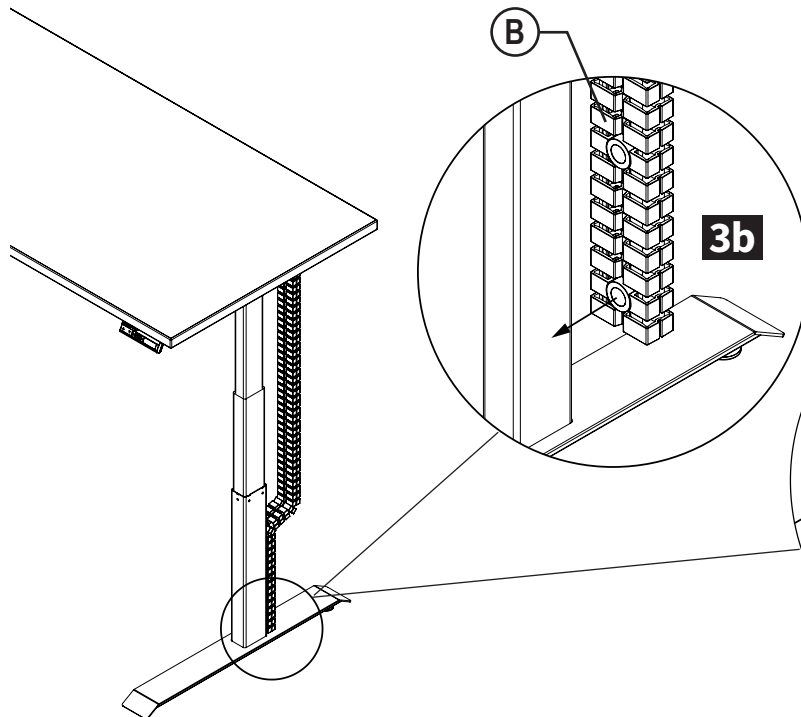
**3c**

The bottom link should be positioned approximately .25" above where the leg meets the foot

