

# Assembly & Installation Instructions: Acrylic Privacy & Modesty Panels SM-ACR-XX-XXX

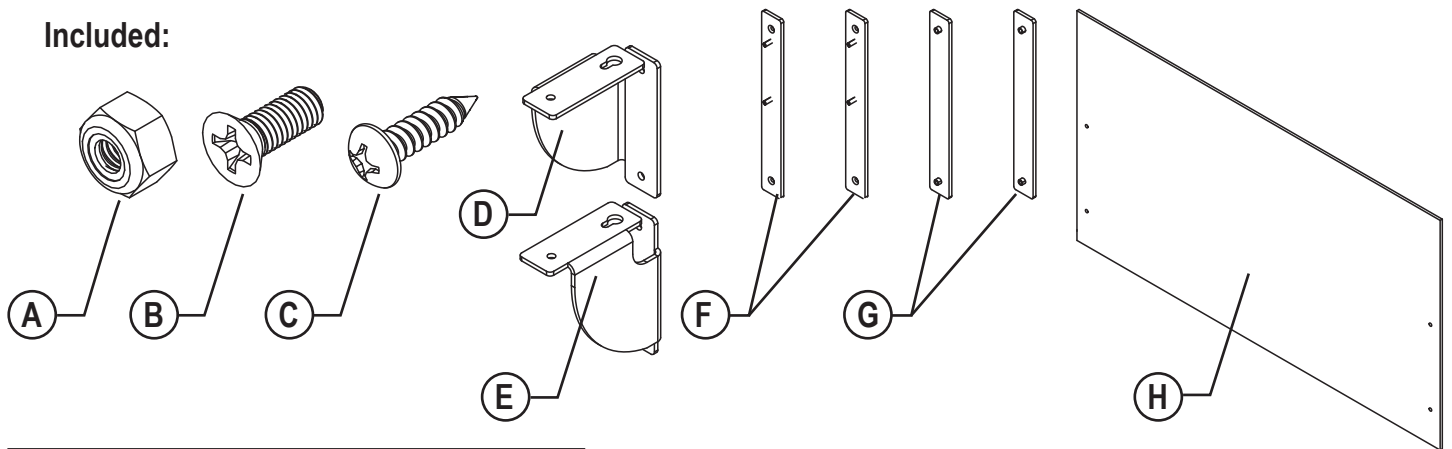

## Included:



ID	Part Name	Qty
A	#10-32 Zinc Nylon Lock Nut	4
B	#10-32 x 1/2" Phillips Drive Flat Head Screws	4
C	#10 x 3/4" Phillips Pan Head Screws	4
D	Left Bracket	1
E	Right Bracket	1
F	Front Stud Brackets	2
G	Rear Standoff Brackets	2
H	Acrylic Panel	1

## Tools Required:

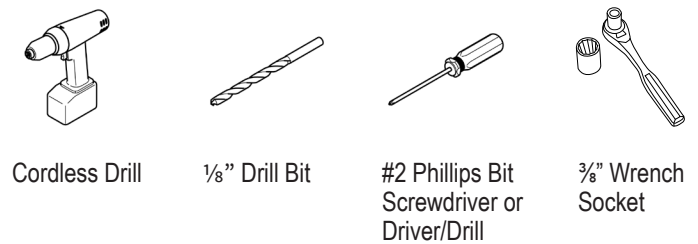

**1** Align Rear Standoff Brackets (G) with holes on outside edge of Acrylic Panel (H)

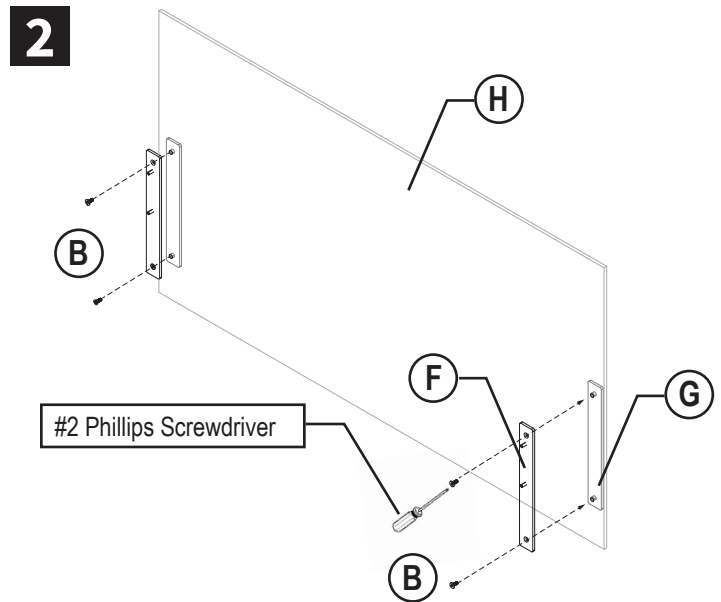
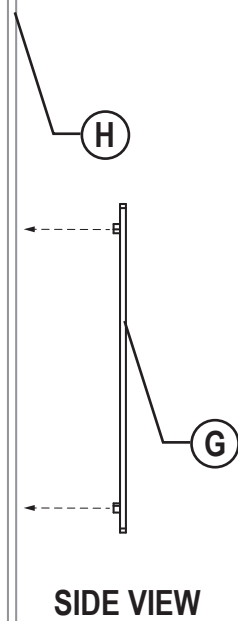

- Align Front Stud Brackets (F) with holes on opposite side of Acrylic Panel (H)
- Insert #10-32 x 1/2" Phillips Flat Head Screws (B)

3

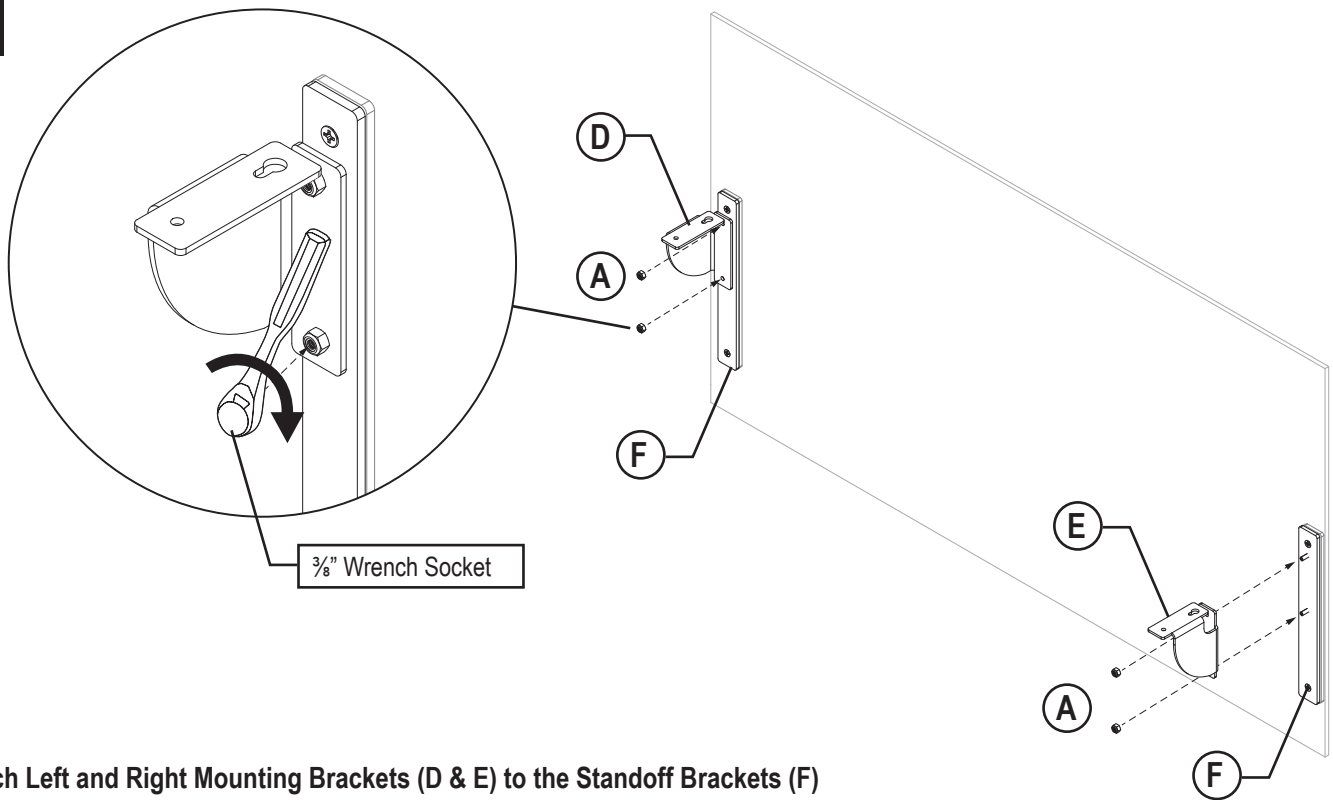

Attach Left and Right Mounting Brackets (D & E) to the Standoff Brackets (F) using #10-32 Zinc Nylon Lock Nuts (A) to securely fasten

4

Center and attach Acrylic Privacy Panel to underside of worksurface

Use #10 × 3/4" Pan Head Screws (C) through Left & Right Mounting Brackets into the pilot holes to securely fasten both brackets and panel to the bottom side of the worksurface

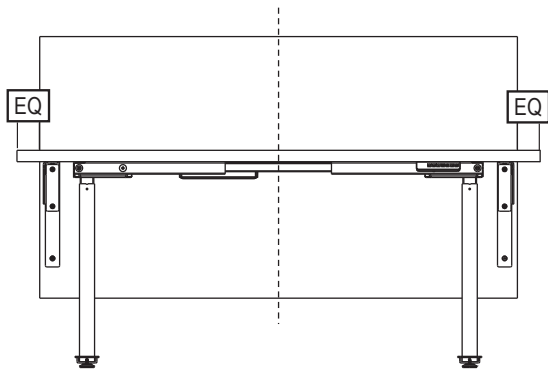

Predrill pilot screw holes underneath the worksurface using 1/8 Drill bit

**!** Drill Four Pilot Holes from Underside of Worksurface DO NOT DRILL DEEPER THAN 3/4"

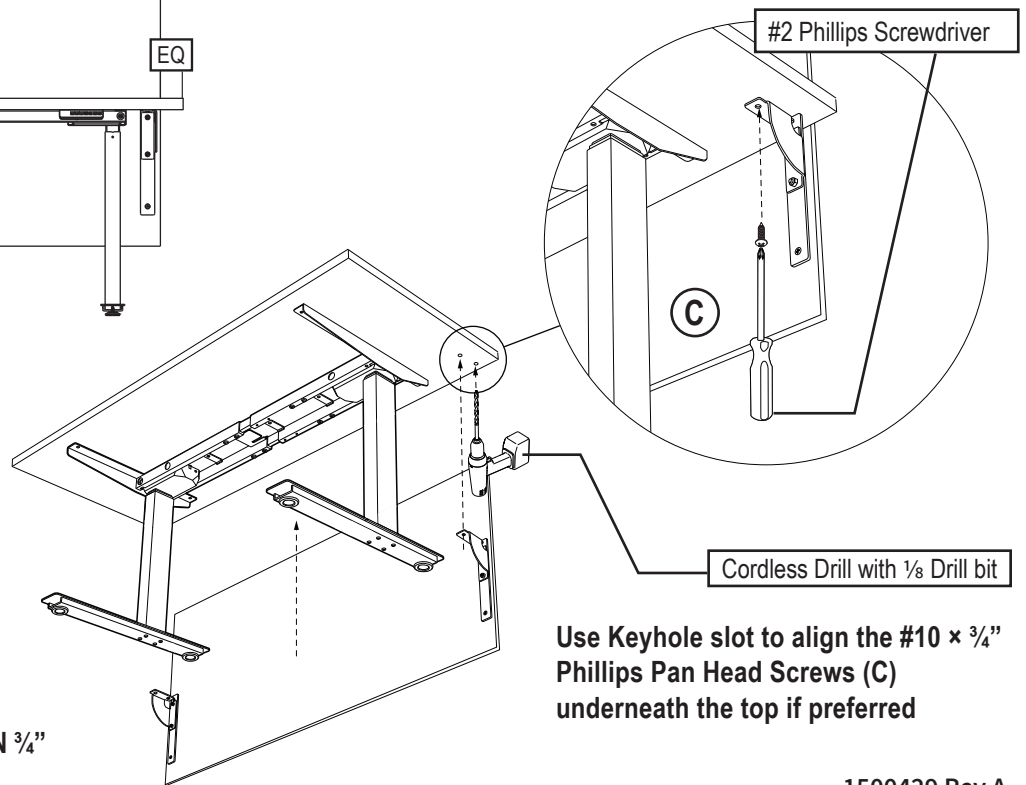

Use Keyhole slot to align the #10 × 3/4" Phillips Pan Head Screws (C) underneath the top if preferred

1500429 Rev A