

1 to 2 Monitor Conversion Bracket Instructions

MON-ACCBRKT-1TO2-B

Parts Included

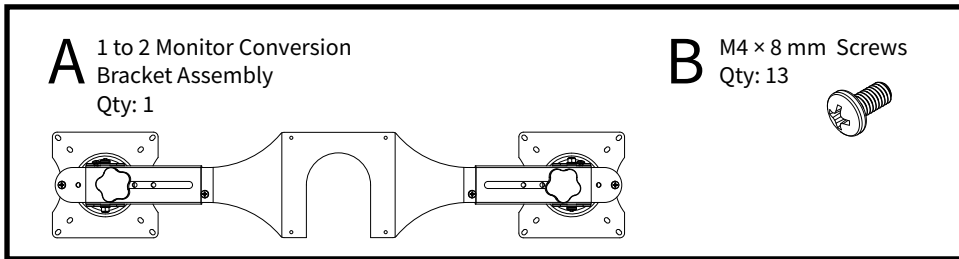

Required & Sold Separately

Poise HD or Conform HD Arm
Two compatible width and weight monitors

Tools Required

#2 Phillips Head Screwdriver

Note: Monitor size and weight limitations apply. Refer to the monitor arm specifications for weight limitations. Be sure to calculate the total weight of two monitors plus 5 lb. for the Bracket Assembly. The 1 to 2 Monitor Conversion Bracket can accommodate two monitors up to 28.5" of ACTUAL width.

Go to: <http://workriteergo.com/monitor-compatibility-finder/> for more information.

1 Attach 1 to 2 Bracket to Arm

a Remove the Monitor Mounts from the Bracket by removing the Safety Screws and Adjustment Knobs and washers. This makes it easier to mount the monitors on the Monitor Mount and attach the Bracket to the monitor arm.

b Use an M4 × 8 mm Screw (B) to lock your monitor arm head pivot, by screwing it into the top hole in the monitor arm head.

You need to lock the center pivot on the monitor arm to prevent the Bracket from pivoting on the monitor arm. Pivot functions will be provided by the Bracket Monitor Mounts.

c Attach Bracket to the VESA mount on the monitor arm in either vertical or horizontal orientation using four M4 × 8 mm Screws (B).

See next step for mounting configurations.

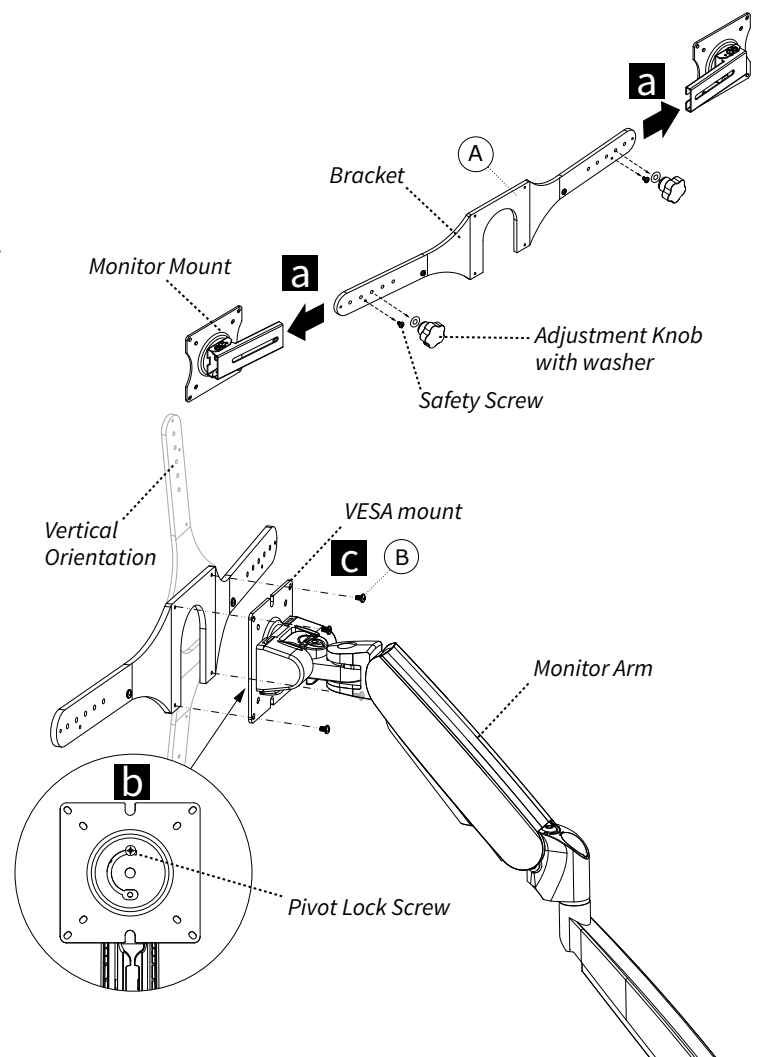

2 Determine Mounting Configuration

There are five possible recommended configurations for mounting — three with a horizontal Bracket orientation and two with a vertical Bracket orientation. Choose the configuration you wish to use, then orient your Bracket on the monitor arm accordingly.

Horizontal Bracket Configurations

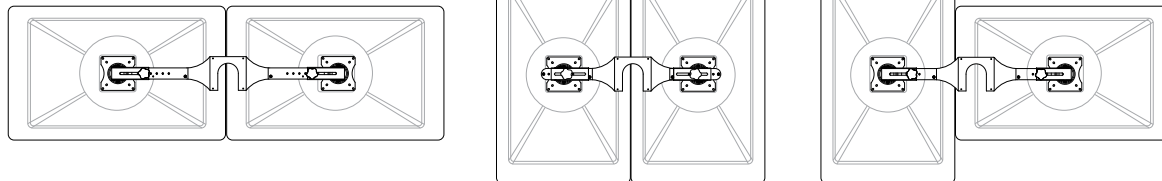

Vertical Bracket Configurations ⚠

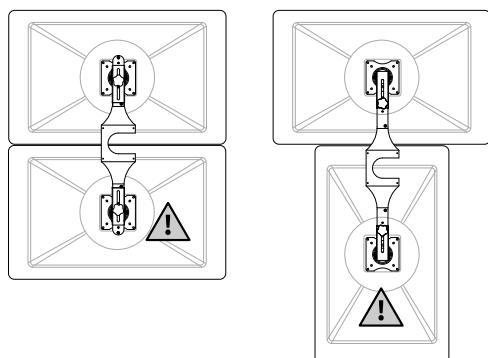

Always use the Safety Screw, especially with these vertical bracket configurations! Depending on your monitor size, you may need to re-install the Safety Screw into its original hole, not the outer most one as shown below.

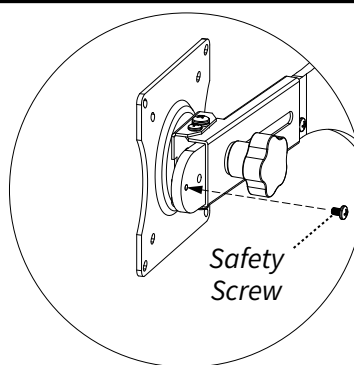

3 Secure Monitor Mounts to Monitors

Attach each Monitor Mount to the monitors with four M4 × 8 mm Screws (B).

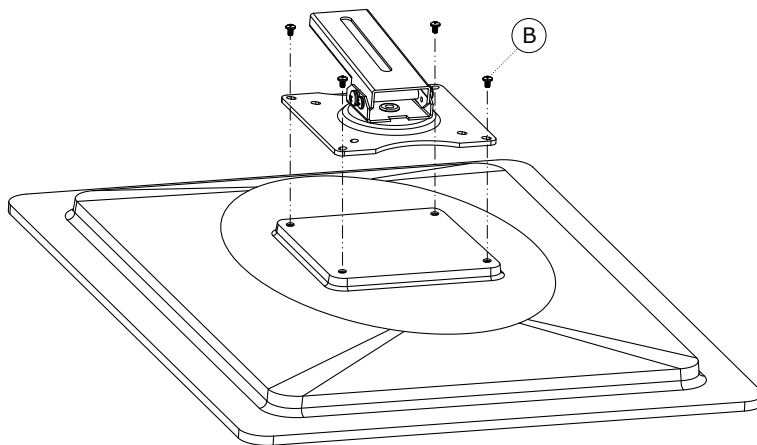

4 Attach Monitors with Mount to Bracket

Slide the Monitor Mounts on to the Wing Bracket (A) and adjust as needed to center the monitors.

Tighten the Adjustment Knob to secure.

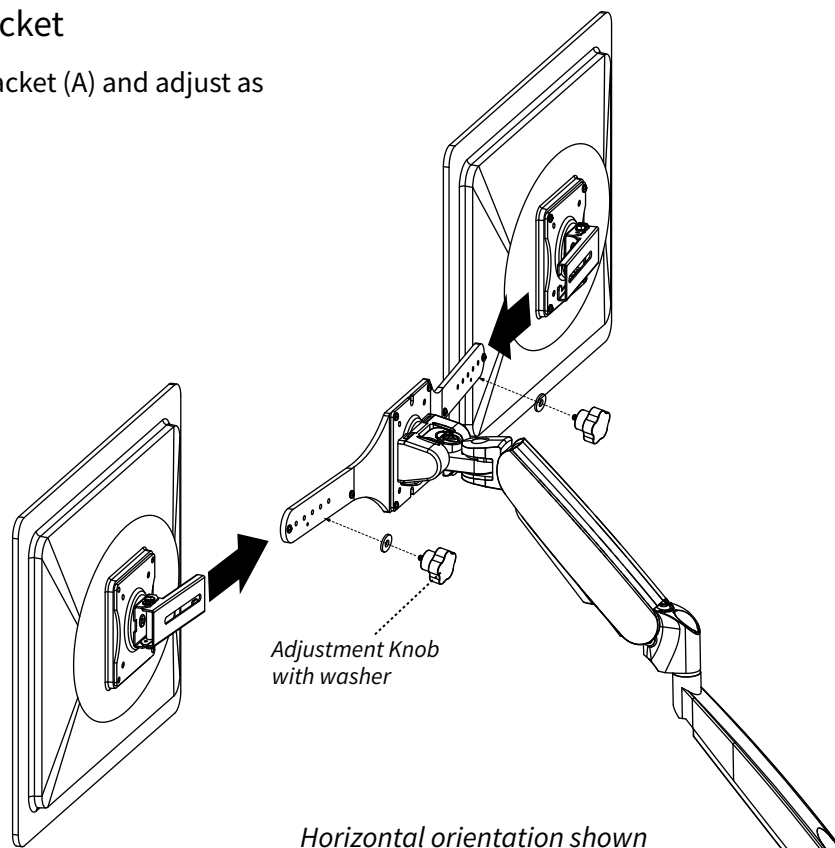

5 Secure Monitors to Bracket

Re-install the two Safety Screws.

Note: Depending on your monitor size, you may need to re-install the Safety Screw into its original hole, not the outer most one as shown below.

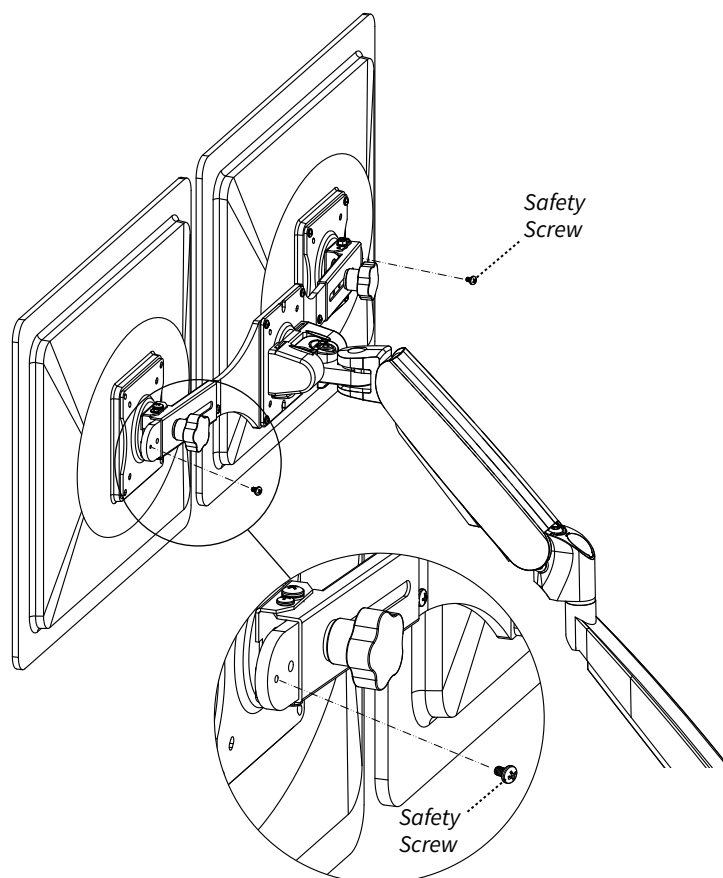

6 Adjust Monitors

Depending on monitor size, thickness and bezel size, it may be necessary to adjust the two monitors to align the center bezels and create a configuration that is gap free.

If more pivot is needed:

- a** If needed, remove both Pivot Screws located next to the Monitor Mount Nuts.
- b** With Pivot Screws removed, pivot the monitors inward or outward until the monitors are positioned to your satisfaction.

Bring monitors together:

- c** Loosen and adjust the Adjustment Knobs inward and outward until the monitor bezels come together.

Note: It may be necessary to remove and re-attach the Adjustment Knob in a different hole location (see **Step 4**) to get the ideal placement of the monitors.

Re-tighten the Adjustment Knob to lock into place. Pivot screws remain out. You may wish to tighten the center Monitor Mount Nut with a 8 mm wrench to tighten.

