



## VERSATILE AND INTUITIVELY SIMPLE TO USE

The Conform Articulating Arm adapts to your changing needs through an easy to use pin connection system. Mount the arm to a variety of bases, add additional arms or reconfigure as hardware and office personnel needs change. The exceptionally smooth lifting gas spring, coupled with precision bushings, provides years of maintenance-free maneuverability. The Conform Articulating Arm has been engineered to support over 12,000 cycles and exceeds ANSI/BIFMA X5.5 requirements. TAA Compliant.



Conform slatwall mount

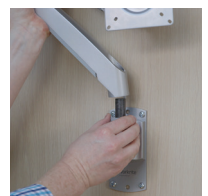

Conform wall mount

# CONFORM ARTICULATING ARM

Benefits:

- Enhance performance through ergonomic comfort
- Smooth lifting, maintenance-free gas spring (supports 5–17 lb. monitors)
- Expandable, interchangeable components ensure future adaptability
- Designed for fast, easy installation
- Easily route and conceal cables through the integrated wire managers
- Quickly folds down to provide users with maximum desk space
- Discrete silver color and design blends into office environments

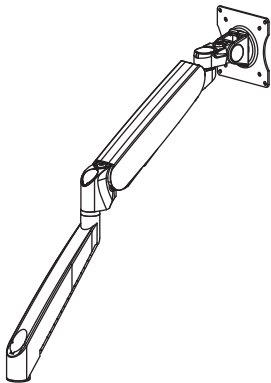

Dimensions

Reach & articulation range

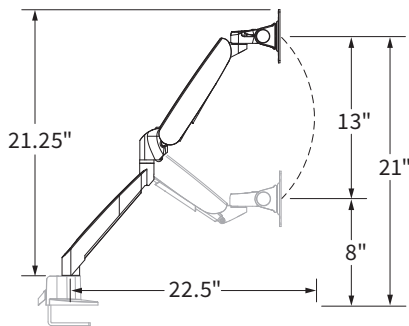

Pivot, tilt & rotate

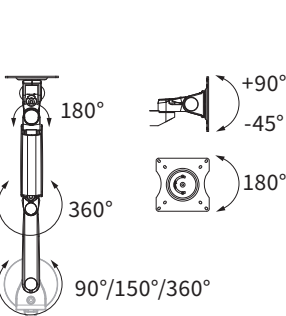

Stowed depth

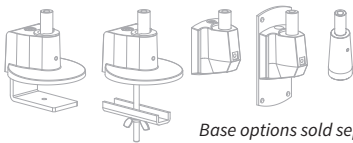

Base options sold separately

## Preconfigured Conform

Articulating Arm with C-Clamp/Grommet Base

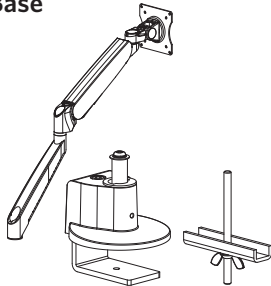

- Arm
- Supports one 5–17 lb monitor
  - Maximum monitor height: 16" (full range of motion)
  - Articulation range: 13"
  - Forward reach: 22.5"
  - Stowed depth: 5.25"
  - Monitor :
    - Tilt: +90°/-45°
    - Pivot: +/-90°
    - Rotation: +/-90°
  - Standard VESA (75 mm & 100 mm)
  - Warranty: 10 year

Model #	Weight	US \$ List	CAN \$ List
CONF-1SDA-BSE-CCG-S		\$282	\$362

- Base
- Convenient top adjusting C-clamp design
  - Includes both C-clamp & grommet mounting hardware
  - 180° pivot limiter on lower arm for space constrained environments
  - Supports up to 48 lb

Articulating Arm with 2 Piece C-Clamp/Grommet Base

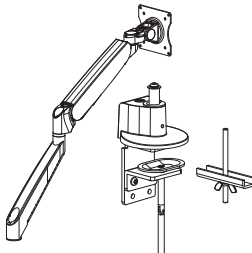

- Arm
- Supports one 5–17 lb monitor
  - Maximum monitor height: 16" (full range of motion)
  - Articulation range: 13"
  - Forward reach: 22.5"
  - Stowed depth: 5.25"
  - Monitor :
    - Tilt: +90°/-45°
    - Pivot: +/-90°
    - Rotation: +/-90°
  - Standard VESA (75 mm & 100 mm)
  - Warranty: 10 year

CONF-1SDA-BSE-TPCCG-S	\$313	\$401
-----------------------	-------	-------

- Base
- Detachable two piece C-clamp design for panel mounted desks
  - Includes both C-clamp & grommet mounting options
  - 180° pivot limiter on lower arm for space constrained environments
  - Supports up to 48 lb



Products listed on this page are available through GSA Contract GS-28F-0030S SIN #711-2 (Schedule 71).

MONITOR ARMS

# CONFORM ARTICULATING ARM

## Stand Alone Conform Arms

### Articulating Arm

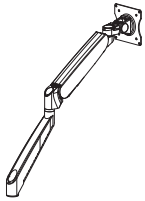

- Supports one 5–17 lb monitor
- Maximum monitor height: 16" (full range of motion)
- Articulation range: 13"
- Forward reach: 22.5"
- Stowed depth: 5.25"
- Monitor :
  - Tilt: +90°/-45°
  - Pivot: +/-90°
  - Rotation: +/-90°
- Standard VESA (75 mm & 100 mm)
- Warranty: 10 year

Model #	Weight	US \$ List	CAN \$ List
CONF-1SDA-WOB-S	6	\$221	\$296

## Stand Alone Conform Bases

### Tool Bar & Slatwall Base



- For use with articulating or Static Monitor Arms
- Easily mount to Tool Bars, Privacy Panels & Slatwall Panels
- Clamping design supports slat rails up to 1.25" wide
- Supports up to 48 lb

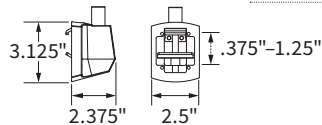

Model#	Weight	US \$ List	CAN \$ List
CONF-BSE-TSB-S	2	\$57	\$73

### Wall Plate Base



- For use with Articulating or Static Monitor Arms
- Wall mount to concrete, steel or drywall
  - Mounting hardware not included
- Supports up to 48 lb

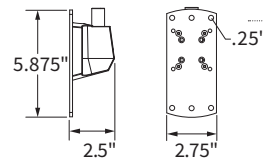

CONF-BSE-WP-S	2	\$57	\$73
---------------	---	------	------

### Knoll® Antenna® Adaptor



- For use with Articulating Monitor Arms
- Compatible with Knoll Antenna- Table Center Beam Center Mount and Center Beam Side Mount
- Supports up to 48 lb
  - Knoll Antenna capacity dependent

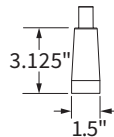

CONF-ADPT-KA-S	2	\$102	\$131
----------------	---	-------	-------

### K-Rail® Adaptor

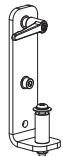

- For use with Articulating or Static Monitor Arms with 80/20 T-Slot construction materials
- Quick release lever for easy vertical adjustment
- Supports up to 48 lb
  - K-Rail capacity dependent

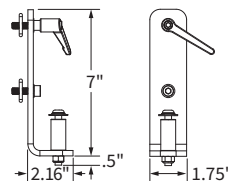

CONF-ADPT-KRAIL-S	2	\$40	\$51
-------------------	---	------	------

## Conform Accessories & Parts

### Dual Arm Adaptor



- For use with Articulating or Static Monitor Arms
- Converts single arm base options into dual arm base
- Supports up to 48 lb

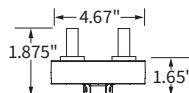

Model#	Weight	US \$ List	CAN \$ List
CONF-ADPT-DA-S	2	\$40	\$51

### Single & Dual Pole Adaptors

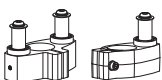

- For use with Articulating or Static Monitor Arms
- Mount one or two Articulating Arms or Static Arms to a pole
- Supports up to 48 lb

Single	CONF-ADPT-SPM-S	1	\$67	\$86
Dual	CONF-ADPT-DPM-S	1	\$77	\$99



Products listed on this page are available through GSA Contract GS-28F-0030S SIN #711-2 (Schedule 71).

MONITOR ARMS

# CONFORM ARTICULATING ARM

## Stand Alone Conform Bases

### C-Clamp & Grommet Base

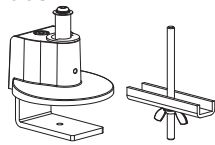

- For use with Articulating Monitor Arms
- Convenient top adjusting C-clamp design
- Includes both C-clamp & grommet mounting options
- 180° pivot limiter on lower arm for space constrained environments
- Supports up to 48 lb

Dimensions

Model#

Weight

US \$ List

CAN \$ List

CONF-BSE-CCG-S

3

\$61

\$78

### 2 Piece C-Clamp & Grommet Base

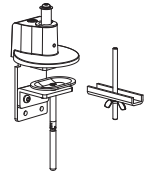

- For use with Articulating Monitor Arms
- Detachable two piece C-clamp design for panel mounted desks
- Includes both C-clamp & grommet mounting options
- 180° pivot limiter on lower arm for space constrained environments
- Supports up to 48 lb

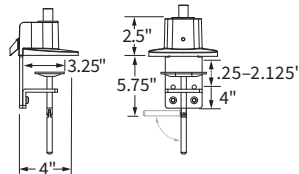

CONF-BSE-TPCCG-S

4

\$92

\$118

### 14" Pole with C-Clamp & Grommet Base

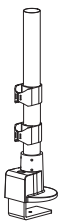

- For use with Static Monitor Arms; or Articulating Arms w/ Pole Mount Adapter
- Includes both C-clamp & grommet mounting options
- Convenient top adjustment C-clamp design
- Supports 1-3 monitors, up to 48 lb

CONF-PB-14CCG-S

6

\$102

\$131

### 14" Heavy Duty Pole with C-Clamp & Grommet Base

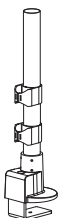

- For use with Static Monitor Arms; or Articulating Arms w/ Pole Mount Adapter
- 14" pole, heavy duty C-clamp & grommet mounting options
- Designed for robust applications
- Heavy duty C-clamp design
- Supports up to 96 lb

CONF-PB-14HDCCG-S

6

\$123

\$164

### 28" Pole, Heavy Duty C-Clamp & Grommet Base

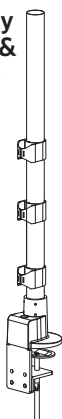

- Designed for stacked monitor applications
- For use with Static Monitor Arms; or Articulating Arms w/ Pole Mount Adapter
- Includes both C-clamp & grommet mounting options
- Heavy duty C-clamp design
- Supports 1-6 monitors, up to 96 lb

C-Clamp

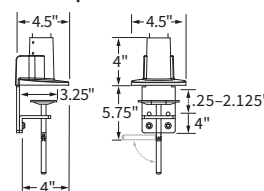

Grommet

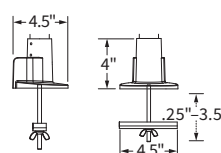

Pole Range

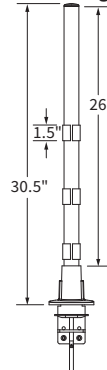

Recommended Configuration

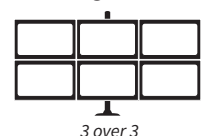

Flexible Solutions for the **Ergonomic** Workplace.

Explore  
Launch website

1400562-09/30/19 Subject to change without notice.

©2019 Workrite Ergonomics, 2277 Pine View Way, Suite 100, Petaluma, CA 94954  
www.workriteergo.com 800.959.9675

**Workrite**  
ergonomics®