



ENHANCED PERFORMANCE THROUGH ERGONOMIC COMFORT

The Conform Triple Static Arm is designed to provide side-by-side support for three monitors in a compact footprint. As part of the Conform family it uses the Workrite pin connection system, allowing it to be quickly mounted to a variety of bases and reconfigured with additional Conform monitor arms to adapt to your changing needs. Easily create a six monitor array by using a 28" pole mount and two Conform Triple, Static Arms. The Conform Triple, Static Arm has been engineered to support over 15,000 cycles and exceeds ANSI/BIFMA X5.5 requirements. TAA Compliant.



Single pole mount adaptor with interchangeable pin system ensures future adaptability



Dual pole mount adaptor with interchangeable pin system ensures future adaptability

CONFORM TRIPLE STATIC ARM

Products listed on this page are available through GSA Contract GS-28F-0030S SIN #711-2 (Schedule 71).



Benefits:

- Enhance performance through ergonomic comfort
- Rigid support for monitors from 0–16 lb. each
- Expandable, interchangeable components ensure future adaptability
- Designed for fast, easy installation
- Easily route and conceal cables through the integrated wire managers
- Compact footprint allows users to maximize their desk space
- Discrete silver color and design blends into office environments

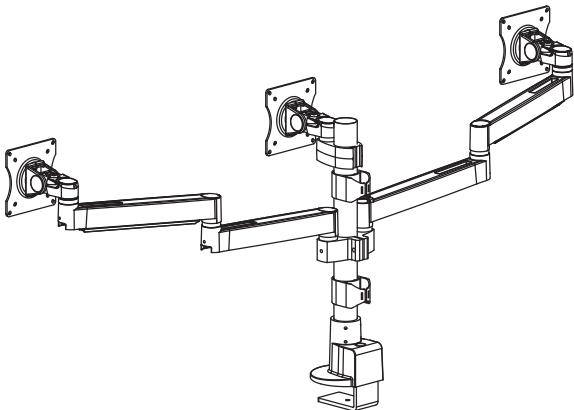

Dimensions

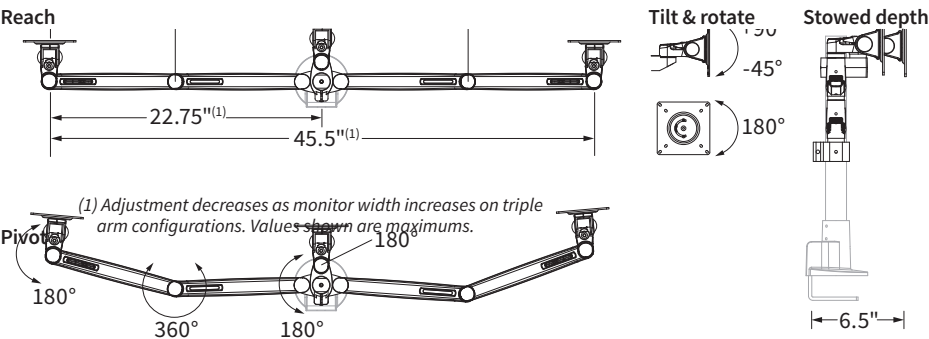

Preconfigured Conform Triple Static

Triple, Static Arm with 14" Pole Base

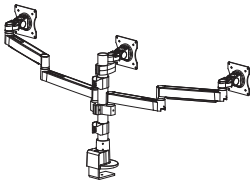

- Arm**
- Supports three monitors 0–16 lb each
 - Maximum monitor height: Pole dependent
 - Articulation range: 0" (static arm)
 - Forward reach: 6.5" with 22" wide monitor ⁽¹⁾
 - Stowed depth: 6.5"
- Monitor :**
- Tilt: +90°/-45°
 - Pivot: +/-90°
 - Rotation: +/-90°
- Standard VESA (75 mm & 100 mm)
- Warranty: 10 year

Model #	Weight	US \$ List	CAN \$ List
CONF-3SDS-PB-14CCG-S	21	\$564	\$723

- Base**
- Convenient top adjusting C-clamp design
 - Includes both C-clamp & grommet mounting hardware
 - 14" pole length
 - Supports 1–3 monitors up to 48 lb



Products listed on this page are available through GSA Contract GS-28F-0030S SIN #711-2 (Schedule 71).

CONFORM TRIPLE STATIC ARM

Stand Alone Conform Arms

Triple, Static Arm

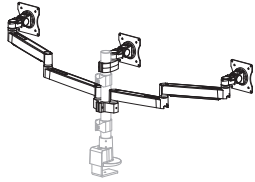

- Supports three monitors 0–16 lb each
- Maximum monitor height: Pole dependent
- Articulation range: 0" (static arm)
- Forward reach: 6.5" with 22" wide monitor ⁽¹⁾
- Stowed depth: 6.5"
- Monitor :
 - Tilt: +90°/-45°
 - Pivot: +/-90°
 - Rotation: +/-90°
- Standard VESA (75 mm & 100 mm)
- Warranty: 10 year

Model #	Weight	US \$ List	CAN \$ List
CONF-3SDS-WOPB-S	15	\$462	\$592

Stand Alone Conform Bases

14" Pole with C-Clamp & Grommet Base

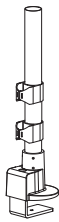

- For use with Static Monitor Arms; or Articulating Arms w/ Pole Mount Adapter
- Includes both C-clamp & grommet mounting options
- Convenient top adjustment C-clamp design
- Supports 1–3 monitors, up to 48 lb

Dimensions	Model#	Weight	US \$ List	CAN \$ List
	CONF-PB-14CCG-S	6	\$102	\$131

14" Heavy Duty Pole with C-Clamp & Grommet Base

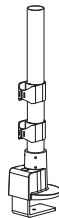

- For use with Static Monitor Arms; or Articulating Arms w/ Pole Mount Adapter
- 14" pole, heavy duty C-clamp & grommet mounting options
- Designed for robust applications
- Heavy duty C-clamp design
- Supports up to 96 lb

CONF-PB-14HDCCG-S	6	\$123	\$164
-------------------	---	-------	-------

28" Pole, Heavy Duty C-Clamp & Grommet Base

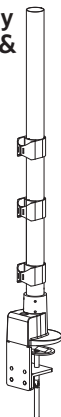

- Designed for stacked monitor applications
- For use with Static Monitor Arms; or Articulating Arms w/ Pole Mount Adapter
- Includes both C-clamp & grommet mounting options
- Heavy duty C-clamp design
- Supports 1–6 monitors, up to 96 lb

C-Clamp

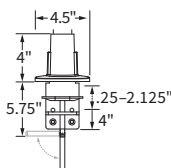
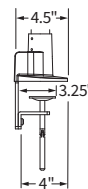

Grommet

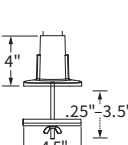
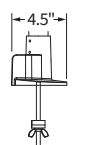

Pole Range

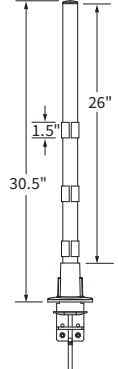

Recommended Configuration

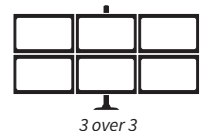



Products listed on this page are available through GSA Contract GS-28F-0030S SIN #711-2 (Schedule 71).

MONITOR ARMS

CONFORM TRIPLE STATIC ARM

Stand Alone Conform Bases

Tool Bar & Slatwall Base



- For use with articulating or Static Monitor Arms
- Easily mount to Tool Bars, Privacy Panels & Slatwall Panels
- Clamping design supports slat rails up to 1.25" wide
- Supports up to 48 lb

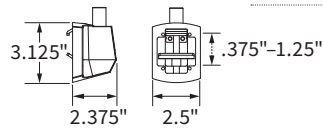

Dimensions	Model#	Weight	US \$ List	CAN \$ List
	CONF-BSE-TSB-S	2	\$57	\$73

Wall Plate Base



- For use with Articulating or Static Monitor Arms
- Wall mount to concrete, steel or drywall
 - Mounting hardware not included
- Supports up to 48 lb

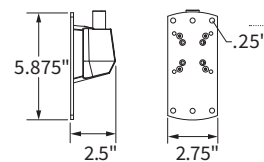

Model#	Weight	US \$ List	CAN \$ List
CONF-BSE-WP-S	2	\$57	\$73

Conform Accessories & Parts

Dual Arm Adaptor



- For use with Articulating or Static Monitor Arms
- Converts single arm base options into dual arm base
- Supports up to 48 lb

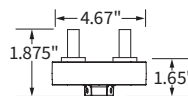

Model#	Weight	US \$ List	CAN \$ List
CONF-ADPT-DA-S	2	\$40	\$51

Single & Dual Pole Adaptors

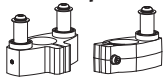

- For use with Articulating or Static Monitor Arms
- Mount one or two Articulating Arms or Static Arms to a pole
- Supports up to 48 lb

Model#	Weight	US \$ List	CAN \$ List
Single CONF-ADPT-SPM-S	1	\$67	\$86
Dual CONF-ADPT-DPM-S	1	\$77	\$99

Flexible Solutions for the **Ergonomic** Workplace.



1400562-09/30/19 Subject to change without notice.

©2019 Workrite Ergonomics, 2277 Pine View Way, Suite 100, Petaluma, CA 94954
www.workriteergo.com 800.959.9675

Workrite
ergonomics®