



## SMOOTH LIFTING, INDEPENDENT MANEUVERABILITY

The Conform Dual Articulating Arm aligns two monitors side-by-side on a single base while maintaining independent movement and articulation. Utilizing the same pin connection system as the rest of the series, the Conform Dual can be de-coupled to use independently should your needs change. Mount the arm to a variety of bases, add additional arms or reconfigure as hardware and office personnel needs change. The exceptionally smooth lifting gas spring, coupled with precision bushings, provides years of maintenance-free maneuverability. The Conform Articulating Arm has been engineered to support over 12,000 cycles and exceeds ANSI/BIFMA X5.5 requirements. TAA Compliant.



Conform Dual Arm adaptor

## CONFORM DUAL ARTICULATING ARM

Products listed on this page are available through GSA Contract GS-28F-0030S SIN #711-2 (Schedule 71).

**Benefits:**

- Enhance performance through ergonomic comfort
- Smooth lifting, maintenance-free gas spring (supports two 5–17 lb. monitors)
- Expandable, interchangeable components ensure future adaptability
- Designed for fast, easy installation
- Easily route and conceal cables through the integrated wire managers
- Quickly folds down to provide users with maximum desk space
- Discrete silver color and design blends into office environments
- Warranty: 10 year

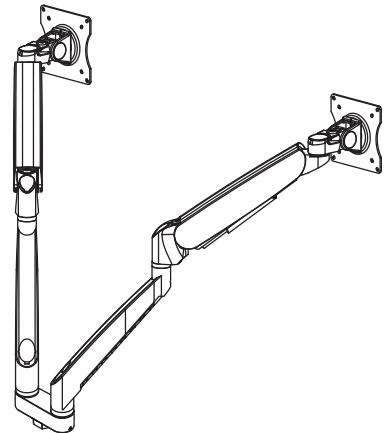
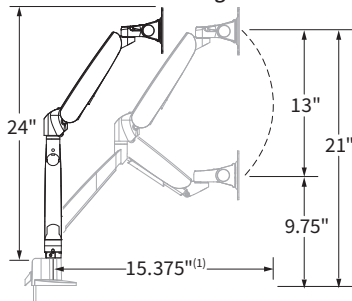
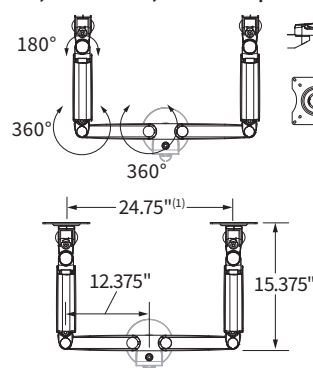
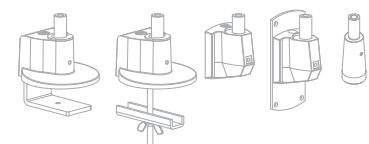
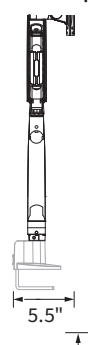
**Dimensions****Reach & articulation range****Pivot, tilt & rotate, width & depth****Stowed depth**

Base options sold separately

(1) Adjustment decreases as monitor width increases on dual arm configurations. Values shown are maximums.

Shown desk mounted against wall. Achieve additional depth with Grommet Base further in on worksurface.

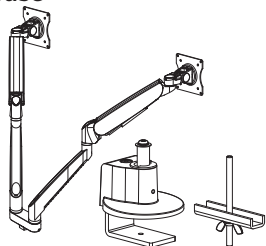
**Preconfigured Conform Dual****Dual Articulating Arm with C-Clamp/Grommet Base**

- Arm**
- Supports two monitors 5–17 lb each
  - Maximum monitor height: 19.5" (full range of motion)
  - Articulation range: 13"
  - Forward reach: 15.375"
  - Stowed depth: 5.5"
  - Monitor :
    - Tilt: +90°/-45°
    - Pivot: +/-90°
    - Rotation: +/-90°
  - Standard VESA (75 mm & 100 mm)
  - Warranty: 10 year

Model #	Weight	US \$ List	CAN \$ List
CONF-2SDA-BSE-CCG-S		\$534	\$685

**Base**

- Convenient top adjusting C-clamp design
- Includes both C-clamp & grommet mounting hardware
- 180° pivot limiter on lower arm for space constrained environments
- Supports up to 48 lb

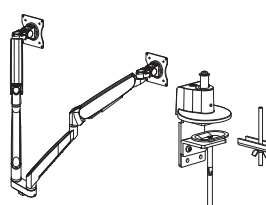
**Dual Articulating Arm with 2 Piece C-Clamp/Grommet Base**

- Arm**
- Supports two monitors 5–17 lb each
  - Maximum monitor height: 19.5" (full range of motion)
  - Articulation range: 13"
  - Forward reach: 15.375"
  - Stowed depth: 5.5"
  - Monitor :
    - Tilt: +90°/-45°
    - Pivot: +/-90°
    - Rotation: +/-90°
  - Standard VESA (75 mm & 100 mm)
  - Warranty: 10 year

CONF-2SDA-BSE-TPCCG-S	\$564	\$723
-----------------------	-------	-------

**Base**

- Detachable two piece C-clamp design for panel mounted desks
- Includes both C-clamp & grommet mounting options
- 180° pivot limiter on lower arm for space constrained environments
- Supports up to 48 lb



Products listed on this page are available through GSA Contract GS-28F-0030S SIN #711-2 (Schedule 71).

MONITOR ARMS

# CONFORM DUAL ARTICULATING ARM

## Stand Alone Conform Arms

### Dual Articulating Arms

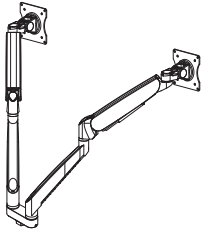

- Supports two monitors 5–17 lb each
- Maximum monitor height: 19.5" (full range of motion)
- Articulation range: 13"
- Forward reach: 15.375"
- Stowed depth: 5.5"
- Monitor :
  - Tilt: +90°/-45°
  - Pivot: +/-90°
  - Rotation: +/-90°
- Standard VESA (75 mm & 100 mm)
- Warranty: 10 year

Model #	Weight	US \$ List	CAN \$ List
CONF-2SDA-WOB-S	13	\$473	\$606

## Stand Alone Conform Bases

### Tool Bar & Slatwall Base



- For use with articulating or Static Monitor Arms
- Easily mount to Tool Bars, Privacy Panels & Slatwall Panels
- Clamping design supports slat rails up to 1.25" wide
- Supports up to 48 lb

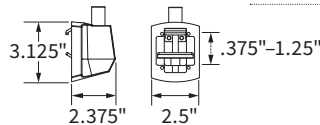

Model#	Weight	US \$ List	CAN \$ List
CONF-BSE-TSB-S	2	\$57	\$73

### Wall Plate Base



- For use with Articulating or Static Monitor Arms
- Wall mount to concrete, steel or drywall
  - Mounting hardware not included
- Supports up to 48 lb

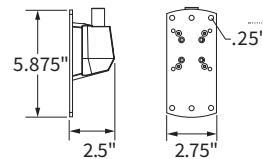

Model#	Weight	US \$ List	CAN \$ List
CONF-BSE-WP-S	2	\$57	\$73

### Knoll® Antenna® Adaptor



- For use with Articulating Monitor Arms
- Compatible with Knoll Antenna- Table Center Beam Center Mount and Center Beam Side Mount
- Supports up to 48 lb
  - Knoll Antenna capacity dependent

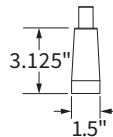

Model#	Weight	US \$ List	CAN \$ List
CONF-ADPT-KA-S	2	\$102	\$131

### K-Rail® Adaptor

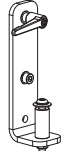

- For use with Articulating or Static Monitor Arms with 80/20 T-Slot construction materials
- Quick release lever for easy vertical adjustment
- Supports up to 48 lb
  - K-Rail capacity dependent

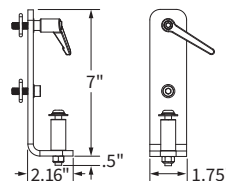

Model#	Weight	US \$ List	CAN \$ List
CONF-ADPT-KRAIL-S	2	\$40	\$51

## Conform Accessories & Parts

### Dual Arm Adaptor



- For use with Articulating or Static Monitor Arms
- Converts single arm base options into dual arm base
- Supports up to 48 lb

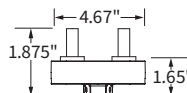

Model#	Weight	US \$ List	CAN \$ List
CONF-ADPT-DA-S	2	\$40	\$51

### Single & Dual Pole Adaptors



- For use with Articulating or Static Monitor Arms
- Mount one or two Articulating Arms or Static Arms to a pole
- Supports up to 48 lb

Model#	Weight	US \$ List	CAN \$ List
Single CONF-ADPT-SPM-S	1	\$67	\$86
Dual CONF-ADPT-DPM-S	1	\$77	\$99



Products listed on this page are available through GSA Contract GS-28F-0030S SIN #711-2 (Schedule 71).

MONITOR ARMS

# CONFORM DUAL ARTICULATING ARM

## Stand Alone Conform Bases

### C-Clamp & Grommet Base

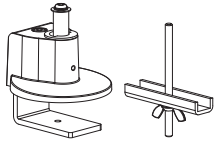

- For use with Articulating Monitor Arms
- Convenient top adjusting C-clamp design
- Includes both C-clamp & grommet mounting options
- 180° pivot limiter on lower arm for space constrained environments
- Supports up to 48 lb

Dimensions

Model#

Weight

US \$ List

CAN \$ List

CONF-BSE-CCG-S

3

\$61

\$78

### 2 Piece C-Clamp & Grommet Base

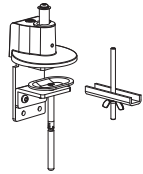

- For use with Articulating Monitor Arms
- Detachable two piece C-clamp design for panel mounted desks
- Includes both C-clamp & grommet mounting options
- 180° pivot limiter on lower arm for space constrained environments
- Supports up to 48 lb

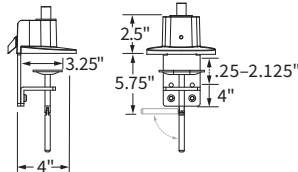

CONF-BSE-TPCCG-S

4

\$92

\$118

### 14" Pole with C-Clamp & Grommet Base

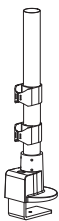

- For use with Static Monitor Arms; or Articulating Arms w/ Pole Mount Adapter
- Includes both C-clamp & grommet mounting options
- Convenient top adjustment C-clamp design
- Supports 1-3 monitors, up to 48 lb

CONF-PB-14CCG-S

6

\$102

\$131

### 14" Heavy Duty Pole with C-Clamp & Grommet Base

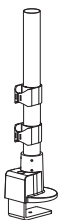

- For use with Static Monitor Arms; or Articulating Arms w/ Pole Mount Adapter
- 14" pole, heavy duty C-clamp & grommet mounting options
- Designed for robust applications
- Heavy duty C-clamp design
- Supports up to 96 lb

CONF-PB-14HDCCG-S

6

\$123

\$164

### 28" Pole, Heavy Duty C-Clamp & Grommet Base

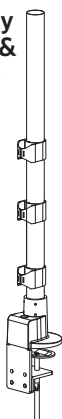

- Designed for stacked monitor applications
- For use with Static Monitor Arms; or Articulating Arms w/ Pole Mount Adapter
- Includes both C-clamp & grommet mounting options
- Heavy duty C-clamp design
- Supports 1-6 monitors, up to 96 lb

C-Clamp

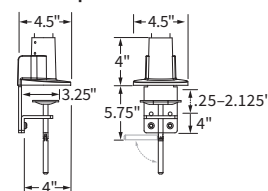

Grommet

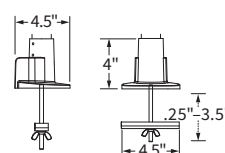

Pole Range

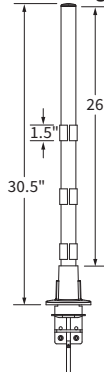

Recommended Configuration

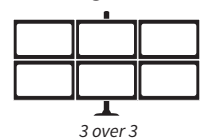

Flexible Solutions for the Ergonomic Workplace.

Explore  
Launch website

1400562-09/30/19 Subject to change without notice.

© Workrite Ergonomics, 2277 Pine View Way, Suite 100, Petaluma, CA 94954  
www.workriteergo.com 800.959.9675

Workrite  
ergonomics®