

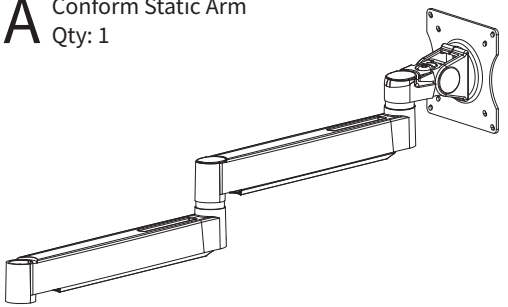

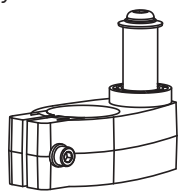



Assembly & Installation Instructions: Conform Static Arm CONF-1SDS-WOPB-S

Parts Included

A Conform Static Arm Qty: 1 	B Single Pole Mount Adaptor Assembly Qty: 1 	C M4 × 10 mm VESA mount screw Qty: 4  D M4 × 6 mm VESA mount screw Qty: 4  E Wedge Washer Qty: 1  F Pivot Cover Cap Qty: 1  G Hook & Loop Strips Qty: 4 
--	--	--

Required Parts Sold Separately

Selected base option with mounting hardware.

Tools Required

#2 Phillips head screwdriver
2.5 mm Allen wrench (included with base)
4 mm Allen wrench (included with base)
5 mm Allen wrench (included with base)



Do not use on hollow core tables.
Do not rotate or suspend arm beyond table surface.
Do not exceed 16 lb. per Arm.

1 Attach the Single Pole Mount Adaptor to Selected Pole Option

- Place the selected Single Pole Mount Adaptor Assembly (B) on the selected pole option, at your desired monitor height.
- Tighten the clamp screw on the Single Pole Mount Adaptor Assembly with the 5 mm Allen wrench, included with base, to secure Adaptor to Pole.

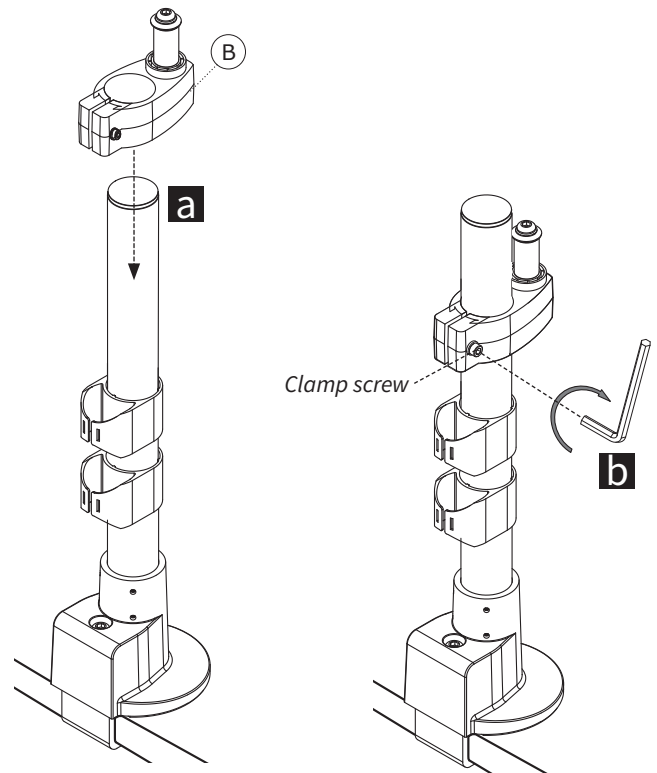

14" Pole shown

2 Attach Conform Static Arms to Single Pole Mount Adaptor

a Remove the Bolt and Washers from Single Pole Mount Adaptor Assembly (B).

b Place the Static Arm (A) on the Pin, resting on the Spacer.

c Assemble the Bolt and Washers as shown.

d Tighten with 5 mm Allen wrench, included with base. Be sure the arm is tight but rotates freely.

e Tighten the pre-installed set screw with 2.5 mm Allen wrench, included with base, to lock in place.

f Snap on Pivot Cover Cap (F)

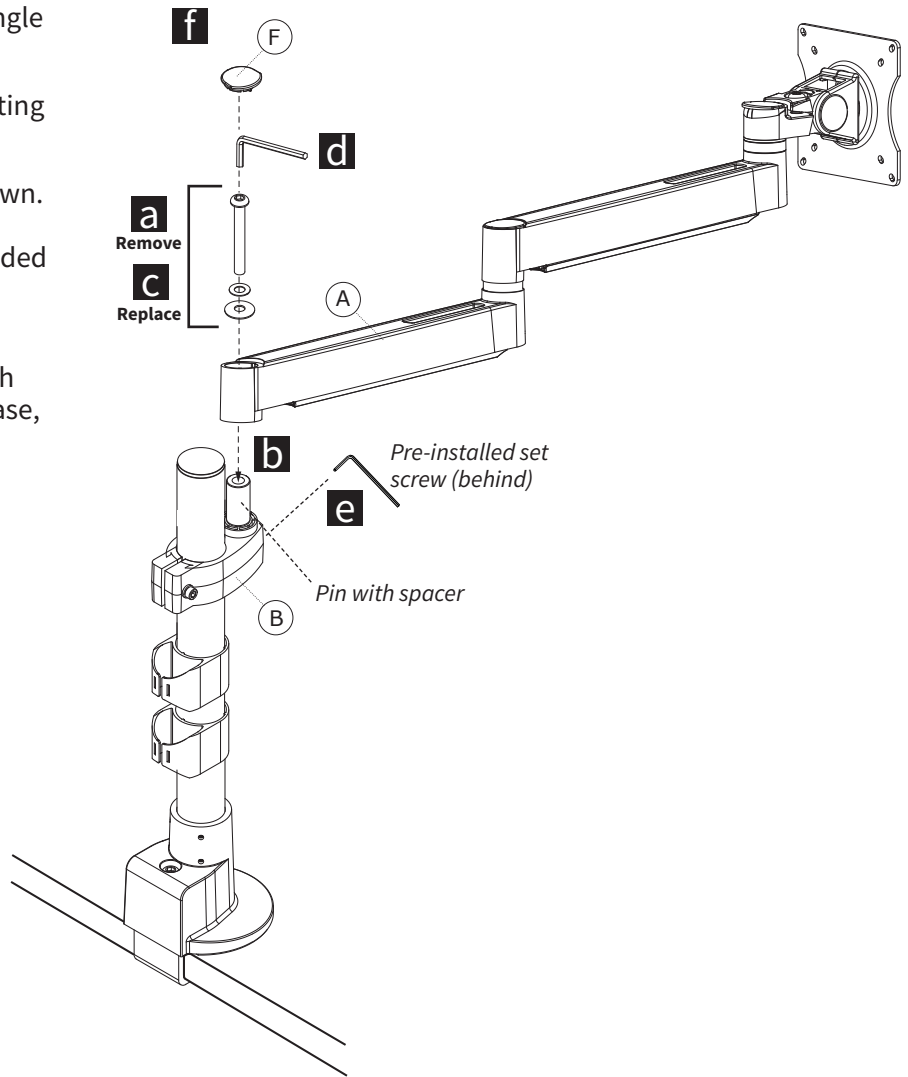

3 Monitor Gap Adjustment for Small Monitors Less Than 17" Actual Width

May be required if you plan to add a second Static Monitor Arm:

Due to shallow depth environments and monitors less than 17" in actual width, consider moving the pivot head to the Slotted Pivot Adjustment area of the arm.

If you are not adding a second Static Monitor Arm, skip to **Step 4**.

- a** Remove cable management covers by sliding them up, then off.
- b** Loosen the set screw using 2.5 mm Allen wrench included with base.
- c** Remove the Pivot Screw using 4 mm Allen wrench included with base.
- d** Remove the Pivot Head.

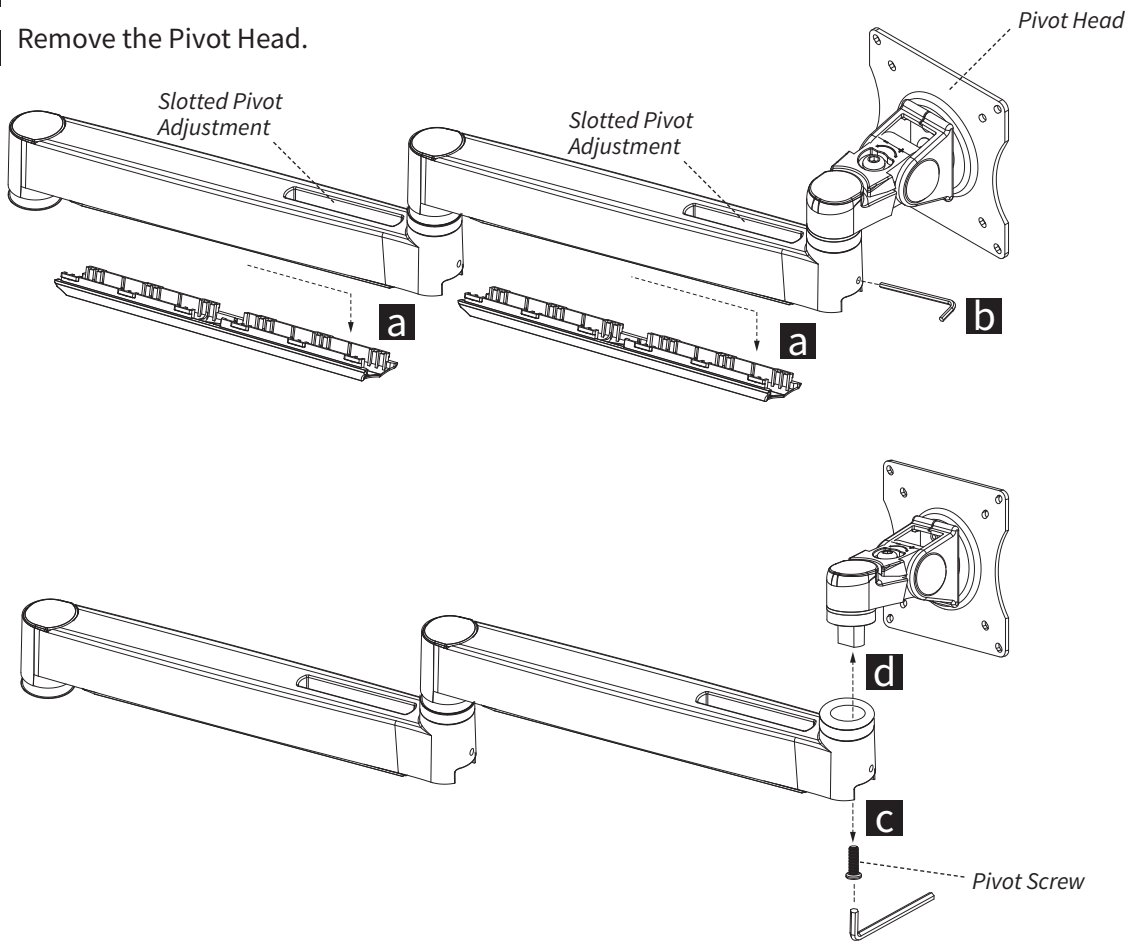

3 Monitor Gap Adjustment (continued)

- e** With Pivot Head removed, place the Wedge Washer (E) onto the post, with the thicker side of the washer toward the pole.
- f** Reassemble the Pivot Head as shown with the Pivot Screw going through the bottom of the Arm Assembly into the Head. Use the 4 mm Allen wrench included with the base to tighten the screw.
- g** Repeat for a second arm, if needed.

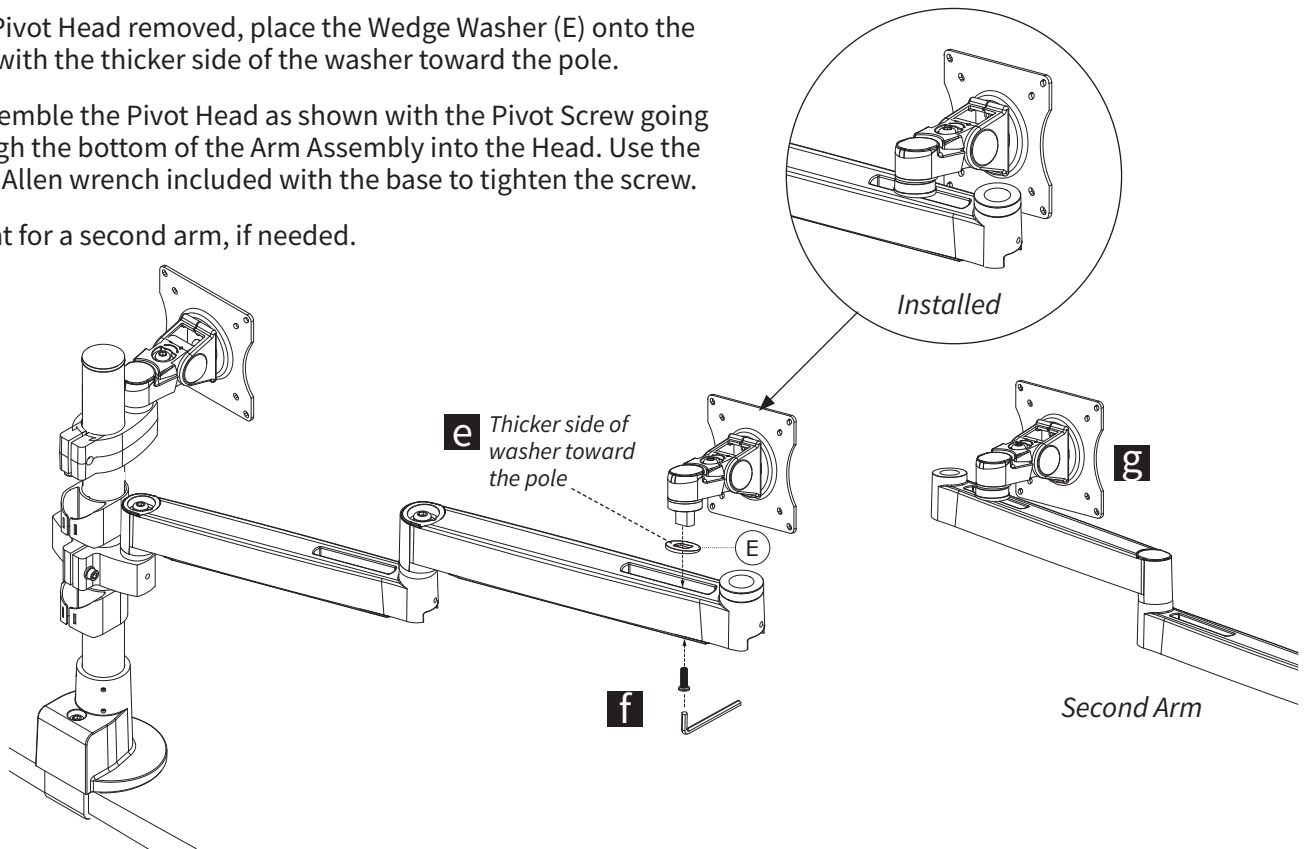

Example Three Monitor Configuration

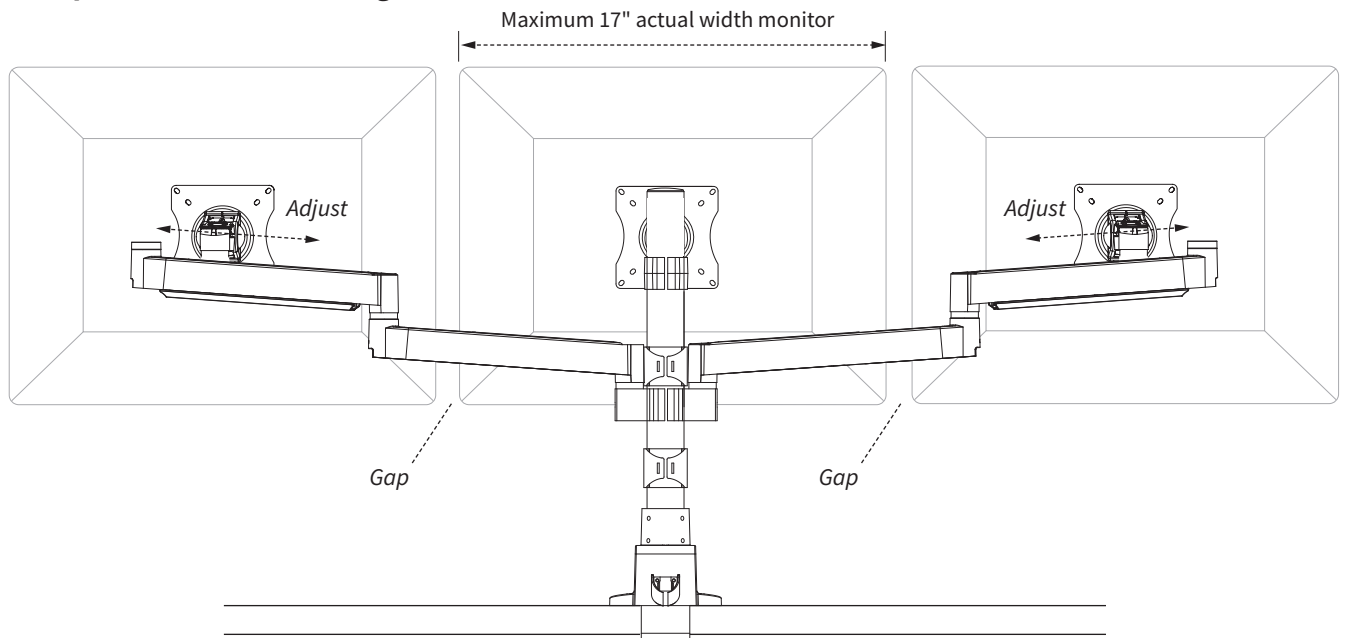



Note: Adjust as needed to reduce gap between monitors.

Once the Pivot Head is installed into the Slotted Pivot Adjustment area, you can install the monitors to the VESA Mount in the following step, then adjust the outside monitors in or out for ideal placement.

4 Attach the Monitor to the Monitor Arm VESA Plate

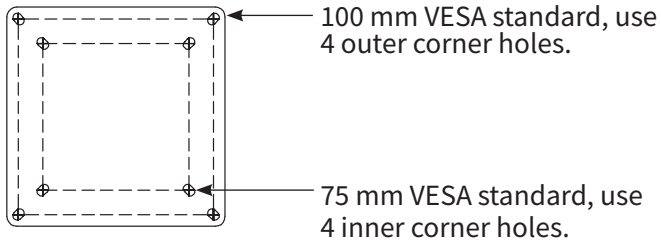
- a Remove the monitor from its stand. Keep the original screws to mount to Conform Arm.
- b Attach the VESA plate to the VESA holes on your monitor. Use the screws from your monitor if possible.



 **Important Note:** It is strongly recommended to use the mounting screws provided by the monitor manufacturer if possible. If longer screws are required, use either part (B) 10 mm, or (C) 6 mm screws supplied. Always use the shortest screws possible to avoid damage to the monitor.

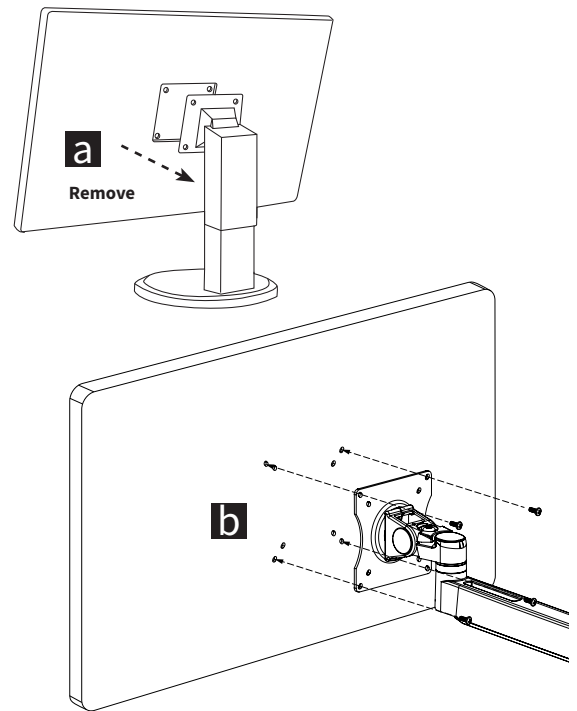

5 Monitor Tilt Capacity Adjustment

If your monitor is too light or too heavy for the factory set capacity, the monitor will tilt too easily. If this is the case, you need to adjust the tension.

Adjusting Tilt Capacity

To increase capacity(+) turn clockwise using a 5 mm Allen wrench (included with base) until the monitor reaches a balanced adjustment.

To decrease capacity(-) turn counter-clockwise until the monitor reaches a balanced adjustment.

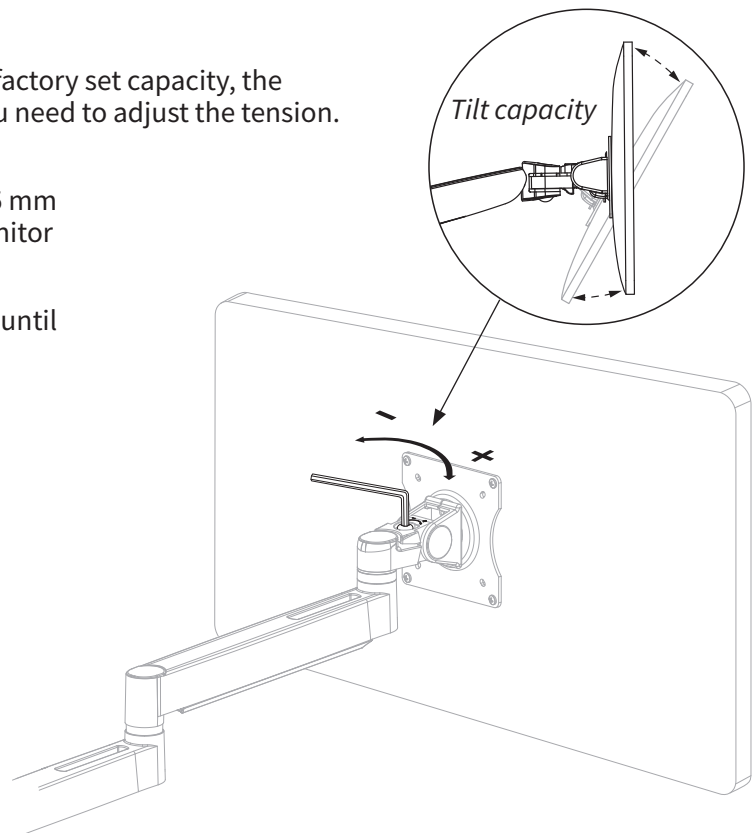

6 Cable Management

- a** Remove the arm covers by sliding them up, then off.
- b** Secure cables with Hook & Loop (G) strips. Slide covers on, then down to secure.
- c** Route through Cable Management clips on pole.

Note: Leave sufficient slack in the cables to allow free movement of arm.

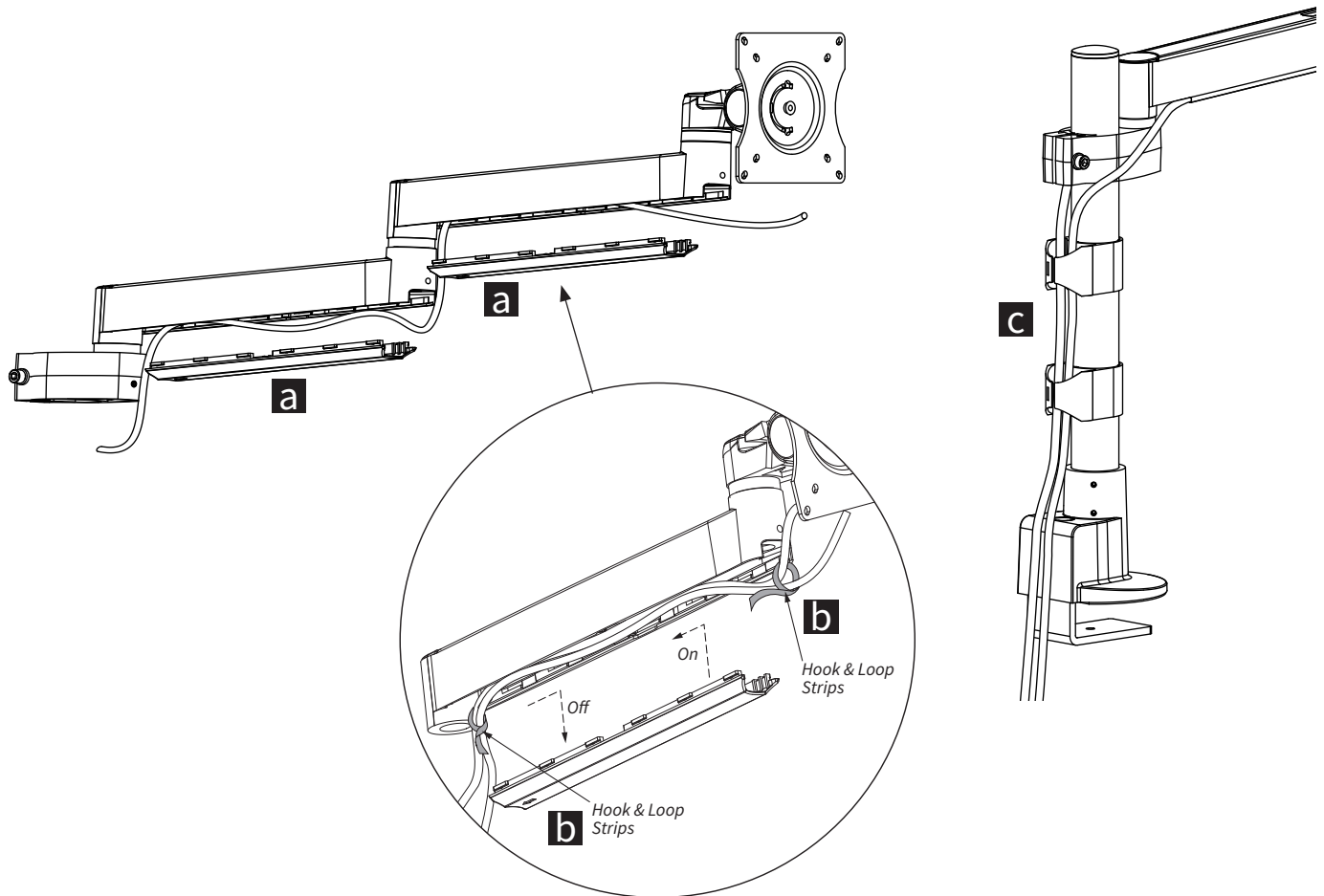

✓ Parts & Support

14" Pole Base with C-Clamp & Grommet	CONF-PB-14CCG-S
28" Pole Base with Heavy Duty C-Clamp & Grommet	CONF-PB-28HDCCG-S
Tool Bar & Slatwall Base	CONF-BSE-TSB-S
Wall Plate Base	CONF-BSE-WP-S
Static Extension Arm	CONF-ACC-1EXT-S
Single Pole Mount Adaptor	CONF-ADPT-SPM-S
Dual Pole Mount Adaptor	CONF-ADPT-DPM-S
Quick Release Adaptor	MON-ADPTVQR-W-B

Technical Support: Please call Workrite Technical Support while at the Workrite product. (800) 959-9675 option 2.