



COMPACT FOOTPRINT MAXIMIZES DESK SPACE

The Conform Dual Static Arm is designed to provide side-by-side support for two monitors in a compact footprint. As part of the Conform family it uses the Workrite pin connection system, allowing it to be quickly mounted to a variety of bases and reconfigured with additional Conform monitor arms to adapt to your changing needs. Easily create a quadruple monitor system by using a 28" pole mount and two Conform Dual Static Arms. The Conform Dual Static Arm has been engineered to support over 15,000 cycles and exceeds ANSI/BIFMA X5.5 requirements. TAA Compliant.



Dual pole mount adaptor with interchangeable pin system ensures future adaptability

CONFORM DUAL STATIC ARM

Benefits:

- Enhance performance through ergonomic comfort
- Rigid support for monitors from 0–16 lb. each
- Expandable, interchangeable components ensure future adaptability
- Designed for fast, easy installation
- Easily route and conceal cables through the integrated wire managers
- Compact footprint allows users to maximize their desk space
- Discrete silver color and design blends into office environments

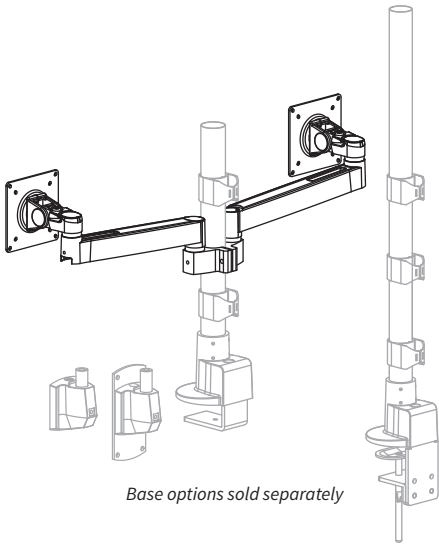

Dimensions

Reach & pivot

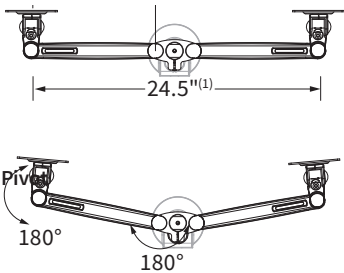

Tilt & rotate

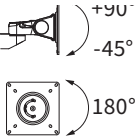

Stowed depth

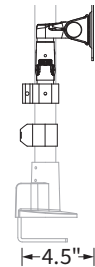

(1) Adjustment decreases as monitor width increases on dual arm configurations. Values shown are maximums.

Preconfigured Conform Dual Static

Dual Static Arm with 14" Pole Base

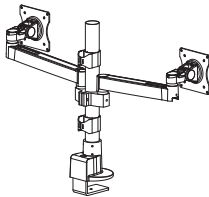

- Arm
- Supports two monitors 0–16 lb each
 - Maximum monitor height: Pole dependent
 - Articulation range: 0" (static arm)
 - Forward reach: 4.5" with 24" wide monitor ⁽¹⁾
 - Stowed depth: 4.5"
 - Monitor :
 - Tilt: +90°/-45°
 - Pivot: +/-90°
 - Rotation: +/-90°
 - Standard VESA (75 mm & 100 mm)
 - Warranty: 10 year

Model #	Weight	US \$ List	CAN \$ List
CONF-2SDS-PB-14CCG-S	18	\$358	\$459

- Base
- Convenient top adjusting C-clamp design
 - Includes both C-clamp & grommet mounting hardware
 - 14" pole length
 - Supports 1–3 monitors up to 48 lb



Products listed on this page are available through GSA Contract GS-28F-0030S SIN #711-2 (Schedule 71).

CONFORM DUAL STATIC ARM

Stand Alone Conform Arms

Dual Static Arm

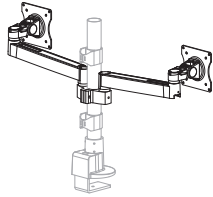

- Supports two monitors 0–16 lb each
- Maximum monitor height: Pole dependent
- Articulation range: 0" (static arm)
- Forward reach: 4.5" with 24" wide monitor ⁽¹⁾
- Stowed depth: 4.5"
- Monitor :
 - Tilt: +90°/-45°
 - Pivot: +/-90°
 - Rotation: +/-90°
- Standard VESA (75 mm & 100 mm)
- Warranty: 10 year

Model #	Weight	US \$ List	CAN \$ List
CONF-2SDS-WOPB-S	12	\$256	\$328

Stand Alone Conform Bases

14" Pole with C-Clamp & Grommet Base

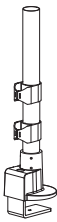

- For use with Static Monitor Arms; or Articulating Arms w/ Pole Mount Adapter
- Includes both C-clamp & grommet mounting options
- Convenient top adjustment C-clamp design
- Supports 1–3 monitors, up to 48 lb

Dimensions	Model#	Weight	US \$ List	CAN \$ List
	CONF-PB-14CCG-S	6	\$102	\$131

14" Heavy Duty Pole with C-Clamp & Grommet Base

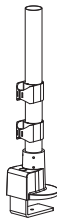

- For use with Static Monitor Arms; or Articulating Arms w/ Pole Mount Adapter
- 14" pole, heavy duty C-clamp & grommet mounting options
- Designed for robust applications
- Heavy duty C-clamp design
- Supports up to 96 lb

CONF-PB-14HDCCG-S	6	\$123	\$164
-------------------	---	-------	-------

28" Pole, Heavy Duty C-Clamp & Grommet Base

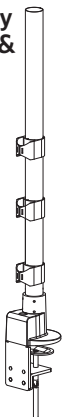

- Designed for stacked monitor applications
- For use with Static Monitor Arms; or Articulating Arms w/ Pole Mount Adapter
- Includes both C-clamp & grommet mounting options
- Heavy duty C-clamp design
- Supports 1–6 monitors, up to 96 lb

C-Clamp

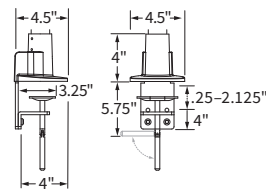

Grommet

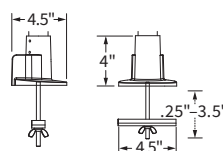

Pole Range

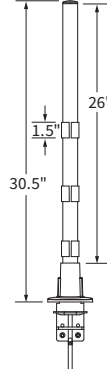

Recommended Configuration

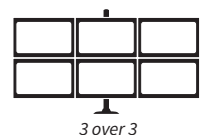



Products listed on this page are available through GSA Contract GS-28F-0030S SIN #711-2 (Schedule 71).

CONFORM DUAL STATIC ARM

Stand Alone Conform Bases

Tool Bar & Slatwall Base



- For use with articulating or Static Monitor Arms
- Easily mount to Tool Bars, Privacy Panels & Slatwall Panels
- Clamping design supports slat rails up to 1.25" wide
- Supports up to 48 lb

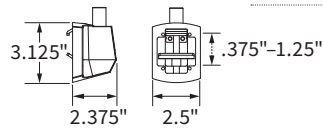

Model#	Weight	US \$ List	CAN \$ List
CONF-BSE-TSB-S	2	\$57	\$73

Wall Plate Base

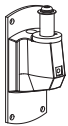

- For use with Articulating or Static Monitor Arms
- Wall mount to concrete, steel or drywall
 - Mounting hardware not included
- Supports up to 48 lb

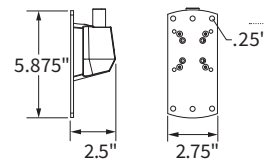

Model#	Weight	US \$ List	CAN \$ List
CONF-BSE-WP-S	2	\$57	\$73

Conform Accessories & Parts

Dual Arm Adaptor



- For use with Articulating or Static Monitor Arms
- Converts single arm base options into dual arm base
- Supports up to 48 lb

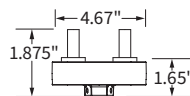

Model#	Weight	US \$ List	CAN \$ List
CONF-ADPT-DA-S	2	\$40	\$51

Single & Dual Pole Adaptors

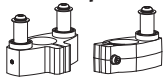

- For use with Articulating or Static Monitor Arms
- Mount one or two Articulating Arms or Static Arms to a pole
- Supports up to 48 lb

Model#	Weight	US \$ List	CAN \$ List
Single CONF-ADPT-SPM-S	1	\$67	\$86
Dual CONF-ADPT-DPM-S	1	\$77	\$99