

# ergotron®

---

## WorkFit™ B, HD

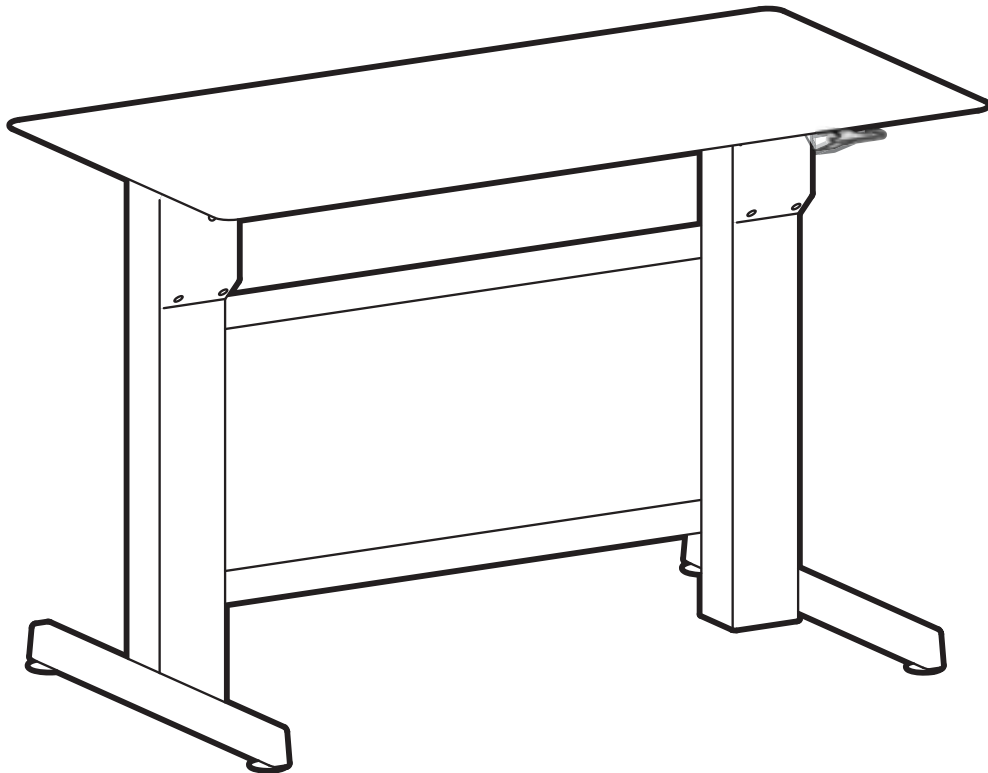

---

**English**







For the latest User Installation Guide please visit: [www.ergotron.com](http://www.ergotron.com)

English, Español, Français, Deutsch, Nederlands, Italiano, Svenska, 日本語, 汉语

[www.ergotron.com](http://www.ergotron.com) | USA: 1-800-888-8458 | Europe: +31 (0)33-45 45 600 | China: 400-120-3051 | Japan: [japansupport@ergotron.com](mailto:japansupport@ergotron.com)

# Hazard Symbols Review



These symbols alert users of a safety condition that demands attention. All users should be able to recognize and understand the significance of the following Safety Hazards if encountered on the product or within the documentation. Children who are not able to recognize and respond appropriately to Safety Alerts should not use this product without adult supervision!

Symbol	Signal Word	Level of Hazard
	<b>NOTE</b>	A NOTE indicates important information that helps you make better use of this product.
	<b>CAUTION</b>	A CAUTION indicates either potential damage to hardware or loss of data and tells you how to avoid the problem.
	<b>WARNING</b>	A WARNING indicates either potential for property damage, personal injury, or death.
	<b>ELECTRICAL</b>	An Electrical indicates an impending electrical hazard which, if not avoided, may result in personal injury, fire and/or death.

## Safety

 **WARNING**

**IMPACT HAZARD**

**Moving Parts Can Crush And Cut**

**Minimize Lift Strength BEFORE:**  
- Removing Mounted Equipment  
**and**  
**Insert 4 Stop Screws BEFORE:**  
- Shipping or Storing (i.e. when Desk is not upright).

**To Minimize Lift Strength**  
Refer to installation manual for instructions on how to minimize lift strength.

**To Insert 4 Stop Screws**  
Refer to installation manual for instructions on installing stop screws.

**Failure to heed this warning may result in serious personal injury or property damage!**

For More information and instructions visit [www.ergotron.com](http://www.ergotron.com)  
or contact Ergotron Customer Care at **1-800-888-8458**.

826-901-00

Refer to Appendix A at the end of this manual  
Refer to Appendix B at the end of this manual

# Safety



**WARNING!** Stop screws are pre-installed in this product to secure it in the compressed position during shipping and installation. **DO NOT REMOVE THESE SCREWS UNTIL INSTRUCTED TO DO SO IN THESE INSTRUCTIONS.** Make sure these screws are in place before starting installation. Failure to follow these instructions may cause lift engine to expand rapidly and may result in equipment damage and or personal injury. If any of the 4 stop screws are not installed in these locations, contact customer care before continuing with installation.

**DO NOT REMOVE SCREWS!**

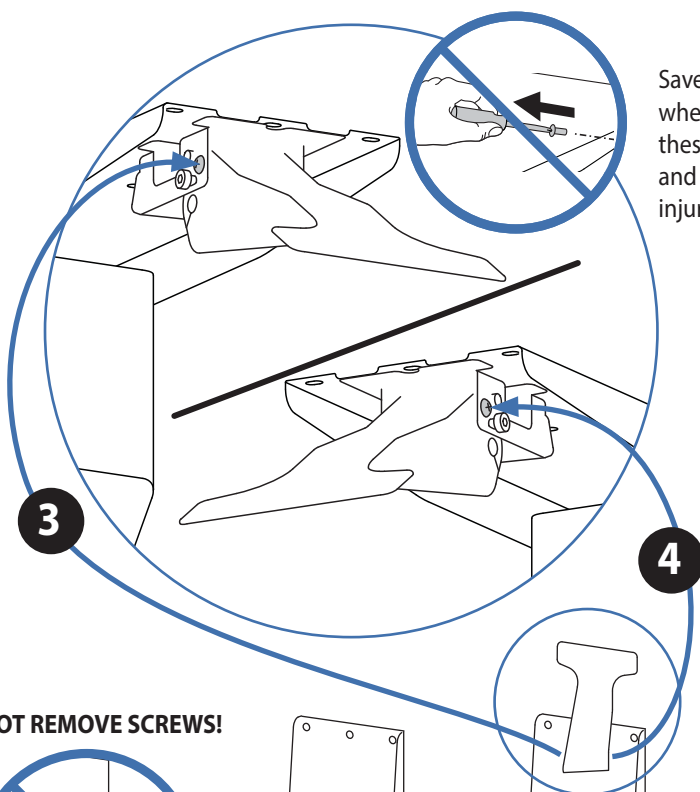

**IMPORTANT!**

Save these stop screws and instructions. Install stop screws when shipping or storing this product. Failure to follow these instructions may cause lift engine to expand rapidly and may result in equipment damage and or personal injury.

**DO NOT REMOVE SCREWS!**

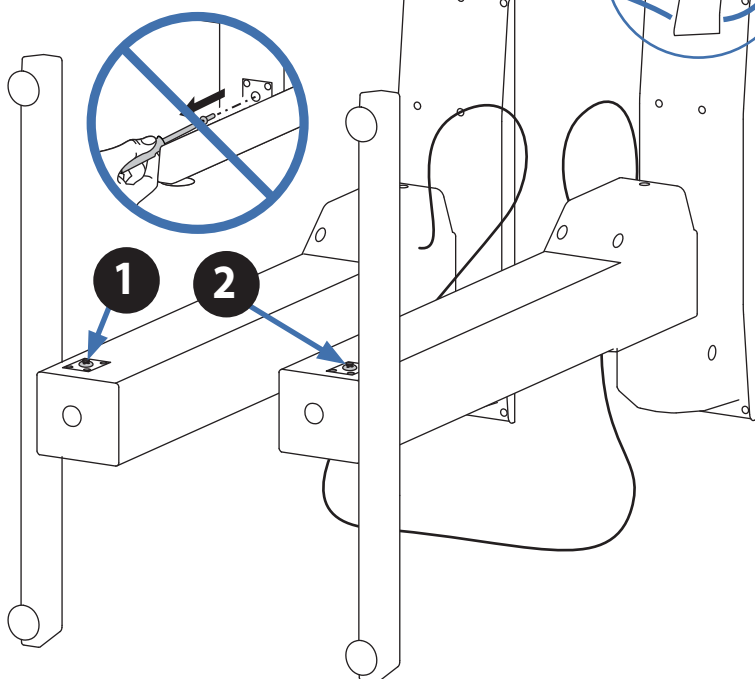

# Safety



Important! You will need to adjust this product after installation is complete. Make sure all your equipment is properly installed on the product before attempting adjustments. This product should move smoothly and easily through the full range of motion and stay where you set it. If movements are too easy or difficult or if product does not stay in desired positions, follow the adjustment instructions to create smooth and easy movements. Depending on your product and the adjustment, it may take many turns to notice a difference. Any time equipment is added or removed from this product, resulting in a change in the weight of the mounted load, you should repeat these adjustment steps to ensure safe and optimum operation.

## **WARNING**

### **Keep Brake Cables Away from Sync Rod and Crossbars During Installation!**

Failure to keep the brake cables away from sync rod and crossbars may restrict lift motion and may cause equipment damage or personal injury! Refer to instruction manual for more information.

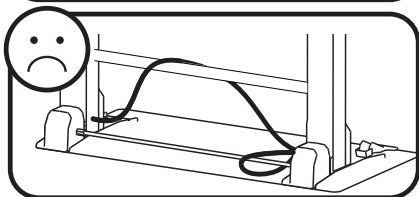
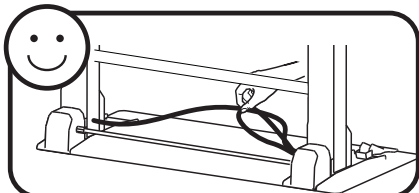

### **WARNING! TIPPING HAZARD!**

**When mounting accessories to the WorkFit-D, they must stay within the foot print. Do not mount accessories past the front and rear worksurface! Failure to follow this warning may result in equipment damage and or personal injury.**

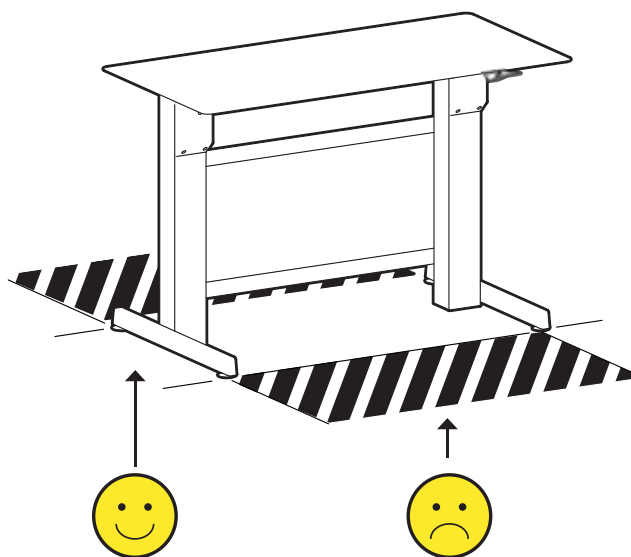

## Features & Specifications

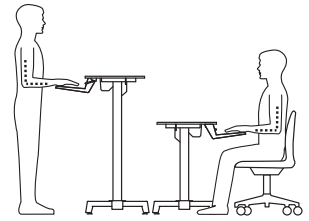
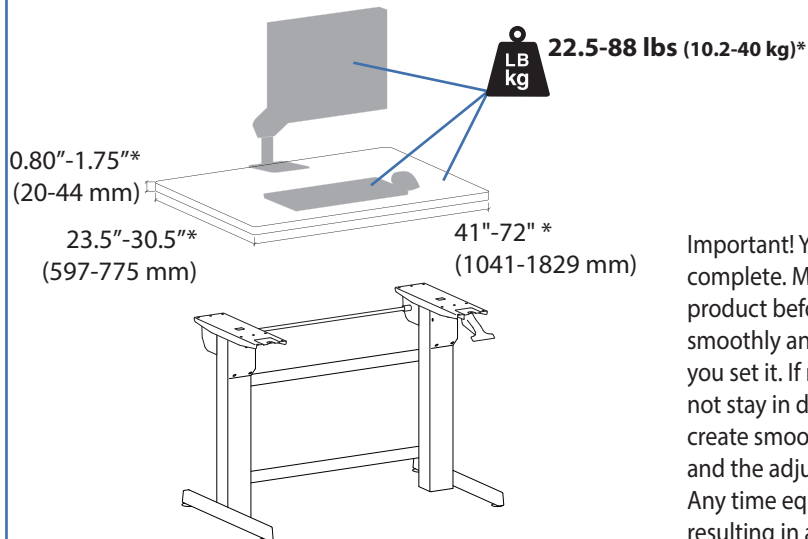

Important! You will need to adjust this product after installation is complete. Make sure all your equipment is properly installed on the product before attempting adjustments. This product should move smoothly and easily through the full range of motion and stay where you set it. If movements are too easy or difficult or if product does not stay in desired positions, follow the adjustment instructions to create smooth and easy movements. Depending on your product and the adjustment, it may take many turns to notice a difference. Any time equipment is added or removed from this product, resulting in a change in the weight of the mounted load, you should repeat these adjustment steps to ensure safe and optimum operation.

Wood Worksurface Weight Estimator	
Worksurface Thickness	Estimated Weight per square foot
0.80" (20 mm)	2.9 lbs (1.32 kg)
1.25" (32 mm)	4.5 lbs (2.04 kg)
1.75" (44 mm)	6.3 lbs (2.86 kg)



\*Total weight of worksurface and mounted equipment must be  $\leq 88$  lbs (40 kg).  
Worksurface must meet ALL dimensional and weight range specification requirements.



**WARNING!** The addition of accessories can negatively impact the tip performance.

**WORKSURFACE TEMPLATE FOR WORKFIT-B, HD**

Lay this template on the bottom of your worksurface to drill the holes to attach the WorkFit-B, Base.

**Align BEAS Edge of Worksurface** Distance from the back of the Base Brackets. See table for value of **X** based on the depth of your worksurface.

**Back of Base Bracket**

**Depth of Worksurface**

Depth of Worksurface	Depth of Worksurface
23.50 - 24.25" 0-25"	100 - 616 mm 4-inches
24.25 - 25.00" 0-25"	616 - 630 mm 19 inches
25.00 - 25.75" 1-25"	630 - 654 mm 22 inches
25.75 - 26.50" 1-25"	654 - 673 mm 24 inches
26.50 - 27.25" 1-25"	673 - 682 mm 27 inches
27.25 - 28.00" 1-25"	682 - 711 mm 30 inches
28.00 - 28.75" 1-25"	711 - 735 mm 33 inches
28.75 - 29.50" 1-25"	735 - 748 mm 35 inches
29.50 - 30.25" 1-25"	748 - 768 mm 38 inches

**Use Drill Bit #46, Ø 0.081" (2mm) to drill these 3 holes 0.24" (6 mm) deep.**

**Center Point of Base Brackets**

**Use Drill Bit #21, Ø 0.119" (4.0 mm) to drill these 8 holes 0.375" (9.5 mm) deep.**

**Center Worksurface from Side-to-Side Across Base Brackets.**

**Failure to follow these instructions may make this product unstable and may result in equipment damage and/or personal injury.**

**TIPPING HAZARD!**

**Brake Release**

**DIMENSIONS ARE IN INCHES**

**ERGOTRON**  
www.ergotron.com  
1-800-541-0000  
© 2009, all rights reserved by Ergotron, Inc.

620 020806 Rev 01/12

## A diagram of a spirit level, which is a tool used to check if a surface is horizontal or vertical. It consists of a long, rectangular body with a circular vial inside containing liquid and a bubble. The bubble's position indicates the level. The diagram shows the level tilted at an angle, with the bubble near the right end.

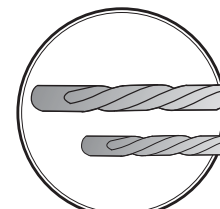
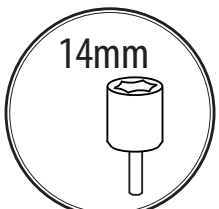
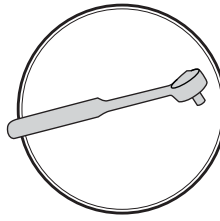
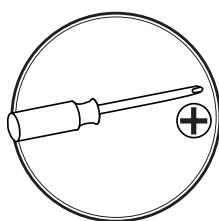

• #46, Ø 0.081" (2mm)

# Set-up Steps

- 1 Place the worksurface on a clean floor with the top side facing down.

Center Template Side-to-Side on worksurface.

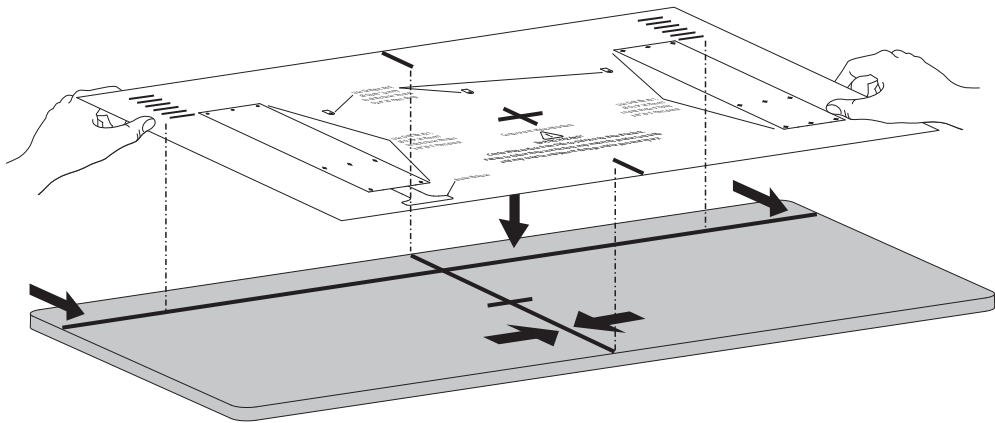

Align REAR Edge of Worksurface X distance from the back of the Base Brackets. See table for value of X based on the depth of your worksurface.

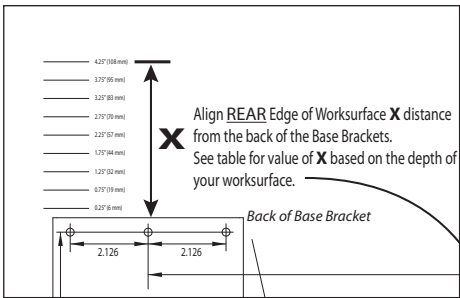
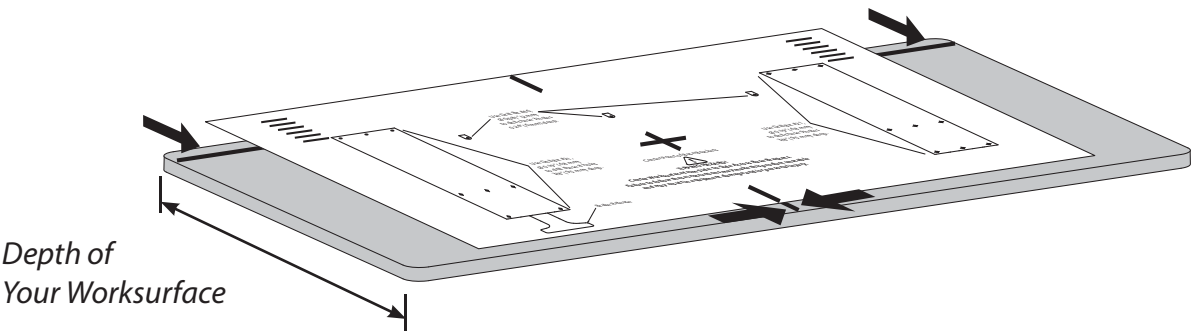

Depth of Worksurface	X	Depth of Worksurface	X
23.50 - 24.25"	0.25"	597 - 616 mm	6 mm
24.25 - 25.00"	0.75"	616 - 635 mm	19 mm
25.00 - 25.75"	1.25"	635 - 654 mm	32 mm
25.75 - 26.50"	1.75"	654 - 673 mm	44 mm
26.50 - 27.25"	2.25"	673 - 692 mm	57 mm
27.25 - 28.00"	2.75"	692 - 711 mm	70 mm
28.00 - 28.75"	3.25"	711 - 730 mm	83 mm
28.75 - 29.50"	3.75"	730 - 749 mm	95 mm
29.50 - 30.25"	4.25"	749 - 768 mm	108 mm

Tape Template in place.

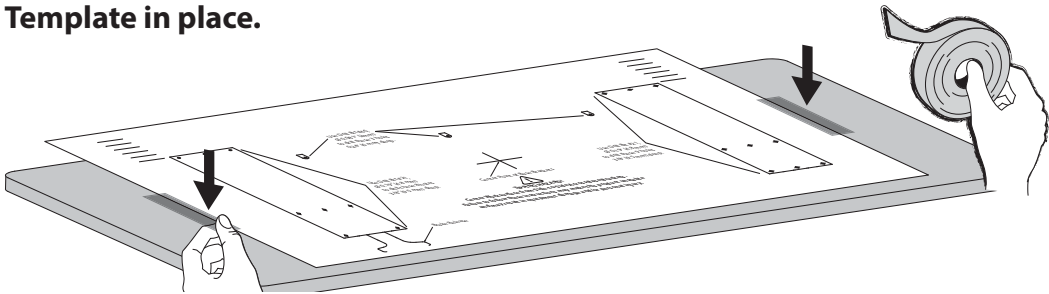

# Set-up Steps

Using the specified drill bit, drill the 17 holes for base.



#12, Ø 0.19" (4.8mm)

Drill holes 0.375" (9.5 mm) deep.

TIP: To ensure proper depth, place a piece of tape on the drill bit 0.375" (9.5 mm) from the tip.

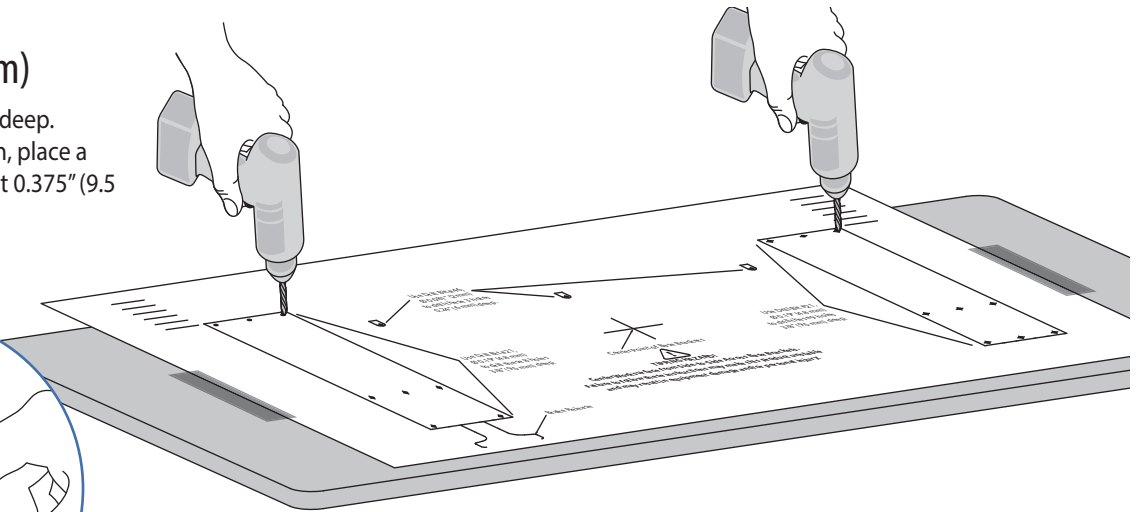
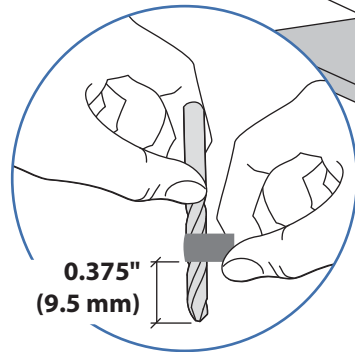

Using the specified drill bit, drill the 3 holes for cable clips.



#46, Ø 0.081" (2mm)

Drill holes 0.24" (6 mm) deep.

TIP: To ensure proper depth, place a piece of tape on the drill bit 0.24" (6 mm) from the tip.

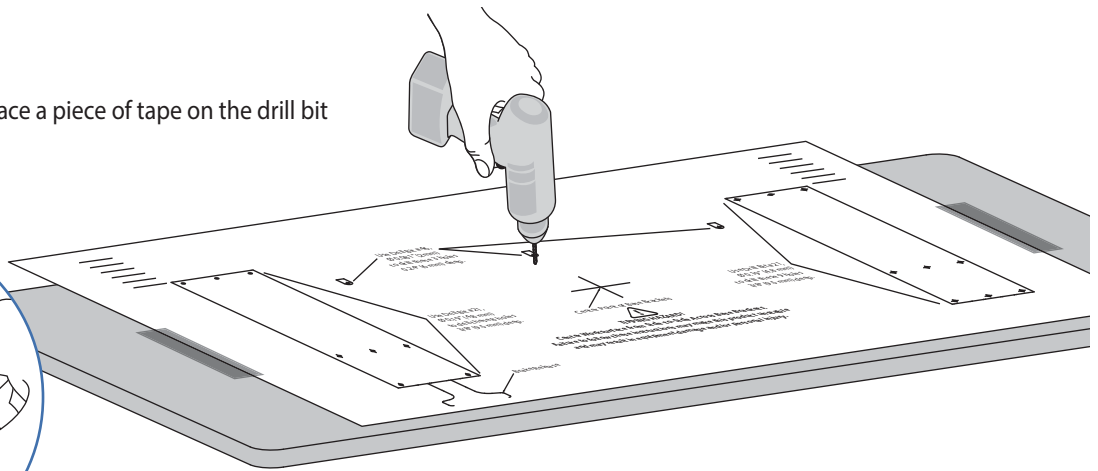
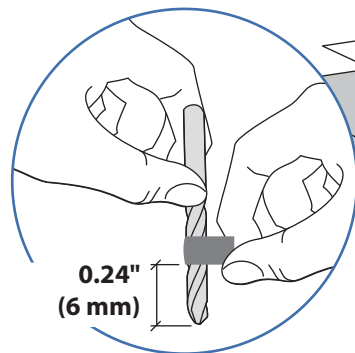

Remove Template.

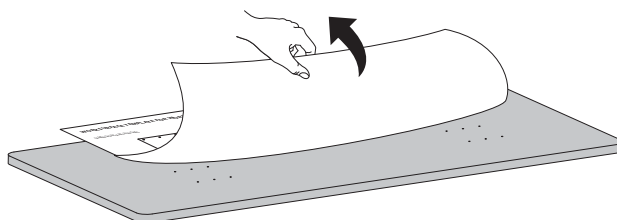

# Set-up Steps

**2** Place the worksurface on a clean floor with the top side facing down.

Carefully position the leg with the hand brake on the right end of the worksurface. Place the other leg on the left end.

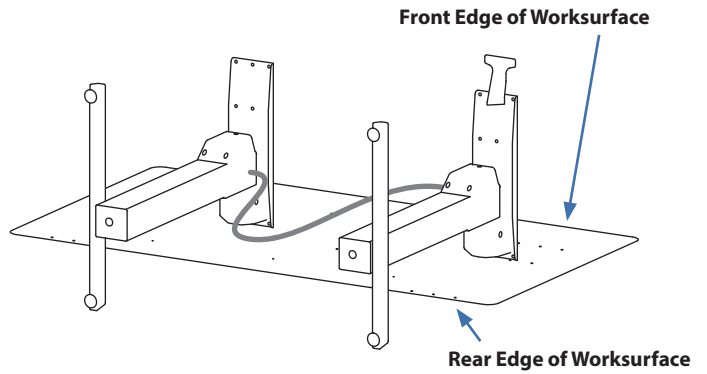

**NOTE:** The brake cable is attached to both legs. Take care when removing the legs from the packaging to avoid damaging or pulling the brake cable from the legs.

**3** Set the right leg (with hand brake) upright on the worksurface.

Partially insert 3 of the provided #12-14 wood screws at the rear of the leg, 3 near the middle of the leg and 2 at the front of the leg.

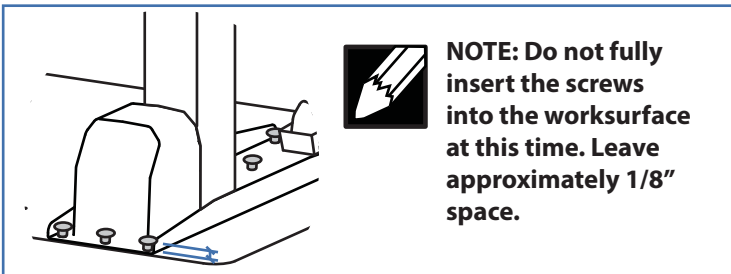
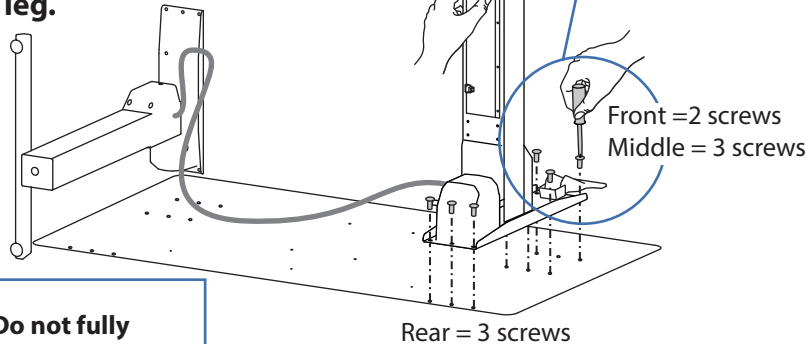
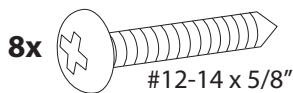

**4** Attach one end of the sync rod to the right leg as illustrated. Make sure the brake cables don't loop around the sync rod. See Warning, right.

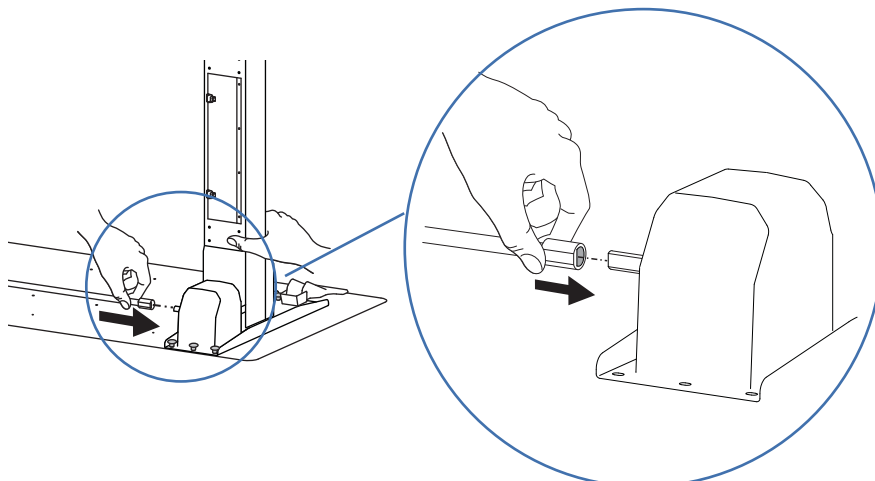

## ! WARNING

**Keep Brake Cables Away from Sync Rod and Crossbars During Installation!**

Failure to keep the brake cables away from sync rod and crossbars may restrict lift motion and may cause equipment damage or personal injury! Refer to instruction manual for more information.

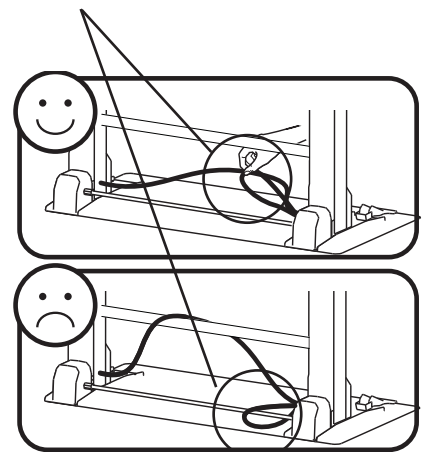

# Set-up Steps

- 5** Set the left leg (without hand brake) upright on the worksurface. Attach the left end of the sync rod to the left leg. Make sure the brake cables don't loop around the sync rod. See Warning, right.

- 6** Partially insert 9 of the provided #12-14 wood screws in the left leg and worksurface.

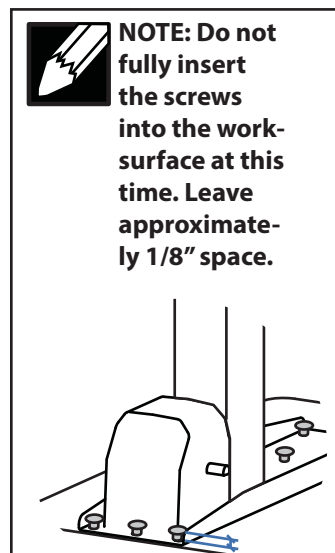
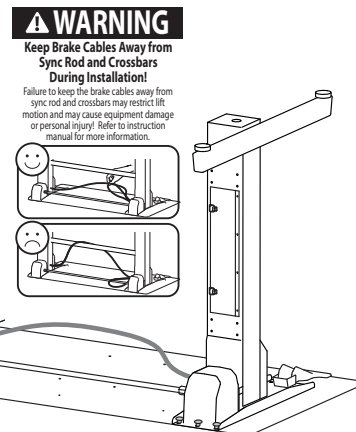
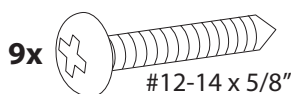
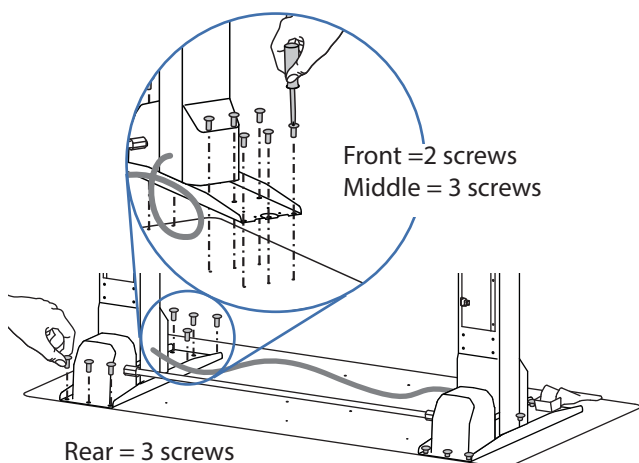

- 7** Use a Phillips screwdriver to insert the provided M5x6 mm screws into the two crossbars connecting the left and right legs. Make sure the brake cables don't loop around the crossbars.



**Tighten the screws slightly one at a time and repeat to ensure that the tension on every screw is equal.**



**NOTE:** Do not overtighten screws. overtightening screws may result in stripping the holes and may cause the installation to be unsafe.

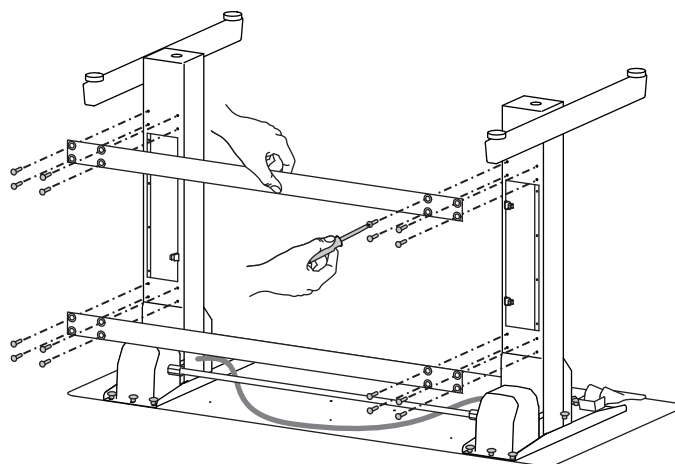

- 8** Use a Phillips screwdriver to tighten down the screws attaching the legs to the worksurface.



**NOTE:** Do not overtighten screws. overtightening screws may result in stripping the holes and may cause the installation to be unsafe.

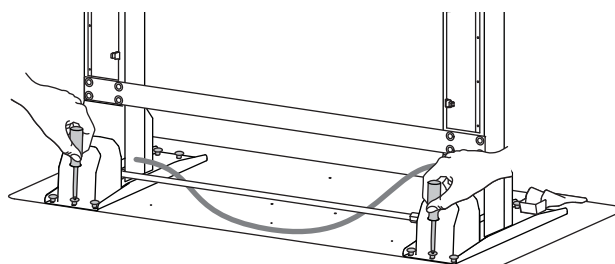

# Set-up Steps

- 9** If your brake release handle is not aligned with the front edge of your worksurface and you would like it to be, follow these instructions to relocate the brake release handle.

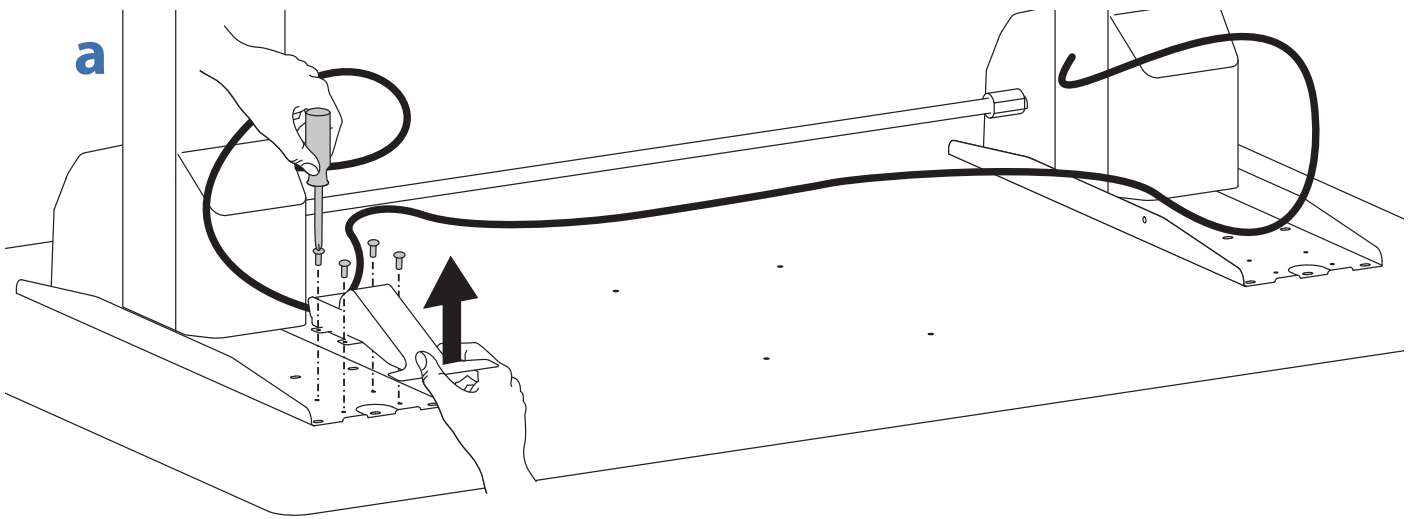

- b** Relocate brake release handle along front edge of worksurface and next to the inside of the leg only. **DO NOT** attach brake release handle in front of or to the outside of the leg. Make sure cable has enough slack to allow worksurface to fully extend up and down.

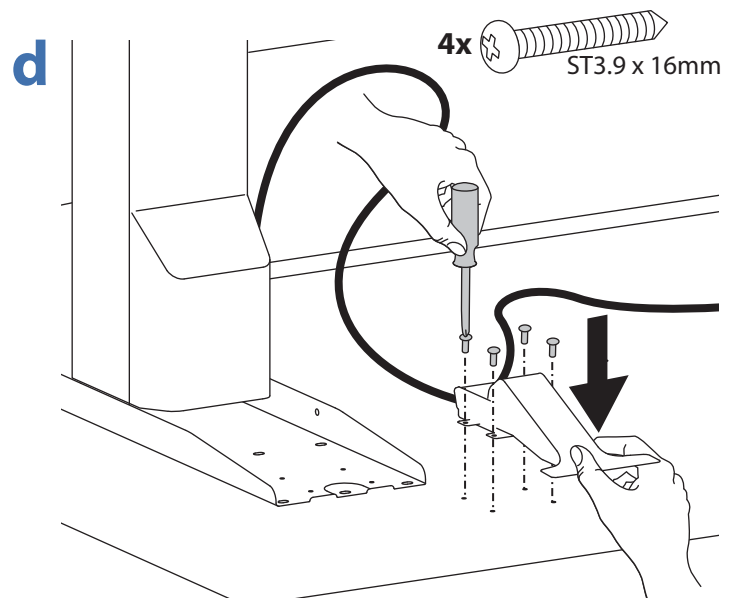
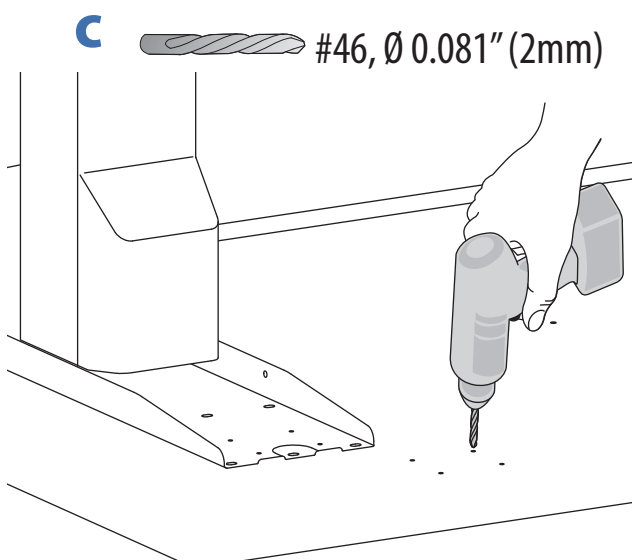
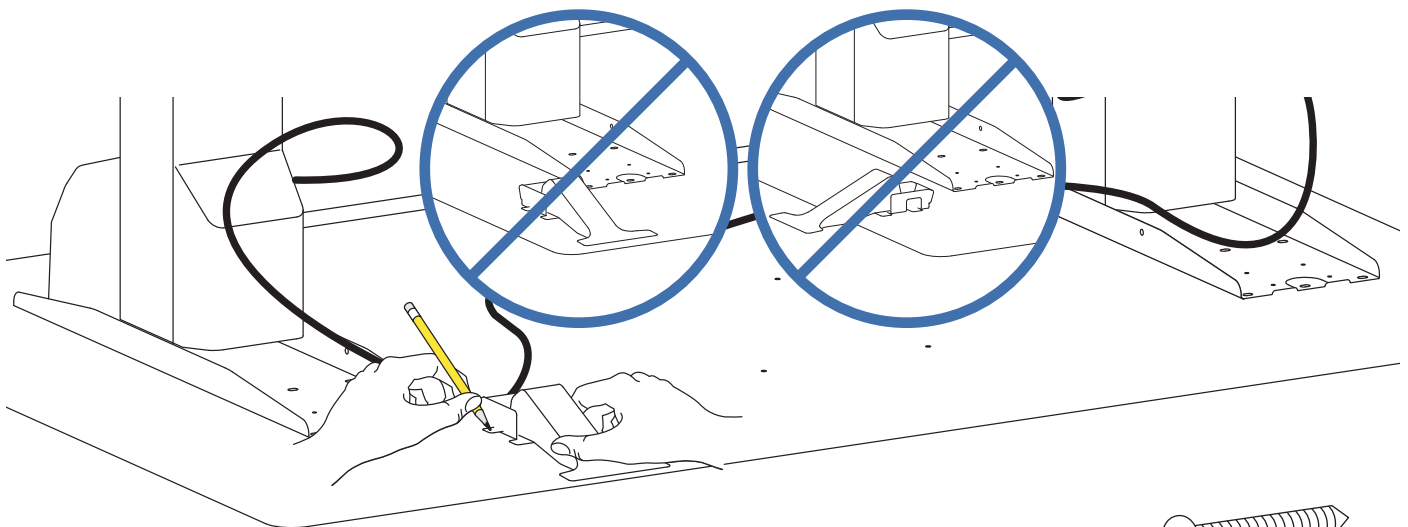

## Set-up Steps

- 10** Capture the brake cable in the cable clip as illustrated, then use a Phillips screwdriver to attach the cable clips to bottom of work surface with the provided M2.9 x 8 mm screws.

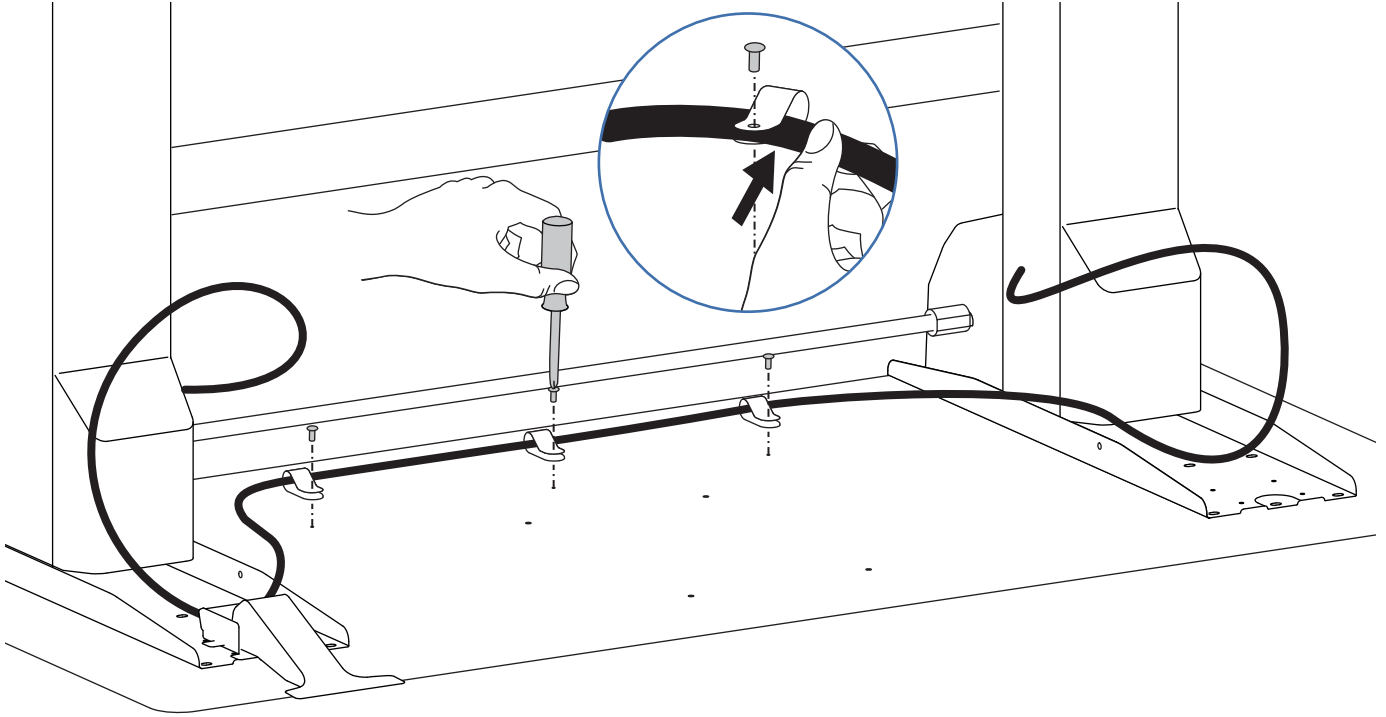

- 11** Using the 2 provided cable ties, attach brake cable to the legs leaving as much slack in cable as possible between the cable tie and the leg to allow desk top to raise up unrestricted.

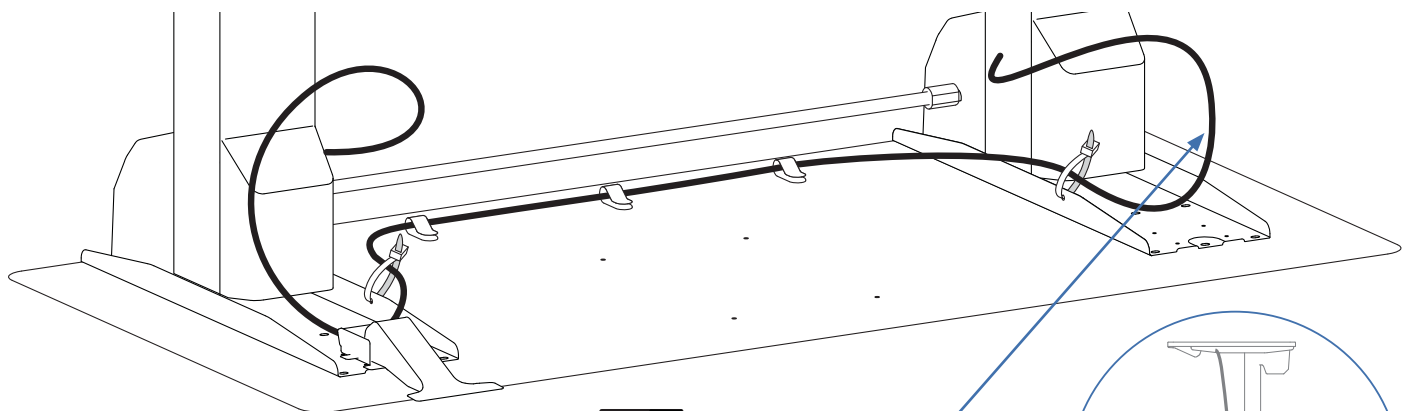
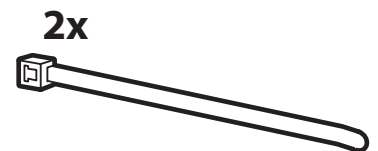

**NOTE:** Leave as much slack in cable as possible between the cable tie and the leg to allow desk top to raise up unrestricted. Failure to follow this may result in equipment damage.

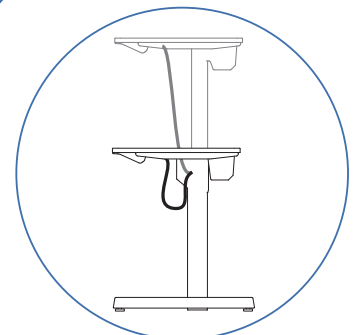

## Set-up Steps

### 12 Set the desk upright onto its legs.

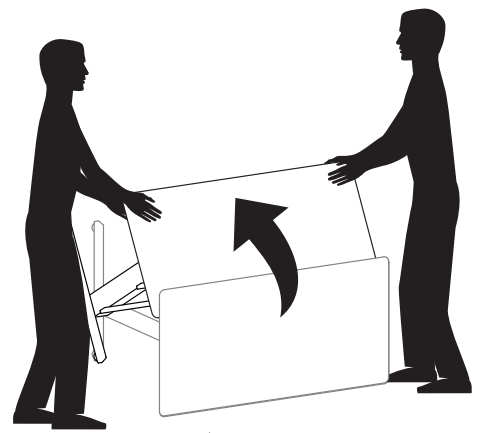
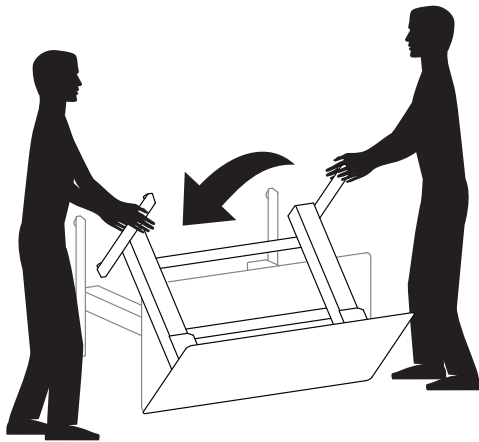

**CAUTION!**  
**LIFT HAZARD!**

Two persons are required for this step. Failure to follow this warning may result in equipment damage and or personal injury.

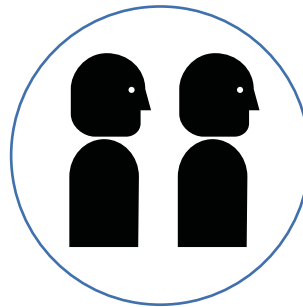

### 13 Adjust the riser on each leg and check with a level to make sure the work surface is even.

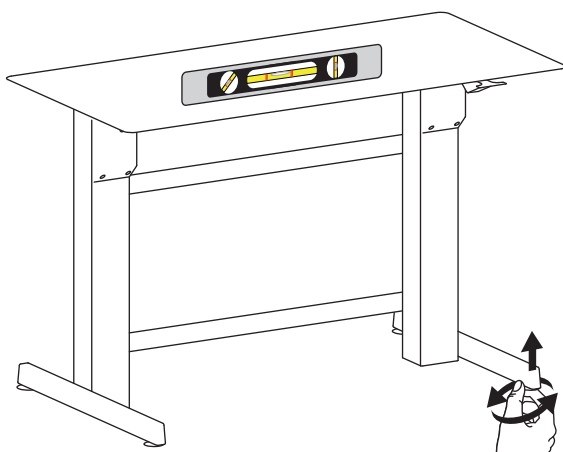

**Spin Left to Raise.**

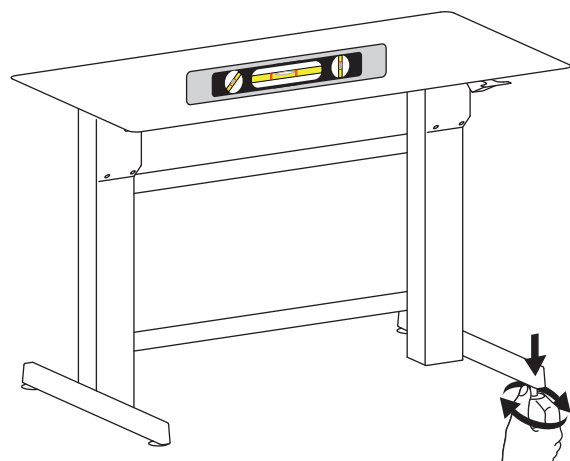

**Spin Right to Lower.**

# Set-up Steps

## 14

Remove the 4 brake stop screws before installing equipment.

Remove the 2 stop screws from the legs then the 2 stop screws from the brake to allow the worksurface to raise and lower.

### IMPORTANT!

Save these stop screws and instructions. Install stop screws when shipping or storing this product. Failure to follow these instructions may cause lift engine to expand rapidly and may result in equipment damage and or personal injury.

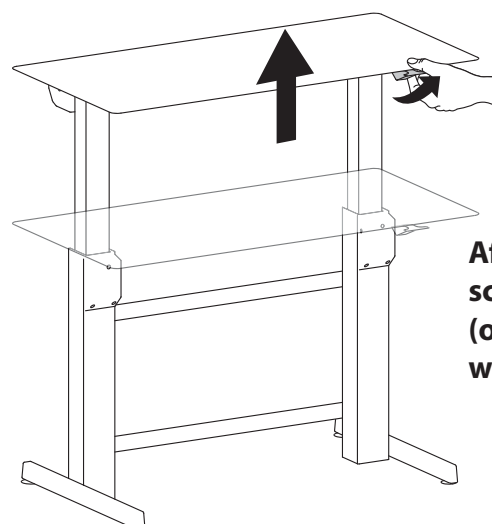
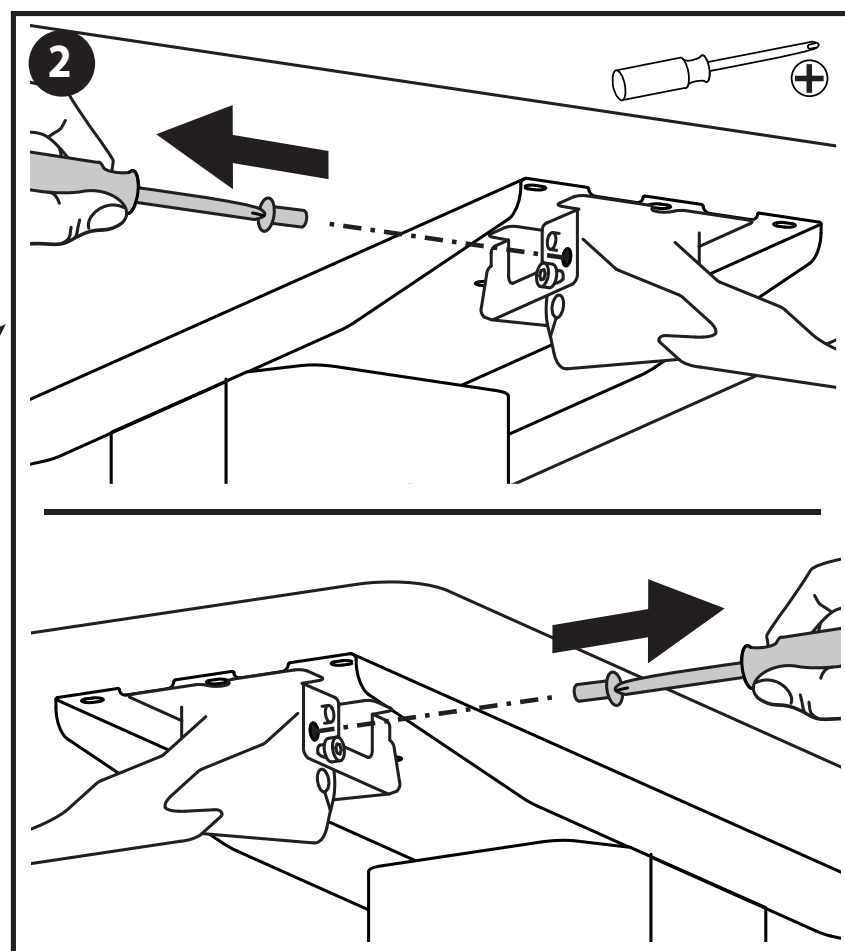
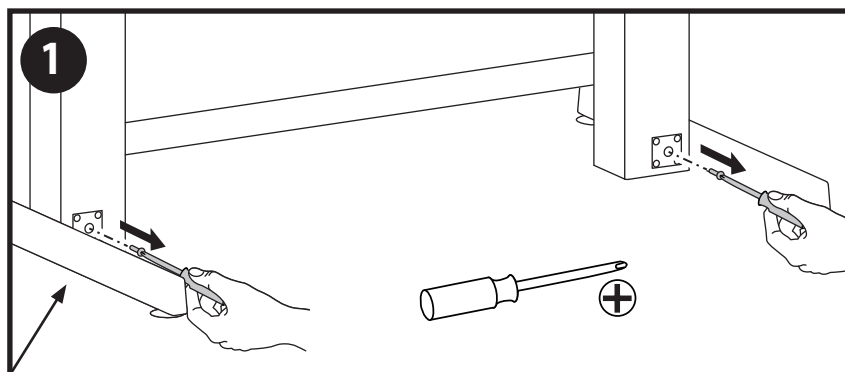
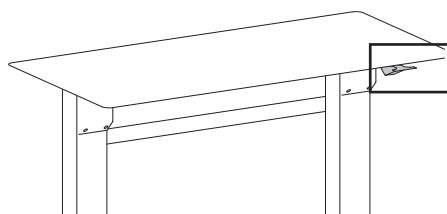
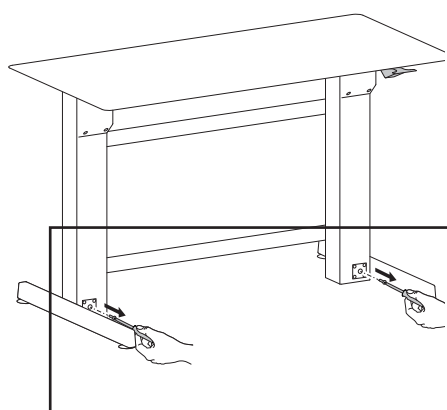

After you remove the 4 brake stop screws, release the hand brake (on the right leg) and move the worksurface up to highest level.

# Set-up Steps

## 15 Install all equipment.



**CAUTION!** Make sure you leave 20" (508mm) of slack in all equipment cables to allow the worksurface to raise up it's full 20" (508mm). Failure to allow enough slack in equipment cables may cause cables to get pulled, equipment to fall off desk and may result in product damage and or personal injury.

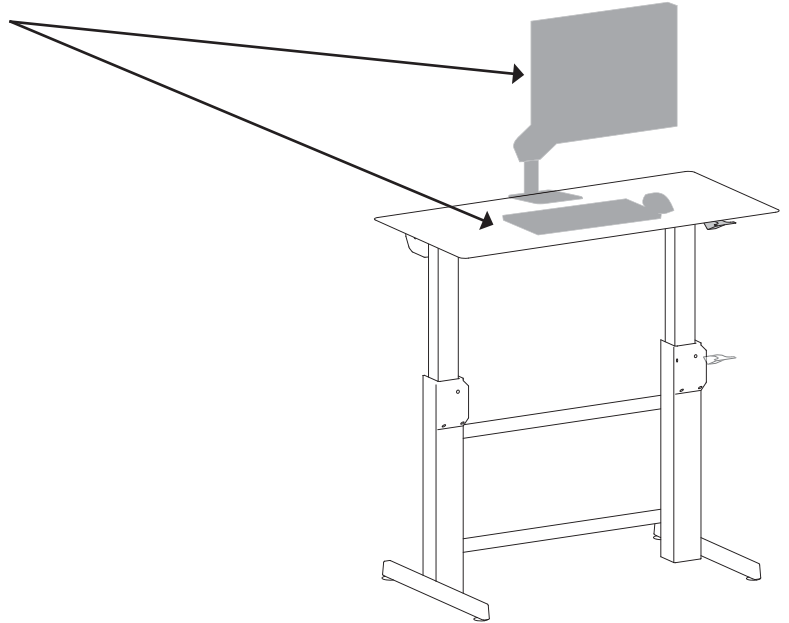

## 16 Adjustment Step

Important! You will need to adjust this product after installation is complete. Make sure all your equipment is properly installed on the product before attempting adjustments. This product should move smoothly and easily through the full range of motion and stay where you set it. If movements are too easy or difficult or if product does not stay in desired positions, follow the adjustment instructions to create smooth and easy movements. Depending on your product and the adjustment, it may take many turns to notice a difference. Any time equipment is added or removed from this product, resulting in a change in the weight of the mounted load, you should repeat these adjustment steps to ensure safe and optimum operation.

**⚠ WARNING**  
**IMPACT HAZARD**



**Moving Parts Can Crush And Cut**

**Minimize Lift Strength BEFORE:**  
- Removing Mounted Equipment  
**and**  
**Insert 4 Stop Screws BEFORE:**  
- Shipping or Storing (i.e. when Desk is not upright).

**To Minimize Lift Strength**  
Refer to installation manual for instructions on how to minimize lift strength.

**To Insert 4 Stop Screws**  
Refer to installation manual for instructions on installing stop screws.

**Failure to heed this warning may result in serious personal injury or property damage!**

For More information and instructions visit [www.ergotron.com](http://www.ergotron.com)  
or contact Ergotron Customer Care at **1-800-888-8458**.  
826-901-00

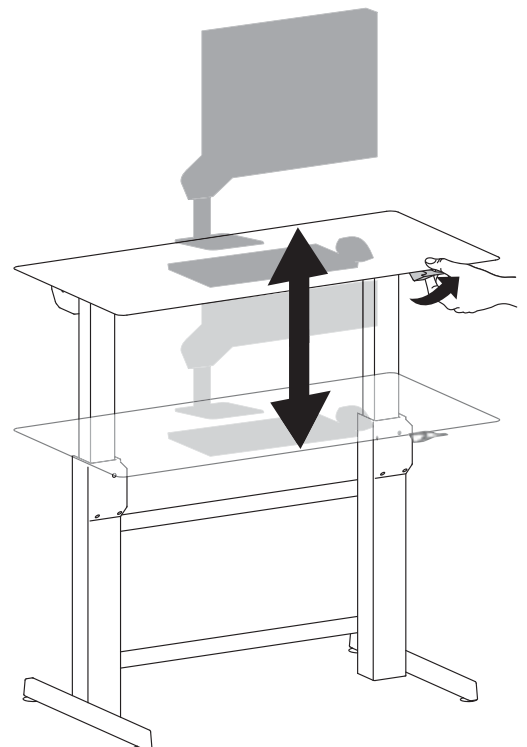

# 17 Adjustment Step

Release the hand brake (on the right leg) and move the worksurface up to highest level.

Push in the cover located behind each leg to access the adjustment point.



**NOTE:** The covers on the legs will not open unless the worksurface has been lifted to it's full height. The worksurface will not lower unless the covers have been completely closed.

Maintain equal amount of tension on both legs by alternating the adjustment from one leg to the other using a 14mm socket drill.

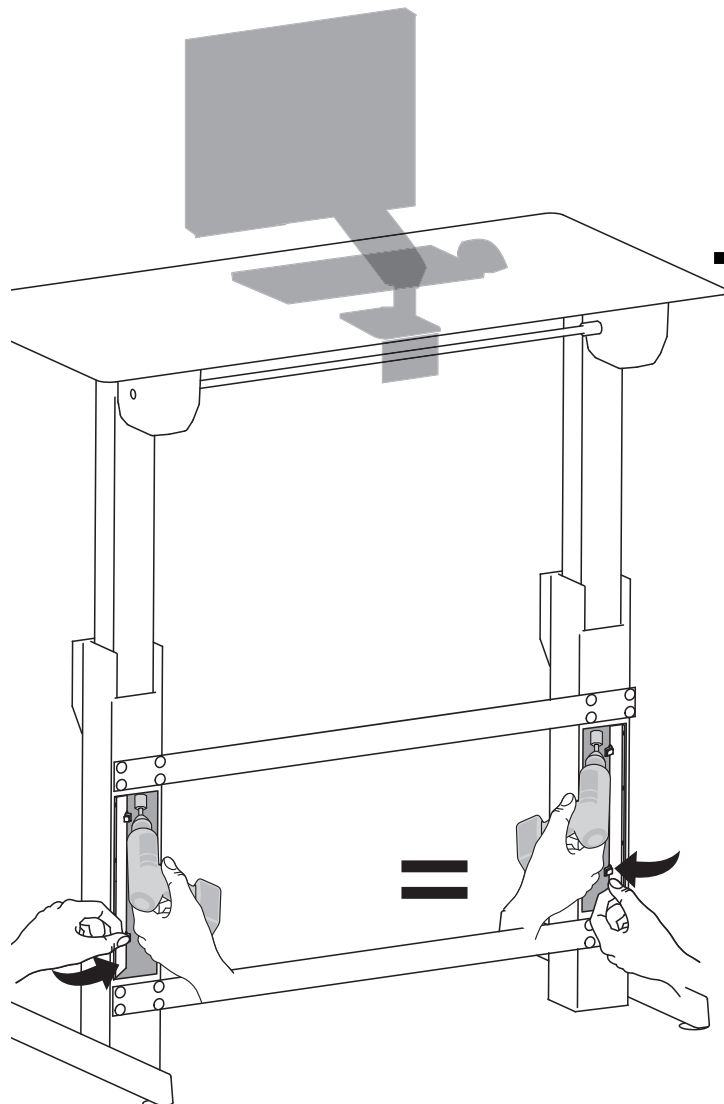
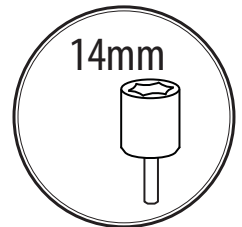
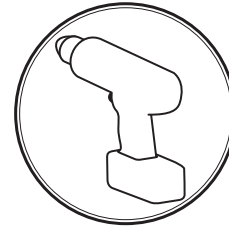
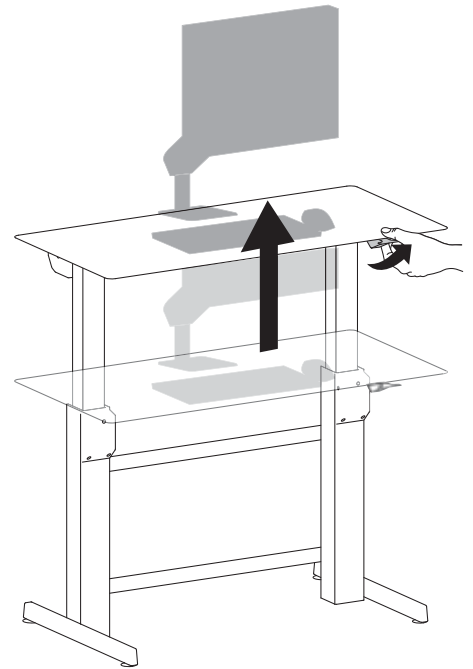

**WARNING! DO NOT** tip desk over to adjust. Only perform adjustment while desk is upright. Failure to follow these instructions may cause the lift engine to expand rapidly and may result in equipment damage and or personal injury.



## +

### Increase Lift Strength

If the mounted weight is too heavy or this product does not stay up when raised, then you'll need to increase Lift Strength:



## -

### Decrease Lift Strength

If the mounted weight is too light or this product does not stay down when lowered, then you'll need to decrease Lift Strength:

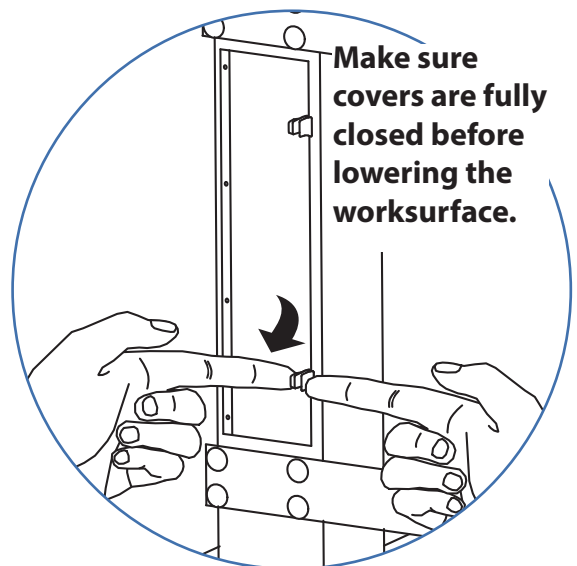

**Make sure covers are fully closed before lowering the worksurface.**

# APPENDIX A - Minimize Lift Tension



**WARNING.** Before removing mounted equipment (monitor, arm, stand CPU, etc.), from desk, or to prepare for shipping or storing the desk it is extremely important to minimize the lift tension. Failure to install these instructions may cause lift engine to expand rapidly and may result in equipment damage and or personal injury.

1. Release the hand brake (on the right leg) and move the worksurface up to highest level.
2. Push in the cover located behind each leg to access the adjustment point.



**NOTE:** The covers on the legs will not open unless the worksurface has been lifted to it's full height. The worksurface will not lower unless the covers have been completely closed.

3. To minimize tension, turn adjustment bolts left using a 14mm socket drill. Maintain equal tension on both legs by alternating adjustment from one leg to the other. Keep adjusting until the wrench stops turning.
4. Once at minimum tension it is ok to remove mounted equipment.

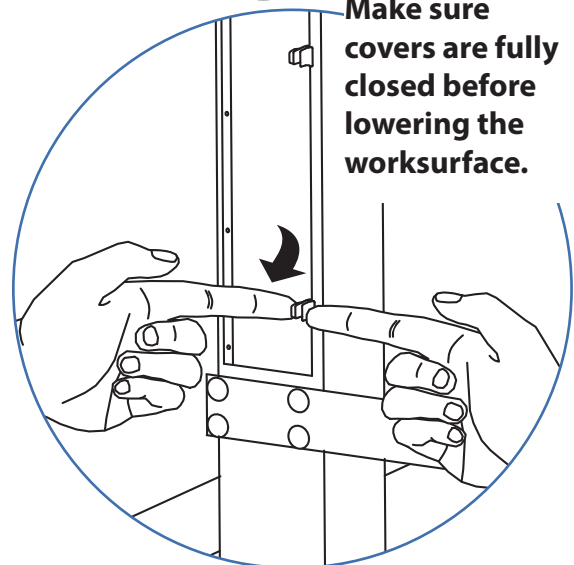
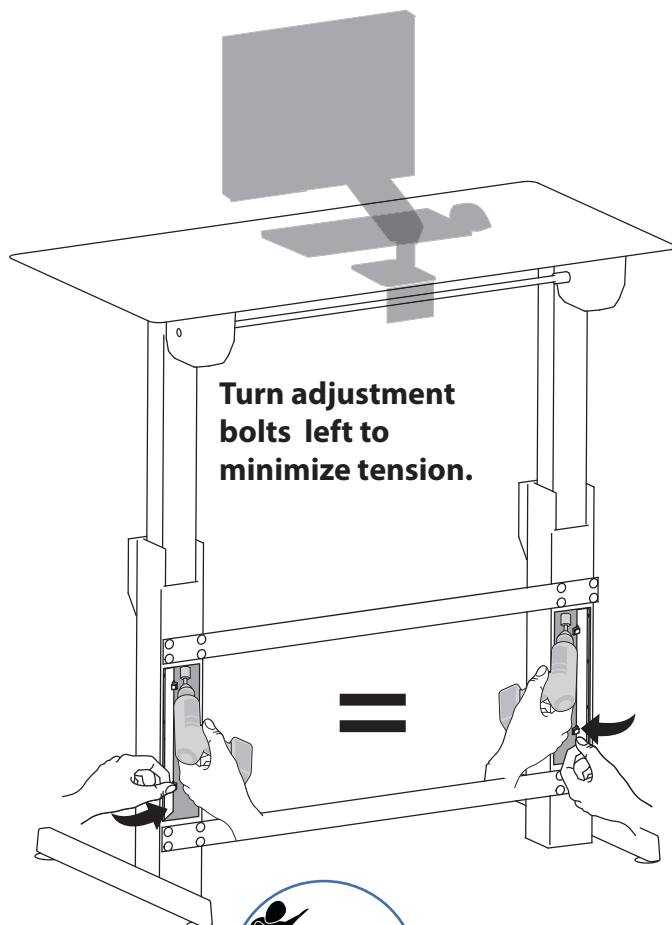
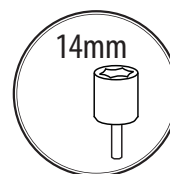
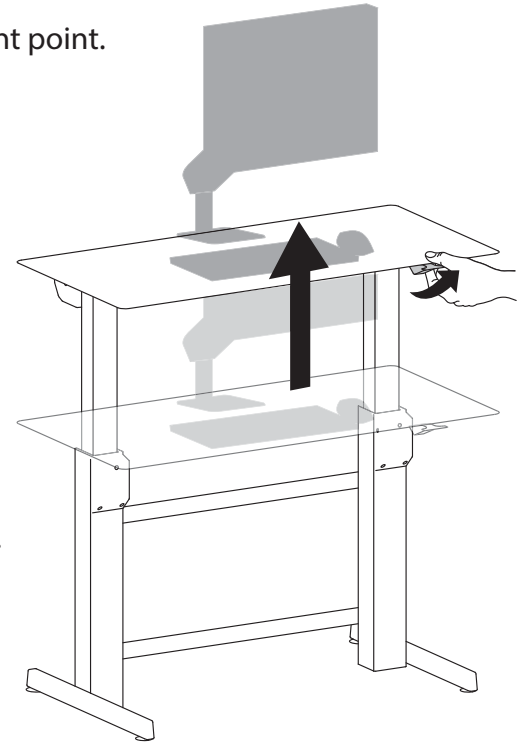

**WARNING! DO NOT** tip desk over to adjust. Only perform adjustment while desk is upright. Failure to follow these instructions may cause the lift engine to expand rapidly and may result in equipment damage and or personal injury.

## APPENDIX B - Inserting Stop Screws



**WARNING.** Before shipping or storing the desk, or in cases where the desk is placed on its back or side\*, it is extremely important that the 4 stop screws be re-inserted. Failure to follow these instructions may cause lift engine to expand rapidly and may result in equipment damage and or personal injury.

1. Follow instructions in Appendix A to minimize lift tension.
2. Push the desk down to its lowest position.
3. Insert 2 stop screws at the bottom of each leg.
4. Insert the other 2 stop screws on each side of the hand brake located on the right side of the worksurface.
5. Once the 4 stop screws have been installed the desk can be shipped or stored.

\* Placing the desk on its back or side is not recommended.

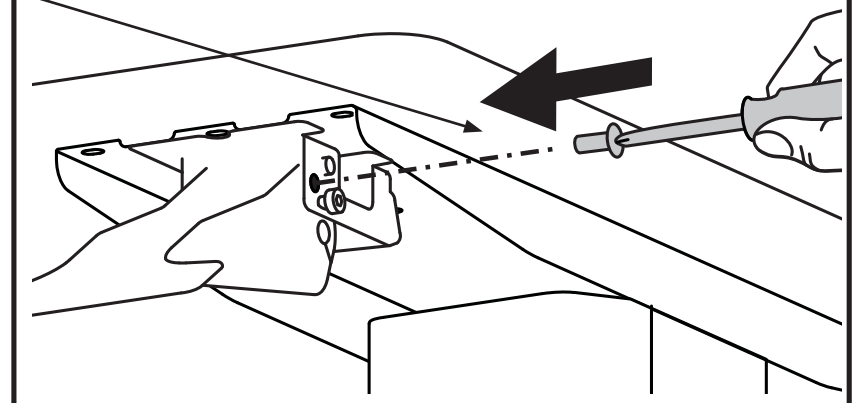
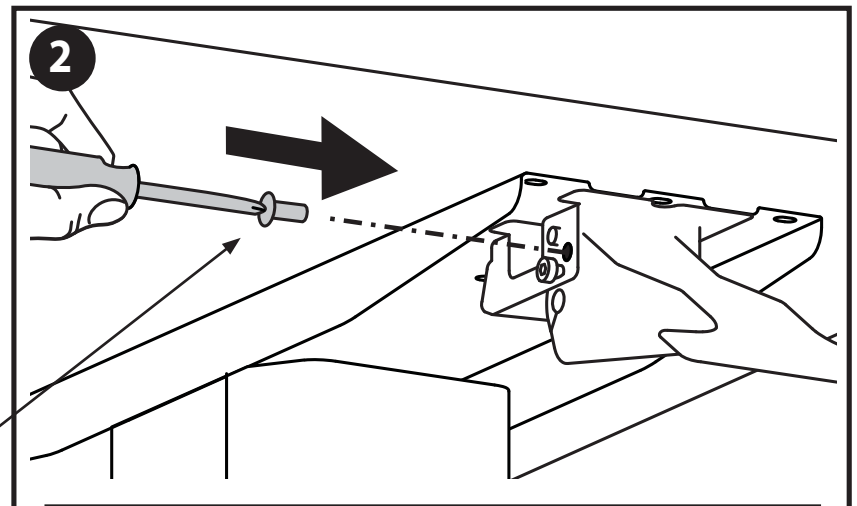
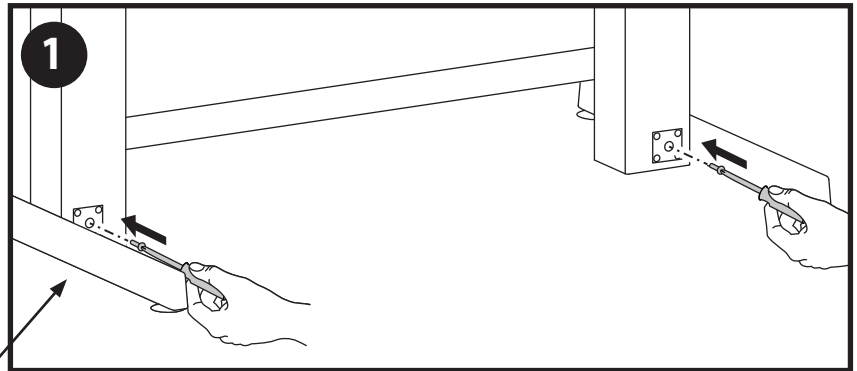
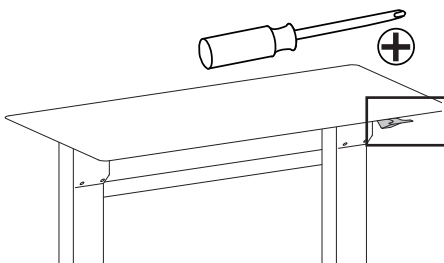
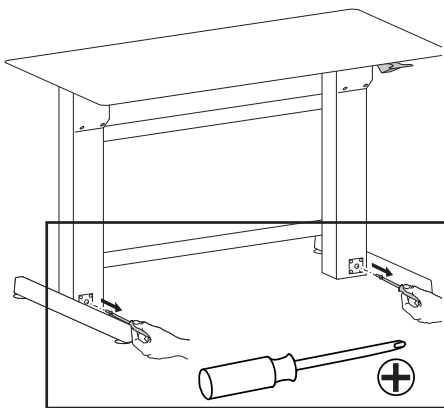

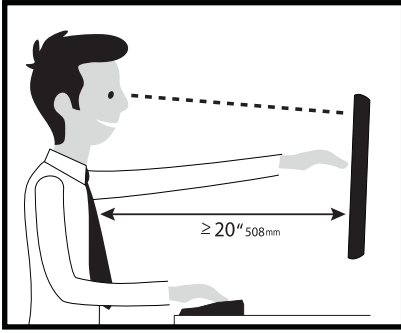

Learn more about ergonomic computer use at: [www.ergotron.com/ergonomics](http://www.ergotron.com/ergonomics)

# ergotron®

For Warranty visit: [www.ergotron.com/warranty](http://www.ergotron.com/warranty)

For Service visit: [www.ergotron.com](http://www.ergotron.com)

For local customer care phone numbers visit: <http://contact.ergotron.com>

[www.ergotron.com](http://www.ergotron.com) | USA: 1-800-888-8458 | Europe: +31 (0)33-45 45 600 | China: 400-120-3051 | Japan: [japansupport@ergotron.com](mailto:japansupport@ergotron.com)

© 2016 Ergotron, Inc. All rights reserved. WorkFit™ is a registered trademark of Ergotron, Inc.

While Ergotron, Inc. makes every effort to provide accurate and complete information on the installation and use of its products, it will not be held liable for any editorial errors or omissions (including those made in the process of translation from English to another language), or for incidental, special or consequential damages of any nature resulting from furnishing this instruction and performance of equipment in connection with this instruction. Ergotron, Inc. reserves the right to make changes in the product design and/or product documentation without notification to its users. For the most current product information, or to know if this document is available in languages other than those herein, please contact Ergotron. No part of this publication may be reproduced, stored in a retrieval system, or transmitted in any form or by any means, electronic, mechanical, photocopying, recording or otherwise without the prior written consent of Ergotron, Inc., 1181 Trapp Road, Eagan, Minnesota, 55121, USA. Patents Pending and Patented U.S. & Foreign. Ergotron is a registered trademark of Ergotron, Inc.