

# Desk Mounts

## DS100 Desk Stands Individual Components

### 28" Pole

**20-137-200** black

Shipping weight: 5 lbs (2.3 kg)

The DS Pole measures 1-1/2" (38 mm) in diameter and mounts to a Free Standing, Desk Clamp or Grommet Mount Base\*

\*Attaches to base with set screws from base mounting kit.



### Free Standing Base

Flexible, quick, DS mounting

**33-262-200** black

Shipping weight: 2 lbs (.9 kg)

Place directly on works surface, no hardware necessary.\*

\*Observe balance requirements to prevent tipping.



### Grommet Mount Base

Quick, stable mounting utilizes grommet hole

**60-350-200** black

Shipping weight: 5 lbs (2.3 kg)

Attaches to openings in worksurface from 3/8–3" in diameter (10 to 76 mm) and up to 3-1/4" (83 mm) thick.



### DS Clamping Pivot

Single Pivot with P/L motion

**47-058-200** black

LCD weights (each): 25 lbs (11.3 kg)  
Shipping weight: 4 lbs (1.8 kg)

Attaches to 28" Pole.

Observe balance requirements to prevent tipping.



### DS Clamping Double Pivot

Double Pivot with P/L motion

**47-051-200** black

LCD weights (each): 23 lbs (10.4 kg)  
Shipping weight: 5 lbs (2.3 kg)

Attaches to 28" Pole.

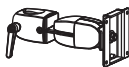

### Outboard Pole Clamps

Greater stability for expanded, multi-display configurations

**60-443-200\*** black

Shipping weight: 3 lbs (1.4 kg)

Attaches 55" Crossbar using two (2) base/Pole assemblies.

\*One set consists of two (2) clamps.

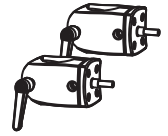

### DS Sliding Pivot

Flexible, quick, DS mounting

**47-100-009** black

LCD weights (each): 28 lbs (12.7 kg)  
Shipping weight: 2 lbs (.9 kg)

Attaches to Crossbar

Observe balance requirements to prevent tipping.



### 28" Crossbar

For multi-display applications

**60-409-200** black

Shipping weight: 6 lbs (2.7 kg)

Attaches to 28" pole.

Requires two (2) Sliding Pivots, order separately.

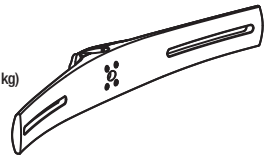

### Crossbar Extender

Short

**97-446-200** black

Shipping weight: 6 lbs (2.7 kg)

Use Short Extenders to increase width of 28" Crossbar, 60-409 to 46". Includes center pivot for mounting an LCD in the middle of the crossbar.

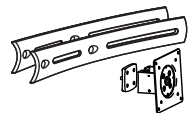

### Crossbar Extender

Long

**97-447-200** black

Shipping weight: 6 lbs (2.7 kg)

Use Long Extenders to increase width of 28" Crossbar, 60-409-200 to 55". Includes center pivot for mounting an LCD in the middle of the crossbar.

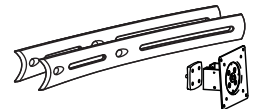

# Desk Mounts

## 1½" Diameter Pole Components

### 1½" Round Pole, 28" long

20-137-200 black

Mount Pole to worksurface using Grommet Mount Base, 60-350-00

Dimensions: 1½" diameter, 28" (71 cm) Long

Shipping Weight: 5 lbs (2.3 kg)



### Grommet Mount Base

60-350-200 black

Grommet Mount Base for 1½" Round Pole attaches to worksurface through holes 3/8" to 3" (10 to 76 mm) wide, up to ≤ 4" (102 mm) thick

Shipping Weight: 5 lbs (2.3 kg)



### Split Pole-Mount Bracket

60-423-003 aluminum

Split Pole-Mount Bracket (1 Bracket) - use to mount LX, 200, 400 Series, Extenders, CPU Holders, and Wire Storage Basket on vertical 1½" Round Pole\*

Shipping Weight: 2 lbs (.9 kg)

\* Order two Brackets for LX, 200, 400 Series and Extenders installation.

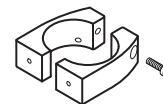

### Large Clamp

60-420-200 aluminum

Large Clamp features adjustment lever for easy height repositioning. Applications: LX, 200 Series on 1½" Round Pole

Shipping Weight: 3 lbs (1.4 kg)

