

# Assembly & Installation Instructions: Banana-Board Platform Mounting for the Following:

**Workrite**  
ergonomics®



UB2180S25



UB2181SN

## Parts Included

- A** Banana-Board Keyboard Platform  
Qty: 1

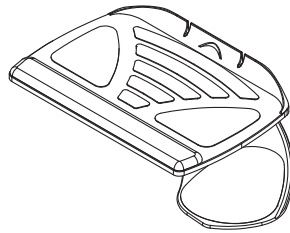

## Hardware Kit #AKP-HDWR-BB

- B**  $\frac{3}{8}$ " #10-32 Keps Nuts  
Qty: 4



- C** Cord Clips  
Qty: 2



## Required

Adjustable Keyboard Arm

## Tools Required

Socket wrench with  $\frac{3}{8}$ " socket

**Note:** Mount your adjustable keyboard arm to your worksurface using the instructions that came with your adjustable keyboard arm.

## 1 Mount Keyboard Platform to Arm

- Align the threaded studs on the bottom of the Banana-Board (A) with the mounting holes in the keyboard arm.
- Attach with four  $\frac{3}{8}$ " #10-32 Keps Nuts(B) and tighten securely.

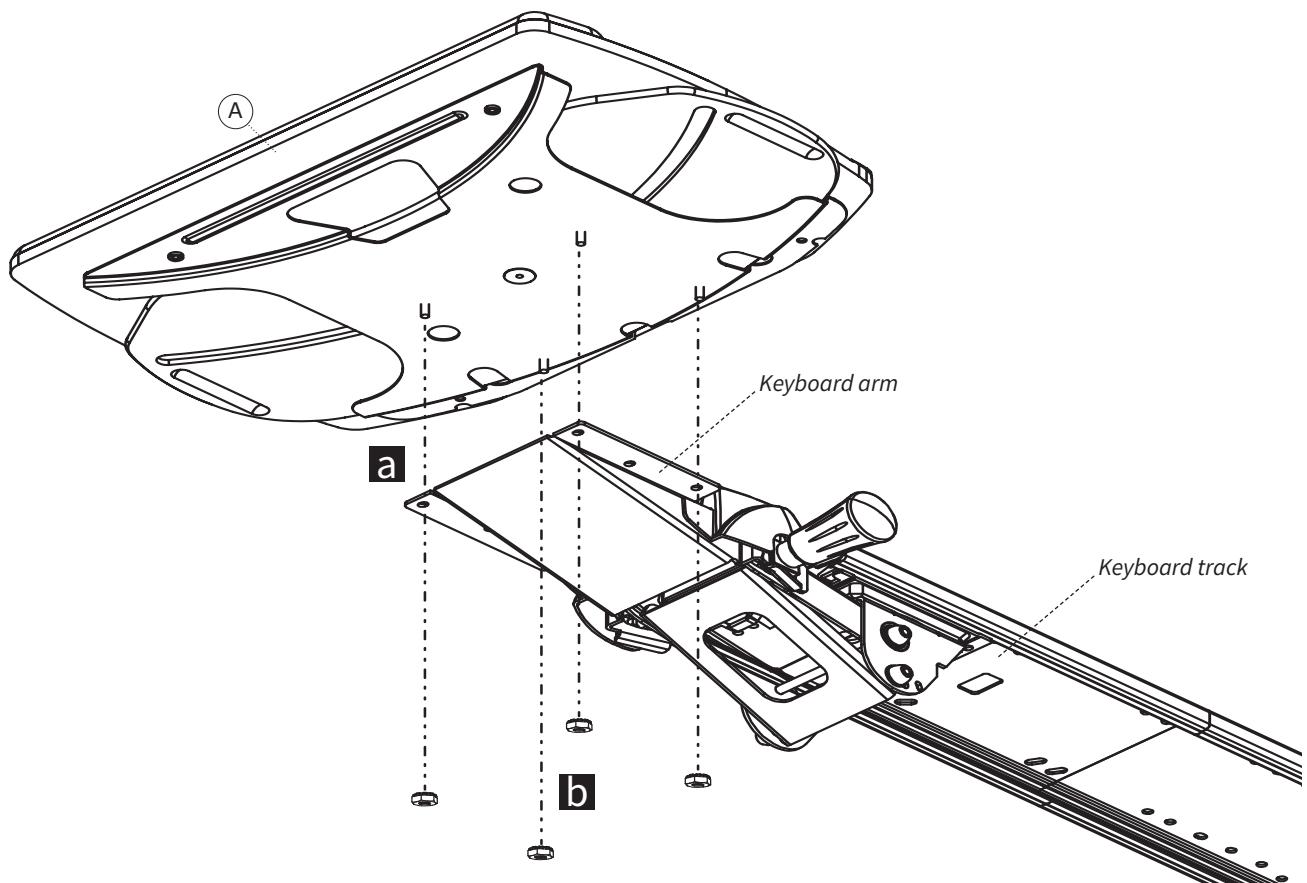

## 2 Route Keyboard and Mouse Cords on Keyboard Platform

Place the keyboard cord in either slot on back wall of the Banana-Board platform. Press down to lock into position.

Place mouse cord into notch at back rear corner of the Banana-Board platform. Be sure to leave enough slack in cord to allow for unrestricted movement of the mouse.

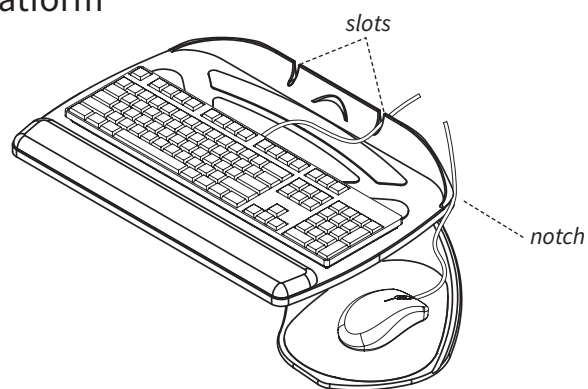

## 3 Attach Cord Clips and Rout Cords on Arm & Under Worksurface

**Note:** Make sure your keyboard arm is fully extended before routing your cables.

Place one Cord Clip (C) on the side of the arm mechanism. Place the other Cord Clip on the rear of the track. Do the opposite side in the same fashion if cords run down the left side.

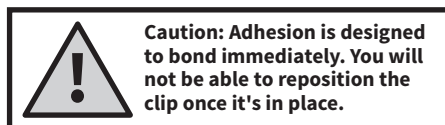

**Caution:** Adhesion is designed to bond immediately. You will not be able to reposition the clip once it's in place.

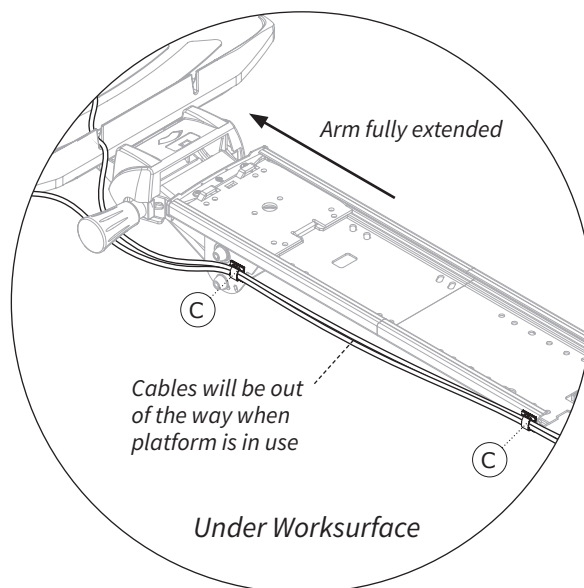

## 4 Consult the User Guides for Your Platform and Arm

Go to [www.workriteergo.com/instructions](http://www.workriteergo.com/instructions) to find the Banana-Board User Guide and Pinnacle Arm User Guide for instructions on how to set up this product for ideal ergonomic benefit.

