

# Assembly & Installation Instructions: Solace Sit-to-Stand Dual Monitor Adaptor SOL-ADPT-TWIN-S

**Workrite**  
ergonomics®

## Parts Included

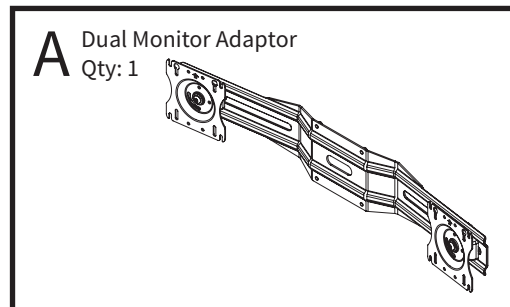

## Hardware Kit

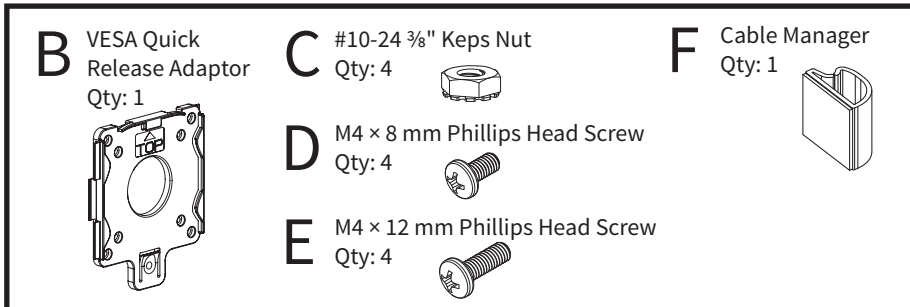

## Required

Solace Sit-to-Stand

## Tools Required

3/8" Wrench or pliers  
#2 Phillips screwdriver or drill/driver

**Note:** Addition of the Dual Monitor Adaptor reduces total weight capacity by 3 lb.

## 1 Mount Dual Arm Adaptor to Monitor Mount

Attach Dual Monitor Adaptor (A) to Monitor Mount on Solace using the four #10 x 24 3/4" Keps Nuts (C) included.

If purchased after installation of a single monitor, remove existing monitor first. Keep the Quick Release on the monitor if pre-installed.

**Note: Do not install Quick Release Adaptor between Dual Arm Adaptor and Solace Monitor mount!**

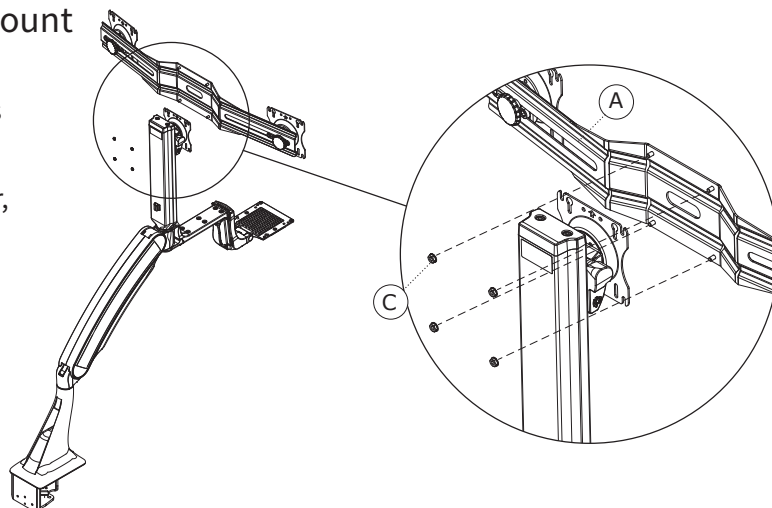

## 2 Mount Quick Release to Monitor

Attach the VESA Quick Release Adaptor (B) to the back of both monitors. Remove existing base if necessary, being sure to keep and use the mount screws that came with your monitor to mount the monitor to the Quick Release Adaptor.



**Important Note:**  
It is strongly recommended to use the mounting screws provided by the monitor manufacturer if possible. Always use the same size screws and the shortest screws possible to avoid damage to the monitor.

If manufacturer screws are not available or are not the correct length, use four screws included with the Solace Sit-to-Stand and the same size screws included with the Dual Arm Adaptor (D) or (E).

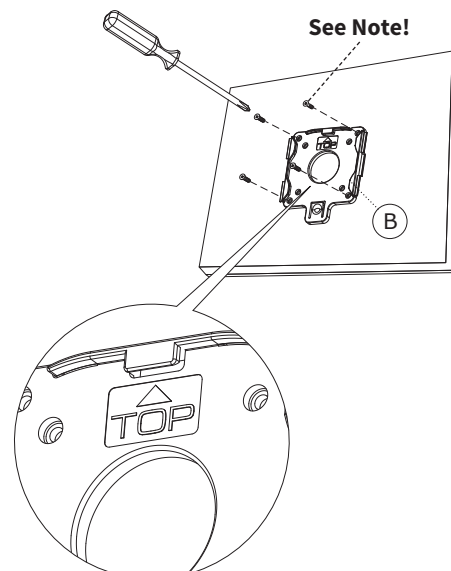

### 3 Mount Monitors to Dual Arm Adaptor

Slide the monitor with the Quick Release Adaptor onto the VESA mount of the Solace Dual Arm Adaptor.

Repeat for other side.

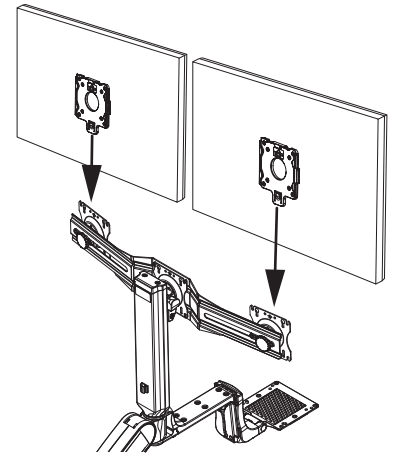

### 4 Adjust Counterbalance Tension on Solace Monitor Mount

With the monitors installed, counterbalance the monitors by following the instructions on the label on the back of the Solace monitor tower.

Keep unused pins installed in the bracket hole for possible future use.

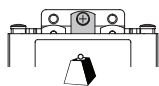

Light monitor  
5–9 lb.

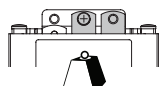

Medium monitor  
(factory default)  
8.5–15 lb.

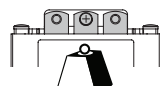

Heavy monitor  
14.5–20 lb.

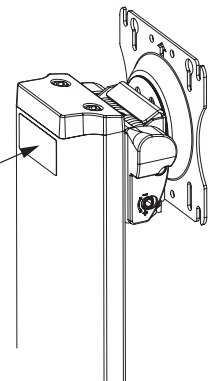
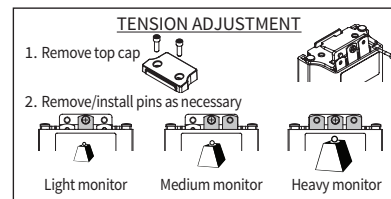

### 5 Adjust Tilt on Solace Monitor Mount

If your monitor droops with the dual monitors installed, tighten the tilt adjustment to compensate using  $\frac{3}{16}$ " Allen Wrench provided with the Solace Sit-to-Stand.

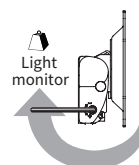

Loosen —

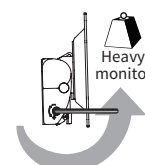

Tighten +

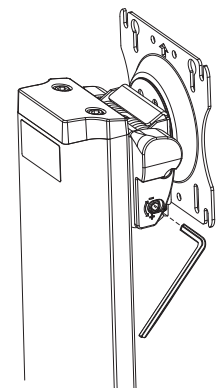

### 6 Add Cable Manager

Affix the Cable Manager (F) to the back side of the monitor tower in a convenient location to rout cables.

