

ITEM NO.	PART NUMBER	QTY
1	45-0434 VESA Handle	1
2	45-0502 Quick Release Base	1
3	45-0608 VESA Quick Release Pin	1
4	45-0609 Pin, Press, VESA Quick Release	1
5	45-0633 Quick Release Collar	1
6	45-0905 Quick Release Spring	1
7	58-016 M4 Combination Cheese Head, 8mm	1

REV.	DESCRIPTION	DATE	BY
1	ADDED VIEW TO SHOW ASSEMBLY ORIENTATION	5/11/2005	MAS
2	ADDED LOCATING TAB	22-Jan-07	MAS

HANDLE AND THIS SURFACE MUST BE PARALLEL AS SHOWN

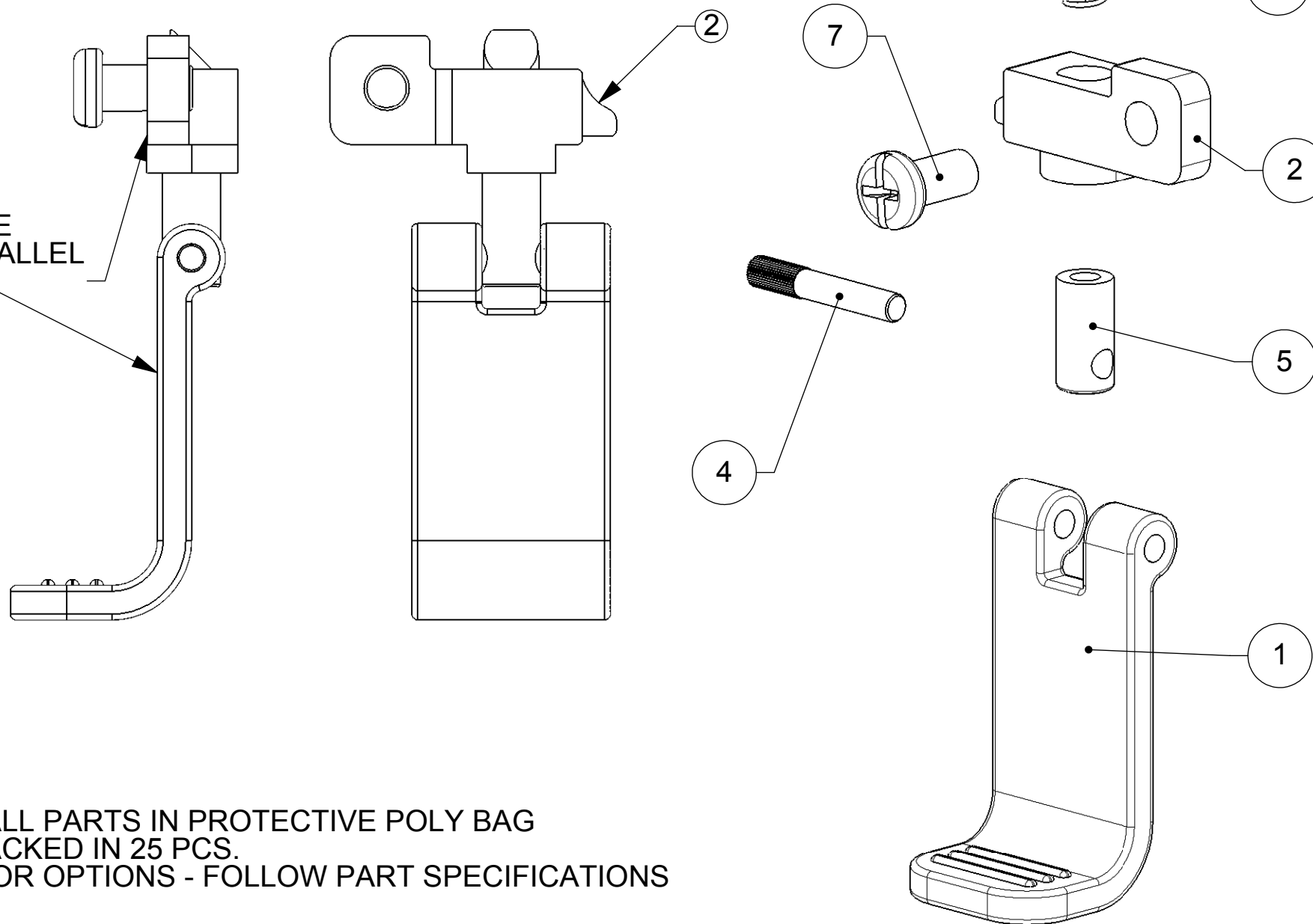

- NOTES:
1. PLACE ALL PARTS IN PROTECTIVE POLY BAG
 2. BULK PACKED IN 25 PCS.
 3. NO COLOR OPTIONS - FOLLOW PART SPECIFICATIONS

TOLERANCES UNLESS NOTED
 mm [INCHES]
 .XX = ±.10 .XXX = ±.005
 .X = ±.25 .XX = ±.010
 ANGLES = ±1°

Humanscale

11 East 26th Street, NYC, NY 10010
 TEL: 212 725 4749, FAX: 212 725 7545

MATERIAL

PROJECT

M7

WEIGHT

TITLE

g

DRAWN BY

Vesa Quick Release Assembly

ANT

DATE

4-19-05

DO NOT SCALE DRAWING

SHEET

1

OF

1

SCALE

2:1

DRAWING NO.

45-1034

B

PROPRIETARY AND CONFIDENTIAL
 THE INFORMATION CONTAINED IN THIS DRAWING IS THE SOLE PROPERTY OF HUMANSCALE. ANY REPRODUCTION OR DISTRIBUTION IN PART OR AS A HOLE WITHOUT THE WRITTEN PERMISSION OF HUMANSCALE IS PROHIBITED.