

## Installation Instructions

Product # 200-F16-B01 – Single Arm on 16" Pole with Flush Mount  
 200-F16-S01

1. Remove product from box.
2. Decide on mounting location.
3. The flush mounting plate can be secured with either screws or nuts and bolts depending on the under the surface accessibility. If possible, we recommend nuts and bolts.
4. To adjust the height of the articulating arm, loosen handle on pole clamp and set arm to desired height, then re-tighten handle.
5. Attach quick release pivot to back of each monitor using Phillips head screws provided. Be sure that the silver release button is positioned toward the top of the monitor.
6. Place the monitor on the mounting block by tipping the monitor back approximately 45 degrees and then down until the silver release button engages groove and clicks down into place.

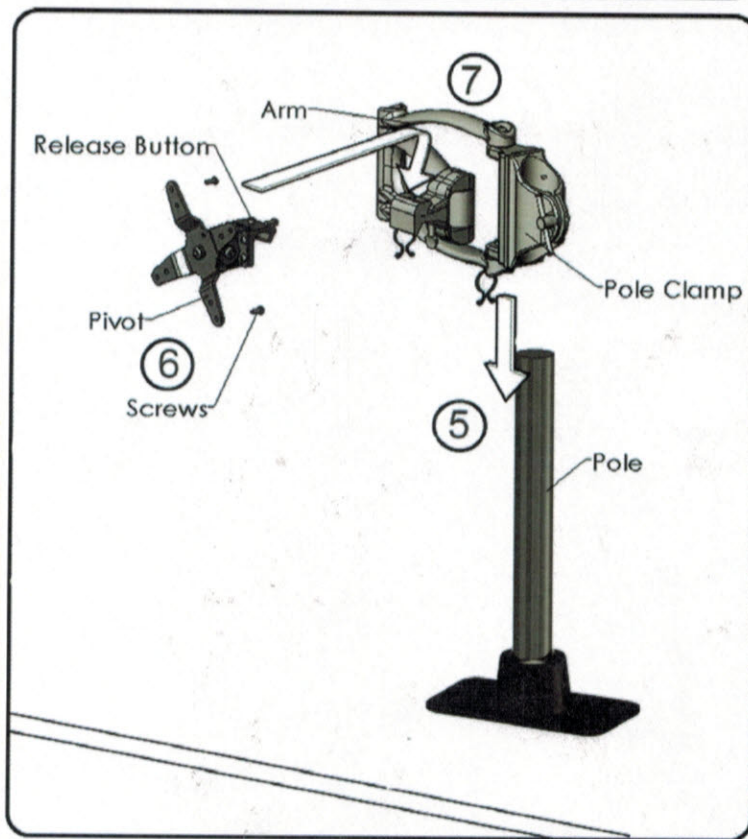
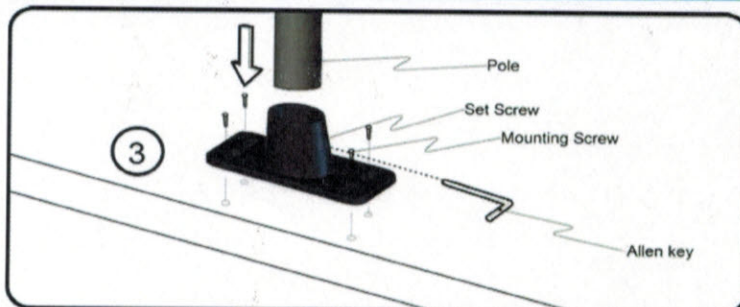

### To adjust monitors:

Laterally: Place hand on bottom of monitor and lift slightly to support weight. Monitor will slide along bar.

Left/Right and Up/Down: Grasp monitor with both hands and adjust to desired position.

To tension the vertical adjustment to the weight of monitor: Tighten the 5mm bolt on the right side of the pivot with the hex wrench provided.

To remove the monitor: Take the weight from the monitor with one hand on the bottom and tip it back slightly while using the other hand to lift the top of the silver release button. Lift up and back and this will release the monitor from the stand.

### Installation Instructions

Product # 200-C16-B02 – Dual Horizontal with Single Arm on 16" Pole with Slat Wall Bracket  
200-C16-S02

1. Remove product from box.
2. Decide on mounting location.
3. Mount clamp onto desk in desired location by tightening knob at the bottom of clamp. **Note:** It may be necessary to disassemble clamp in area with minimal open space behind the surface edge. (Example: cubicles with partitions) Simply disassemble clamp, slide clamp edge with pole attached into position and reassemble in position. Then tighten clamp as above.
4. Tighten set screw in truncated cone using provided hex wrench.
5. To adjust the height of the articulating arm: loosen handle on pole clamp and set bar to desired height, then re-tighten handle.
6. Slide 25" horizontal bar into arm, making sure that the hole in the underside of the block aligns with the thumbscrew. Tighten thumbscrew.
7. Attach quick release pivots to back of each monitor using Phillips head screws provided. Be sure that the silver release button is positioned toward the top of the monitor.
8. Place the monitor on the mounting block by tipping the monitor back approximately 45 degrees and then down until the silver release button engages groove and clicks down into place.

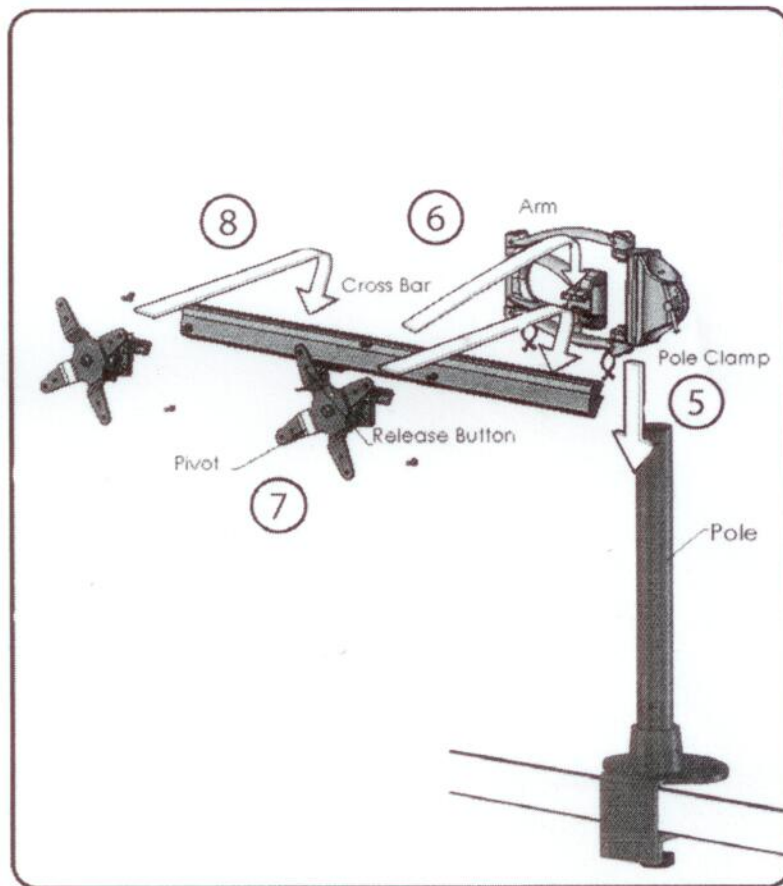
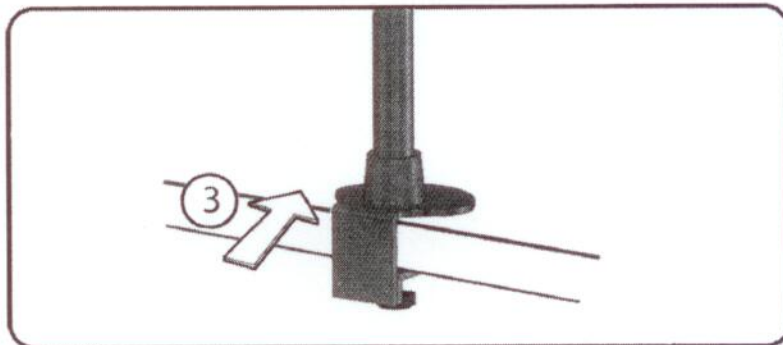

#### To adjust monitors:

Left/Right and Up/Down: Grasp monitor with both hands and adjust to desired position.

To tension the vertical adjustment to the weight of monitor: Tighten the 5mm bolt on the right side of the pivot with the hex wrench provided.

**DO NOT ADJUST THE ARM VERTICALLY BY USING THE HORIZONTAL BAR**

## Installation Instructions

### Product #212-22- Double Vertical Mount with Flush Mount

1. Remove product from box.
2. Decide on mounting location.
3. The flush mounting plate can be secured with either screws or nuts and bolts depending on the under the surface accessibility. If possible, we recommend nuts and bolts.
4. To adjust the height of the arms, loosen handle on pole clamp and set arms to desired height, then re-tighten handle.
5. Attach quick release pivots to back of each monitor using phillips head screws provided. Be sure that the silver release button is positioned toward the top of the monitor.
6. Place each monitor on the mounting blocks by tipping the monitor back approximately 45 degrees and then down until the silver release button engages groove and clicks down into place.

#### To adjust monitors:

Left/Right and Up/Down: Grasp monitor with both hands and adjust to desired position.

To tension the vertical adjustment to the weight of monitor: Tighten the 5mm bolt on the right side of the pivot with the hex wrench provided.

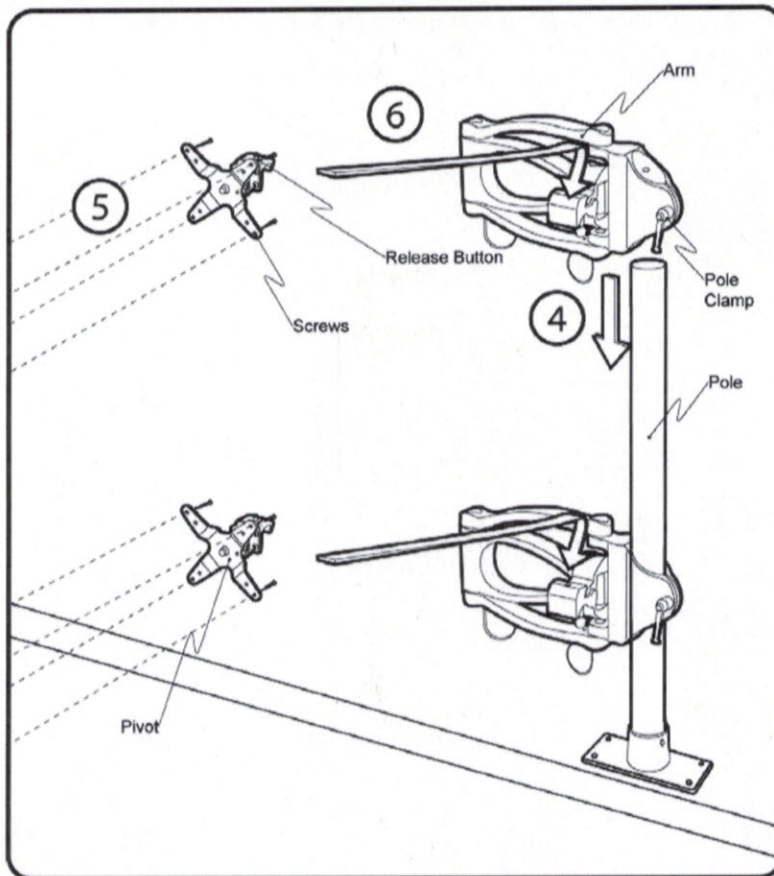
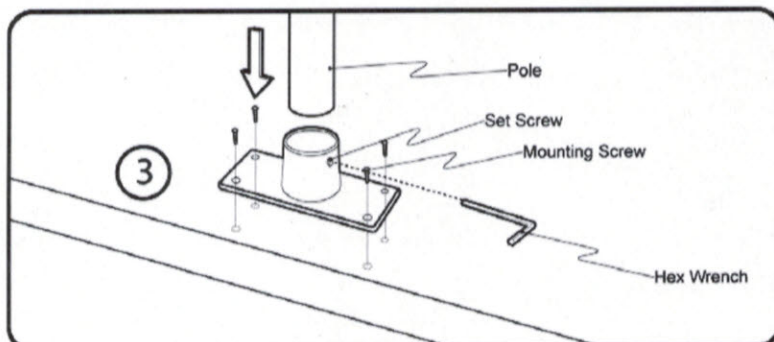

Product # 200-S16-B01  
200-S16-S01

## Installation Instructions

– Single Arm on 16" Pole with Slat Wall Bracket

1. Place mounting bracket on a flat surface.
2. Remove cable management cover by sliding upward. Check to make sure wing nuts on lower mounting bracket are loose enough for bracket to slide freely in slot.
3. Mount slatwall bracket to slatwall by hooking the lower bracket on slatwall first, then extending to latch upper bracket to farthest available slat from the lower bracket. Tighten onto slatwall using the cam handles. Cam handles operate by holding them vertically and spinning clockwise. Continue until snug and then lock into place by pressing handle down into a horizontal position. If unable to lock down firmly, loosen handle by spinning counterclockwise a few turns and then engage the handle down. **DO NOT OVERTIGHTEN.**
4. Be certain bracket is holding firmly to the slatwall. Snug lower wing nuts and check to be sure the vertical pole is fully tightened in bracket.
5. To adjust the height of the articulating arm, loosen handle on pole clamp and set arm to desired height, then re-tighten handle.
6. Attach quick release pivot to back of each monitor using Phillips head screws provided. Be sure that the silver release button is positioned toward the top of the monitor.
7. Place the monitor on the mounting block by tipping the monitor back approximately 45 degrees and then down until the silver release button engages groove and clicks down into place.

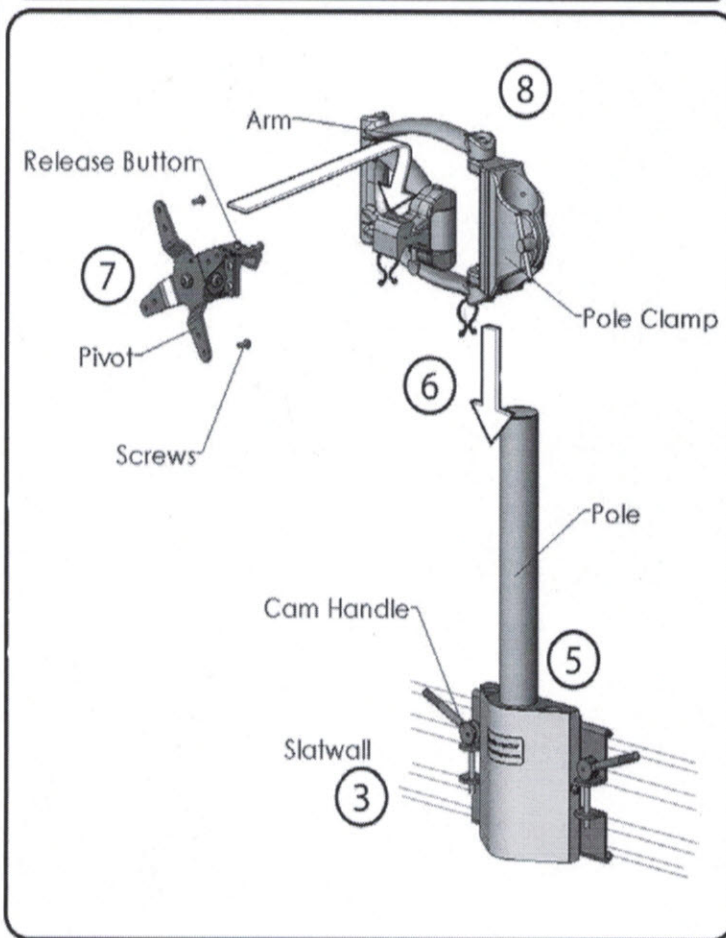
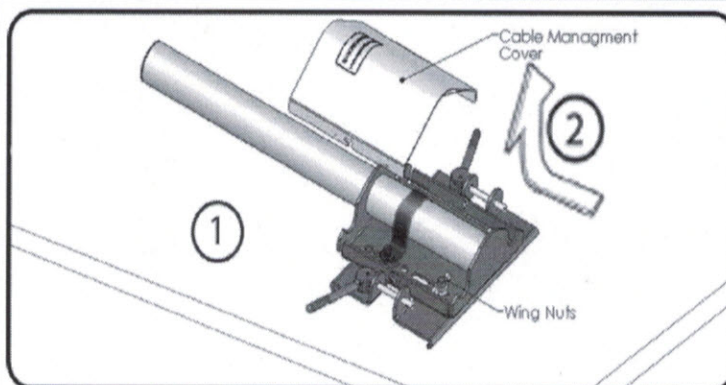

### To adjust monitors:

Left/Right and Up/Down: Grasp monitor on top and bottom bezel with both hands and adjust to desired position.

To tension the vertical adjustment to the weight of monitor: Tighten or loosen the 5mm bolt on the right side of the pivot with the hex wrench provided.

### Installation Instructions

Product # 200-S16-B02 – Dual Horizontal with Single Arm on 16" Pole with Slat Wall Bracket  
200-S16-S02

1. Place mounting bracket on a flat surface.
2. Remove cable management cover by sliding upward. Check to make sure wing nuts on lower mounting bracket are loose enough for bracket to slide freely in slot.
3. Mount slatwall bracket to slatwall by hooking the lower bracket on slatwall first, then extending to latch upper bracket to farthest available slat from the lower bracket. Tighten onto slatwall using the cam handles. Cam handles operate by holding them vertically and spinning clockwise. Continue until snug and then lock into place by pressing handle down into a horizontal position. If unable to lock down firmly, loosen handle by spinning counterclockwise a few turns and then engage the handle down. **DO NOT OVERTIGHTEN.**
4. Be certain bracket is holding firmly to the slatwall. Snug lower wing nuts and check to be sure the vertical pole is fully tightened in bracket.
5. To adjust the height of the articulating arm loosen handle on pole clamp and set bar to desired height, then re-tighten handle.
6. Slide 25" cross bar mounting block into arm, making sure that the hole in the underside of the block aligns with the thumbscrew. Tighten thumbscrew.
7. Attach quick release pivots to back of each monitor using Phillips head screws provided. Be sure that the silver release button is positioned toward the top of the monitor.
8. Place the monitor on the mounting block by tipping the monitor back approximately 45 degrees and then down until the silver release button engages groove and clicks down into place.

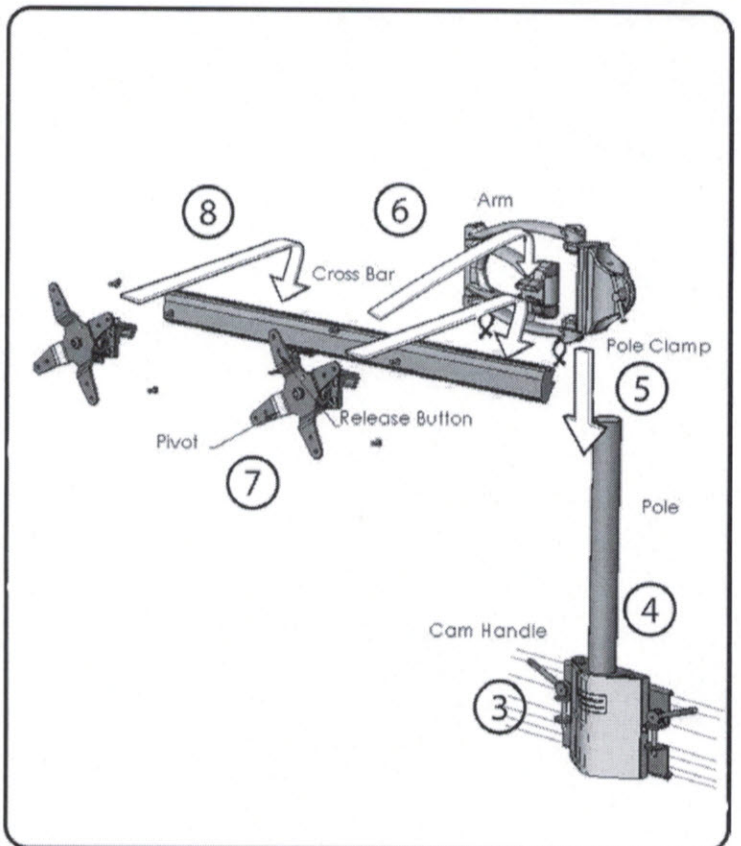
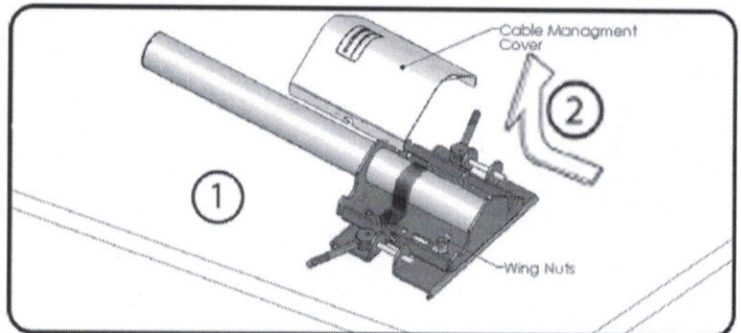

#### To adjust monitors:

Left/Right and Up/Down: Grasp monitor with both hands and adjust to desired position.

To tension the vertical adjustment to the weight of monitor: Tighten the 5mm bolt on the right side of the pivot with the hex wrench provided.

**DO NOT ADJUST THE ARM VERTICALLY BY USING THE HORIZONTAL BAR**