

Zido® Shelves and Bin



Product	Part#
Zido Additional Shelf, Lg	ZADLxx
Zido Equipment Shelf, Med	ZESMxx
Zido Equipment Shelf, Lg	ZESLxx
Zido Metal Bin	ZMBxx

 www.ergotron.com
 **USA 1-800-325-3841**

For the latest User Installation Guide please visit: www.ergotron.com

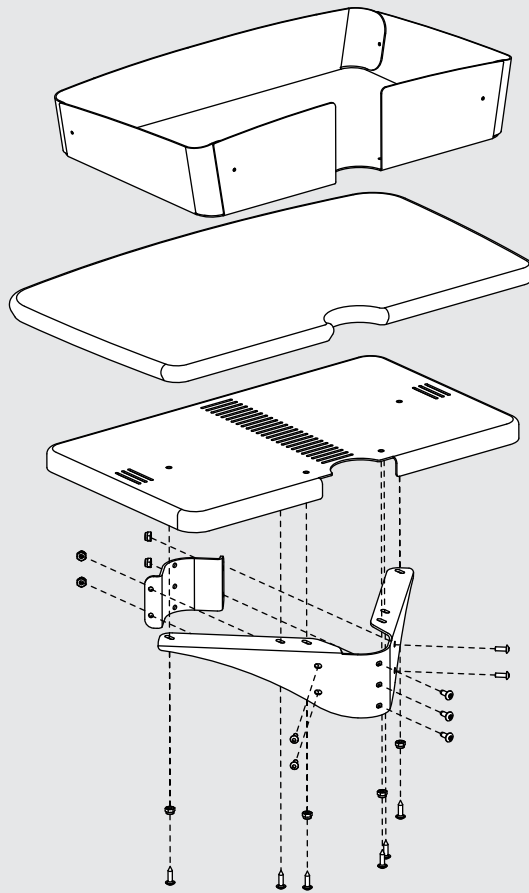

WELCOME

Thank you for purchasing your Zido Shelf or Bin! If you have any questions or if we can help you in any way, please contact us at 800.325.3841.

ASSEMBLY SEQUENCE

Plan out the assembly sequence to make your installation easier.

1. Pre-drill the top for accessories (Side Bin, Gel Cup/ Probe Holder, Extension Tube).
2. Assemble the cart.
3. Base Storage Shelf.
4. Drawer, Handle.
5. Additional Shelves, Equipment Shelves, Metal Bin.
6. Cable Bin, Glove Box Holder.
7. Side Bin, Gel Cup & Probe Holder, Extension Tube.
8. Pole-mount (8in) Handle, Flat Panel Mount.

PARTS LIST

Before beginning assembly of your Zido Shelf or Bin, please review the parts list to verify that your shipment is complete.

The 3-way wrench and 1/8" hex key are provided for assembly of your Equipment Shelf and Metal Bin. The 5/32" hex driver (provided with your Zido cart) is required for this assembly.

Shelves and Metal Bin	Quantity	Part Number
01 Metal Bin	1	225-2625-00
02 Additional Shelf	1	101-1029-06-50
03 Equipment Shelf	1	
Medium		225-2623-00
Large		225-2652-00
04 Inner Shelf Bracket	1	225-2986-00
05 Outer Shelf Bracket	1	225-2626-00
06 Nylok Nuts	8	325-5186-00
07 3/4" Wood Screws (for Wood Shelves)	4	325-5575-00
08 1/2" Button-head Screw	4	325-5193-00
09 Self-threading Screw	3	325-5464-00
10 1/8" Hex Key (not shown)	1	375-5015-00
11 Zido Strap and Buckle Kit f/Equ Shelf (not shown)	1	ZSTRBK

STEP 1

Install the Outer Shelf Bracket

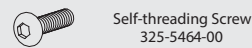

- Select the location for your shelf or bin. Align the outer shelf bracket so that the top of the bracket is just below the chosen shelf height.
- Loosely attach the bracket to the Zido tube using three self-threading screws.

Note: These fasteners are creating the threads in the tube, so the first few turns will require some force.

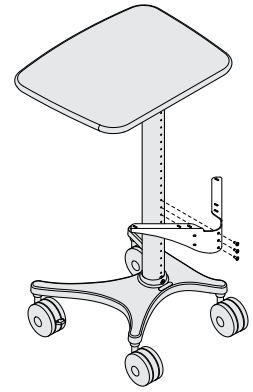

STEP 2

Install the Inner Shelf Bracket

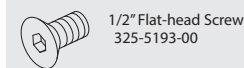

- Align the inner shelf bracket with the outer shelf bracket so the pair of holes on each end of the inner shelf bracket align with the pair of holes on the outer shelf bracket.
- Feed one 1/2" Button-head Screw through the inner bracket and through the outer bracket and loosely capture with a Nylock Nut. Repeat for the remaining three screws and nuts.

If you have an Additional Shelf, skip ahead to step 4. If you have an Equipment Shelf or Metal Bin, go to step 3.

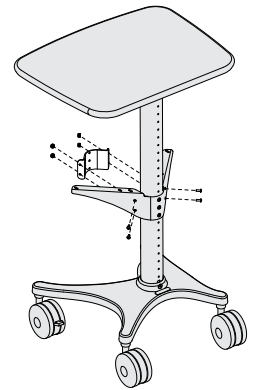

STEP 3

Install the Equipment Shelf or Metal Bin

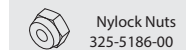

- Place the Shelf or Bin onto the bracket so that the pins seat into the holes on the bracket.
- Secure the Shelf or Bin to the bracket using four nuts. Tighten the three self-threading screws into the bracket. Tighten the inner bracket screws and nuts.
- If you have an Equipment Shelf, install the Strap and Buckle Kit.
- Use the provided 1/8" Hex Key and your own 3/8" socket, nut driver, or wrench to tighten the fasteners.

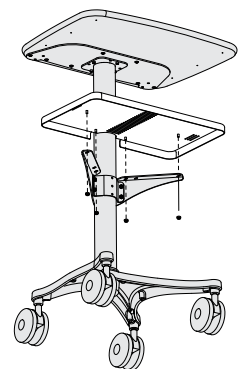

STEP 4

Install the Additional Shelf

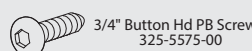

- Place the Shelf onto the bracket so that the holes on the bottom of the shelf align with the holes on the bracket.
- Secure the shelf to the bracket using four 3/4" wood screws. Tighten the three self-threading screws into the bracket. Tighten the inner bracket screws and nuts.
- Use the provided 1/8" Hex Key and your own 3/8" socket, nut driver, or wrench to tighten the fasteners.

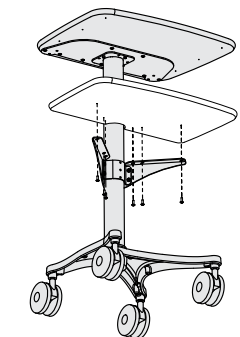

CONGRATULATIONS! YOUR SHELF AND BIN ASSEMBLY IS COMPLETE!

For Warranty visit: www.ergotron.com/warranty

For Service visit: www.ergotron.com

For local customer care phone numbers visit: <http://contact.ergotron.com>

Americas Sales and Corporate Headquarters

1181 Trapp Rd.
St. Paul, MN USA
1-800-325-3841
www.ergotron.com
sales@ergotron.com

	<p>While Ergotron, Inc. makes every effort to provide accurate and complete information on the installation and use of its products, it will not be held liable for any editorial errors or omissions (including those made in the process of translation from English to another language), or for incidental, special or consequential damages of any nature resulting from furnishing this instruction and performance of equipment in connection with this instruction. Ergotron, Inc. reserves the right to make changes in the product design and/or product documentation without notification to its users. For the most current product information, or to know if this document is available in languages other than those herein, please contact Ergotron. No part of this publication may be reproduced, stored in a retrieval system, or transmitted in any form or by any means, electronic, mechanical, photocopying, recording or otherwise without the prior written consent of Ergotron, Inc., 1181 Trapp Road, Eagan, Minnesota, 55121, USA. Patents Pending and Patented U.S. & Foreign. Ergotron is a registered trademark of Ergotron, Inc.</p>
---	---

© 2016 Ergotron, Inc. All rights reserved.

All trademarks are the property of their respective companies. Anthro is a registered trademark and brand of Ergotron Inc. Anthro-DNA is a trademark of Ergotron Inc.