

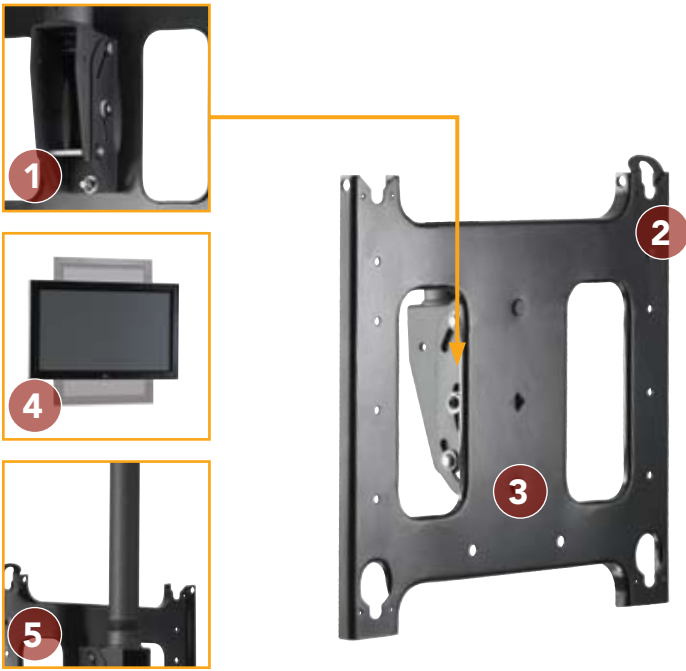

CEILING MOUNTS PCS™ □ 42 - 71" SINGLE CEILING MOUNT



FEATURES

- CENTRIS™ FINGERTIP TILT**
Effortlessly adjust display using Centris fingertip tilt technology. Screen angle stays set until you decide to re-adjust.
- CLICKCONNECT™ TECHNOLOGY**
PATENT-PENDING
An audible click confirms flat panels are locked in place for easy connect/disconnect. Supports optional security by adding a padlock.
- POST-INSTALLATION LEVELING**
No tools needed. Ultra fast and easy screen positioning with lock down capability.
- PORTRAIT/LANDSCAPE CAPABILITY**
Mounts in either portrait or landscape position.
- CABLE MANAGEMENT**
Easily route cables through 1-1/2" NPT extension column. Columns sold separately.

WHAT YOU NEED TO KNOW

ORDERING OPTIONS

Available in custom or universal.

OTHER PRODUCT OPTIONS



PCM™
42 - 71" Single Ceiling Mount with Angled Column



PDC™
42 - 71" Dual Ceiling Mount

SPECIFICATIONS

Roll	+/-2°
Tilt	+5°-20°
Yaw	360°
Color	Black
Weight Capacity	200 lbs (90.7 kg)



RECOMMENDED ACCESSORIES



CMA STRUCTURAL ADAPTERS



CMS EXTENSION COLUMNS

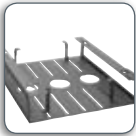

PAC251 ■ Universal Storage Accessory

For a complete list of flat panel mount accessories see page 73.

TECHNICAL DRAWINGS

