

9" Vertical Lift with Slide-out Keyboard Tray for Flat Panel Monitor & Keyboard OSHPD Mount or Standard Mount

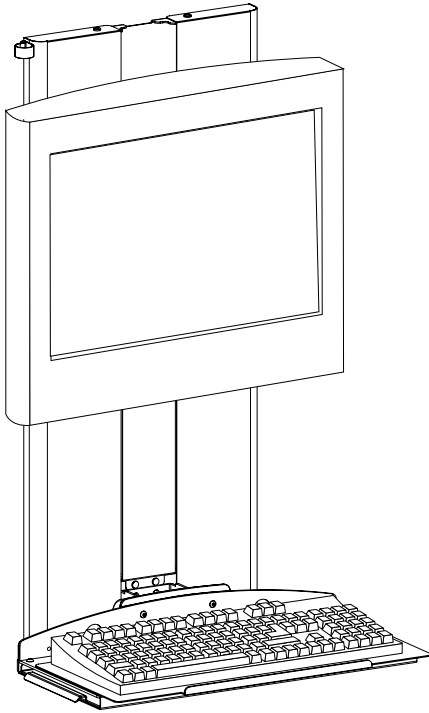

USA 1-800-888-8458
Europe +31 20 312.29.39

Ergonomic Mounting Height Instructions . . .	2
Required Tools	2
Components	3
Wall Anchorage Requirements	4
OSHPD	5
Standard	7
Monitor Attachment	9
Keyboard Attachment	12
Dimensions	16
Adjustment	17
Cover Installation and Cable Routing	20
Trouble Shooting	22



WARNING: Ergotron's Wall Mounted 9" Vertical Lift must be securely attached to your wall. Because wall construction varies widely and your ultimate mounting method is out of Ergotron's control, it is imperative that you consult with appropriate local engineering, architectural, or construction personnel to ensure that the 9" Vertical Lift is mounted properly to handle applied loads.



6.22.04

Raafat S. Aboulhosn
Structural Engineer S3913

Office of Statewide Health Planning and Development

OPA-0620 Approved, 04/28/04

Fixed Equipment Anchorage * Valid for 3 Years Maximum



John Gillengerten
John Gillengerten 916-654-3547

1 Determine Ergonomic Mounting Height

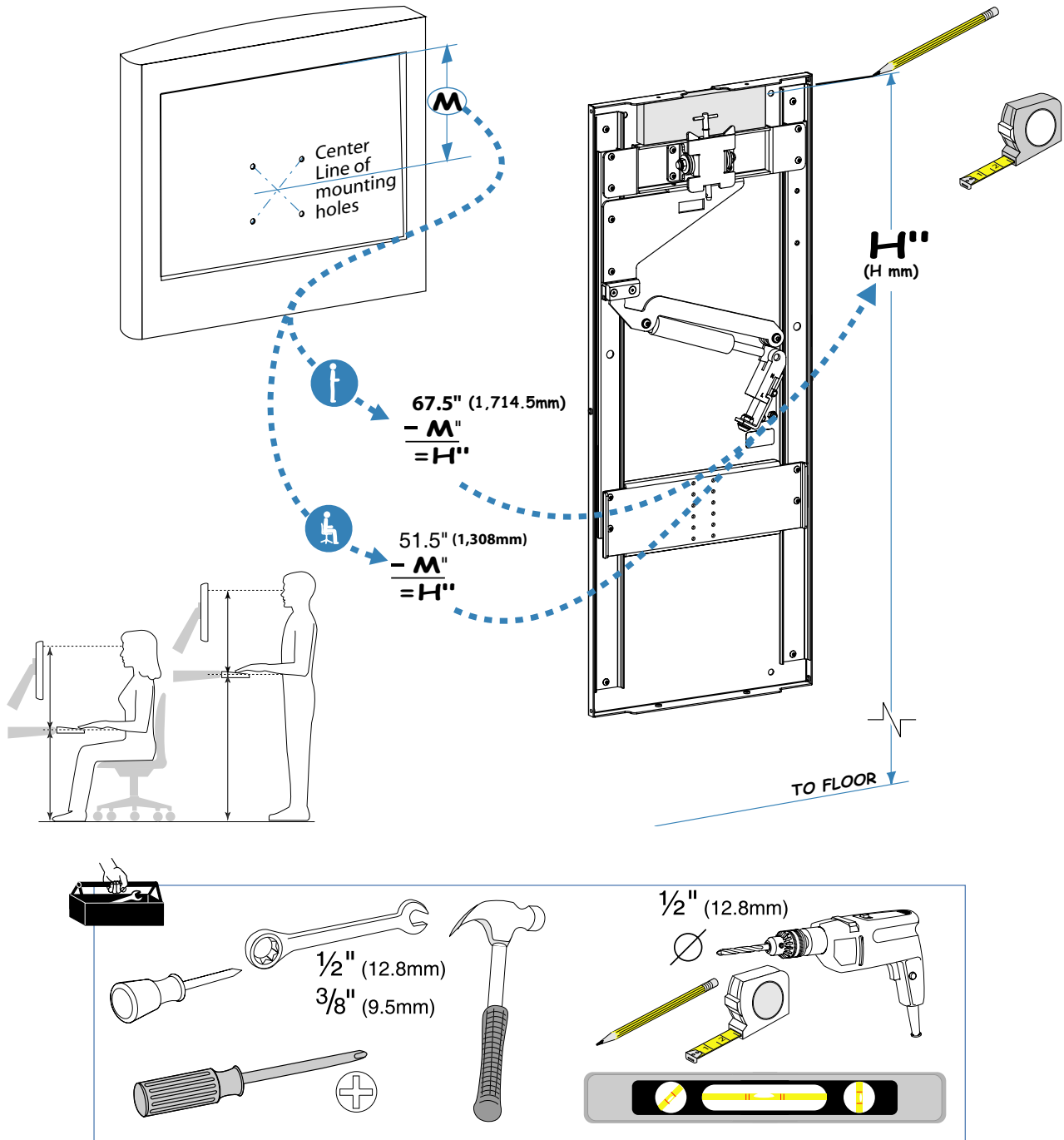

**NO OSHPD
REVIEW REQUIRED**



	A	B	C	D	E
1	<p>CAUTION: Do Not remove cardboard spacer until instructed to do so.</p>	1x	2x	1x	<p>Mounting Hole Template</p>
2		1x			
3	1x		2x	1x	
4	4x #8-32	1x	2x 2x	10x #8-32 x 3/16"	2x #8-32 x 3/8"
5	8x #8-32 x 5/16"	4x M4x10mm	4x	4x M4x20mm	1x
6	4x 1/4-20 x 1-1/2"			 3/32" 1/8" 5/32" 3/16"	
7	4x			10x	

**NO OSHPD
REVIEW REQUIRED**

2 Wall Anchorage Requirements

California OSHPD Anchorage Pre-approval Number OPA-0620

In compliance with standards established for the anchorage and installation of instrument support systems by the California Office of Statewide Health Planning and Development (OSHPD), Ergotron, Inc. has obtained pre-approval for two 9" Vertical Lift mounting methods. These mounting methods are limited to use with the following components on the following types of walls:

- a Light Gauge Metal Stud Walls (24 gauge minimum) - **page 5**
- b Wood Stud Walls (#2 Him Fir, Douglas Fir or better) - **page 6**

The Engineer of Record must verify the wall design using the forces specified in CBC Section 1632A, using $A_p=2.5$ and $R_p=3.0$ for the forces due to the component, combined with the lateral force of the wall itself, computed using the weight of the wall with $A_p=1.0$ and $R_p=3.0$. Most instrumentation weighs well below the maximum load ratings. It is impractical to attempt to meet specific load requirements based on given weights of various instruments and the potential for changing instruments. Consequently, all installations must meet the maximum load ratings. The design of the wall studs is by the engineer of record. Inspection of the anchorage by OSHPD is required prior to the installation of the mount system.

Compliance with these written instructions, beginning on page 5, is required for the installation of the system.

Standard Anchorage - page 7

This manual also provides information on mounting Ergotron 9" Vertical Lift in situations that do not require California OSHPD compliance.

OSHPD METHOD A LIGHT GAUGE METAL STUD WALLS

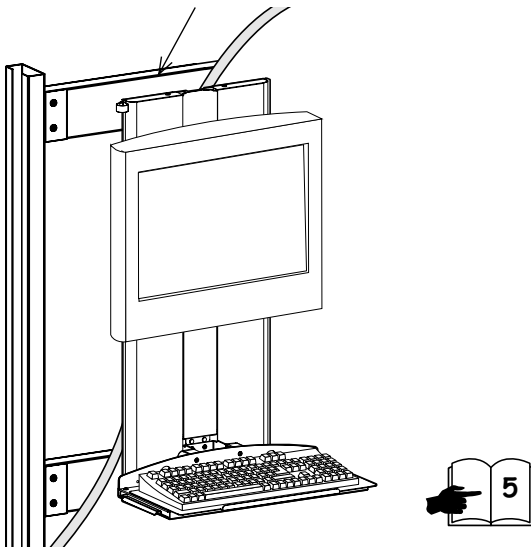

OSHPD METHOD B WOOD STUD WALLS

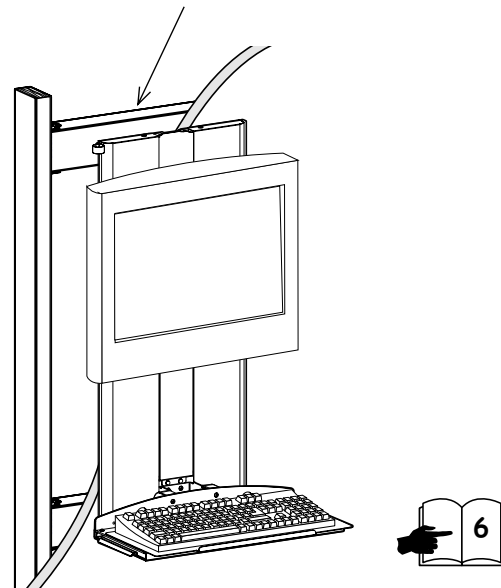

WARNING: Follow these instructions to ensure that the Ergotron 9" Vertical Lift is mounted according to standards established by OSHPD to handle applied loads. Failure to comply with standards established by OSHPD may result in property damage and personal injury.



Raafat S. Aboulhosen
Structural Engineer S3913

Office of Statewide Health Planning and Development

OPA-0620 Approved, 04/28/04

Fixed Equipment Anchorage * Valid for 3 Years Maximum



John A. Gillengerten
John Gillengerten 916-654-3547

OSHPD METHOD A LIGHT GAUGE METAL STUD WALLS

The design of the wall studs is by the engineer of record.

- a** Construct metal stud wall with components shown below.
- b** Go to "step 1", page 2 to determine ergonomic mounting height, then continue with "step c", below.
- c** Mount lift chassis to wall as shown below, then proceed to "step 3", page 9.

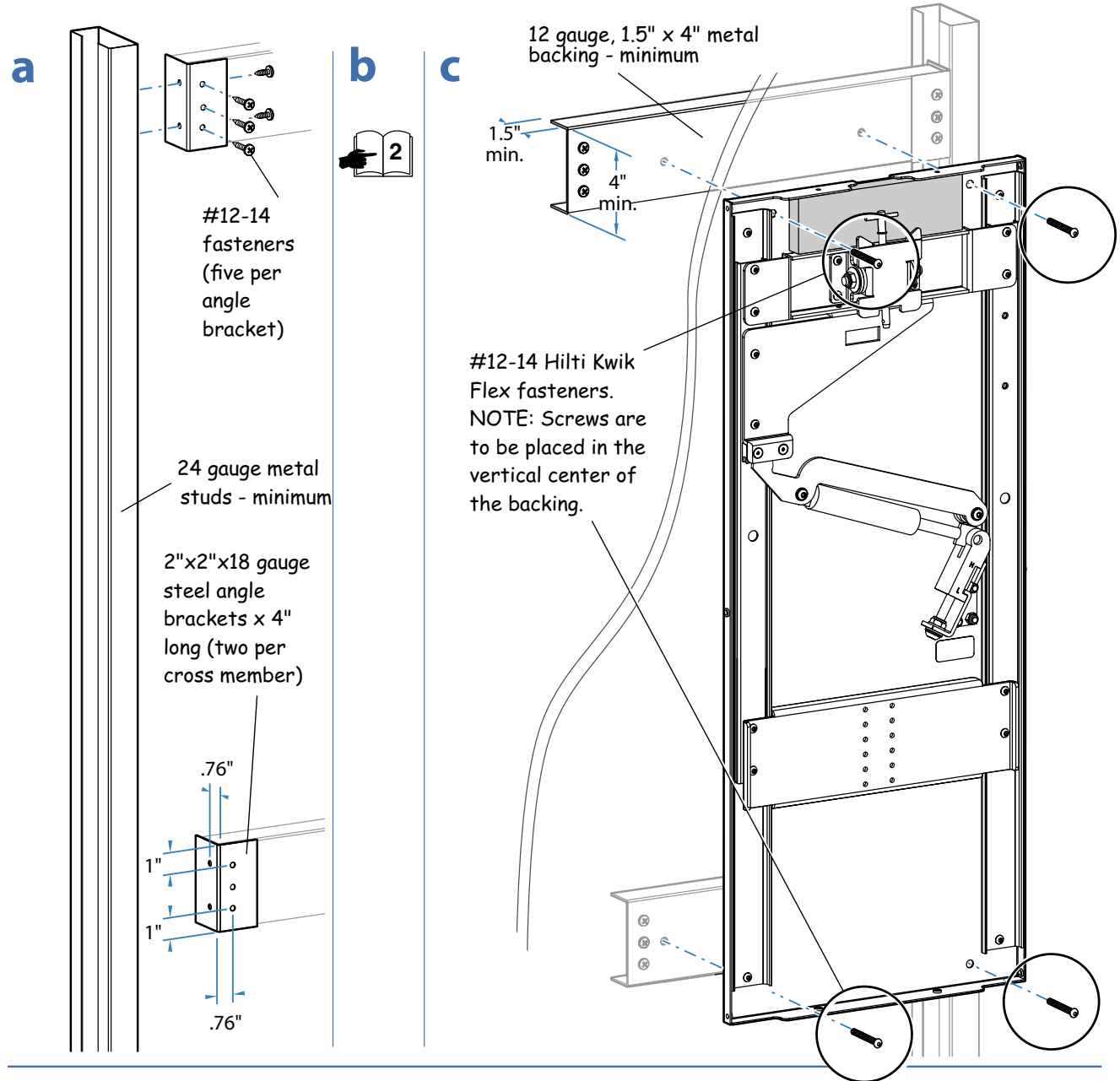

Office of Statewide Health Planning and Development

OPA-0620 Approved, 04/28/04

Fixed Equipment Anchorage * Valid for 3 Years Maximum



John D. Gillengerten
John Gillengerten 916-654-3547

OSHPD METHOD B WOOD STUD WALLS

The design of the wall studs is by the engineer of record.

- a** Construct wood stud wall with components shown below.
- b** Go to "step 1", page 2 to determine ergonomic mounting height, then continue with "step c", below.
- c** Mount lift chassis to wall as shown below, then proceed to "step 3", page 9.

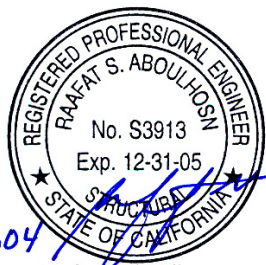
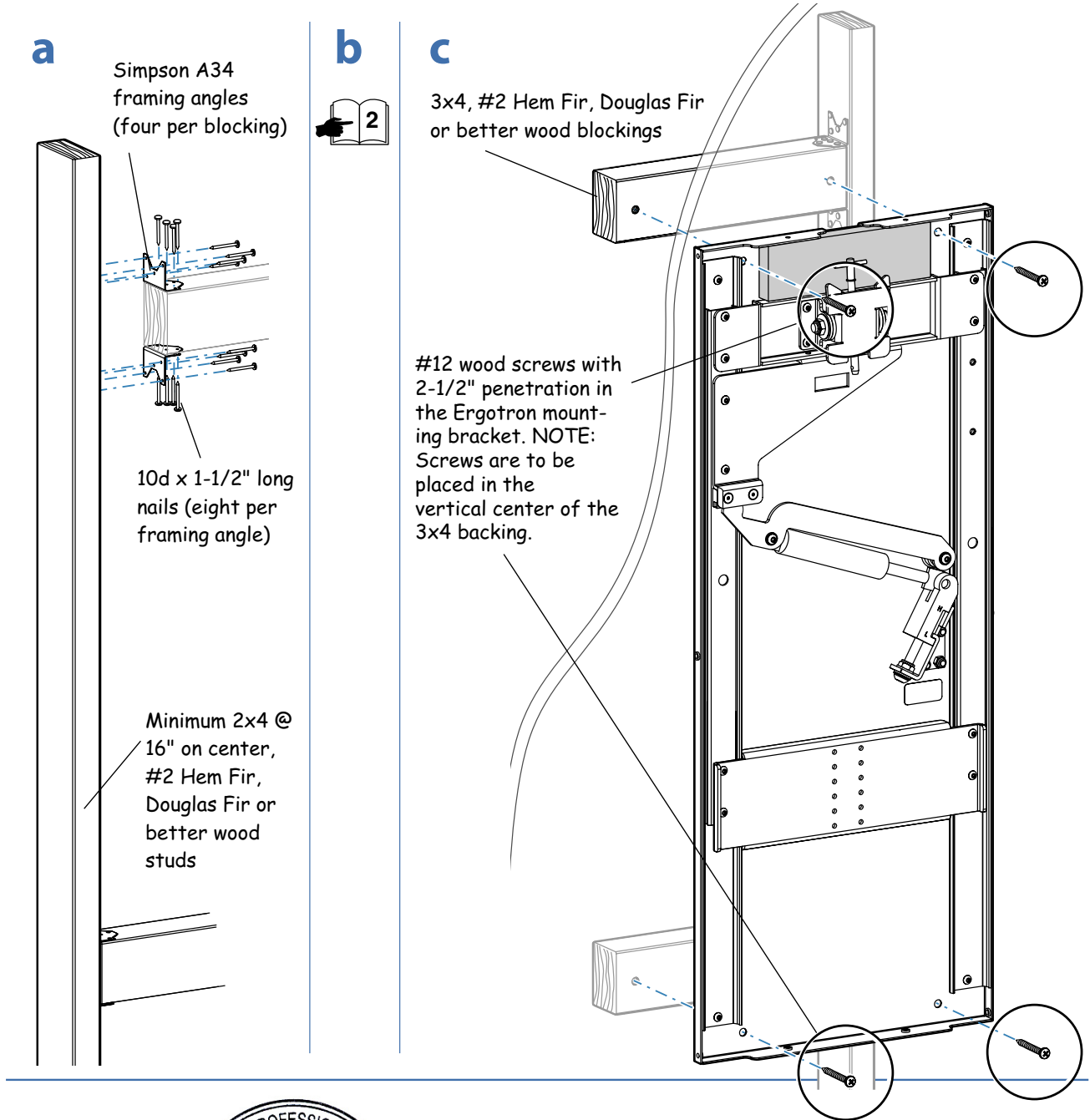

Raafat S. Aboulhosn
Structural Engineer S3913

Office of Statewide Health Planning and Development

OPA-0620 Approved, 04/28/04
Fixed Equipment Anchorage * Valid for 3 Years Maximum



John D. Gillengerten
John Gillengerten 916-654-3547

STANDARD ANCHORAGE TO SHEETROCK WALL

a Go to "step 1", page 2 to determine ergonomic mounting height, then return to "step b", below.



WARNING: The Wall Mounted 9" Vertical Lift must be securely attached to your wall. Because wall construction varies widely and your ultimate mounting method is out of Ergotron's control, it is imperative that you consult with appropriate local engineering, architectural, or construction personnel to ensure that the 9" Vertical Lift is mounted properly to handle applied loads.

b Use level, pencil and provided template to mark ergonomic mounting height.

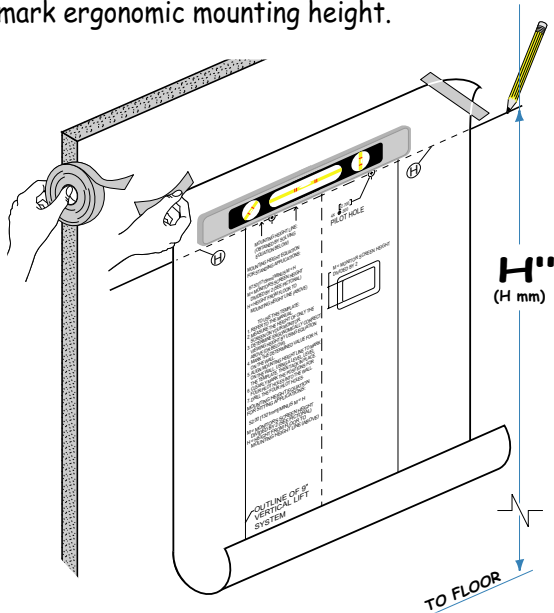

c Center punch holes for wall anchors.

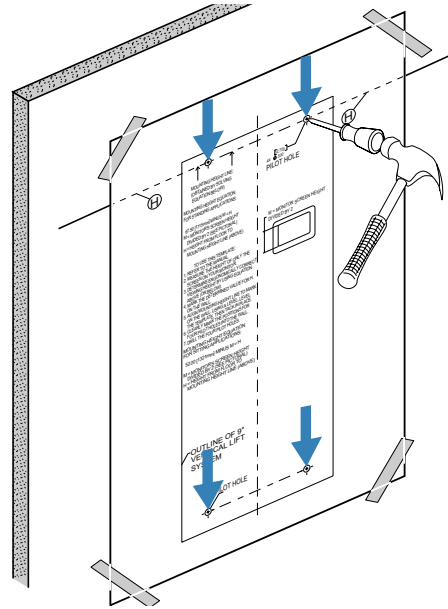

d Drill anchor holes with 1/2" diameter bit*

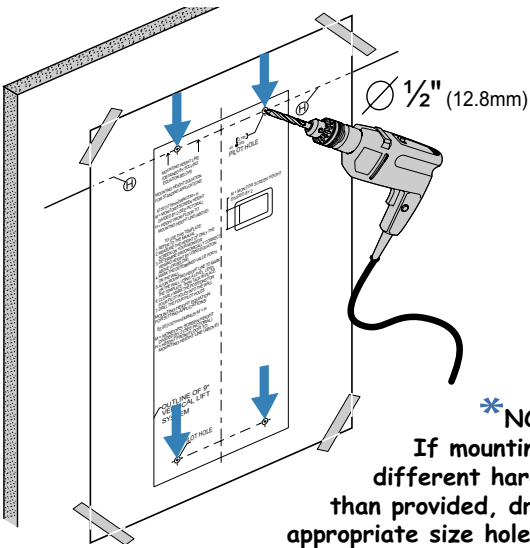

e Remove template from wall.

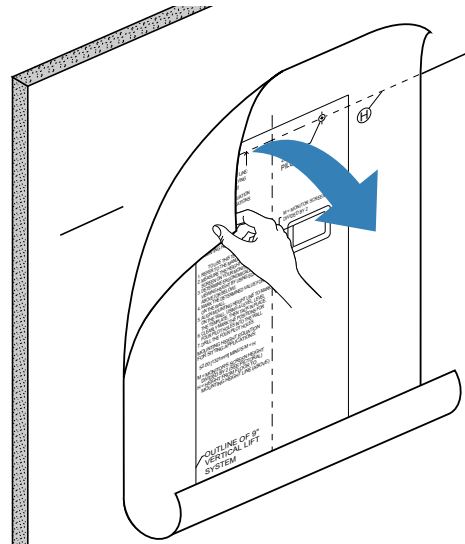

**NO OSHPD
REVIEW REQUIRED**

STANDARD ANCHORAGE TO SHEETROCK WALL

For applications where compliance to OSHPD is not required.

If, after consulting with appropriate local engineering, architectural, or construction personnel it is determined that wall anchor hardware should be used, install as shown:

f Push anchor plate into hole.

g Pull loop back so plate opens flat against inside surface of wall.

h Push collar into hole.

i Snap off loop.

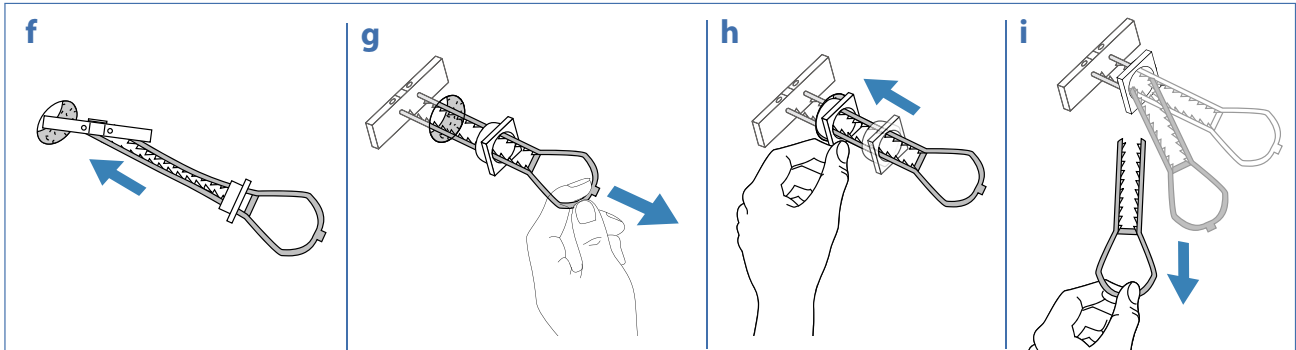
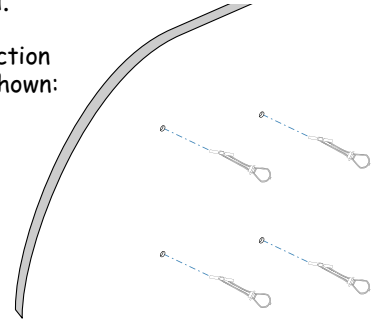

j Mount lift chassis to wall with four, 1/4-20x1-1/2" screws and 5/32" hex wrench, provided.

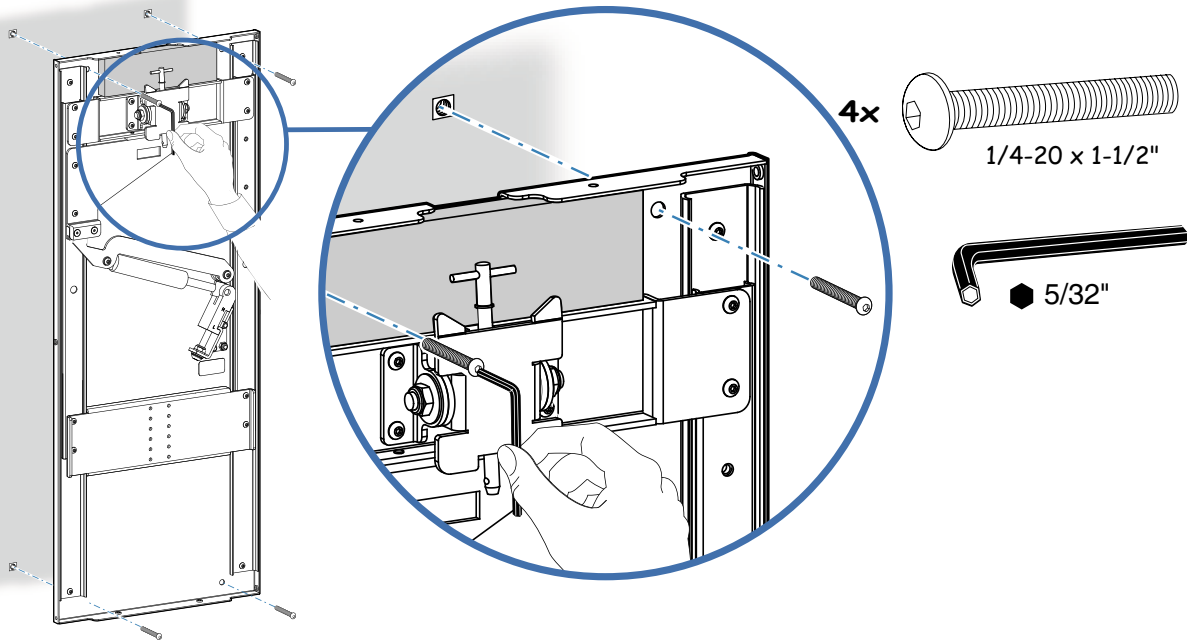

**NO OSHPD
REVIEW REQUIRED**

3 Remove spacer



WARNING: Injury may result if the cardboard spacer is removed without first lowering the keyboard bracket. DO NOT remove the cardboard spacer before lowering the keyboard bracket.

- a Lower keyboard bracket.
- b Remove cardboard spacer.

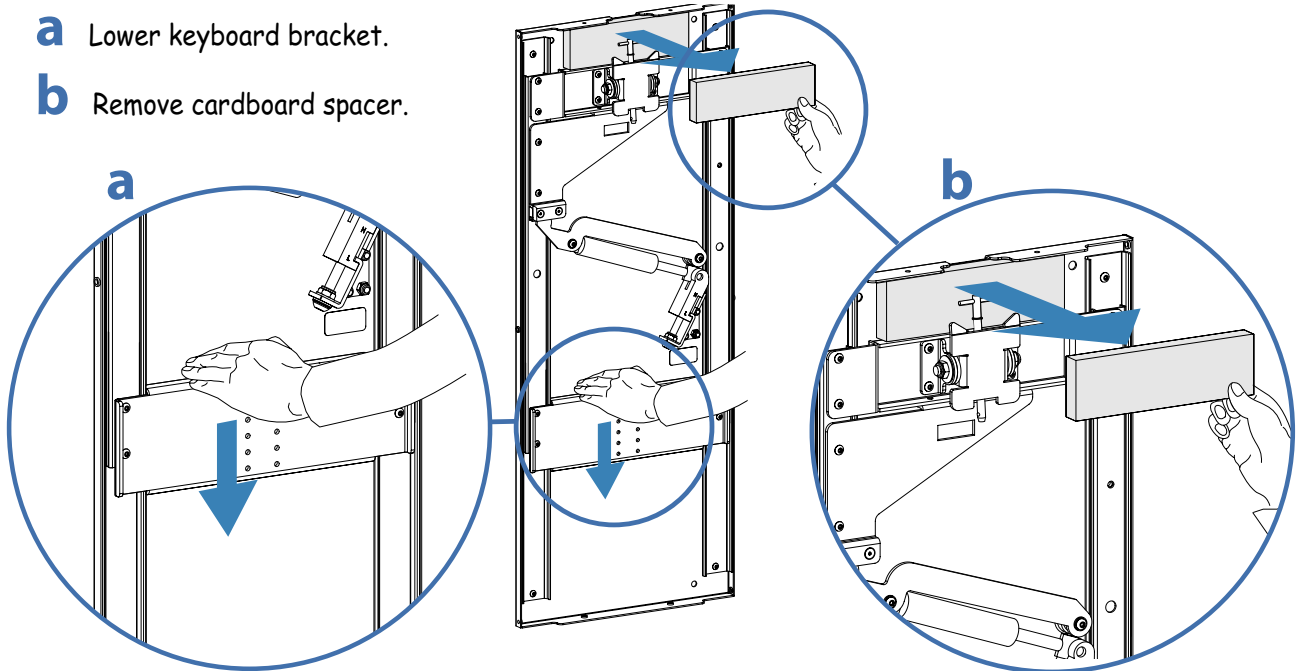

4 Attach monitor bracket

Identify the hole mounting pattern dimensions on the back of your monitor and follow appropriate instructions on next page.

- 75 mm VESA® FDMI™ Standard Hole Mount*
- 100 mm VESA® FDMI™ Standard Hole Mount*
- Non-Standard Hole Mount: contact Ergotron*

75 mm

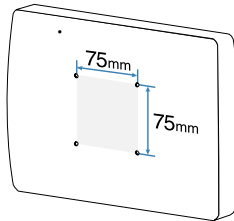

100 mm

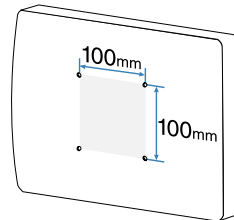

X mm

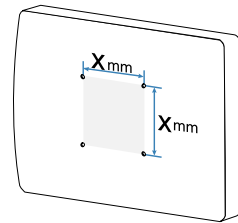

USA 1-800-888-8458
Europe +31 20 312.29.39

*VESA® (Video Electronics Standard Association) FDMI™ (Flat Display Mounting Interface) Standard Hole Mount



WARNING: If your monitor uses a screw size which is different than those provided with your Ergotron mounting solution, use the screws provided with the monitor as those provided may damage your monitor.

**NO OSHPD
REVIEW REQUIRED**

75 mm

VESA® FDMI™

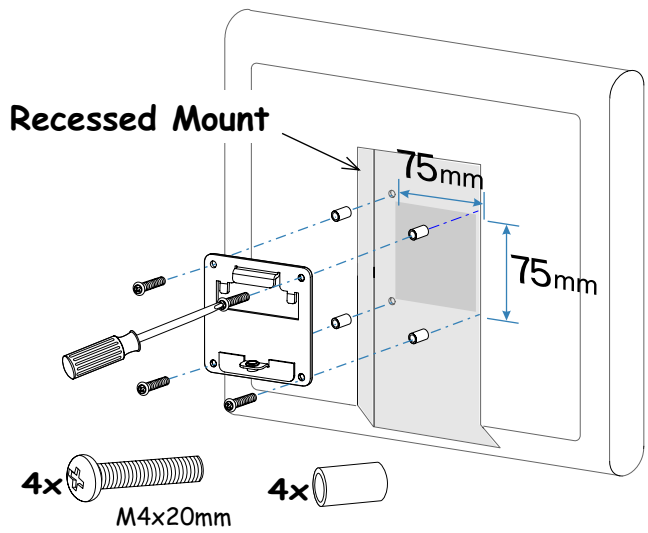
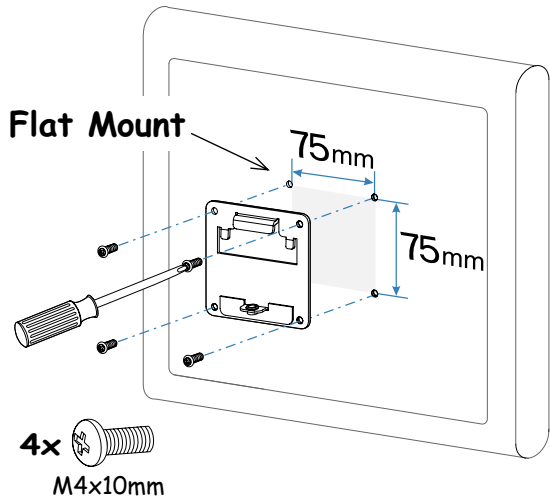

100 mm

VESA® FDMI™

a Attach 75-100mm adaptor to monitor bracket.

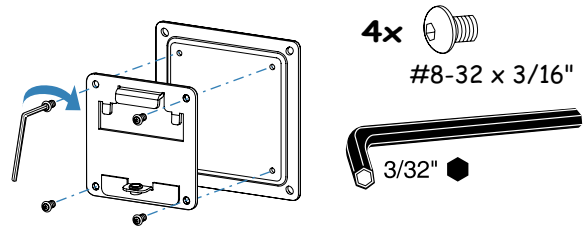
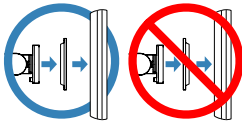

b Attach 75-100mm adaptor/monitor bracket to monitor.

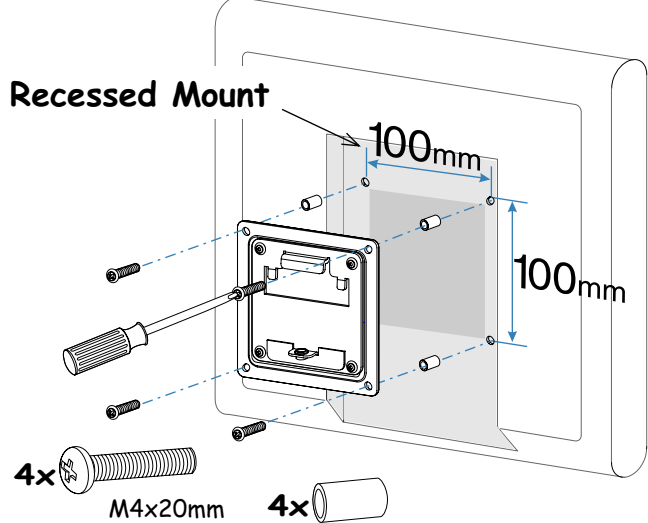
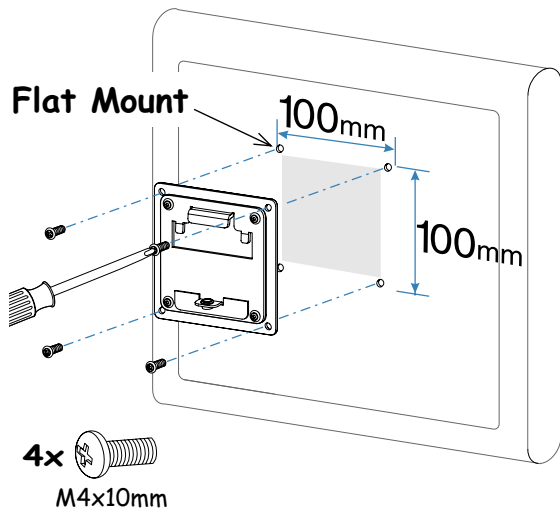

**NO OSHPD
REVIEW REQUIRED**

5 Mount monitor to lift



WARNING: The monitor will not be securely attached to the 9" Vertical Lift until the Locking Pin passes through the tab on the Quick Release Bracket. Do not leave the monitor unsupported until you are certain the Locking Pin is in place.

- a** Lower monitor into position as shown.
- b** Pull up on locking pin.
- c** Swing bottom of monitor toward wall.
- d** Push locking pin down into tab as far as it will go.

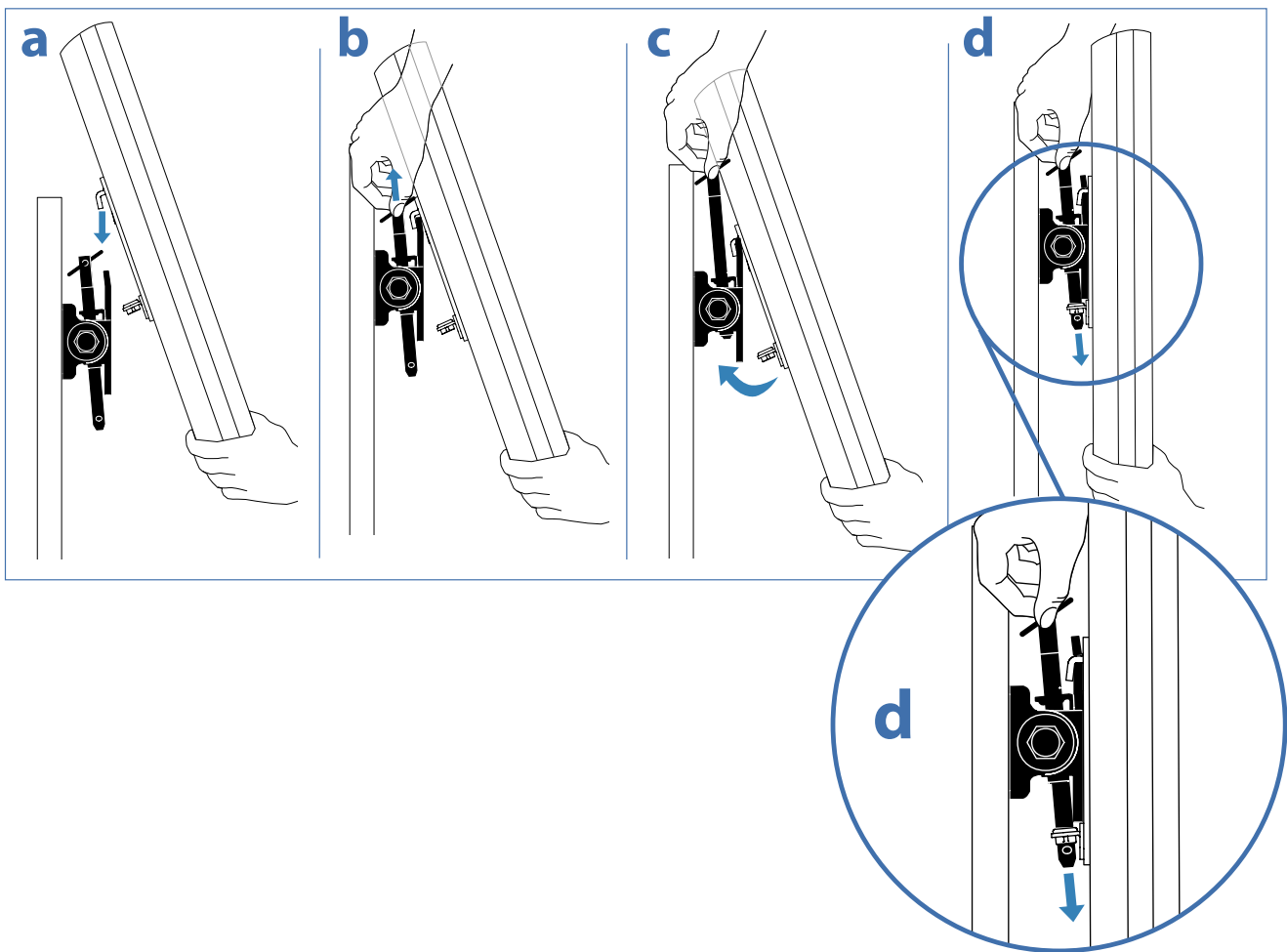
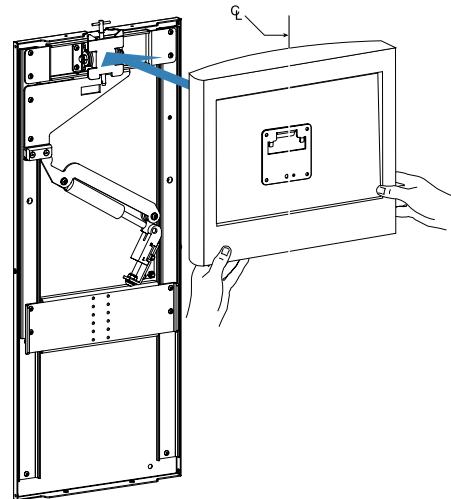

**NO OSHPD
REVIEW REQUIRED**

6 Attach keyboard pivot

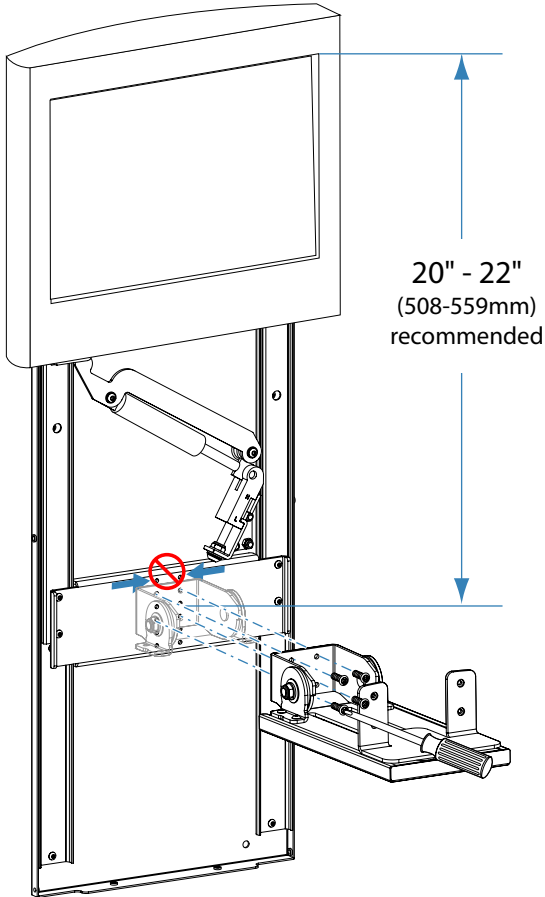

4x  #8-32 x 5/16"

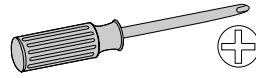

7 Attach keyboard tray

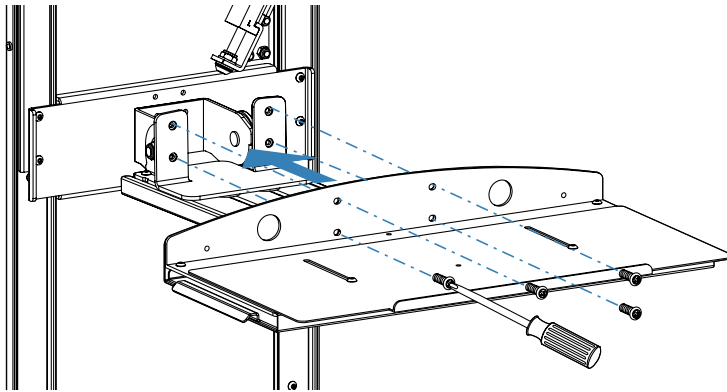

4x  #8-32 x 5/16"

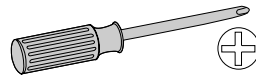

**NO OSHPD
REVIEW REQUIRED**

8 Keyboard tray position based on monitor size

a Determine which keyboard features can be utilized while maintaining minimum profile: Measure and note distance from center of hole mounting pattern to bottom of monitor; compare to diagram below, and proceed to the corresponding "step b".

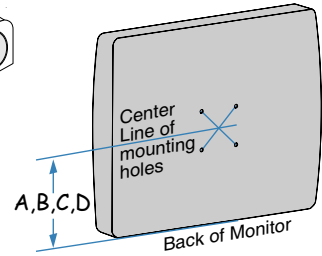
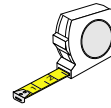

$A \leq 8 \frac{3}{4}''$ (222.25mm)	$B \leq 7''$ (177.8mm)	$C \leq 13''$ (330mm)	N/A

b Remove extension from keyboard tray.

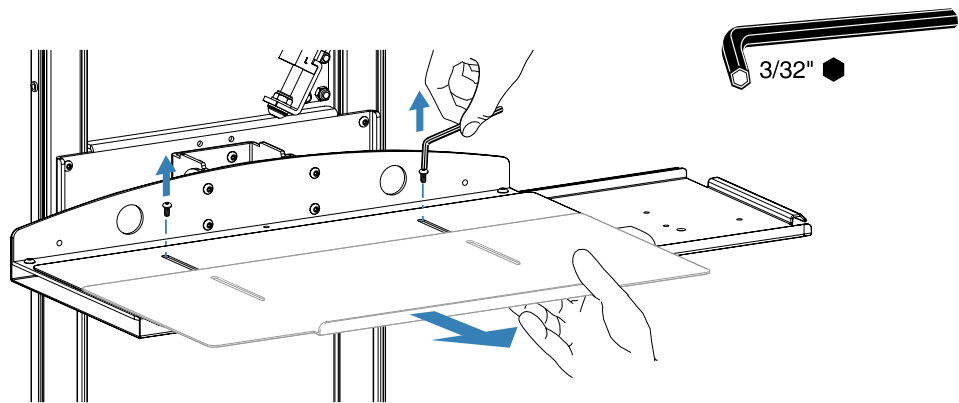
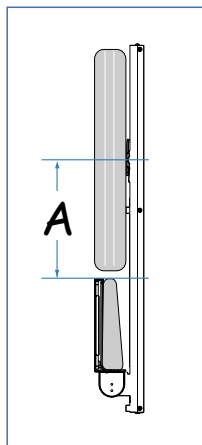

**NO OSHPD
REVIEW REQUIRED**

b Adjust keyboard tray extension: loosen screws with hex wrench, slide the extension to desired position, retighten screws.

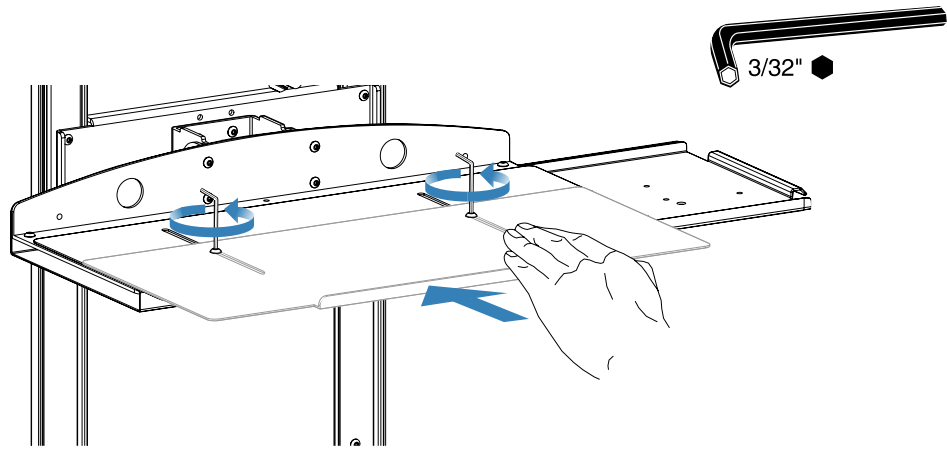
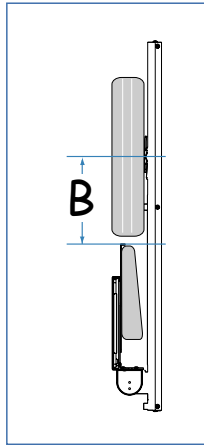

b Install wrist rest (sold separately):

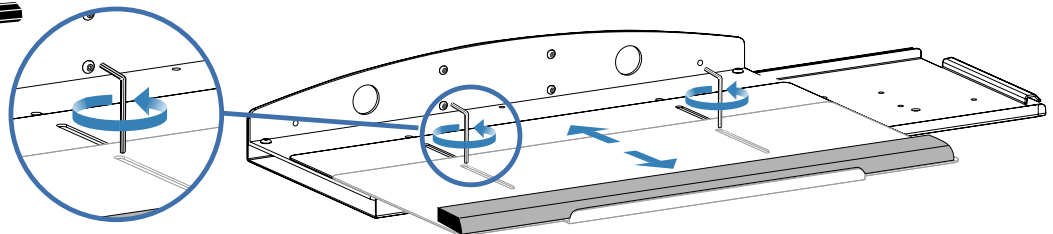
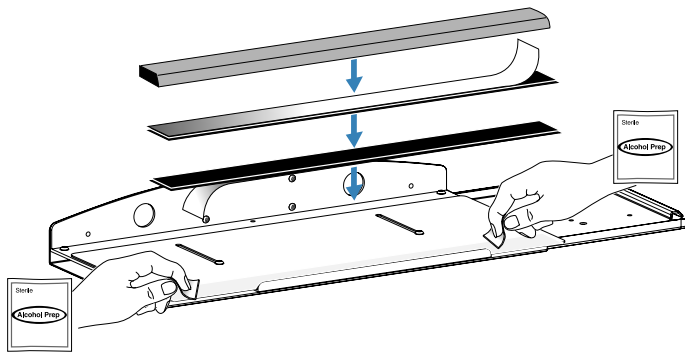
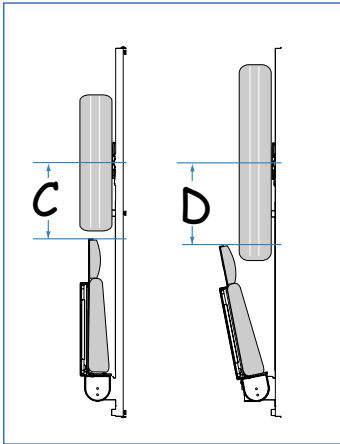

**NO OSHPD
REVIEW REQUIRED**

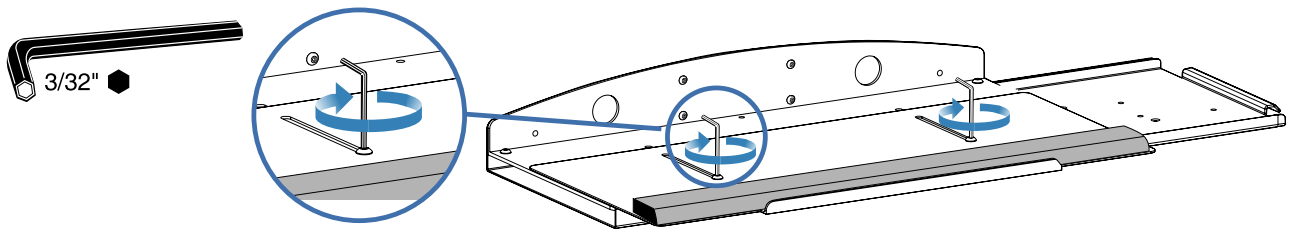
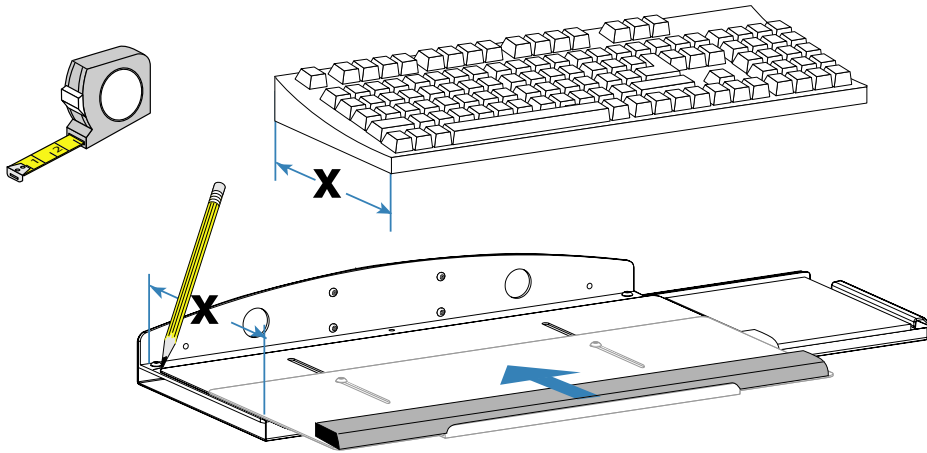

9 Mount keyboard to tray

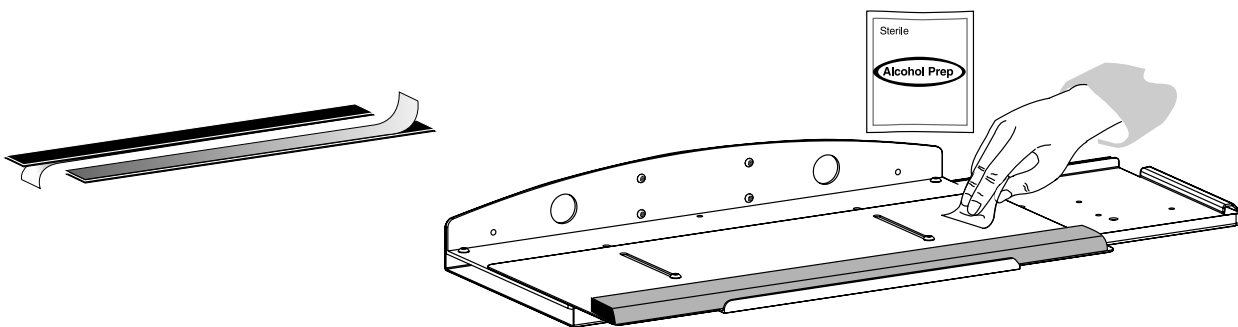
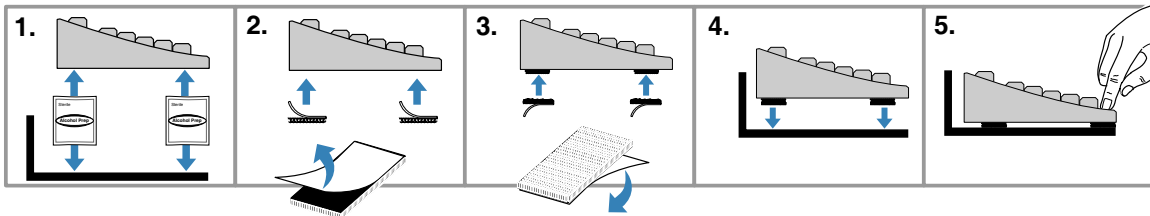

**NO OSHPD
REVIEW REQUIRED**

9 Keyboard mount (continued)

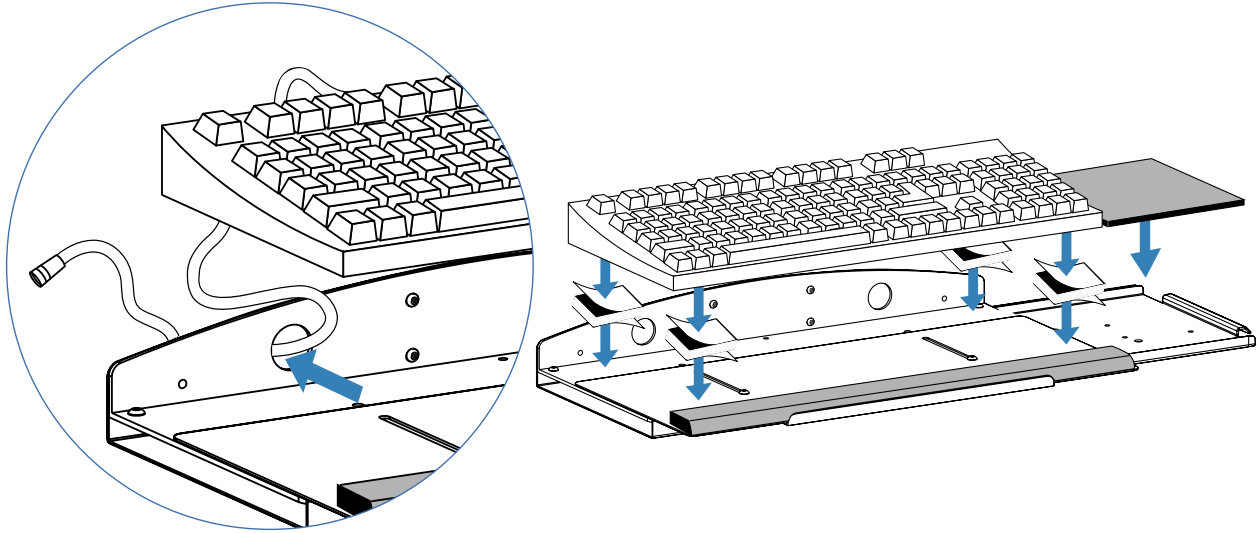

Dimensions

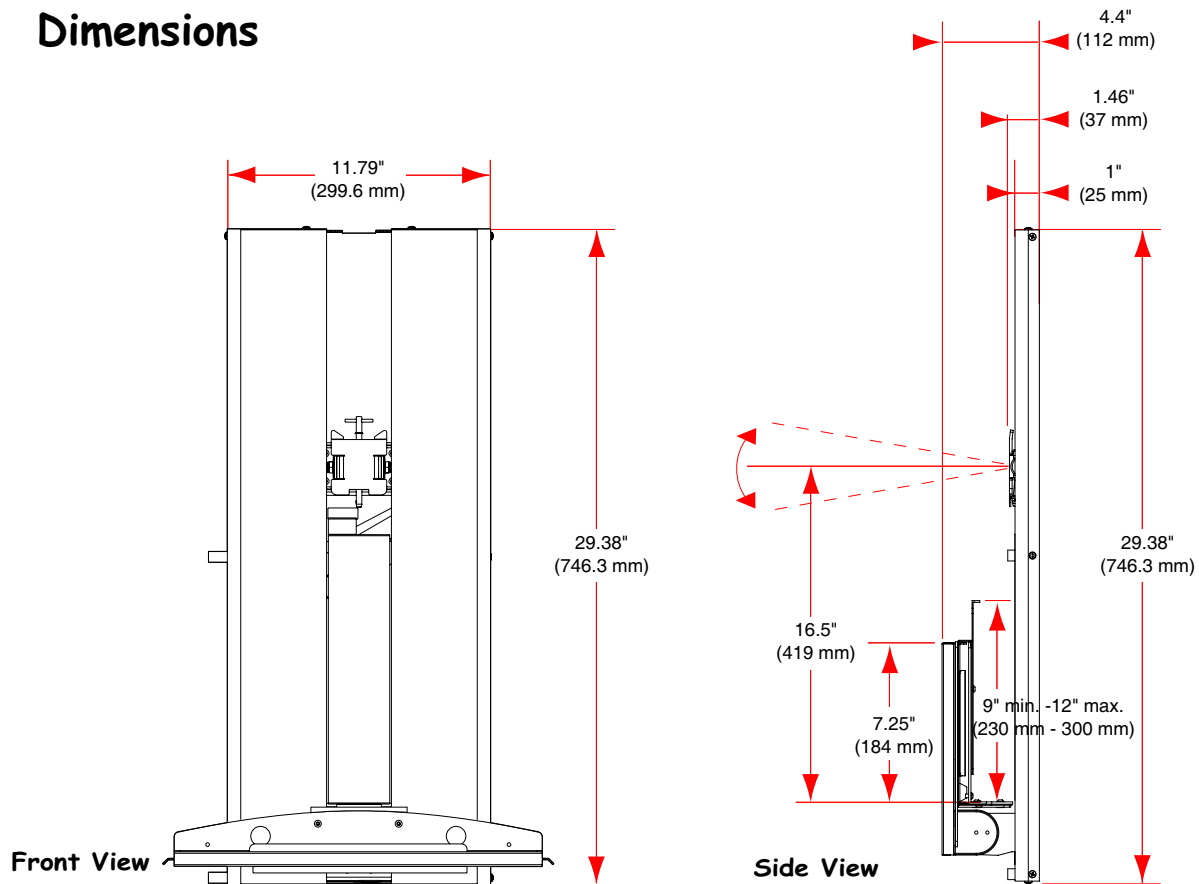

**NO OSHPD
REVIEW REQUIRED**



Adjustment
Justering
Justierung
Ajustement
Bijstelling
Ajuste
Regolazione

After completion of installation steps, evaluate pivot function for your specific installation. Ergotron's pivot joints are factory set to provide the proper pivot control and moving force for the majority of users. If excessive force is required to adjust your setup, or if your monitor or keyboard do not remain in the desired position, pivot adjustment may be required. Instructions for adjustment of the pivots can be found in the following pages.



a Tilt monitor through the entire 10° range.

Monitor Pivot

b If monitor pivot needs adjustment, remove monitor and tighten or loosen as required. NOTE: adjust at each pivot point equally.

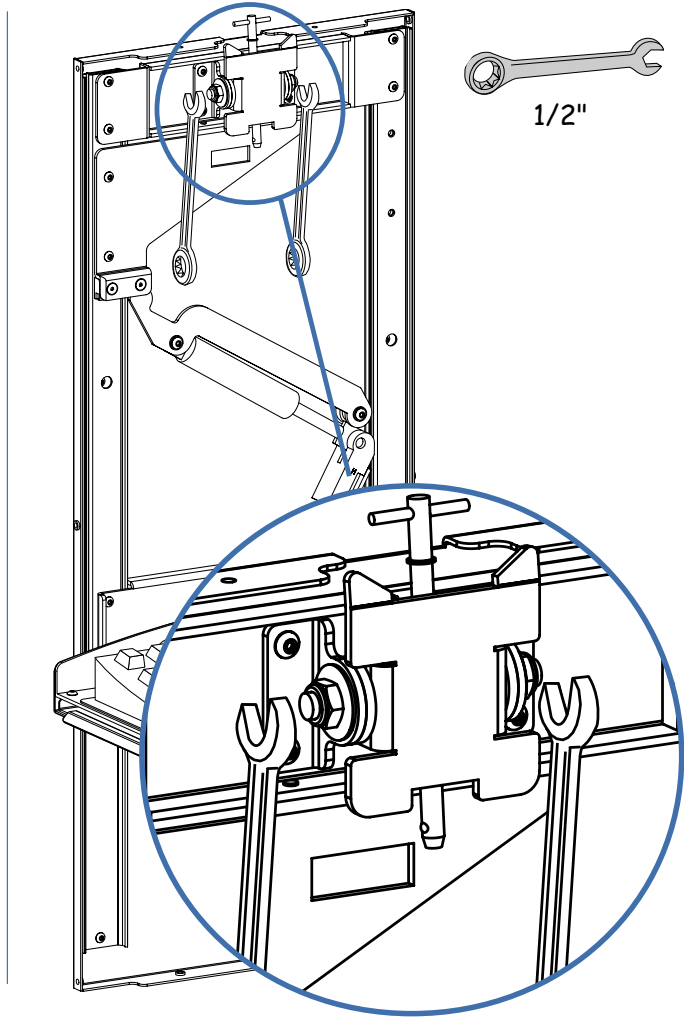
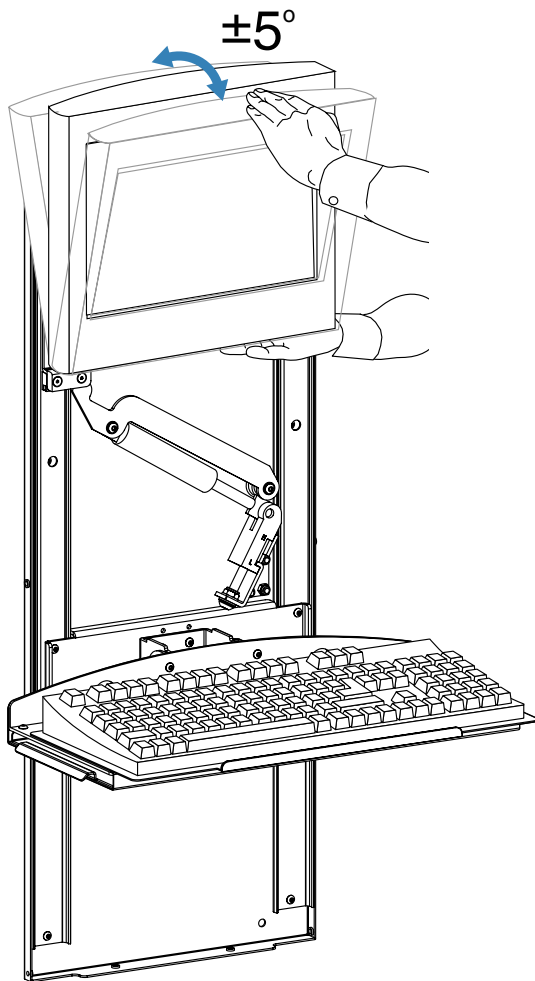

**NO OSHPD
REVIEW REQUIRED**



Keyboard Pivot

a Tilt Keyboard Tray, with keyboard attached, through the entire 90° range.

b If Keyboard Tray pivot needs adjustment, tighten or loosen as required.
NOTE: adjust at each pivot point equally.

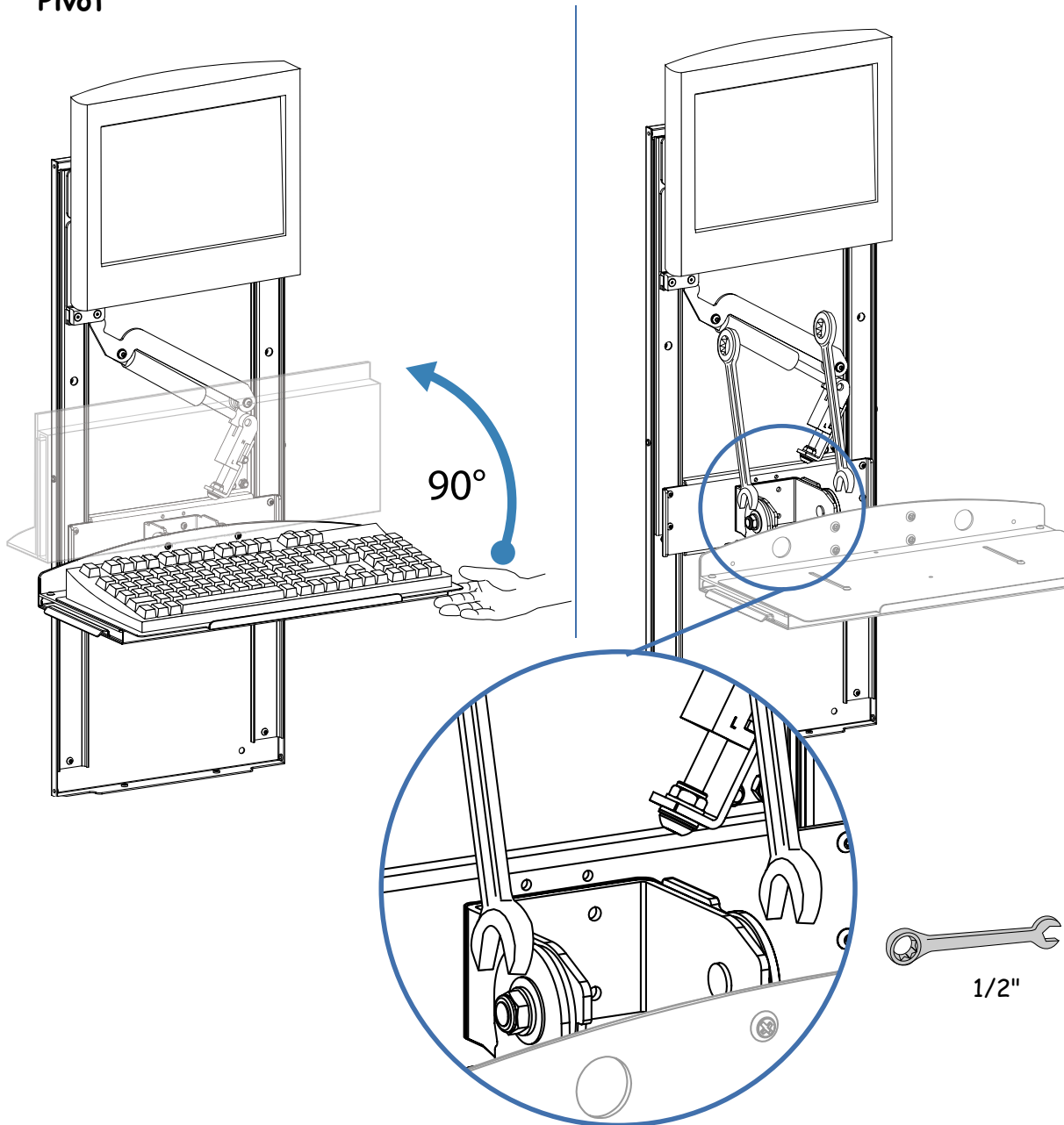

**NO OSHPD
REVIEW REQUIRED**



- a** With all components loaded, move monitor and keyboard to highest and lowest positions.
- b** If adjustment is needed, tighten or loosen as required.

Vertical Lift

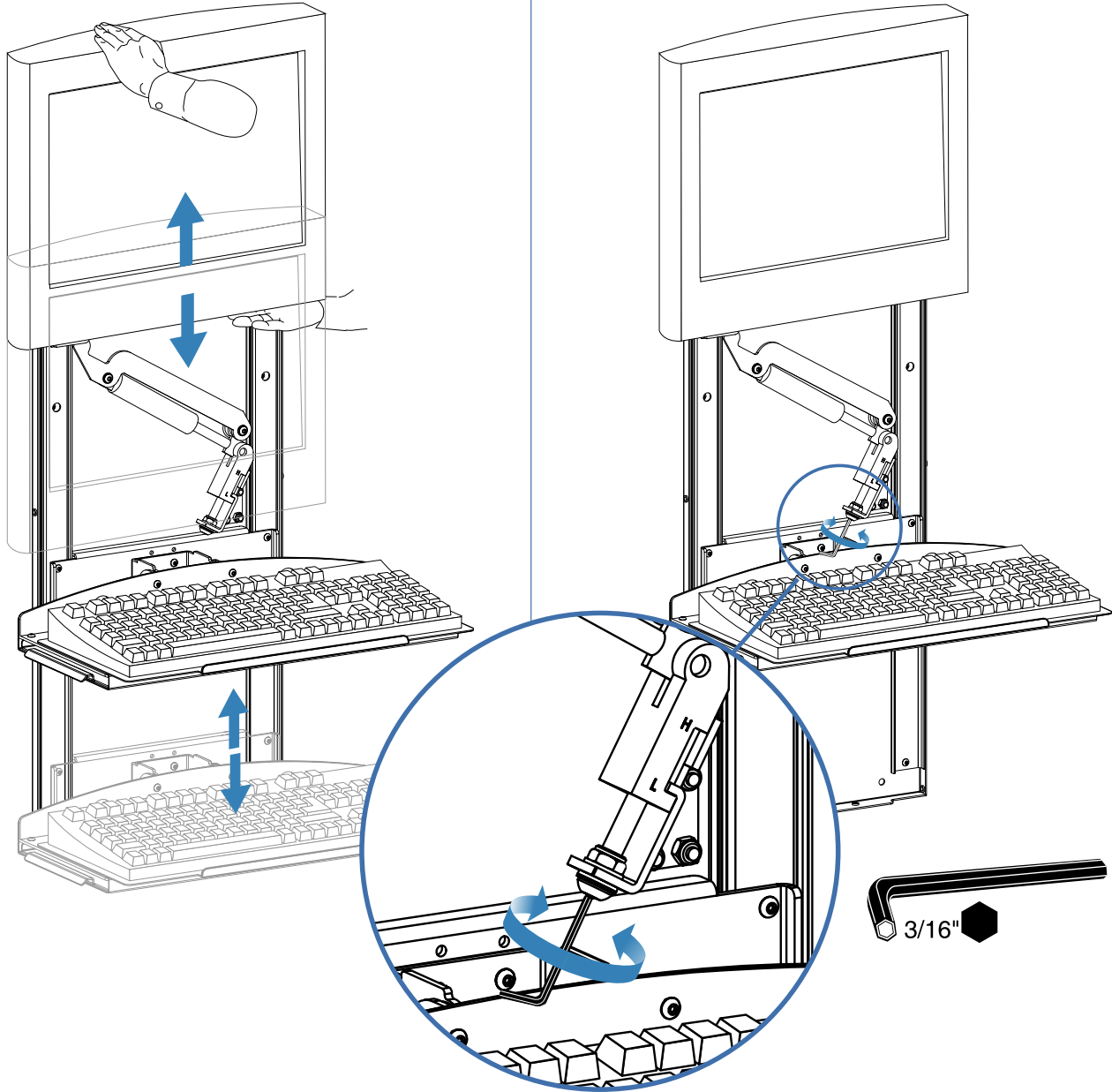

**NO OSHPD
REVIEW REQUIRED**

10 Attach covers and cable clips

a Remove monitor.

b Attach front cover.

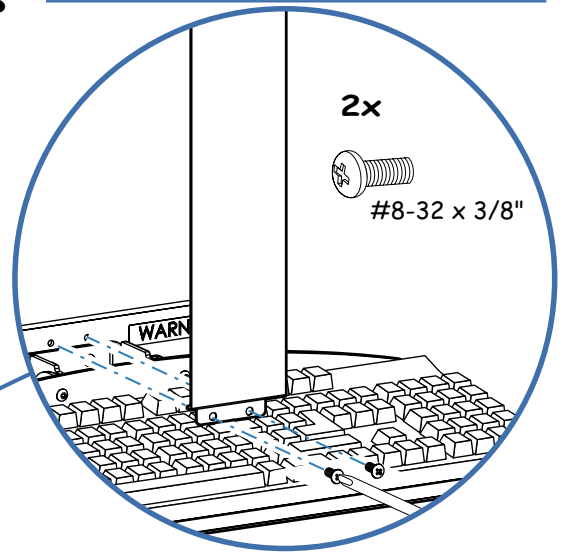
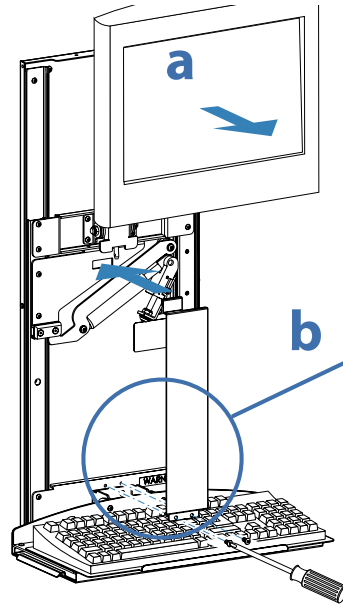
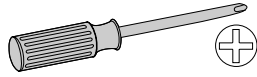

c Attach cable clips and side covers. **NOTE:** The four cable clips can be attached at any of the holes located along the top, bottom and sides of the lift chassis using the same screws that secure the side covers. Re-attach monitor after front and side covers are attached.

10x
#8-32 x 3/16"

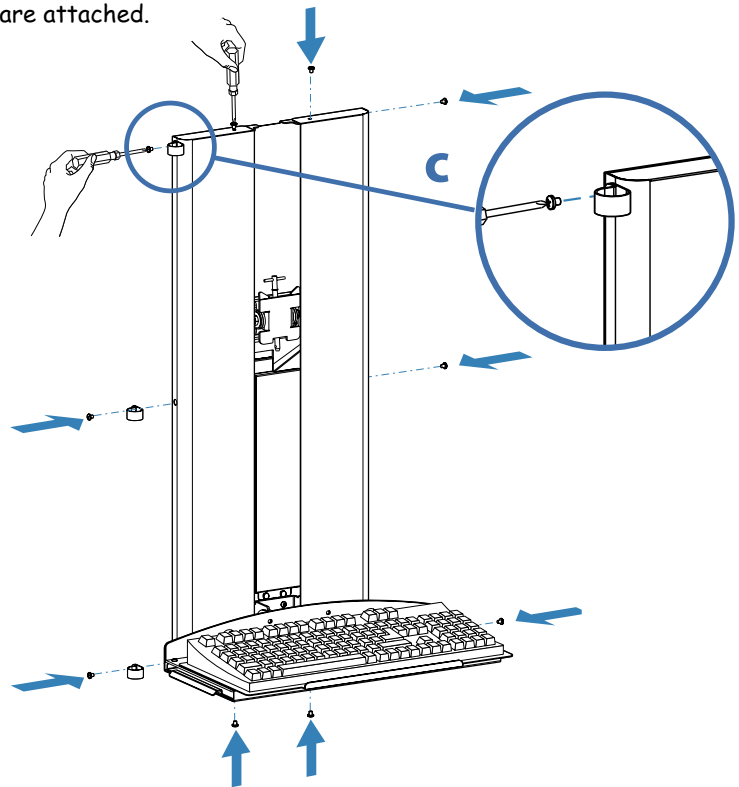
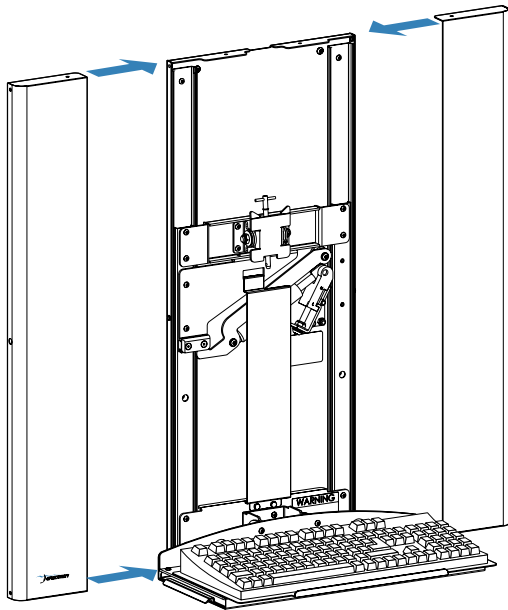
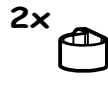
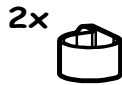

**NO OSHPD
REVIEW REQUIRED**

d Reattach monitor.

e Slide-on keyboard covers.

f Route and organize cables with provided ties.

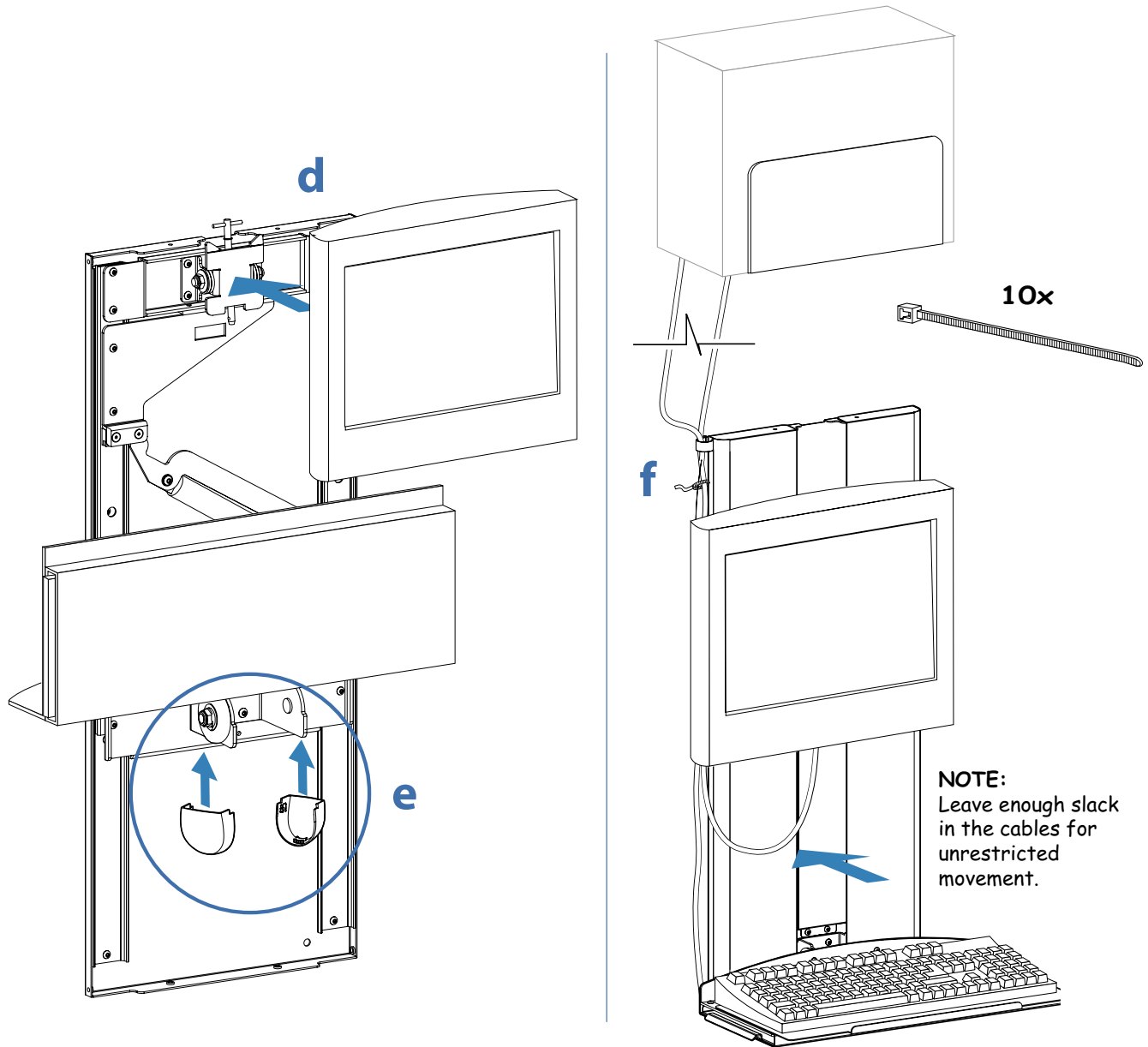





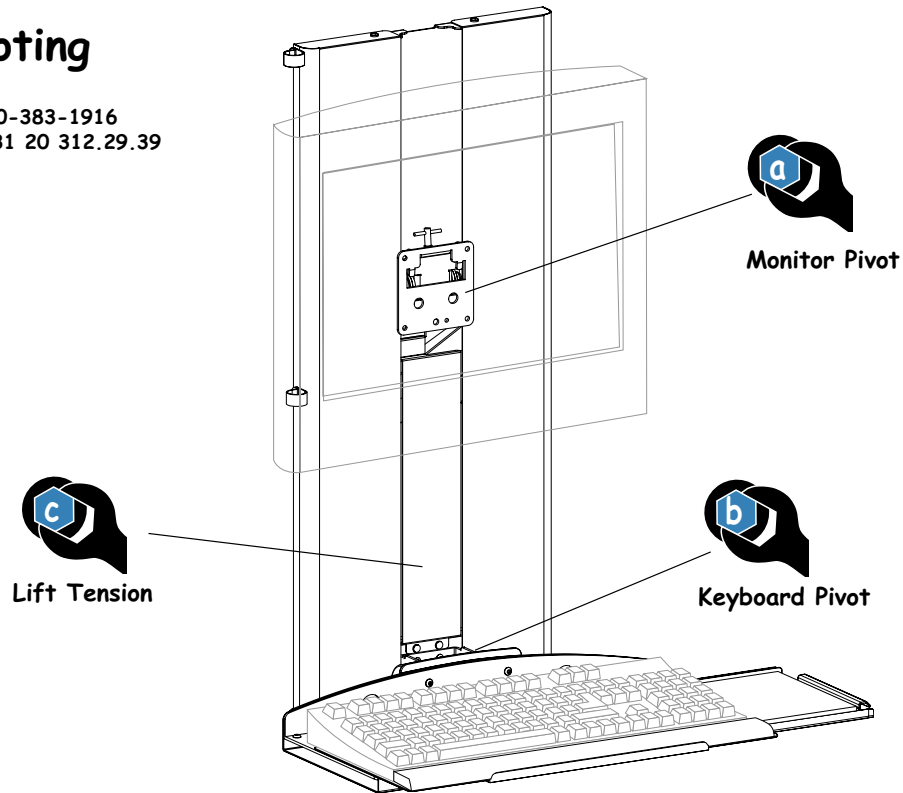

**NO OSHPD
REVIEW REQUIRED**

? Troubleshooting

Ergotron USA 1-800-383-1916
Ergotron Europe +31 20 312.29.39



Symptom	Probable Cause	Solution
Monitor and Keyboard drift upward or downward.	Vertical Lift Tension needs adjustment.	  18
Monitor tilts too easily or with difficulty.	Monitor Pivot needs adjustment.	  16
Keyboard Tray tilts too easily or with difficulty.	Keyboard Pivot needs adjustment.	  17
Keyboard Tray does not fold up under the monitor.	Keyboard Tray configuration does not work with your monitor size.	See Keyboard Tray Arrangements in Step 8a , page 13.

Weight Capacity

The combined load capacity of the system (keyboard and monitor) ranges from 5-30 lbs. (2.3 - 13.6 kg).



© 2004 Ergotron, Inc. All rights reserved.

Patents Pending and Patented U.S. & Foreign. Ergotron is a registered trademark of Ergotron, Inc. Reproduction of this material in whole or part for any purpose other than that authorized by Ergotron, Inc. is prohibited.

**NO OSHPD
REVIEW REQUIRED**