

Installation & Assembly - Vision•Point™ Vertical Desktop Mount with Stationary Base & Vision•Point™ Vertical Desktop Mount with Swivel Base

Model: LCV 100

IMPORTANT! Read entire instruction sheet before you start assembly and installation.

PART LIST

Model	LCV 100		
Part #	QTY.	DESCRIPTION	
A 090-7008	1	LCD mount assembly	
095-8070		hardware pack	
AA	1	4" set screw	
CC	1	washer	
DD	1	nylock nut	
FF	1	1/4" allen wrench	
GG	1	3/16" allen wrench	
B 095-4354	1	adapter plate	
C 504-2013	4	M4 x .7 x 12 mm phillips screw	
D 504-2014	4	M4 x .7 x 20 mm phillips screw	
E 590-5003	4	.198 x .313 x .437 H retaining spacer	
F 520-2175	2	1/4-20 x .5 phillips screw	

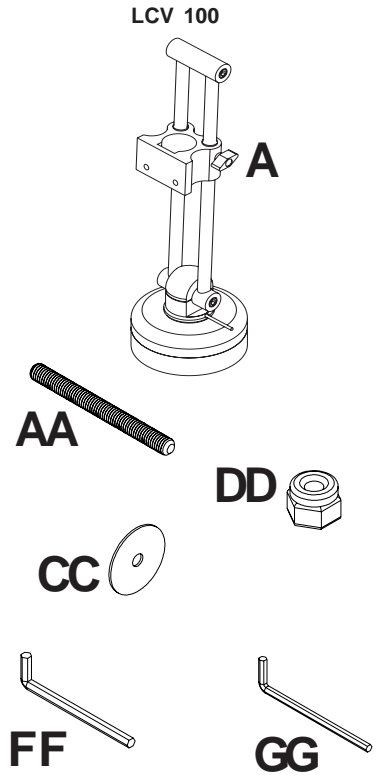

Note: You may not need all hardware provided

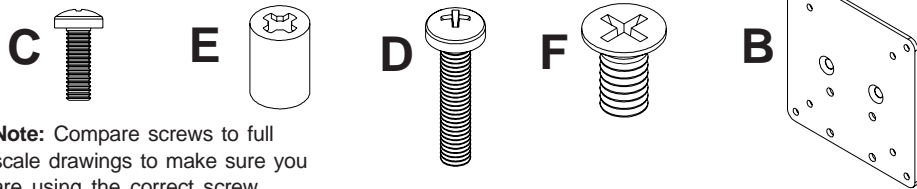

Note: Compare screws to full scale drawings to make sure you are using the correct screw.

Important: The product is made to support screens with a VESA® compliant hole pattern. For safe mounting, mounting screws must turn at least three times in the screen inserts.

⚠ CAUTION

- The LCV 100 can be mounted to most wood and/or wood composite surfaces up to 1.5" thick. Before installation, the installer **MUST** ensure that the mounting surface will safely hold the combined weight of the mount and the screen. The surface must be at least 3/4" thick.

1 Thread set screw (**AA**) into the hole on the bottom of LCD assembly (**A**) using 3/16" allen wrench (**GG**) as shown.

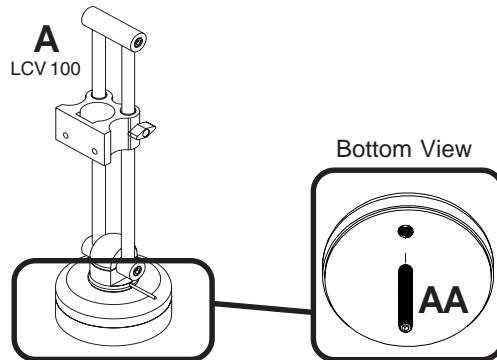

2

Drill a 1/2" hole in the desired location of the desktop. Drop set screw (**AA**) for LCV 100 through the hole (placing 1" base over the hole for LCV 100 model). Fasten LCD assembly with washer (**CC**) and lock nut (**DD**) as shown.

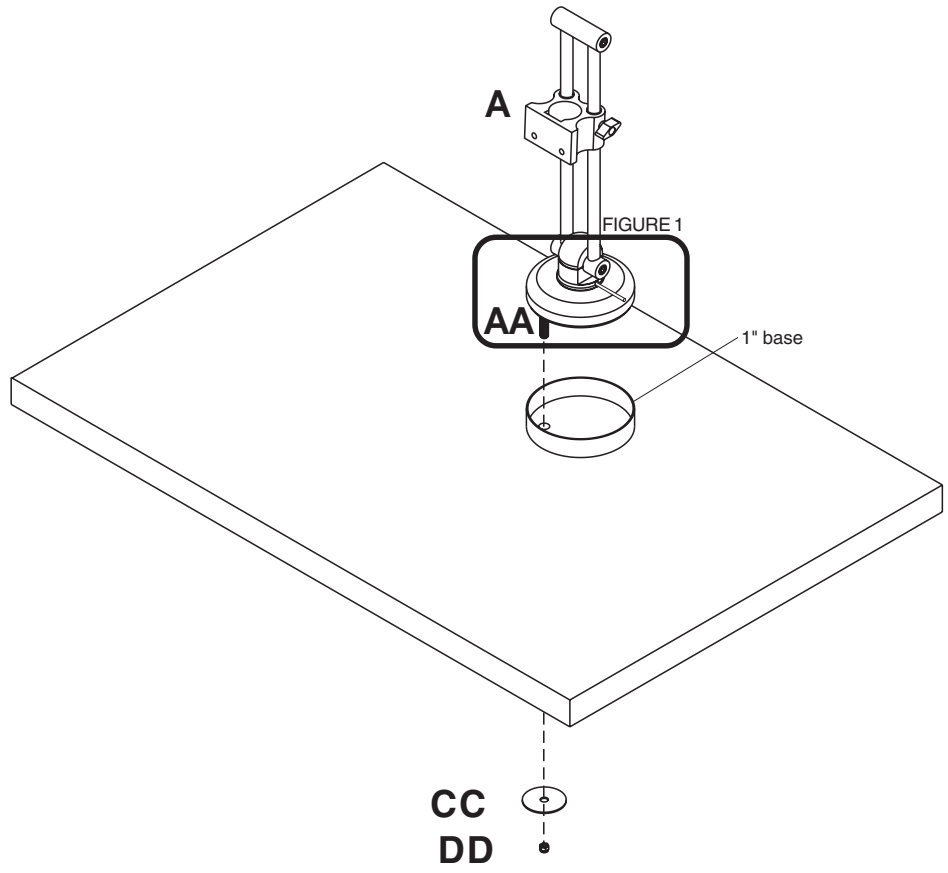

3

Attach adapter plate (**B**) to LCV 100 (**A**) using 2 1/4-20 x .5 phillips screws (**F**) as shown.

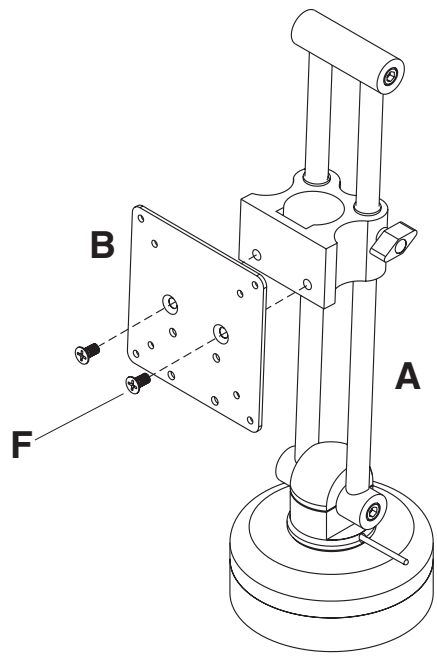

4

In order to be able to safely place the monitor onto the mount, you must first tilt the upright backward about 5° as indicated below:

For the LCV 100 model, loosen the hex head screws using allen wrench (**FF**), tilt the upright 5° and tighten the hex head screws.

Other tilt adjustments will be done later.

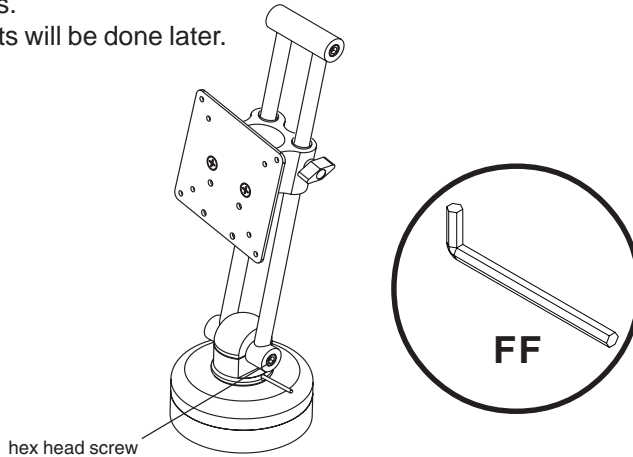

For installing the mounting plate to the LCD monitor, read the following references:

For installing to VESA 75 mm and VESA 100 mm, see below.

For installing to existing Peerless® adapter plate, go to page 4.

FOR INSTALLING TO VESA 75 MM, 100 MM

5

Attach mount assembly (**A**) to monitor using four M4 x 12 mm screws (**C**) in either the 75 MM or the 100 MM hole pattern as shown. If necessary use four M4 x 20mm screws (**D**) and retaining spacers (**E**) provided with adapter plate.

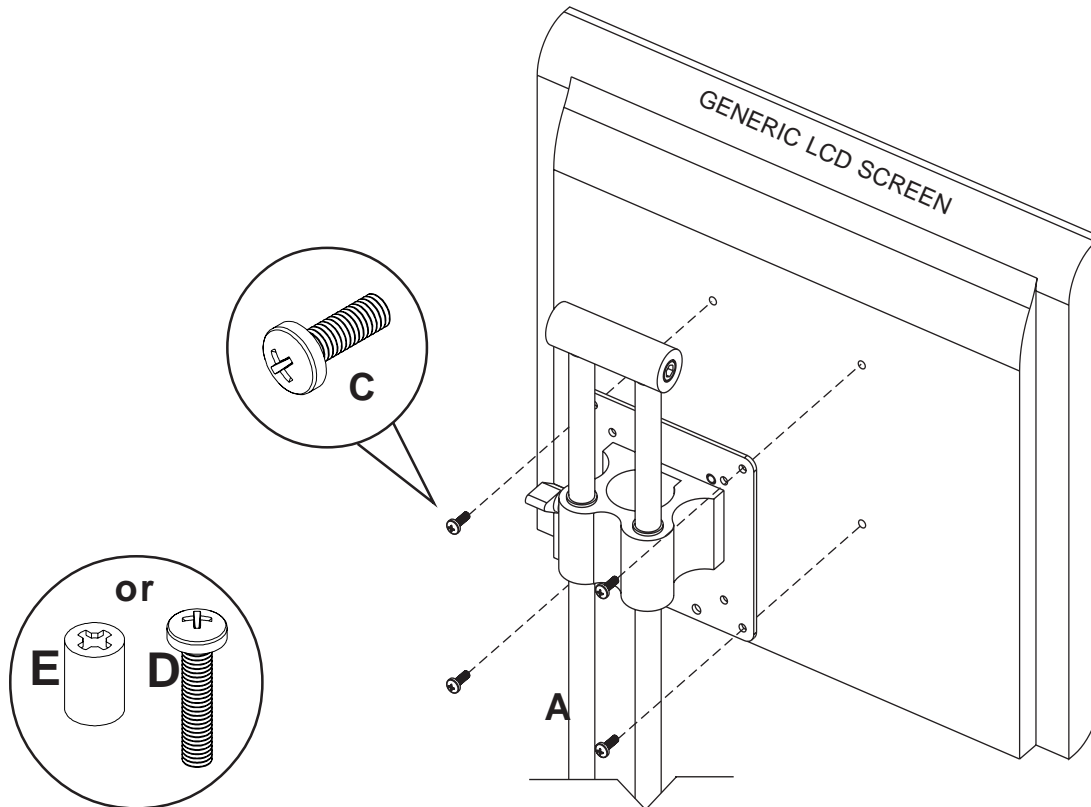

FOR INSTALLING TO EXISTING PEERLESS ADAPTER PLATE

6 **Note:** Refer to adapter bracket instruction sheet for attachment of adapter bracket to monitor.

Attach interface plate (**B**) to existing adapter plate using four M5 x 6 mm screws provided with adapter plate as shown to the right.

IMPORTANT! Hole on bottom denotes bottom of adapter plate as shown in detail 2.

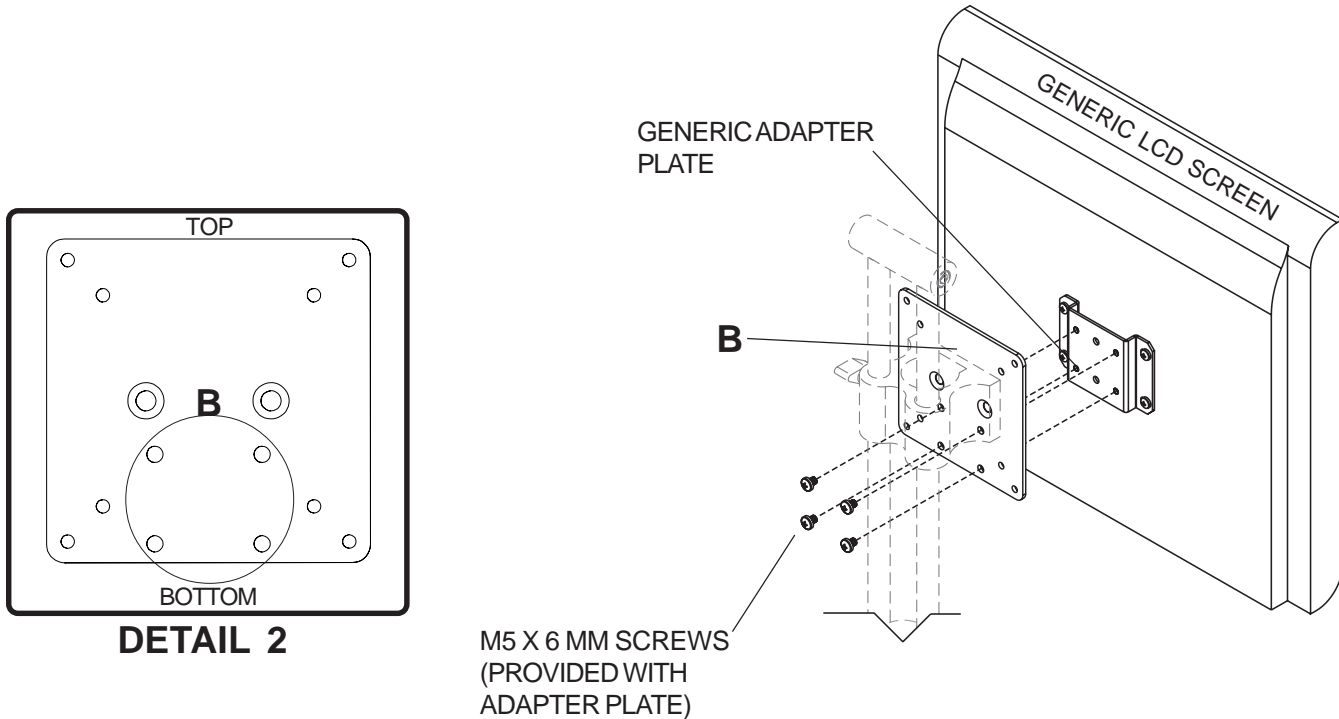

7 To adjust upright in a backward tilt position: Hold the screen with one hand, and loosen the hex head screws with allen wrench (**FF**). Move upright in the desired backward tilt position and tighten hex head screws.

To adjust upright in a forward tilt position: hold screen with one hand, and loosen the hex head screws with allen wrench (**FF**). Place upright in the desired forward tilt position and tighten hex head screws.

If the upright keeps moving forward use allen wrench (FF) and tighten the hex head screws at the bottom of the assembly as shown below.

